

RIVNUT RNFFSHE SERIES

Description	Flush Flange, Full Hex Body
Material	Steel
Finish	Zinc

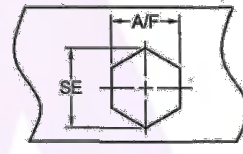
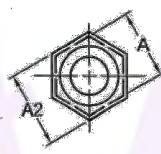
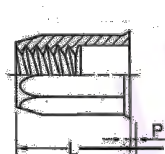

Dimensions in millimetres.

Part Number	Thread Size	Hex Hole Size A/F +0.1	A -0.2	B ±0.35	L ±0.35	P ±0.2	SE Min	Grip Range
RNFFSFBH04	M4	6.1	6.0	9.0	11.2	0.8	6.8	0.5 ~ 2.5
RNFFSFBH05	M5	7.1	7.0	10.0	13.0	1.0	8.0	0.5 ~ 3.0
RNFFSFBH06	M6	9.1	9.0	13.0	16.0	1.5	10.3	0.5 ~ 3.0
RNFFSFBH08	M8	11.1	11.0	16.0	18.0	1.5	12.6	0.5 ~ 3.0
RNFFSFBH10	M10	13.1	13.0	19.0	24.0	2.0	14.0	1.0 ~ 4.5

PLEASE NOTE – NOT ALL STYLES & SIZES ARE HELD IN STOCK AT ALL TIMES. PLEASE CONTACT US TO CHECK AVAILABILITY. MINIMUM ORDER QUANTITIES APPLY.

RIVNUT RNLFSFBH SERIES

Description	Large Flange, Full Hex Body
Material	Steel
Finish	Zinc

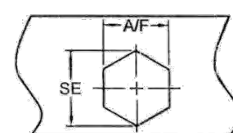
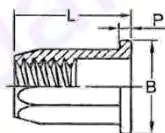

Dimensions in

millimetres.

Part Number	Thread Size	Hex Hole Size A/F +0.1	A -0.2	B ±0.35	L ±0.2	P ±0.35	SE Min	Grip Range
RNLFSFBH05	M5	7.1	7.0	10.0	13.0	1.0	8.0	0.5 ~ 3.0
RNLFSFBH06	M6	9.1	9.0	13.0	16.0	1.5	10.3	0.5 ~ 3.0
RNLFSFBH08	M8	11.1	11.0	16.0	18.0	1.5	12.6	0.5 ~ 3.0

PLEASE NOTE – NOT ALL STYLES & SIZES ARE HELD IN STOCK AT ALL TIMES. PLEASE CONTACT US TO CHECK AVAILABILITY. MINIMUM ORDER QUANTITIES APPLY.