

# LSD 2.0 S

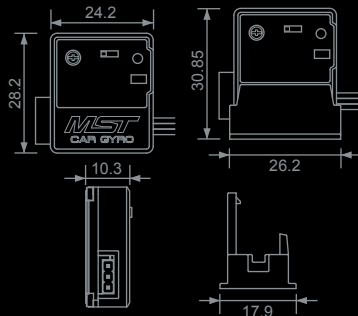

## SPECIFICATIONS

Dimension: 26.0x27.0x11.3mm  
 Weight: 7.0g(0.285 oz) with plastic Case  
 4.8g(0.169 oz) w/o plastic Case  
 Power Supply: 4.8-6.0 Volts  
 Current Drain: 10mA(4.8V)  
 Operating Temperature: -20°C to +85°C  
 Stepless adjustment sensitivity

CAR GYRO

**MST**  
 MAX SPEED TECHNOLOGY

rc-mst.com  
 facebook.com/MST.tw

LSD 2.0 gyro is a specific and completed gyro for RC cars. MST integrates parameters by many events and practices into development. The LSD 2.0 gyro makes car drift smoothly and naturally in curves. It shows amazing balance between car controlling and gyro supporting for beautiful dynamic and stability in different curves.

## FEATURES

### ■ NEUTRAL AUTOMATIC LOCK FUNCTION

The LSD 2.0 gyro is able to auto-lock the neutral point to ensure servo correct position at any time. You do not have to adjust the neutral by hands as traditional gyros!

### ■ CONSIDERATE OF FUNCTION FOR FORWARD AND REVERSE ROTATION CHANGE

You can change the rotation by switch instead of changing gyro position and direction. More choices to set it up!

### ■ SERVO PROTECTION SETTING

Unique design for servo maximum & minimum travel setting, this feature prevent from over-heating when servo exceed its limitation and extend the life of servo further.

### ■ WIRELESS CH3/CH4 SENSITIVITY ADJUSTMENT (RS Version)

The LSD 2.0 gyro supports direct sensitivity adjustment by remote transmitter. You can adjust the volume by digital display accurately and promptly get the best control way in different places!

### ■ UNIQUE REMOVABLE GYRO BASE

The unique base latch design is convenient for removing. The big fitting base applies to more locations for different track.

### ■ JAPANESE SENSE-ELEMENT

The sense-element of LSD 2.0 gyro is from Japanese muRata which also apply for the real car.

**Please read this instruction carefully before any operation of your gyro.**

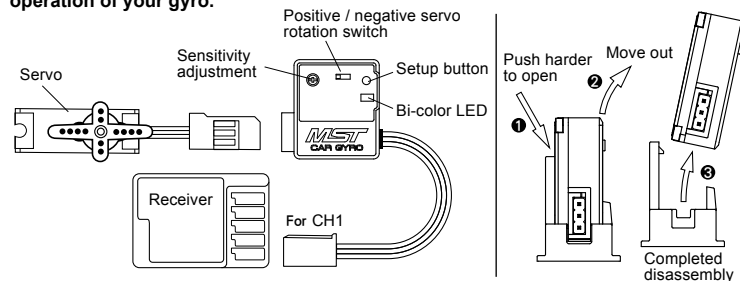

## INTRODUCTIONS OF LSD2.0 S GYRO

### 1 NEUTRAL SETTING < LSD 2.0 Supports neutral detecting automatically. >

Please stand car and turn on gyro after wiring. Both red and green LED flash about three seconds until Bi-color LED light for neutral setting completion. Gyro resets automatically the neutral every time when it is turned on. (\*Please note that gyro cannot detect the neutral for setting if the car is not standing.)

### 2 FORWARD / REVERSE SETTING

If you are not going to set the orientations, please set by switch.

### 3 ACTUATION TRAVEL SETTING

"Press set button constantly then turn power on, about one second later the green LED flashes for setting mode. (\*Please note that some servos default direction is opposite to gyro, if setting of step one is unsuccessful, please follow another direction of step one and two.)

**STEP 1** - Turn right (or left) steering wheel of transmitter to required actuation value, press set button and the red LED flashes once, then green LED flashes twice for setting completion of max right (or left) steering.

**STEP 2** - Turn left (or right) steering wheel of transmitter to required actuation value, press set button and Bi-color LED flash for setting completion of max left (or right) steering. Standing car until neutral setting finish, then Bi-color LED light constantly for all action completion, no need for reboot."

### 4 ACTUATION TRAVEL RELEASING

"Press set button constantly then turn power on, about 1 second later the green LED flashes for setting mode. Hold set button about 3 seconds until green LED lights constantly and red LED flashes, then Bi-color LED flash for actuation release completion. Standing car until neutral setting finish, then Bi-color LED light for all action completion, no need for reboot."

### 5 SENSITIVITY SETTING

Adjust the sensitivity by gyro switch.

As diagram to turn clockwise for max. +100 and counterclockwise for min. -100. Bi-color LED off when gyro is stopped.



# LSD 2.0

CAR GYRO

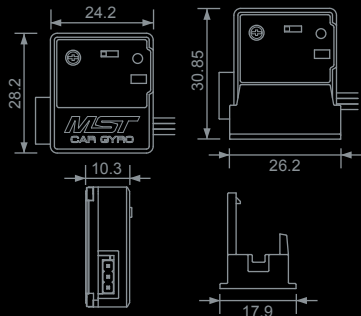

## 規格

外型尺寸: 26.0x27.0x11.3mm

重量: 7.0g(0.285 oz) 含外殼

4.8g(0.169 oz) 不含外殼

工作電壓: 4.8-6.0 Volts

消耗電流: 10mA(4.8V)

適用溫度: -20°C to +85°C

無段式感度調整

**MST**  
MAX SPEED TECHNOLOGY

rc-mst.com  
facebook.com/MST.tw

MST歷經長時間的實戰測試，整合了各項參數所研發出的全方位車用陀螺儀 LSD2.0。在彎中的運行曲線會讓您驚訝的發現車輛走行時動態是如此的順暢，自然，在彎道間的車體控制與陀螺儀輔助下取得最佳平衡，在不同的彎道中車體都能保持優美的動態與安定感。

## 特點介紹

### 智慧型中立點自動鎖定功能

LSD2.0版能為您自動鎖定中立點，讓伺服機隨時保持在正確位置，進而改善了傳統陀螺儀需要手動調整的不便，讓使用LSD2.0版的玩家能輕易上手！

### 貼心的正逆轉切換功能

只需切換正逆轉開關改變作動方向，不須變更本體方向，安裝位置更自由自在。

### 保護伺服機的行程設定

獨家設計伺服機左右行程設定，抑制陀螺儀最大行程作動，防止伺服機行程過量而產生之高溫，進而延長伺服機使用壽命。

### 無線(CH3/CH4)感度調整功能(RS版)

LSD2.0RS版本上，可在發射機以無線方式作感度調整，數位化的顯示方式，能精準設定您的感度位置，快速的在各種場地中找到最迎合您的操控感受！

### 獨家拆卸式陀螺儀底座

獨家巧妙的底座卡榫設計，讓拆卸時更加便利，大面積的底座貼合處，讓擺放自由度大增，更能廣泛的安裝於各車系，讓使用上更加方便。

### 日製感測元件使用

LSD2.0版採用日製進口村田(muRata)之感測元件使用，村田生產之感測元件亦使用於賽車感測元件上！

※ 進行LSD2.0S版安裝設定前，請先詳細閱讀以下使用說明。

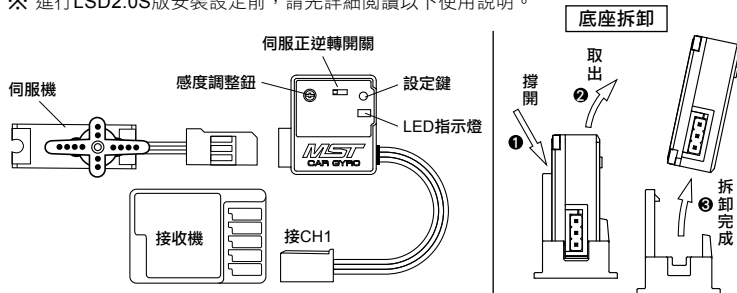

## 使用說明(S版)

### 1 中立點設定 LSD 2.0 為自動偵測中立點

在完成配線後，請將車身靜置後開啟電源。紅綠燈會同時閃爍直到偵測中立點，約3秒鐘紅綠燈會同時亮表示已完成中立點設定。以上動作在每一次開啟電源後，都會自動完成中立點設定。（※ 車身若無靜置會觸發陀螺儀作動而無法偵測到中立點）

### 2 正逆轉設定

陀螺儀作動方向如不是設定方向，只需在正逆開關上作切換即可

### 3 作動行程設定

按住設定鍵不放再開啟電源約一秒鐘後，綠燈會短閃燈，表示已進入設定模式。（※ 因市面上的伺服機品牌或車體伺服機裝置方向會有所不同，如第一動作向右無法完成設定，請改為第一動作向左，第二動作向右即可完成設定。）

**STEP 1 -** 向右(或向左)轉動方向輪到要設定的行程點，短按一下設定鍵，紅燈會閃燈1下後跳至綠燈短閃燈2下，表示已完成右轉(左轉)最大行程設定。

**STEP 2 -** 向左(或向右)轉動方向輪到要設定的行程點，短按一下設定鍵，紅綠燈會同時閃爍，表示已完成左轉(右轉)最大行程設定。靜置車體直到中立點完成，紅綠燈恆亮即完成所有動作，無需重新開機。

### 4 作動行程解除

按住設定鍵不放再開啟電源約一秒鐘後，綠燈會短閃燈，表示已進入設定模式。長按設定鍵約3秒鐘，完成時綠燈恆亮紅燈閃爍即完成，完成行程解除後紅綠燈會同時閃爍。靜置車體直到中立點完成，紅綠燈恆亮即完成所有動作，無需重新開機。

### 5 感度調整設定

LSD2.0S版的感度調整是在本體上的感度調整鈕。如圖示+100為感度最大(順時鐘方向)，-100則為感度最小，當陀螺儀停止作動，紅綠燈會熄滅。

