

Adding washers allows the servos to be tilted forward. Effectively improve the steering stability of the vehicle during driving. The lean angle depends on the caster angle of the front wheels.

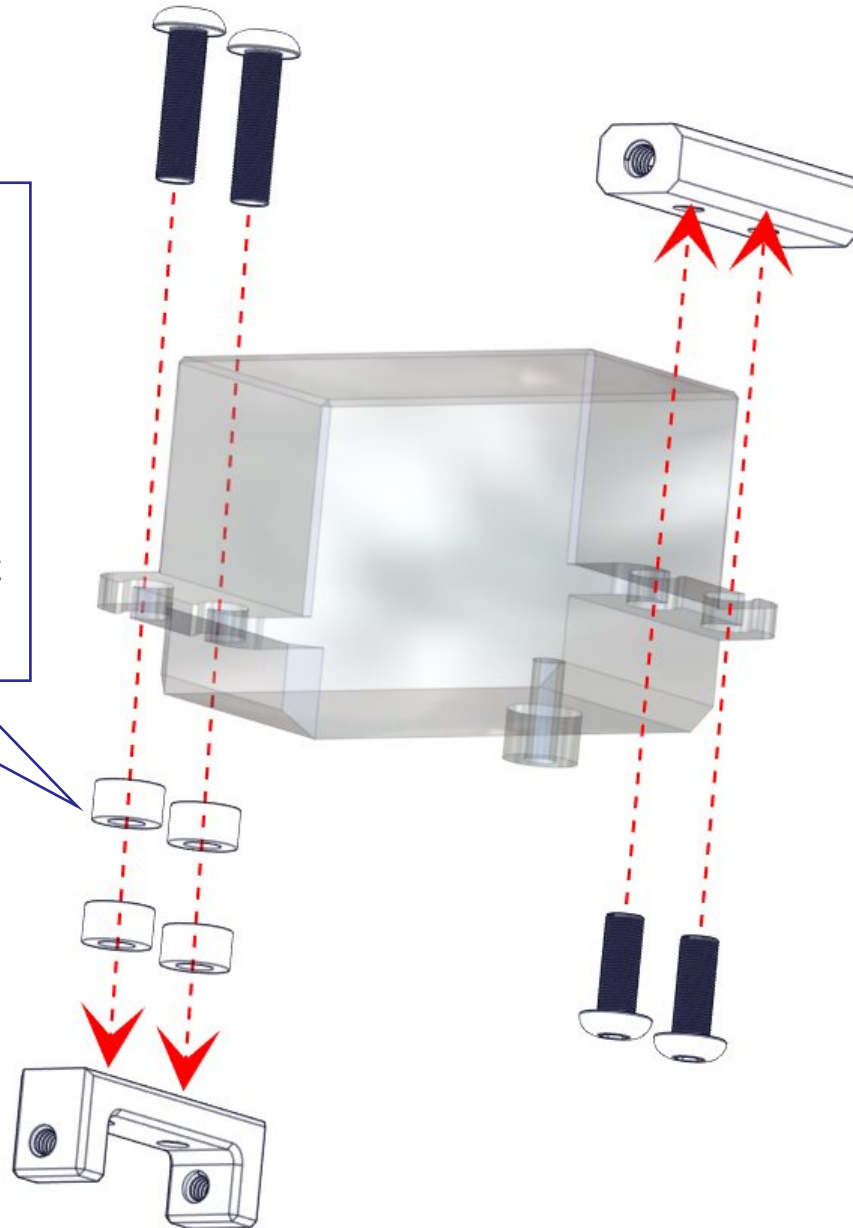

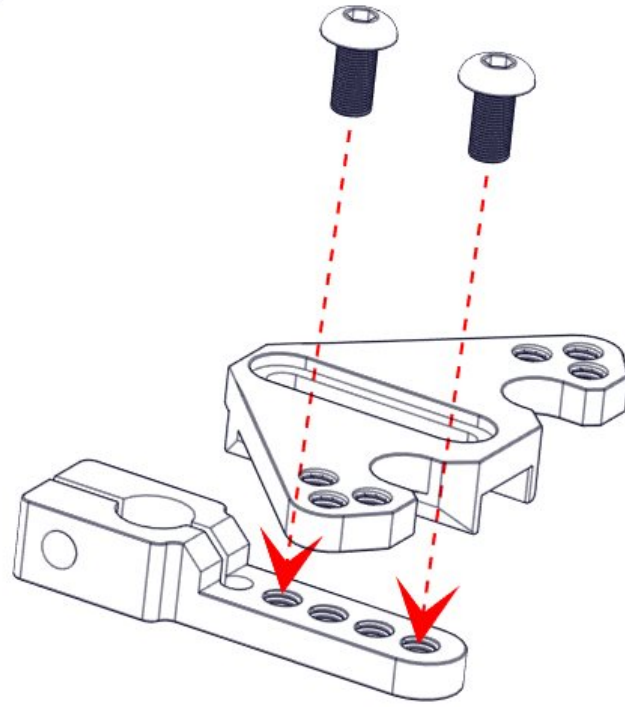

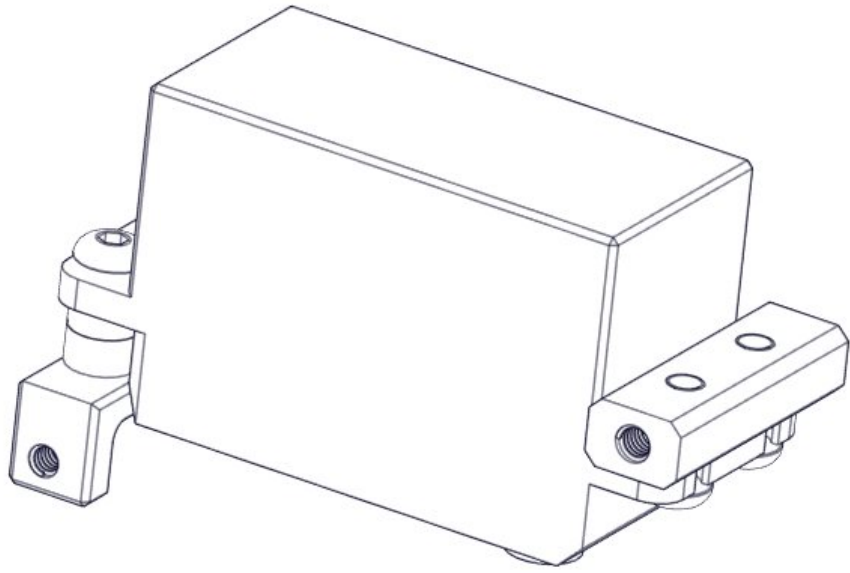
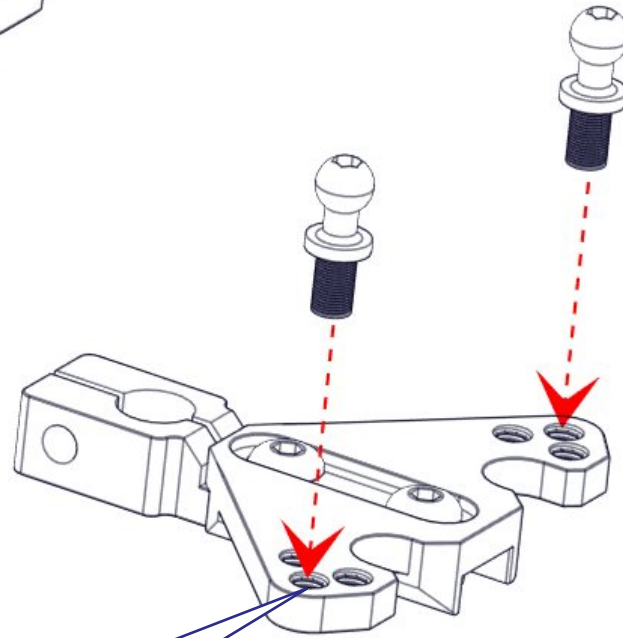
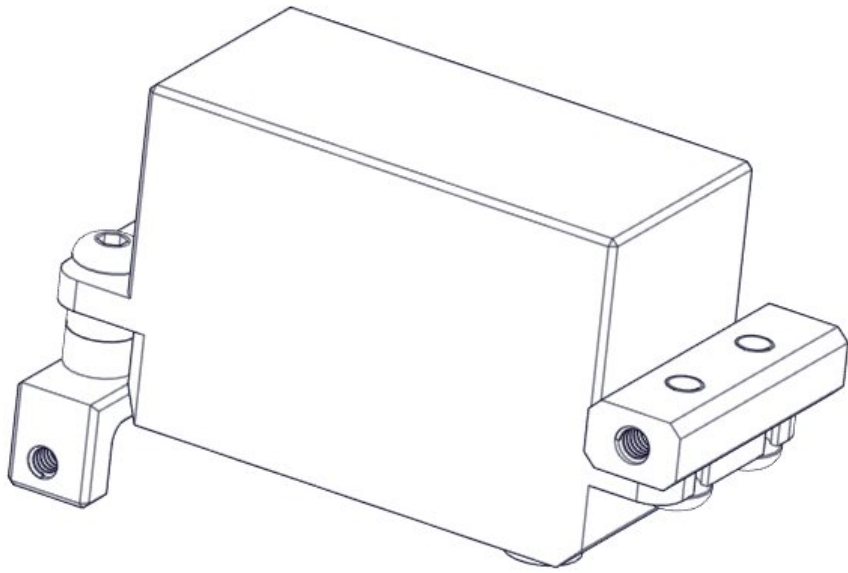

The two outermost threaded holes are recommended

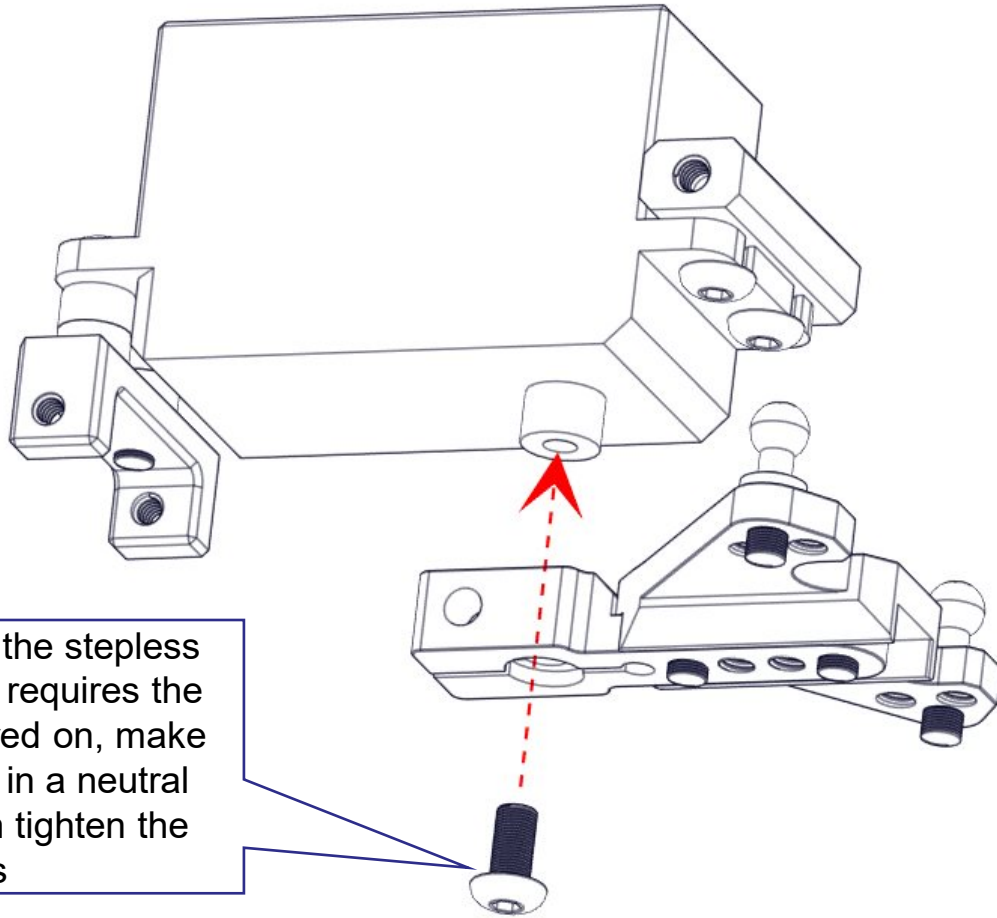

The installation of the stepless private server arm requires the server to be powered on, make sure the server is in a neutral position, and then tighten the screws

After checking that the servo and the servo arm are in the neutral position after power-on, tighten the locking screw of the servo arm.

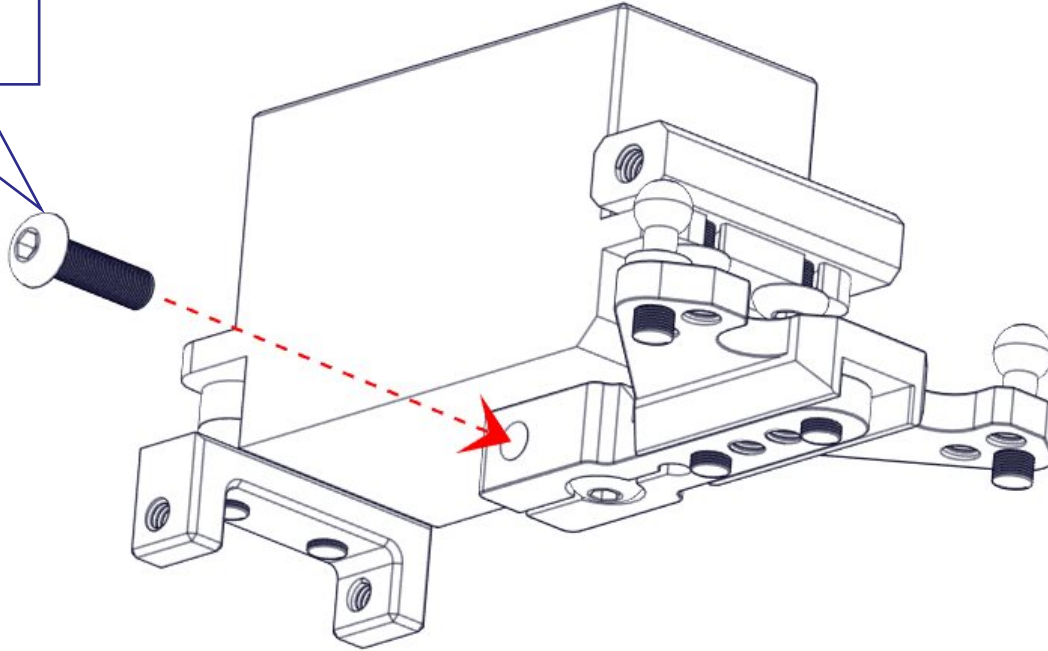

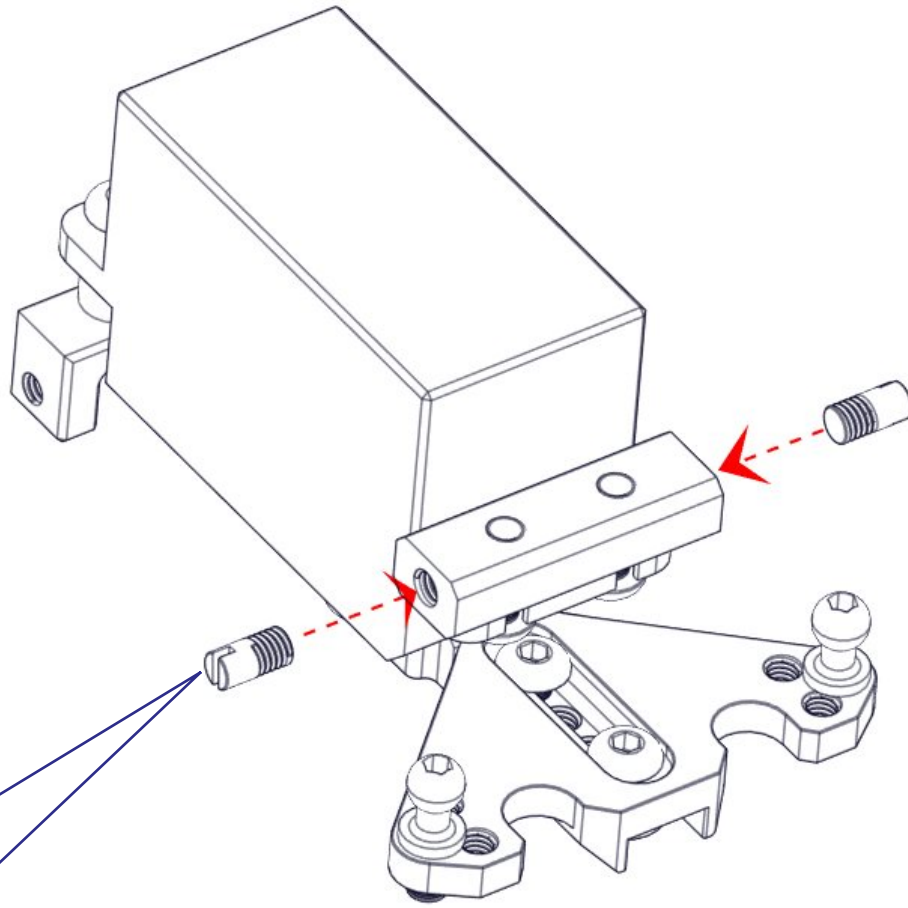

It should be noted here  
that the positioning  
screws need to be  
tightened after adding  
screw glue

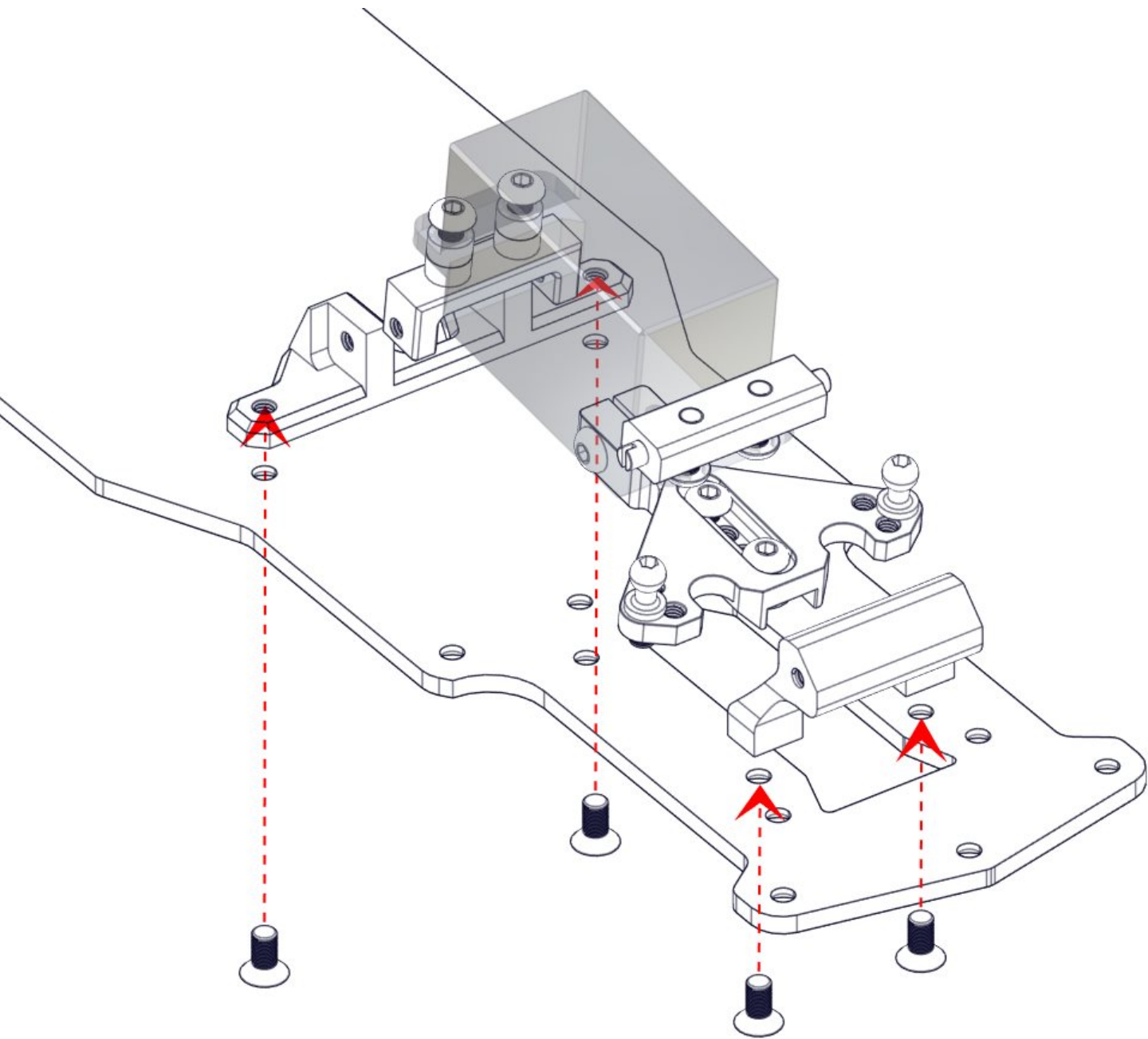



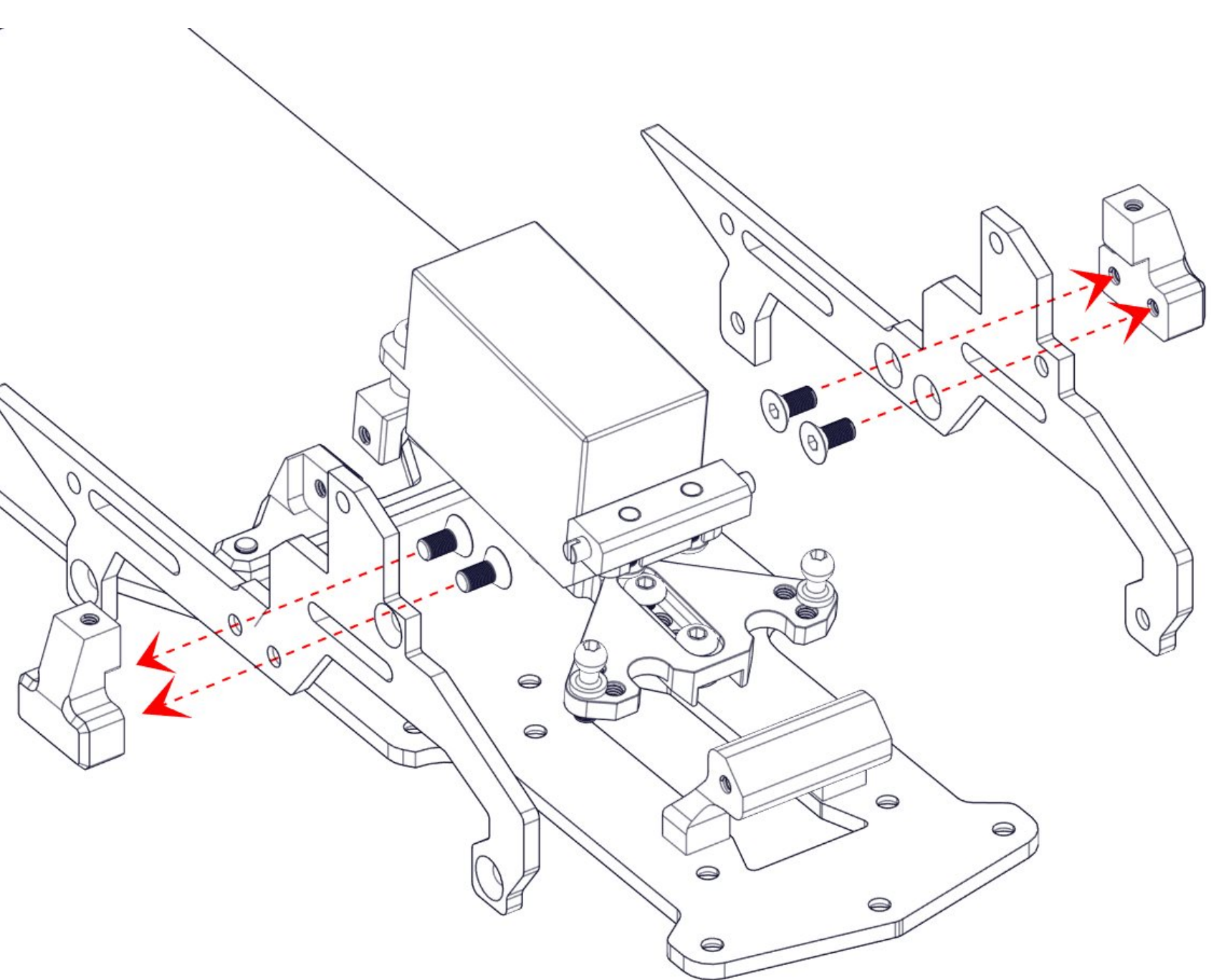

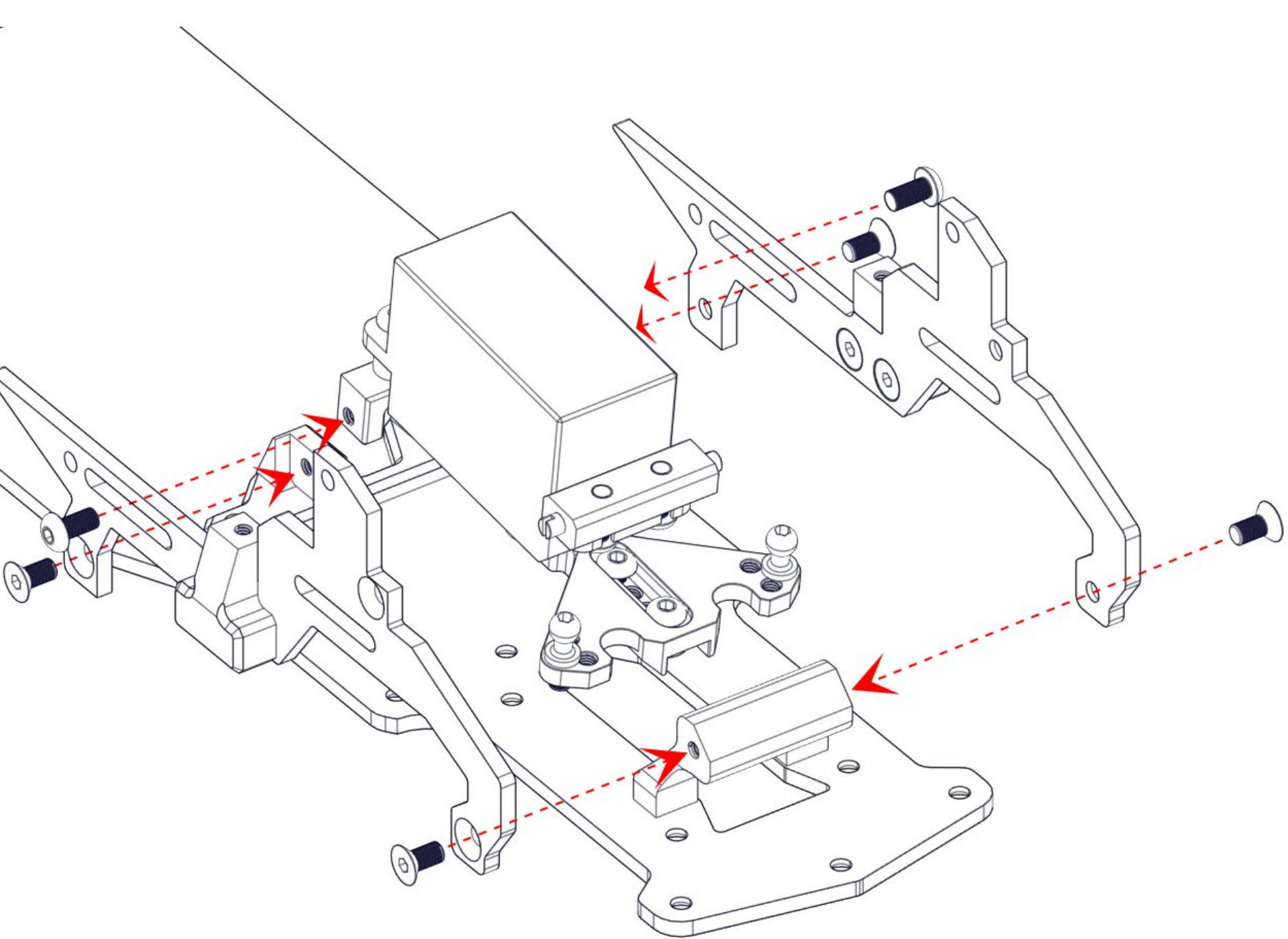

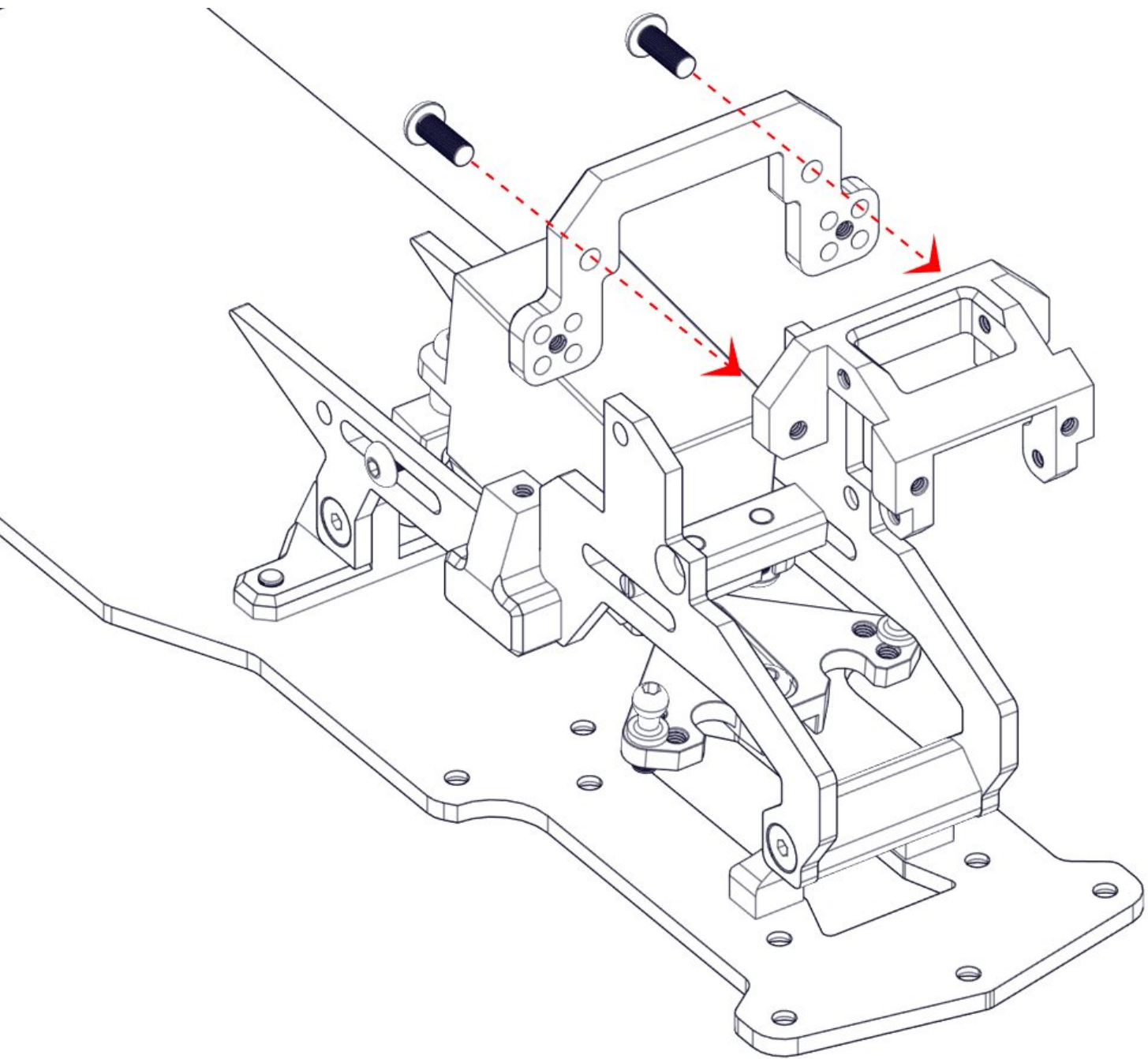

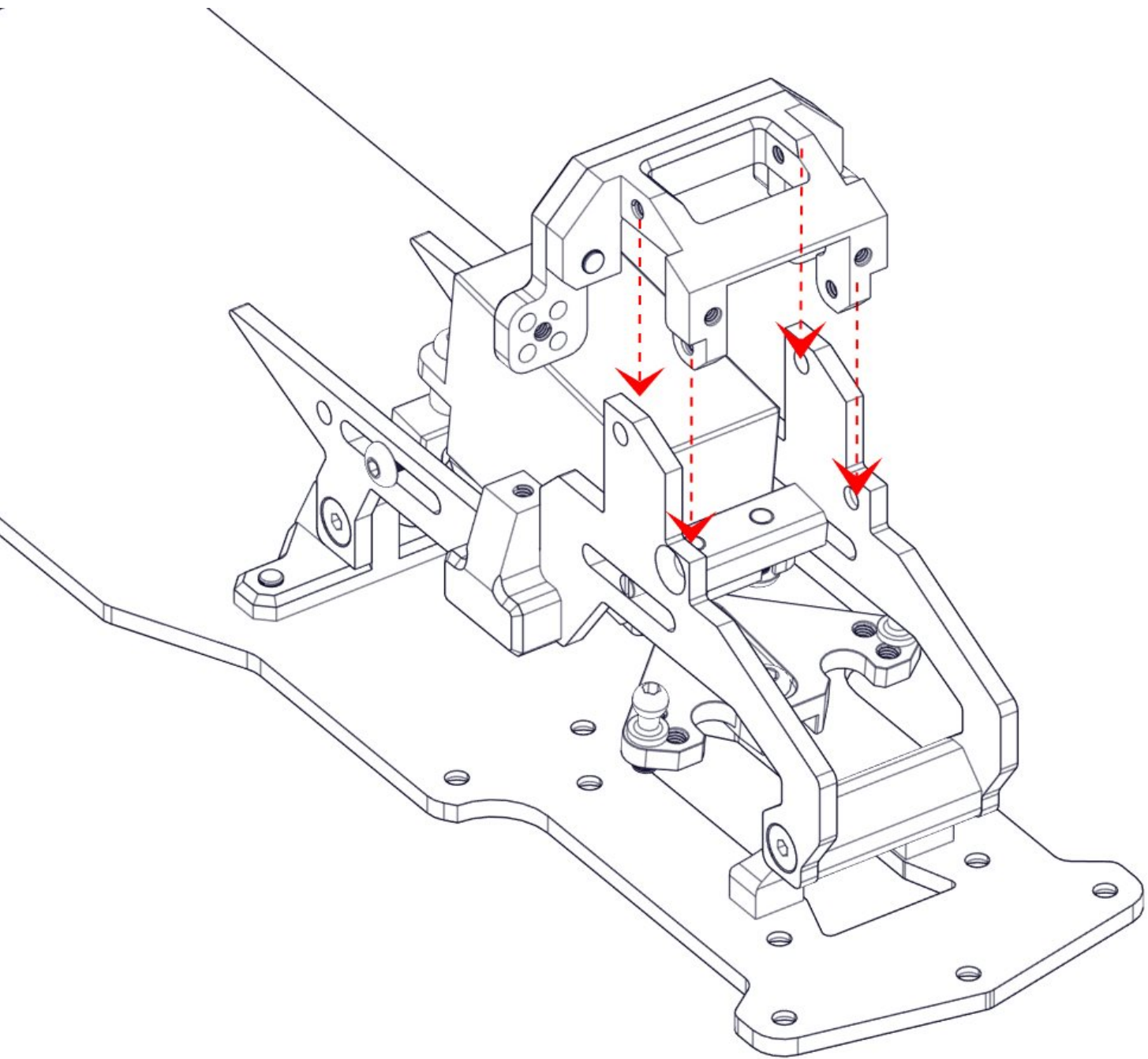

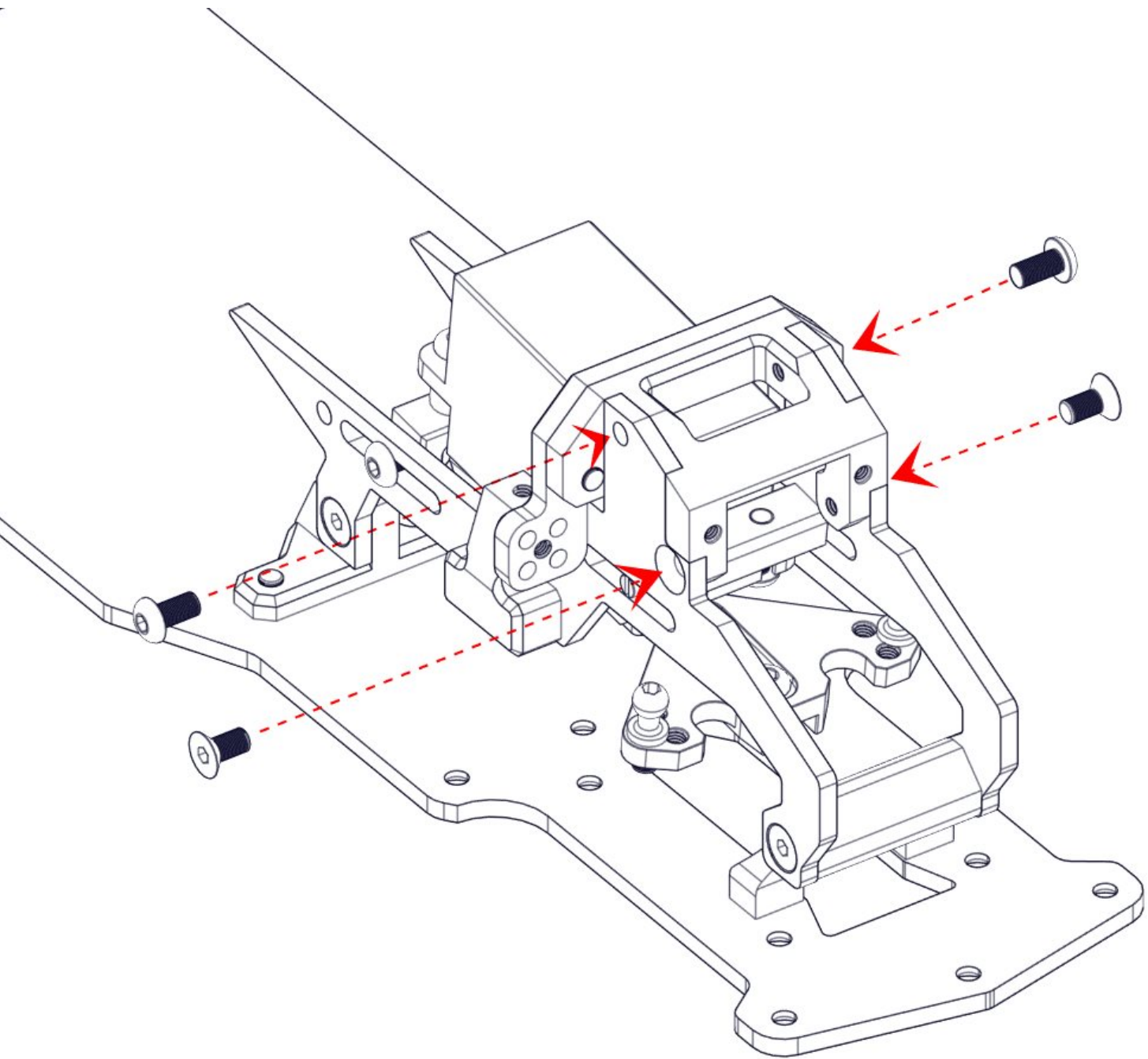

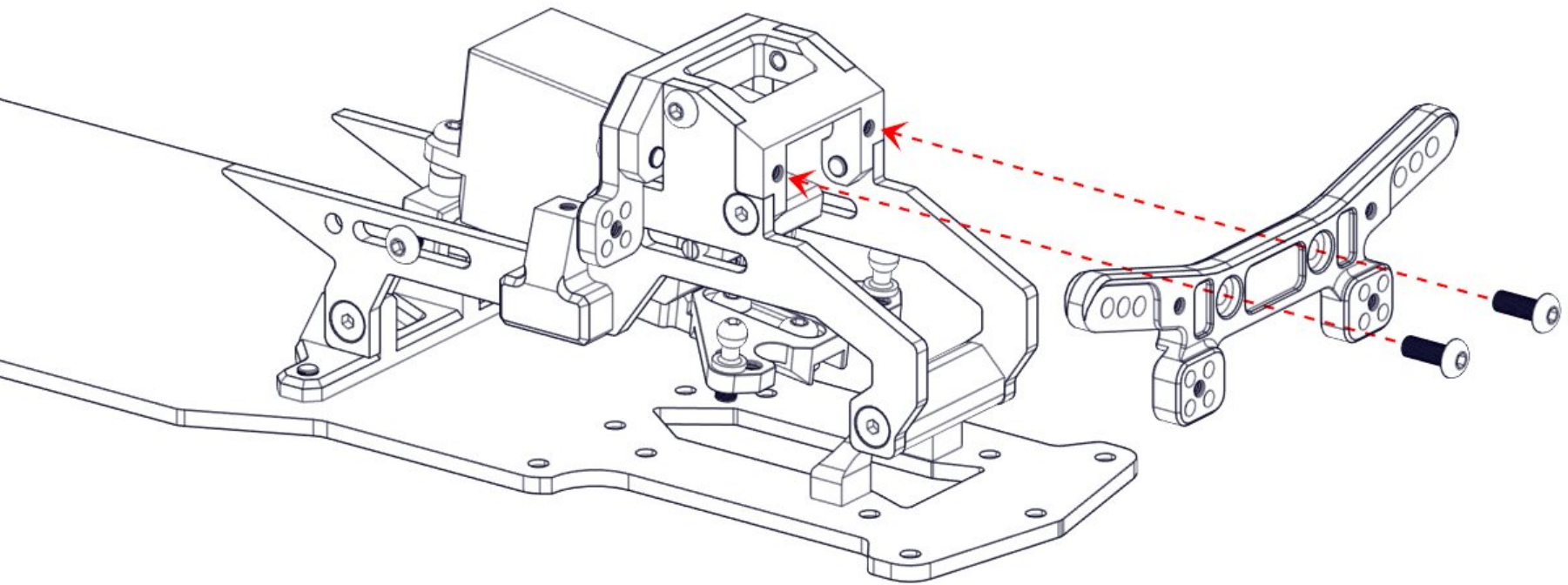

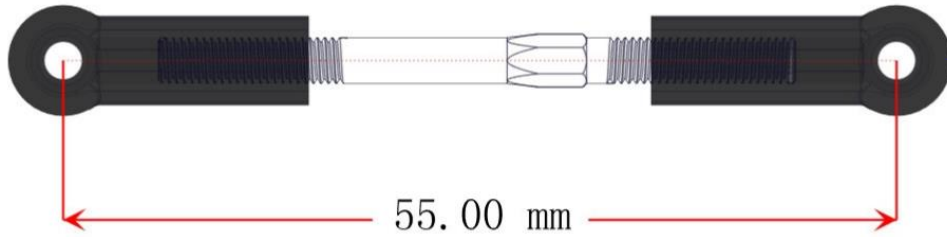

For the first assembly, it is recommended to start with a tie rod length of 55mm. After assembly, adjust the length of the tie rod according to the distance between the wheels of the vehicle and the size of the Ackerman angle.

