

C-LSD (YD2)

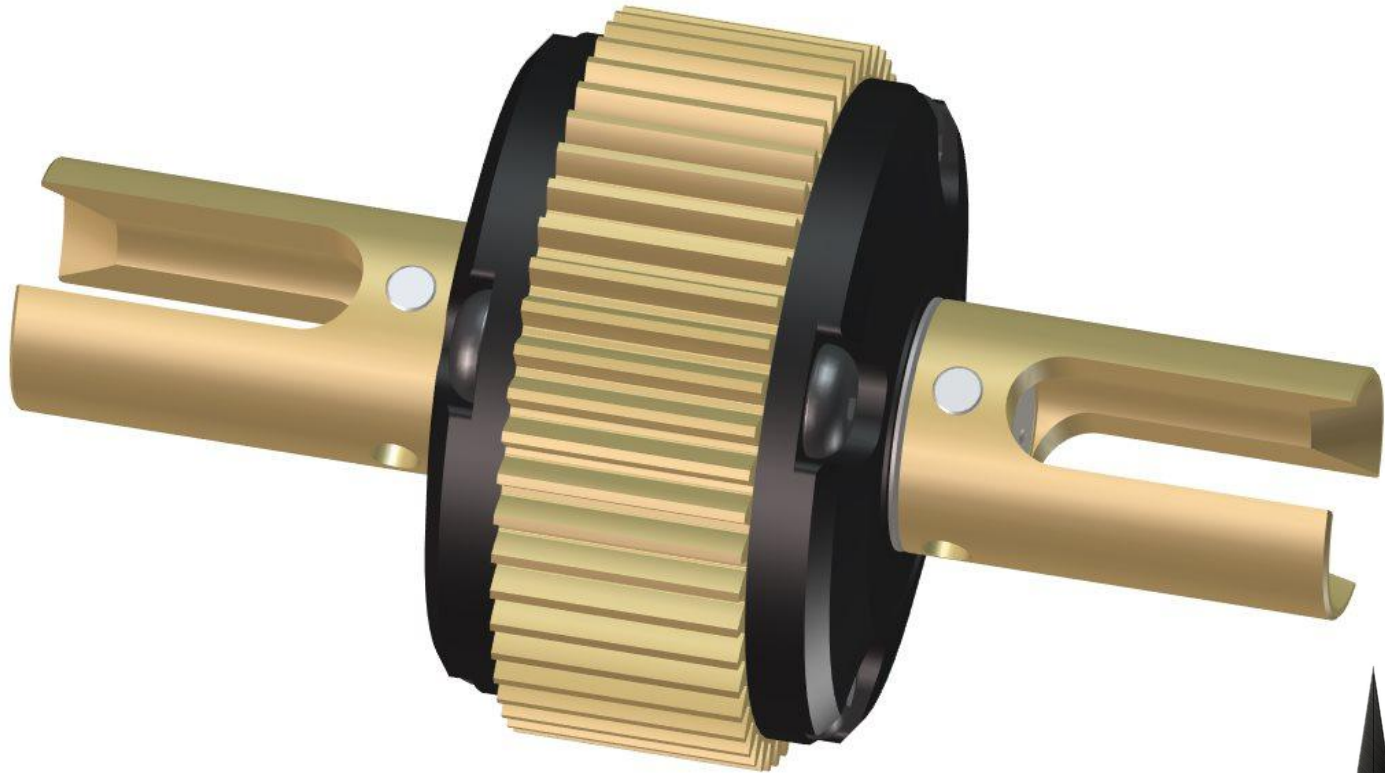

RHINORACING

C-LSD (YD2)

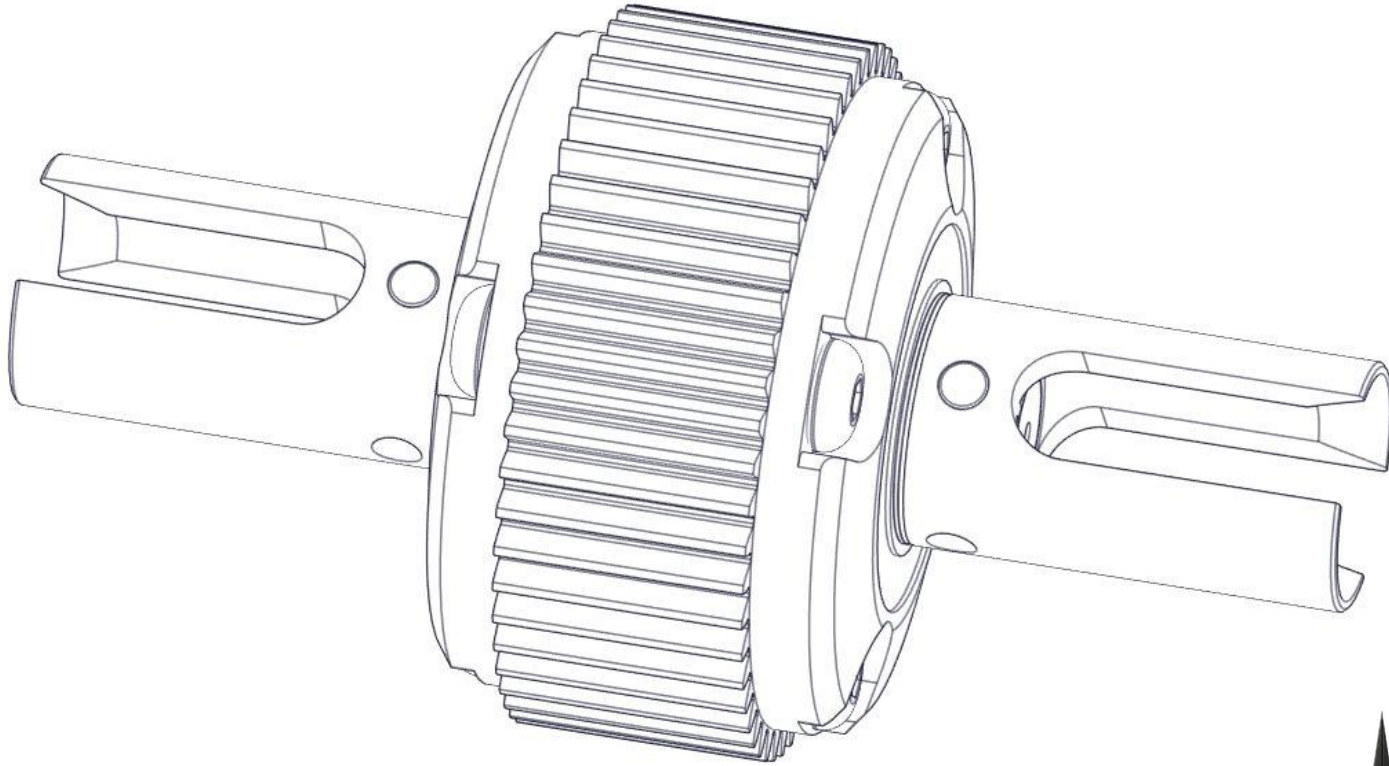

RHINORACING

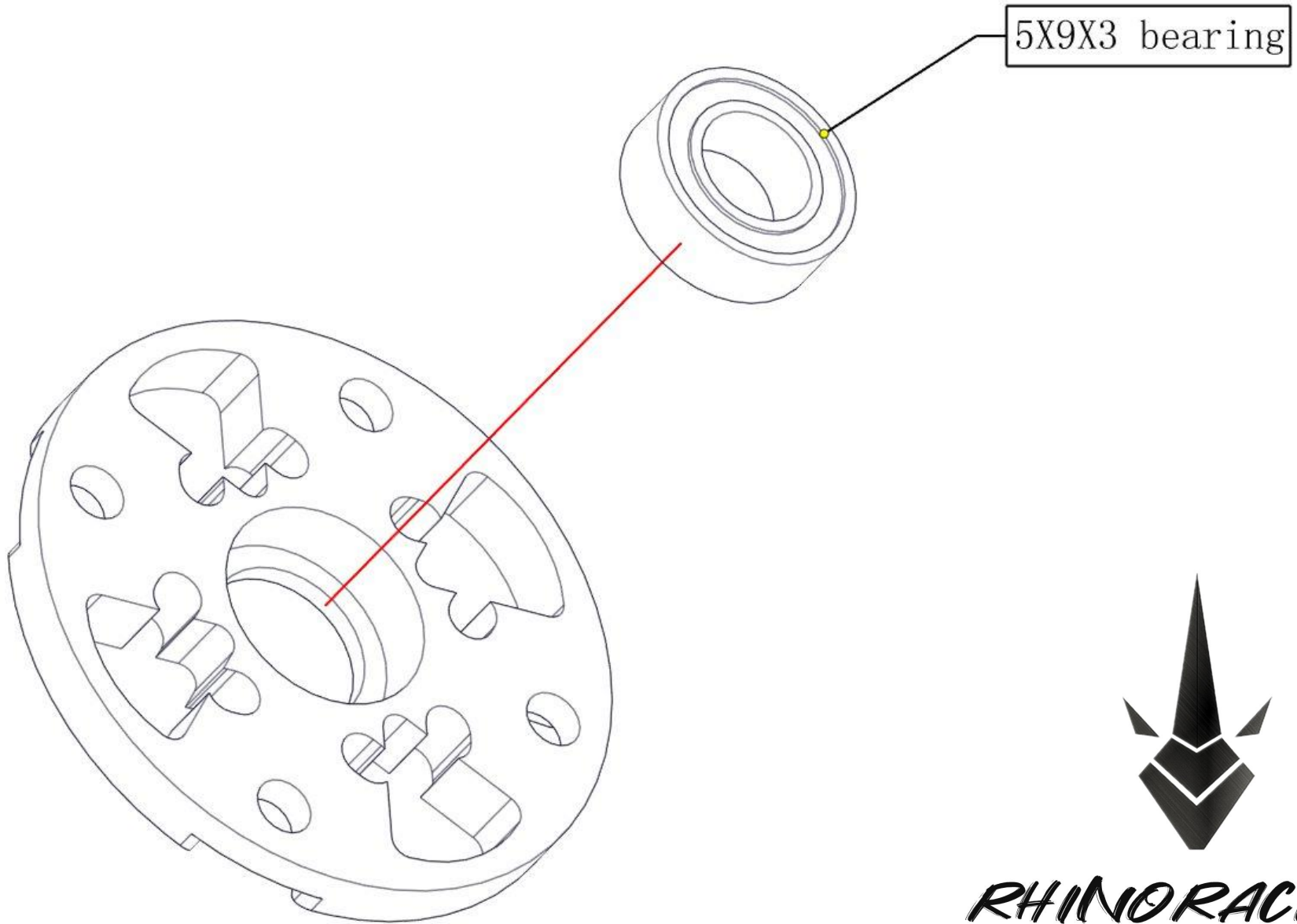

RHINORACING

4 pieces or 2 pieces on the opposite
side optional V-shaped shrapnel
(limited slip intervention fast or slow
0.15/0.2 different thickness)

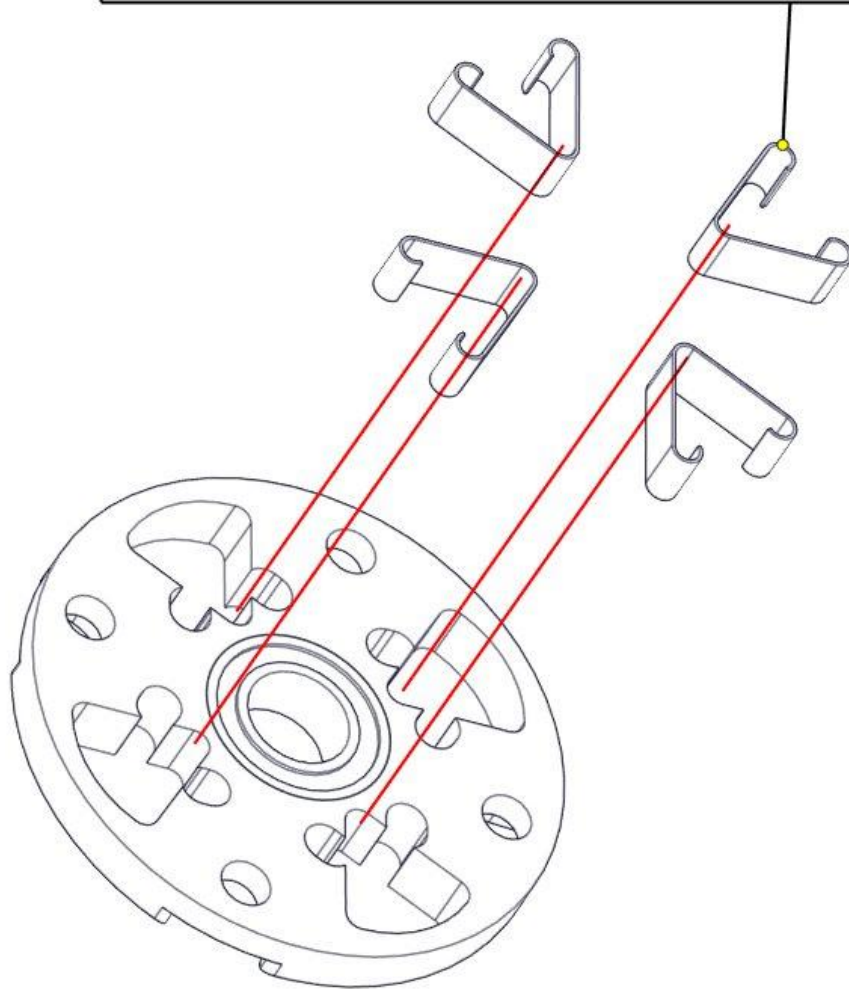

Please use a 7-8mm post to spread
the leaf spring to 75-80° , then
install it into the leaf spring
slot.



RHINORACING



RHINORACING

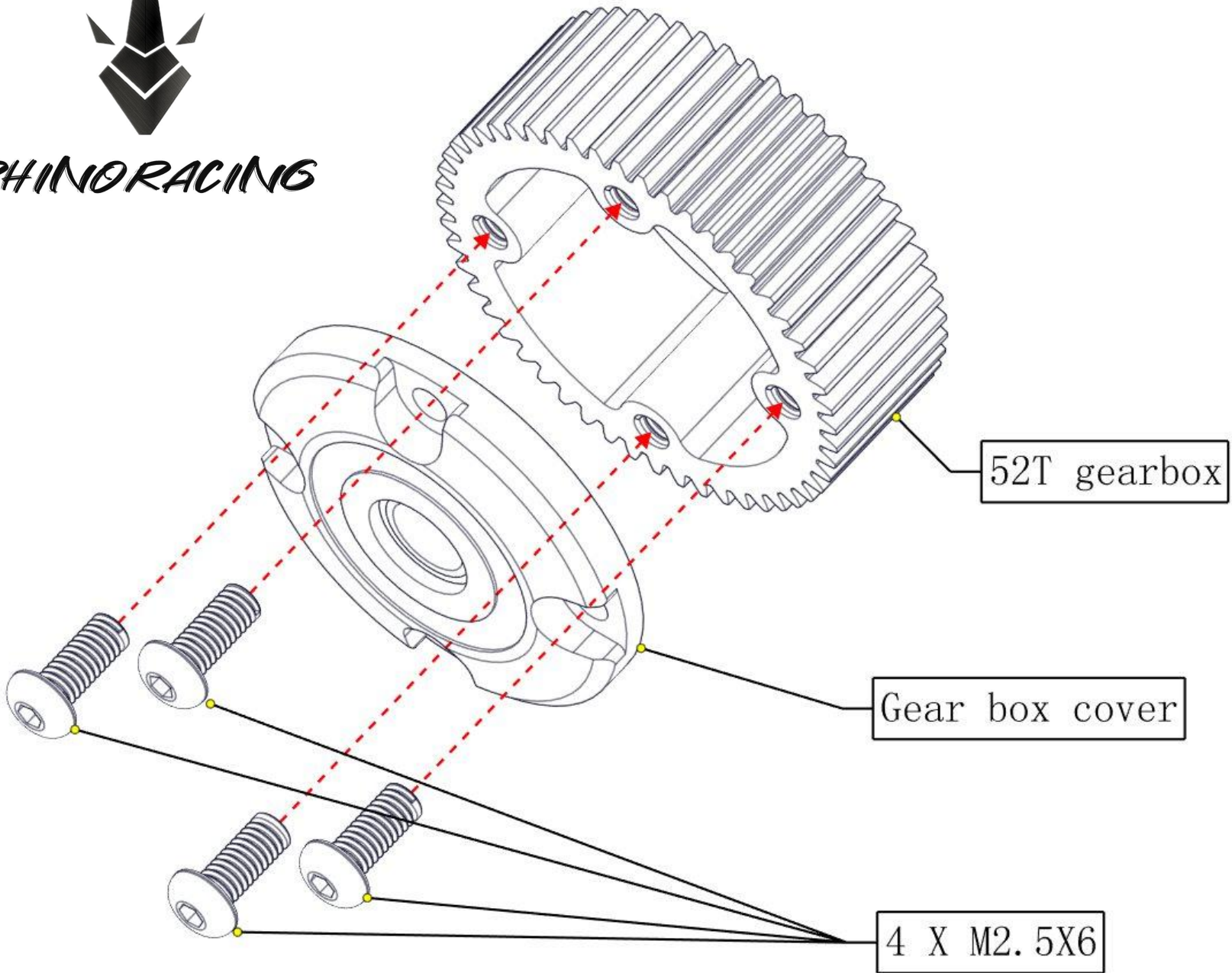



RHINORACING

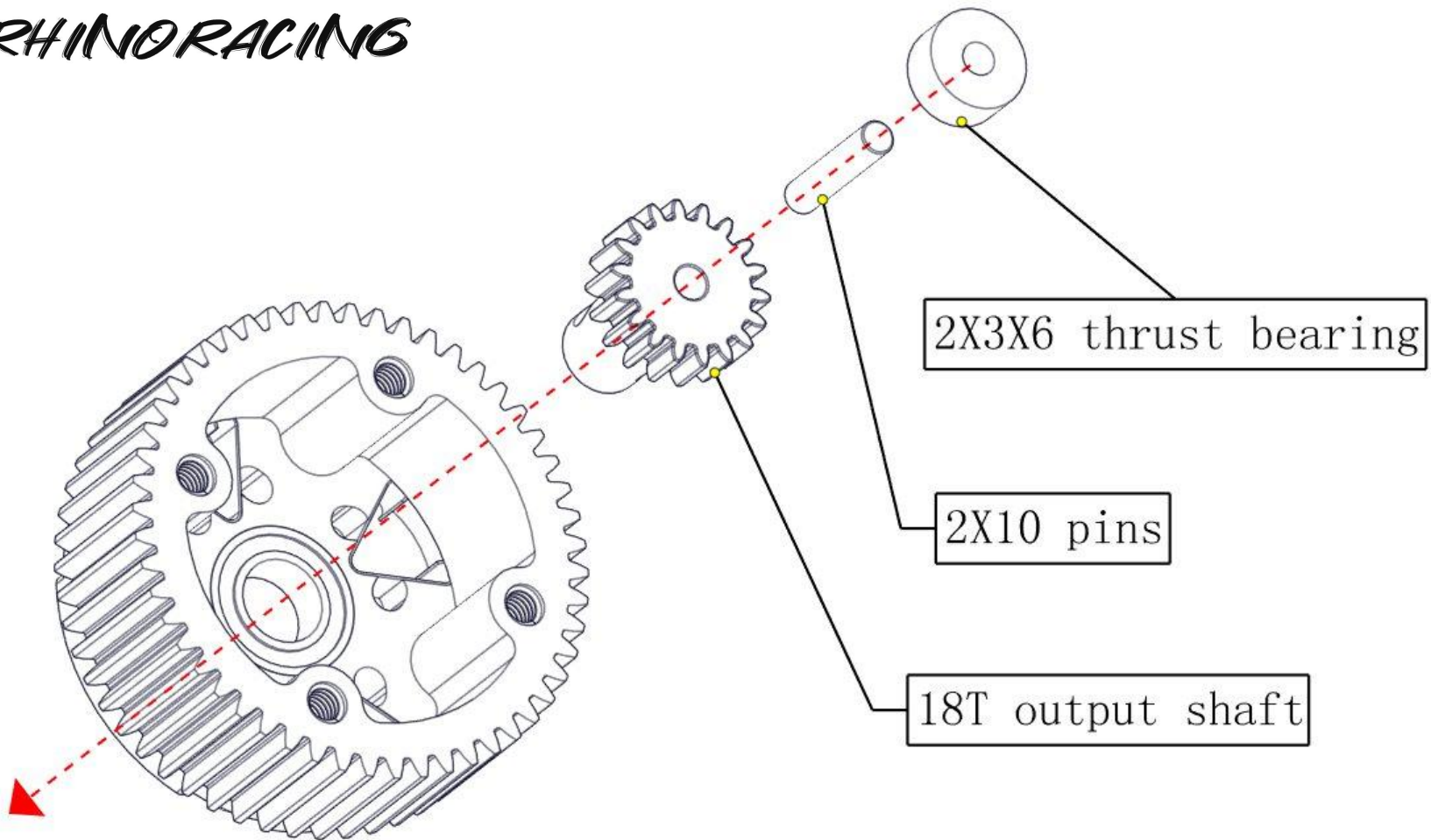



RHINORACING

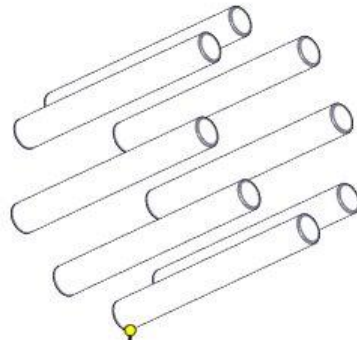
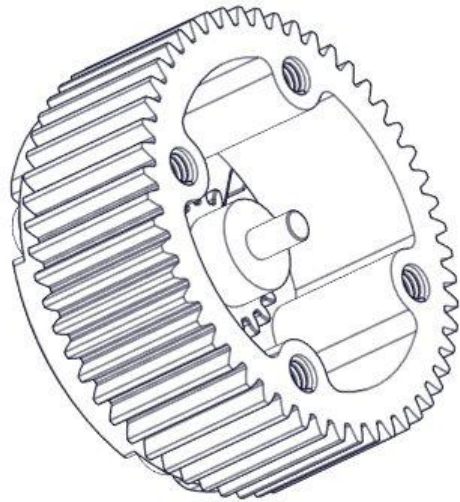

pinion pin

9T pinion

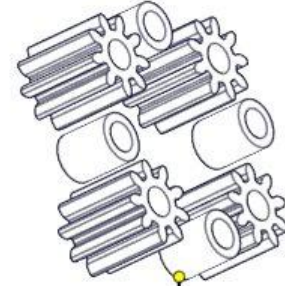
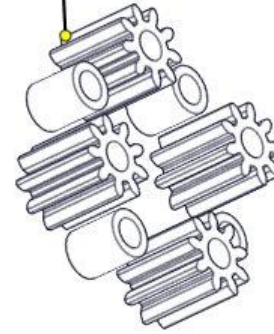

Pinion height limit gasket

The full load is 4 sets of pinions. 2 or 4 sets of installation can be selected.
(2 groups of limited slip strength are small, 4 groups of limited slip strength are strong)
Choose according to the track or personal habits.

After all gears are assembled, a little anti-wear oil needs to be applied to the surface of the gears.

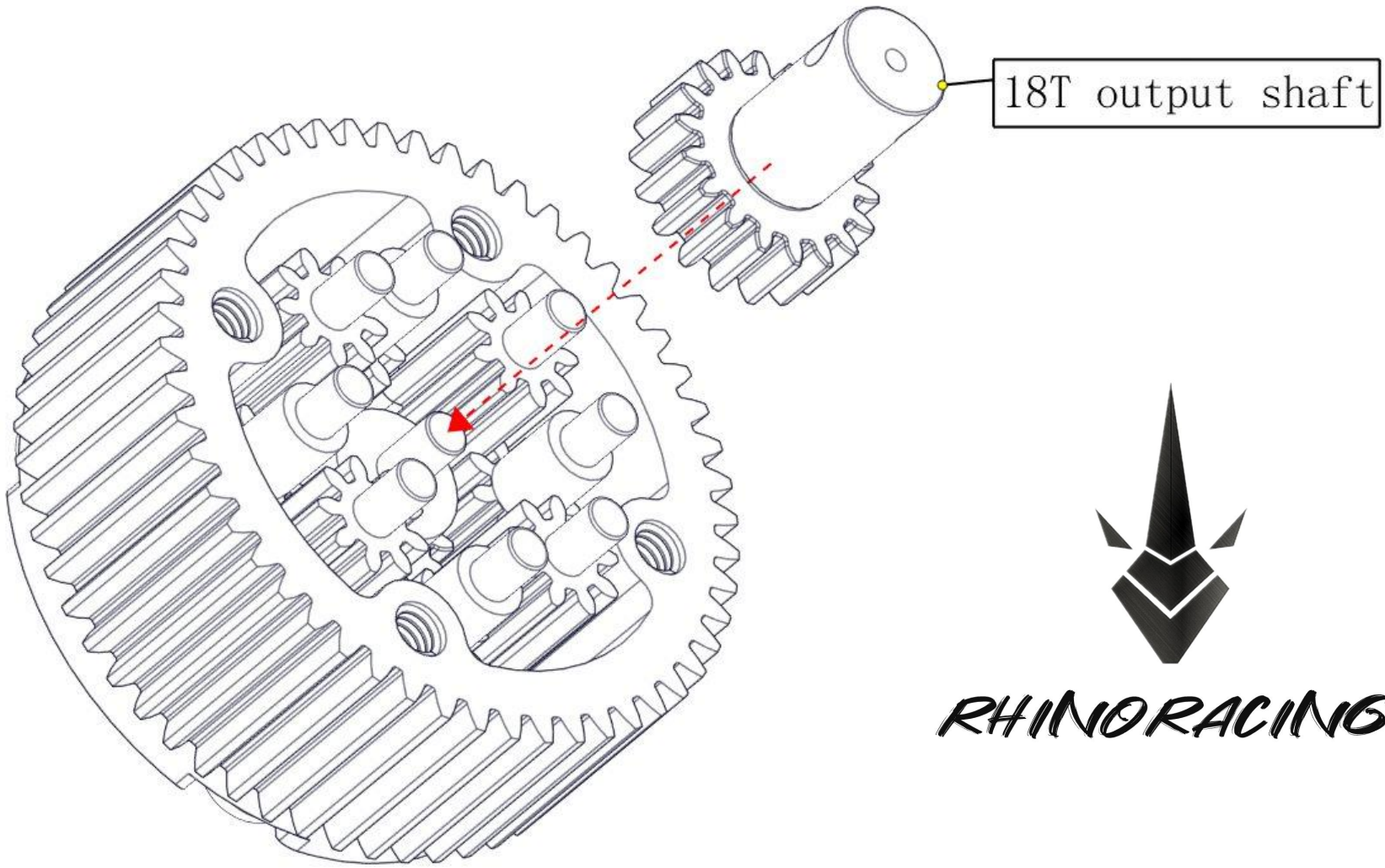

RHINORACING

Notice! Because the pinion pin is only fixed at one end at this time, and the other end shakes to generate a large gap, which causes the 18T output shaft to be installed at the large gap position by mistake. Therefore, the second 18T output shaft needs to be carefully aligned with the gear during installation.



RHINORACING

4 X M2.5X6

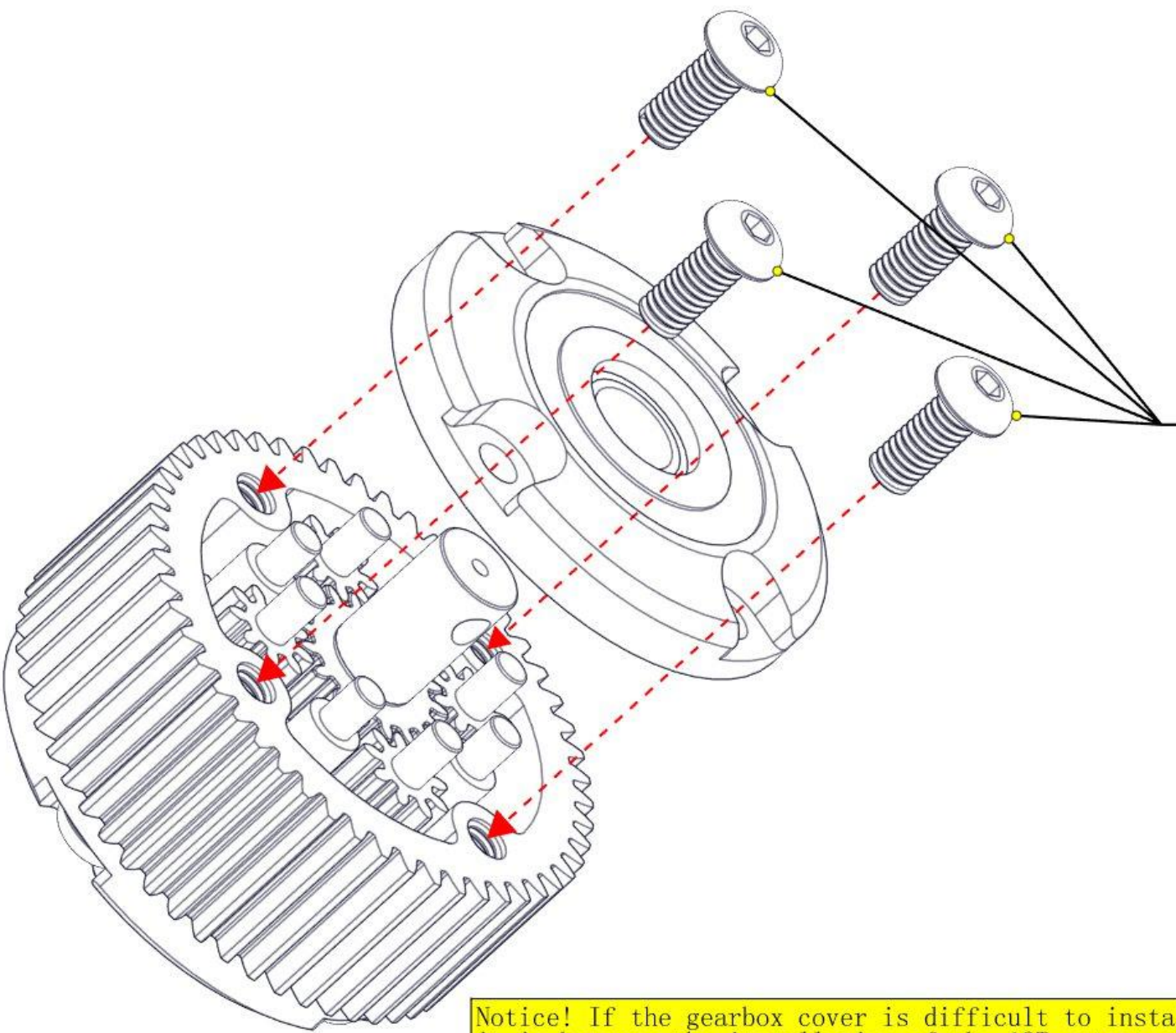

Notice! If the gearbox cover is difficult to install, it is because the installation of the 18T output shaft is wrong, please check again whether the installation of the 18T output shaft is correct. Finally, install and fix the gearbox cover.

output cup

5X10X0.2 gasket

5X7 O-ring

2X10 pins

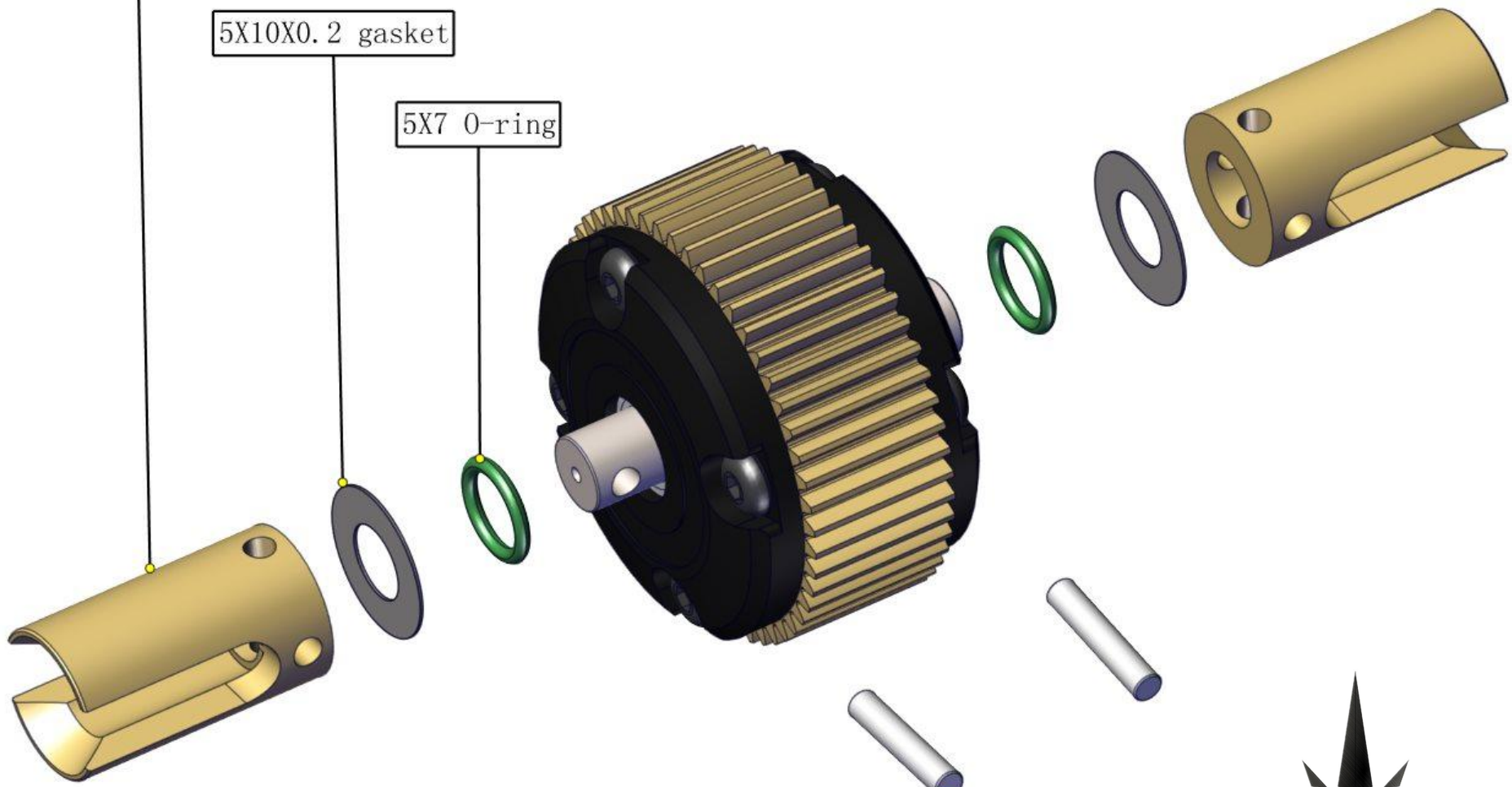

RHINORACING

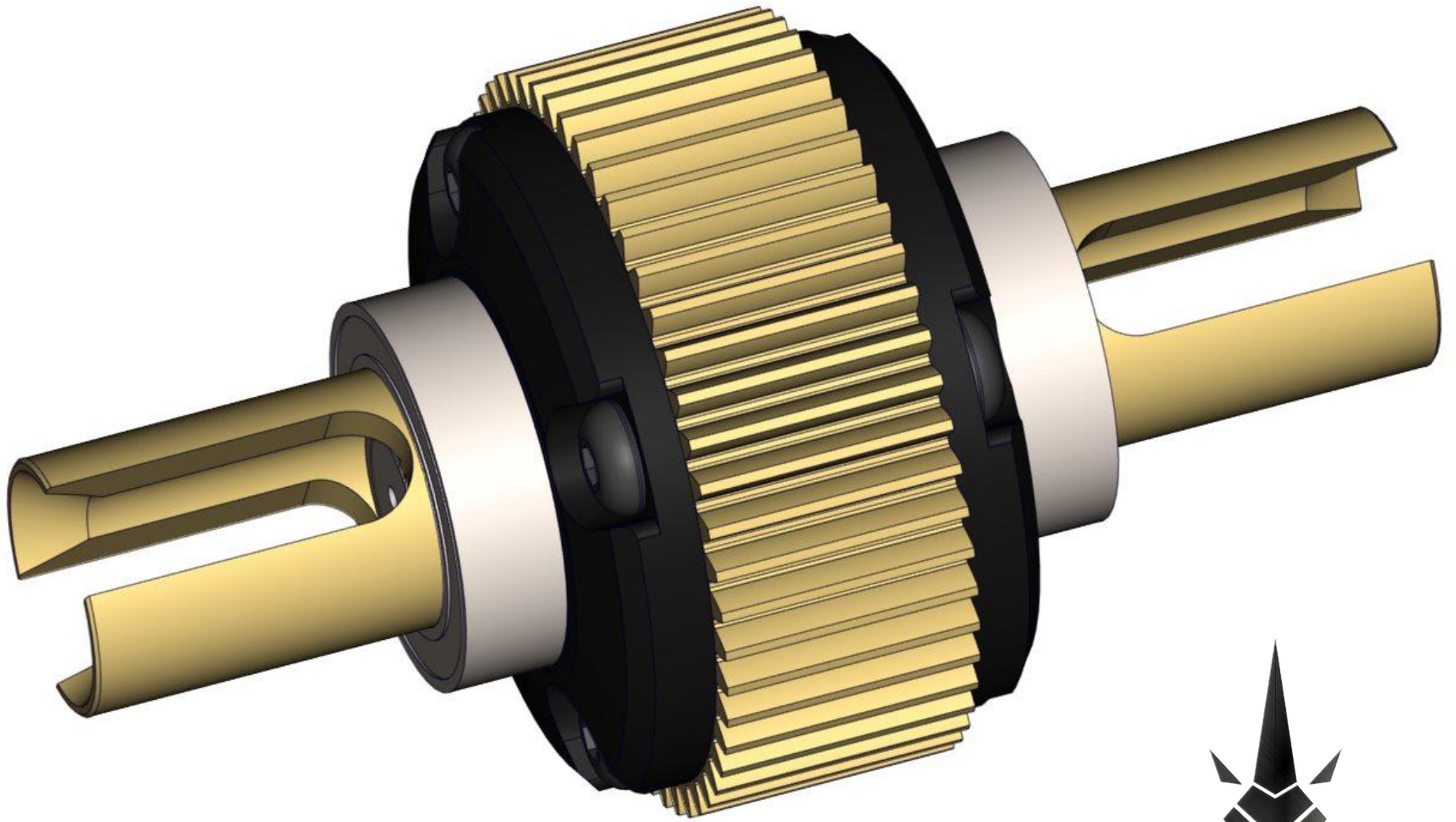

RHINORACING