

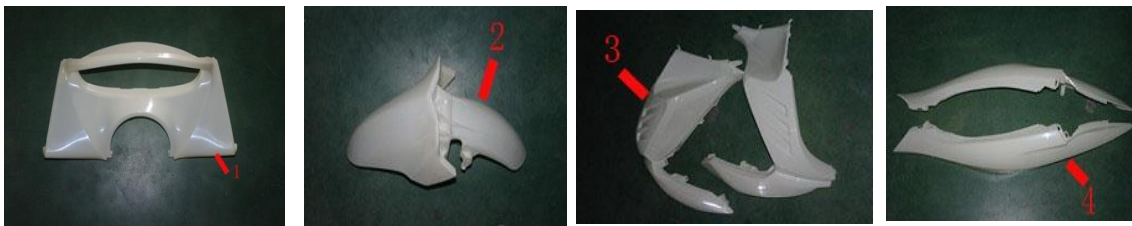

NO.	ICEBEAR PARTS NO.	Description	Chinese name	QTY
1	PST50-17-A-001	Front panel	前面板	1
2	PST50-17-A-002	Front trim panel plate	前装饰板连接板	1
3	PST50-17-A-003	Front panel trim	前面板装饰条	1
4	PST50-17-A-004	middle cover, toolbox	工具箱中间盖	1



NO.	ICEBEAR PARTS NO.	Description	Chinese name	QTY
1	PST50-17-B-001	Cover, meter	仪表壳	1
2	PST50-17-B-002	Front tire fender	前轮泥板	1
3	PST50-17-B-003	left and right front trim panel	左右前装饰板	1
4	PST50-17-B-004	Left and right side plates	左右侧板	1



NO.	ICEBEAR PARTS NO.	Description	Chinese name	QTY
1	PST50-17-C-001	Left and right decoration	左右边条	1
2	PST50-17-C-002	Rear carrier cover	后货架上盖	1
3	PST50-17-C-003	Left toolbox inner lid	左工具箱内盖	1
4	PST50-17-C-004	Left toolbox lid	左工具箱外盖	1





NO.	ICEBEAR PARTS NO.	Description	Chinese name	QTY
1	PST50-17-D-001	Inner board, Front cover	面板内罩,仪表前罩	1
2	PST50-17-D-002	Left toolbox button	左工具箱按钮	1
3	PST50-17-D-003	Toolbox	工具箱	1
4	PST50-17-D-004	Left toolbox inner lid holder	左工具箱内盖固定座	1
5	PST50-17-D-005	Cover, Lock	电门锁盖	1



NO.	ICEBEAR PARTS NO.	Description	Chinese name	QTY
1	PST50-17-E-001	Fuel tank cap decorative ring	油箱盖装饰圈	1
2	PST50-17-E-002	decorative ring, Lock	电门锁装饰圈	1
3	PST50-17-E-003	Fuel tank board	油箱盖板	1
4	PST50-17-E-004	Air fence	通风栅	1



NO.	ICEBEAR PARTS NO.	Description	Chinese name	QTY
1	PST50-17-F-001	rocker, Fuel tank cover	油箱盖板摇臂	1
2	PST50-17-F-002	Frame fender	车架底板	1
3	PST50-17-F-003	rocker holder, Fuel tank cover,	油箱盖板摇臂固定座	1
4	PST50-17-F-004	Main seat box	主座桶	1



NO.	ICEBEAR PARTS NO.	Description	Chinese name	QTY
1	PST50-17-G-001	footplate	左右脚踏板	2
2	PST50-17-G-002	Little cover, seat box	主座桶小盖	1
3	PST50-17-G-003	Little board, Left footplate	左脚踏板小盖	1
4	PST50-17-G-004	Cover, Battery box	电瓶盒盖	1



NO.	ICEBEAR PARTS NO.	Description	Chinese name	QTY
1	PST50-17-H-001	Rear fender	后挡泥板	1
2	PST50-17-H-002	Small intake pipe lid	进气管小盖	1



NO.	ICEBEAR PARTS NO.	Description	Chinese name	QTY
1	PST50-17-I-001	Plastic fastener	塑件安装扣	4
2	PST50-17-I-002	Chrome	压紧座螺丝装饰盖	4
3	PST50-17-I-003	Expansion screws	膨胀螺丝	2
4	PST50-17-I-004	Rear reflector	后反射器	1



NO.	ICEBEAR PARTS NO.	Description	Chinese name	QTY
1	PST50-17-J-001	Upper clamping seat ring decoration	压紧座装饰圈上部	1
2	PST50-17-J-002	Headlight	前大灯	1

3	PST50-17-J-003	Lower clamping seat ring decoration	压紧座装饰圈下部	1
4	PST50-17-J-004	After the left and right turn signal	后左右转向灯	2
5	PST50-17-J-005	Taillights	后尾灯	1



NO.	ICEBEAR PARTS NO.	Description	Chinese name	QTY
1	PST50-17-K-001	Headlight bracket	大灯支架	1
2	PST50-17-K-002	Rear registration plate lamps	后牌照灯	1
3	PST50-17-K-003	Left and right pedal bracket	左右脚踏板支架	2
4	PST50-17-K-004	Cushion	坐垫	1



NO.	ICEBEAR PARTS NO.	Description	Chinese name	QTY
1	PST50-17-L-001	Front bracket of fuel tank cap	油箱盖前支架	1
2	PST50-17-L-002	Frame	车架	1
3	PST50-17-L-003	Front bracket of main seat barrel	主座桶前支架	1
4	PST50-17-L-004	Direction handle	方向把	1
5	PST50-17-L-005	Upper Lower handle clamping seat	把手压紧座上下部	2

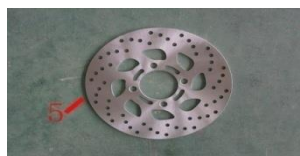
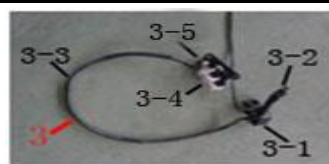

NO.	ICEBEAR PARTS NO.	Description	Chinese name	QTY
1	PST50-17-M-001	Second line board	下联板	1
2	PST50-17-M-002	Steel bowl	钢碗	1
3	PST50-17-M-003	Front disc brakes	前碟刹	1
3-1	PST50-17-M-004	Master cylinder	碟刹上泵	1
3-2	PST50-17-M-005	brake lever	碟刹手柄	1
3-3	PST50-17-M-006	Brake Line	碟刹油管	1
3-4	PST50-17-M-007	Brake Caliper	碟刹下泵	1
3-5	PST50-17-M-008	Brake Pad	摩擦片	2
4	PST50-17-M-009	Front left and right shock absorber	前左右减震器	2
5	PST50-17-M-010	Front disc tray	前碟刹盘	1



NO.	ICEBEAR PARTS NO.	Description	Chinese name	QTY
1	PST50-17-N-001	Left and right foot support	左右脚踏	2
2	PST50-17-N-002	Fuel tank cover spring	油箱盖板弹簧	1
3	PST50-17-N-003	Rear rack	后货架	1
4	PST50-17-N-004	LCD dashboard	液晶仪表	1



NO.	ICEBEAR PARTS NO.	Description	Chinese name	QTY
1	PST50-17-O-001	Set of locks	套锁	1
2	PST50-17-O-002	Front wheel rim	前轮辋	1
3	PST50-17-O-003	speedo gear	转速器	1
4	PST50-17-O-004	Front tire	前轮胎	1



NO.	ICEBEAR PARTS NO.	Description	Chinese name	QTY
1	PST50-17-P-001	Left and right handle switch	左右把手开关	1
2	PST50-17-P-002	Fuel tank	油箱	1
3	PST50-17-P-003	Oil level sensor	油位传感器	1
4	PST50-17-P-004	Fuel tank cap	油箱盖	1
5	PST50-17-P-005	Vacuum pump	负压泵	1

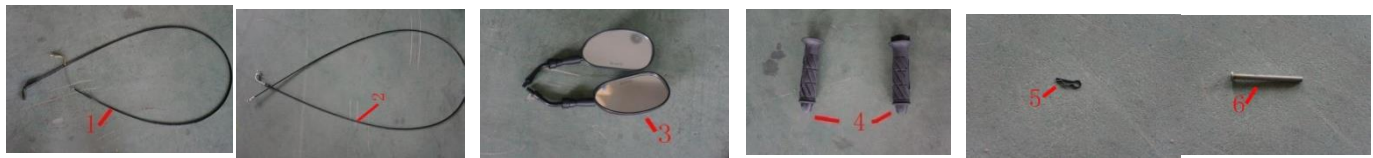

NO.	ICEBEAR PARTS NO.	Description	Chinese name	QTY
1	PST50-17-Q-001	Throttle cable	油门线	1
2	PST50-17-Q-002	Seat lock cable	座垫锁线	1
3	PST50-17-Q-003	Rearview mirror	后视镜	2
4	PST50-17-Q-004	Left and right handle cap	左右把套	2
5	PST50-17-Q-005	Wavy cotter pin	波浪开口销	1
6	PST50-17-Q-006	Fuel tank cap pin	油箱盖板销轴	1



NO.	ICEBEAR PARTS NO.	Description	Chinese name	QTY
1	PST50-17-R-001	Left and right pedal cover	左右脚踏皮	2
3	PST50-17-R-002	Headlight bracket rubber ring	大灯支架橡胶圈	1
4	PST50-17-R-003	Fuel tank rubber ring	油箱橡胶圈	1
5	PST50-17-R-004	Panel rubber ring	面板橡胶圈	1
6	PST50-17-R-005	Fuel tank bushing	油箱衬套	1

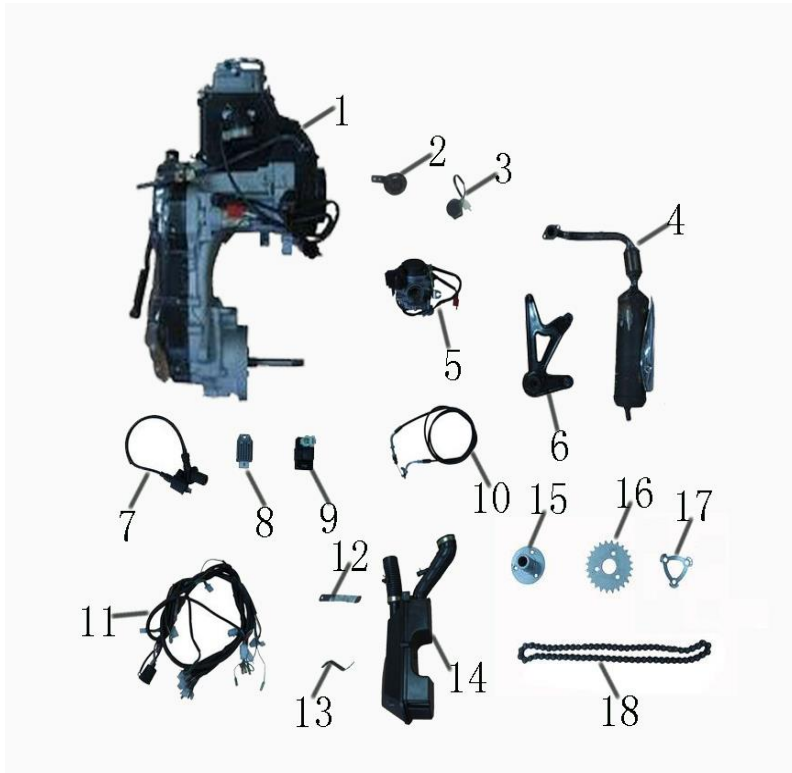

NO.	ICEBEAR PARTS NO.	Description	Chinese name	QTY
1	PST50-17-S-001	engine	发动机	1
2	PST50-17-S-002	horn	喇叭	1
3	PST50-17-S-003	flasher	闪光器	1
4	PST50-17-S-004	muffler	消音器	1
5	PST50-17-S-005	carburator	化油器	1
6	PST50-17-S-006	engine connect plate	动力连接板	1
7	PST50-17-S-007	ignition coil	高压包	1
8	PST50-17-S-008	regulator	稳压器	1
9	PST50-17-S-009	ignition	点火器	1
10	PST50-17-S-010	throttle cable	油门线	1
11	PST50-17-S-011	harness	电缆	1
12	PST50-17-S-012	air filter holder 1	空滤支架1	1
13	PST50-17-S-013	air filter holder 2	空滤支架2	1
14	PST50-17-S-014	air filter	空滤器	1
15	PST50-17-S-015	sprocket holder	链轮座	1
16	PST50-17-S-016	sprocket	链轮	1
17	PST50-17-S-017	sprocket locker	链轮锁片	1
18	PST50-17-S-018	chain	链条	1

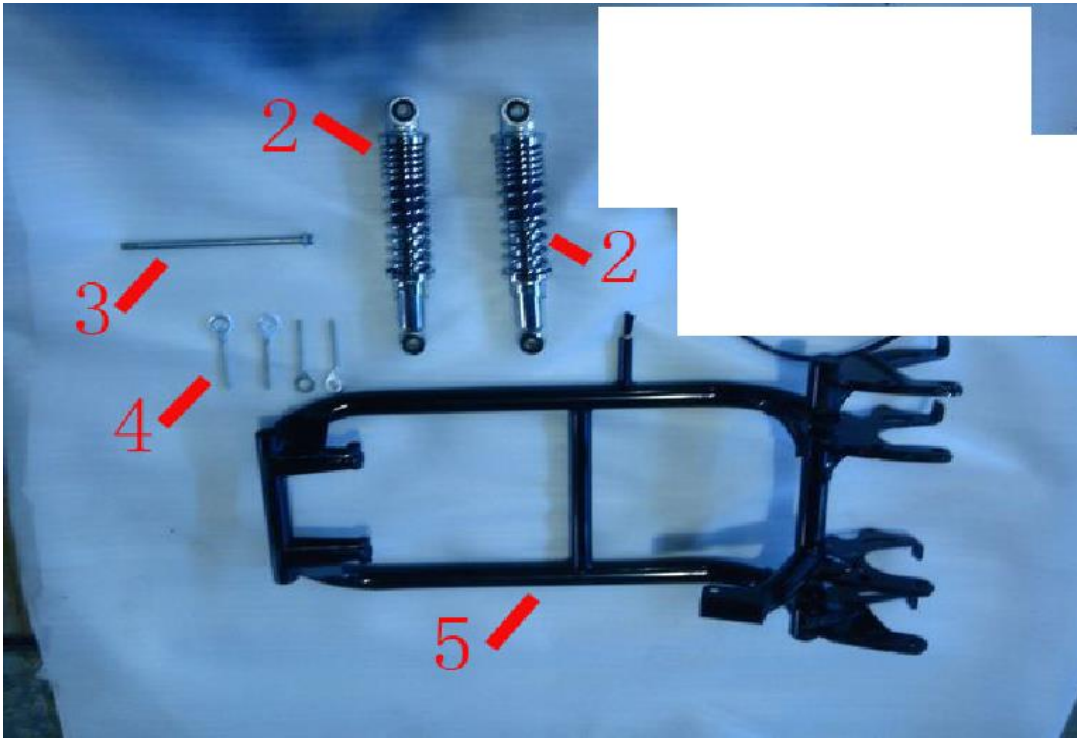

NO.	ICEBEAR PARTS NO.	Description	Chinese name	QTY
2	PST50-17-T-001	rear shock	后减震	2
3	PST50-17-T-002	swing arm axle	后平叉轴	1
4	PST50-17-T-003	chain adjuster	调链器	2
5	PST50-17-T-004	rear swing	后平叉	1

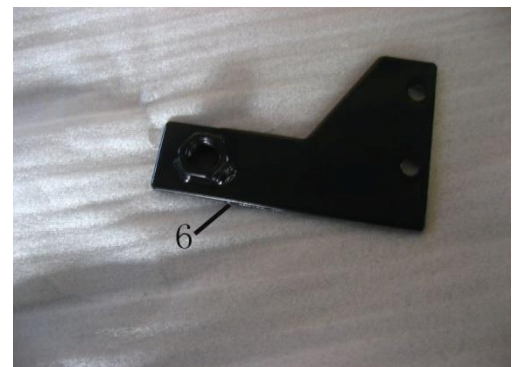
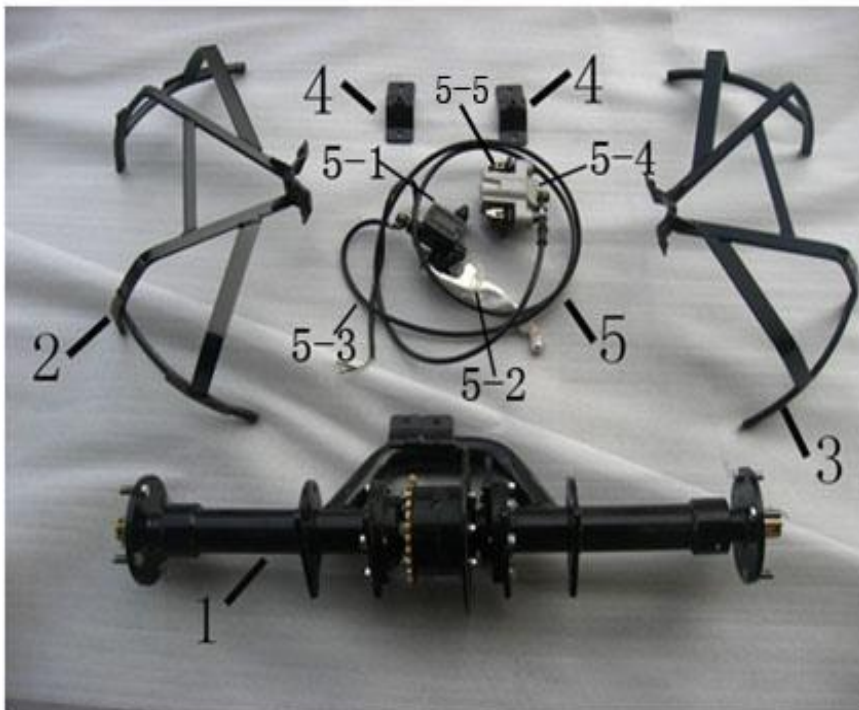

NO.	ICEBEAR PARTS NO.	Description	Chinese name	QTY
1	PST50-17-U-001	differential gear	差速器	1
2	PST50-17-U-002	rear fender bracket LH	左后泥板支架	1
3	PST50-17-U-003	rear fender bracket RH	右后泥板支架	1
4	PST50-17-U-004	rear fender bracket upper	后泥板支架压板	2
5	PST50-17-U-005	rear disc brake	后碟刹	1
5-1	PST50-17-U-006	Master cylinder	碟刹上泵	1
5-2	PST50-17-U-007	brake lever	碟刹手柄	1
5-3	PST50-17-U-008	Brake Line	碟刹油管	1
5-4	PST50-17-U-009	Brake Caliper	碟刹下泵	1
5-5	PST50-17-U-010	Brake Pad	摩擦片	2
6	PST50-17-U-011	plate	挂钩板	1

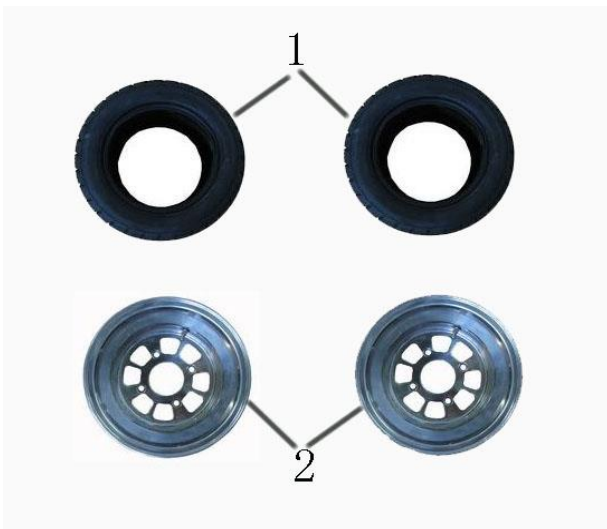

NO.	ICEBEAR PARTS NO.	Description	Chinese name	QTY
1	PST50-17-V-001	rear tire	后轮胎	2
2	PST50-17-V-002	rear wheel	后轮毂	2



NO.	ICEBEAR PARTS NO.	Description	Chinese name	QTY
1	PST50-17-W-001	battery	蓄电池	1
2	PST50-17-W-002	electrolyte	电解液	1
3	PST50-17-W-003	parts for installation	安装附件	1



NO.	ICEBEAR PARTS NO.	Description	Chinese name	QTY
1	PST50-17-X-001	REAR FENDER	后泥板	2



NO.	ICEBEAR PARTS NO.	Description	Chinese name	QTY
1	PST50-17-Y-001	WINDSHIELD	挡风玻璃	1



NO.	ICEBEAR PARTS NO.	Description	Chinese name	QTY
1	PST50-17-Z-001	trunk	尾箱	1
2	PST50-17-Z-002	trunk holder	尾箱底板	1