

PART 1:



NO.	ICEBEAR PARTS NO.	Factory PARTS NO.	Description	Chinese name	QTY
1	PMZ50-M1-A-001	ZH-M1-1-01	Front Fender	前挡泥板	1
2	PMZ50-M1-A-002	ZH-M1-1-02	Turn Signal Stand	前左右转向灯支架	2
3	PMZ50-M1-A-003	ZH-M1-1-03	Top Trim Panel on Shield	护罩上装饰盖	2
4	PMZ50-M1-A-004	ZH-M1-1-04	Trim Panel on Side Cover	侧盖装饰盖	2
5	PMZ50-M1-A-005	ZH-M1-1-05	Tail Cover	尾罩	2
6	PMZ50-M1-A-006	ZH-M1-1-06	Bottom Trim Panel on Shield	护罩下装饰盖	2
7	PMZ50-M1-A-007	ZH-M1-1-07	Top Side Cover	侧盖上段	2
8	PMZ50-M1-A-008	ZH-M1-1-08	Front Side Cover	侧盖前段	2
9	PMZ50-M1-A-009	ZH-M1-1-09	Head Lamp Mask	大灯护罩	1
10	PMZ50-M1-A-010	ZH-M1-1-10	Rear Side Cover	侧盖后段	2

PART 2:



NO.	ICEBEAR PARTS NO.	Factory PARTS NO.	Description	Chinese name	QTY
1	PMZ50-M1-B-001	ZH-M1-2-01	Web	腹板	1
2	PMZ50-M1-B-002	ZH-M1-2-02	Battery Frame	电池盒	1
3	PMZ50-M1-B-003	ZH-M1-2-03	Rear Fender	后挡泥板	1
4	PMZ50-M1-B-004	ZH-M1-2-04	Rear Fender Bottem Cover	后挡泥板下罩	1
5	PMZ50-M1-B-005	ZH-M1-2-05	Tair Cover	尾盖	1
6	PMZ50-M1-B-006	ZH-M1-2-06	Inner Cover for Fuel Tank	油箱内罩	1
7	PMZ50-M1-B-007	ZH-M1-2-07	Front Cover	前罩	1
8	PMZ50-M1-B-008	ZH-M1-2-08	Top Cover for Fuel Tank	油箱上罩	1
9	PMZ50-M1-B-009	ZH-M1-2-09	Front Shield	前护罩	2
10	PMZ50-M1-B-010	ZH-M1-2-10	Side Cover Stand	侧板支架	2
11	PMZ50-M1-B-011	ZH-M1-2-11	Lock Bracket	车锁支架	1
12	PMZ50-M1-B-012	ZH-M1-2-12	Lock Holder	车锁固定件	2

PART 3:



NO.	ICEBEAR PARTS NO.	Factory PARTS NO.	Description	Chinese name	QTY
1	PMZ50-M1-C-001	ZH-M1-3-01	Main Frame	主车架	1

PART 4:

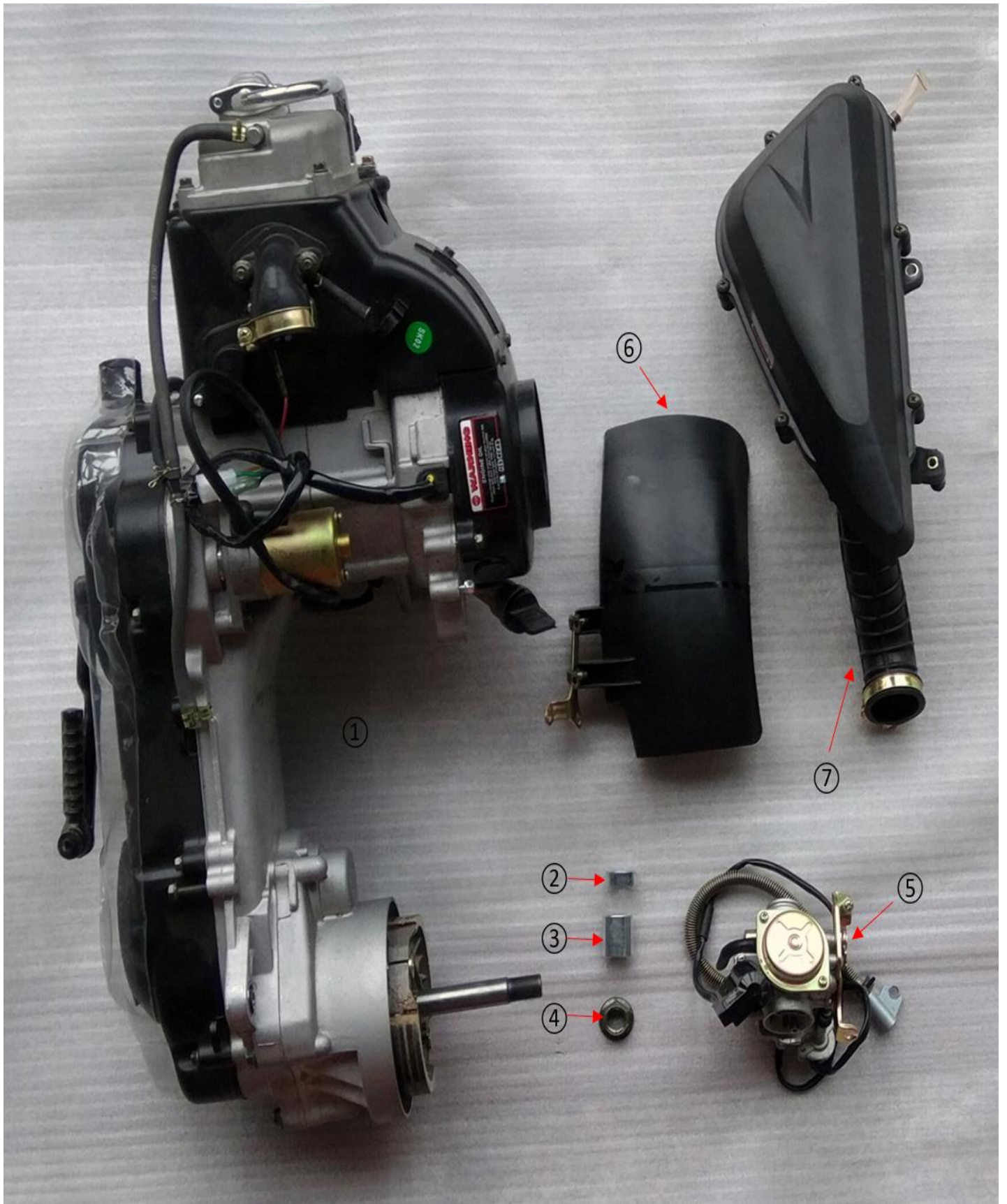

NO.	ICEBEAR PARTS NO.	Factory PARTS NO.	Description	Chinese name	QTY
1	PMZ50-M1-D-001	ZH-M1-4-01	Engine ASSY	发动机总成	1
2	PMZ50-M1-D-002	ZH-M1-4-02	Outer Bush	外衬套	1
3	PMZ50-M1-D-003	ZH-M1-4-03	Inner Bush	内衬套	1

4	PMZ50-M1-D-004	ZH-M1-4-04	Nut	螺母	1
5	PMZ50-M1-D-005	ZH-M1-4-05	Caburetor	化油器	1
6	PMZ50-M1-D-006	ZH-M1-4-06	Rear Fender	后挡泥板	1
7	PMZ50-M1-D-007	ZH-M1-4-07	Air Filter	空气滤清器	1

PART 5:

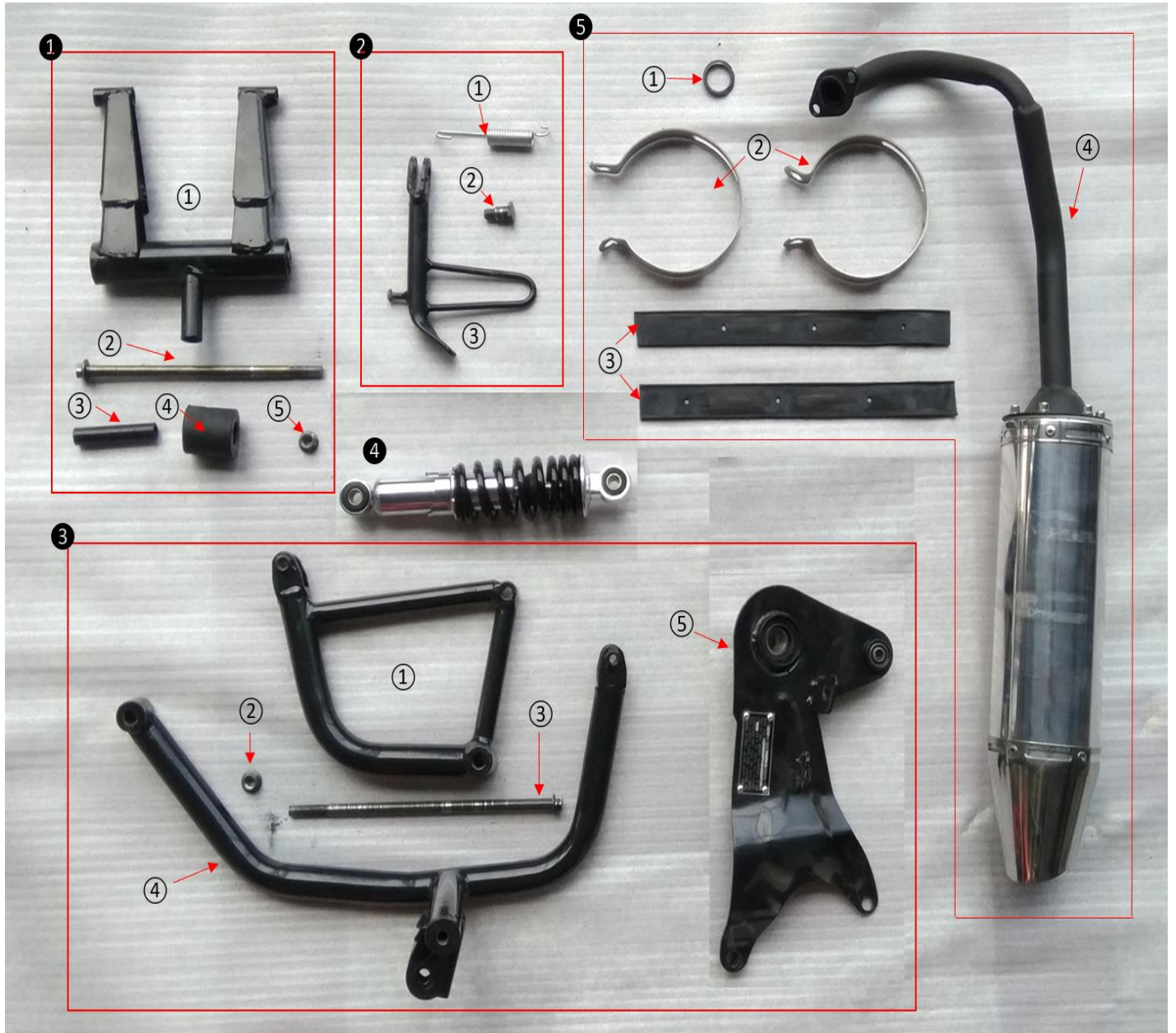

NO.	ICEBEAR PARTS NO.	Factory PARTS NO.	Description	Chinese name	QTY
1-1	PMZ50-M1-E-001	ZH-M1-5-01-01	Rear Swing Arm	后摇臂	1
1-2	PMZ50-M1-E-002	ZH-M1-5-01-02	Shaft to Engine	发动机连接轴	1
1-3	PMZ50-M1-E-003	ZH-M1-5-01-03	Bush	衬套	1
1-4	PMZ50-M1-E-004	ZH-M1-5-01-04	Rubber Damping Ring	减震胶圈	1
1-5	PMZ50-M1-E-005	ZH-M1-5-01-05	Nut	螺母	1
2-1	PMZ50-M1-E-006	ZH-M1-5-02-01	Tension Spring	拉簧	1
2-2	PMZ50-M1-E-007	ZH-M1-5-02-02	Fix Bolt	固定螺栓	1
2-3	PMZ50-M1-E-008	ZH-M1-5-02-03	Kick Stand	单撑	1
3-1	PMZ50-M1-E-009	ZH-M1-5-03-01	Right Frame for Engine	发动机右吊架	1

3-2	PMZ50-M1-E-010	ZH-M1-5-03-02	Nut	螺母	1
3-3	PMZ50-M1-E-011	ZH-M1-5-03-03	Shaft for Engine	发动机吊装轴	1
3-4	PMZ50-M1-E-012	ZH-M1-5-03-04	Left Frame for Engine	发动机左吊架	1
3-5	PMZ50-M1-E-013	ZH-M1-5-03-05	Rear ASSY plate	后轮联板	1
4	PMZ50-M1-E-014	ZH-M1-5-04-01	Rear Shock Absorber	后减震	1
5-1	PMZ50-M1-E-015	ZH-M1-5-05-01	Gasket on Exhaust	消音器垫圈	1
5-2	PMZ50-M1-E-016	ZH-M1-5-05-02	Exhaust Holder	消音器卡箍	2
5-3	PMZ50-M1-E-017	ZH-M1-5-05-03	Rubber Gasket	胶皮垫片	2
5-4	PMZ50-M1-E-018	ZH-M1-5-05-04	Exhaust	消音器	1

PART 6:

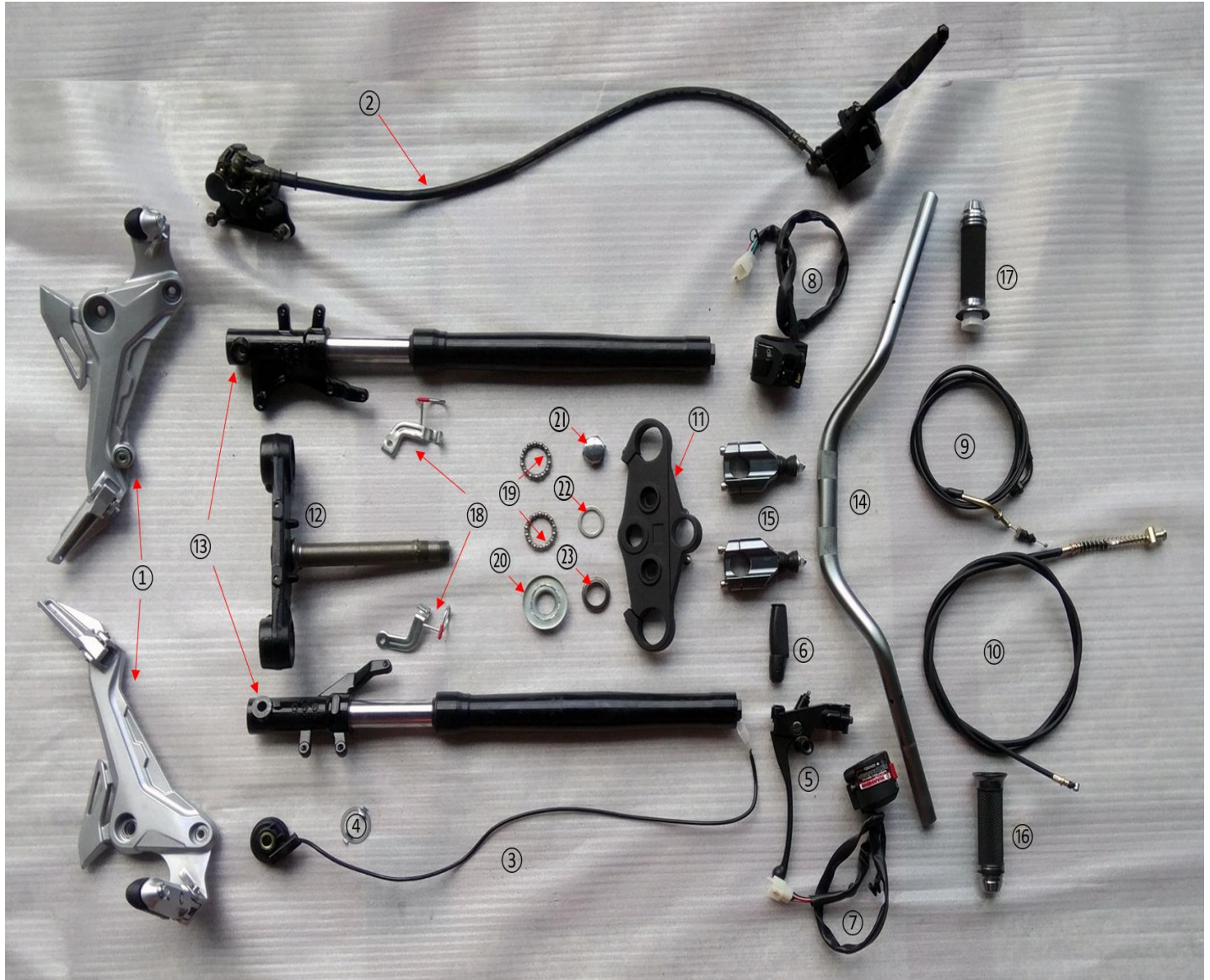

NO.	ICEBEAR PARTS NO.	Factory PARTS NO.	Description	Chinese name	QTY
1	PMZ50-M1-F-001	ZH-M1-6-01	Pedal	脚踏	2
2	PMZ50-M1-F-002	ZH-M1-6-02	Front Break ASSY	前碟刹总成	1
3	PMZ50-M1-F-003	ZH-M1-6-03	Speed Senser	计速感应器	1
4	PMZ50-M1-F-004	ZH-M1-6-04	Clip	卡口圈	1
5	PMZ50-M1-F-005	ZH-M1-6-05	Rear Break Lever	后鼓刹手柄	1
6	PMZ50-M1-F-006	ZH-M1-6-06	Sheath for Lever	皮套	1
7	PMZ50-M1-F-007	ZH-M1-6-07	Left Switch	左开关	1

8	PMZ50-M1-F-008	ZH-M1-6-08	Right Switch	右开关	1
9	PMZ50-M1-F-009	ZH-M1-6-09	Fuel Trottle Cable	油门线	1
10	PMZ50-M1-F-010	ZH-M1-6-10	Rear Break Cable	后制动线	1
11	PMZ50-M1-F-011	ZH-M1-6-11	Steering Head	上联版	1
12	PMZ50-M1-F-012	ZH-M1-6-12	Steering Stem	转向柱	1
13	PMZ50-M1-F-013	ZH-M1-6-13	Shock Absorber	前减震	2
14	PMZ50-M1-F-014	ZH-M1-6-14	Handbar	手把	1
15	PMZ50-M1-F-015	ZH-M1-6-15	Fixture Block	手把卡块	2
16	PMZ50-M1-F-016	ZH-M1-6-16	Left Grip	左手把套	1
17	PMZ50-M1-F-017	ZH-M1-6-17	Right Trottle Grip	右手把油门转把	1
18	PMZ50-M1-F-018	ZH-M1-6-18	Harness Clamp	导线夹	2
19	PMZ50-M1-F-019	ZH-M1-6-19	Bearing Ball	轴承钢珠	2
20	PMZ50-M1-F-020	ZH-M1-6-20	Boot Cap	护罩	1
21	PMZ50-M1-F-021	ZH-M1-6-21	Head Nut	封头螺母	1
22	PMZ50-M1-F-022	ZH-M1-6-22	Washer	垫圈	1
23	PMZ50-M1-F-023	ZH-M1-6-23	Bearing Block	轴承座	1

PART 7·



NO.	ICEBEAR PARTS NO.	Factory PARTS NO.	Description	Chinese name	QTY
1	PMZ50-M1-G-001	ZH-M1-7-01	Front Tire (No Hub)	前轮胎(不含轮毂)	1
2	PMZ50-M1-G-002	ZH-M1-7-02	Rear Tire (No Hub)	后轮胎(不含轮毂)	1
3	PMZ50-M1-G-003	ZH-M1-7-03	Front Hub	前轮毂	1
4	PMZ50-M1-G-004	ZH-M1-7-04	Rear Hub	后轮毂	1
5	PMZ50-M1-G-005	ZH-M1-7-05	Break Disc	碟刹盘	1
6	PMZ50-M1-G-006	ZH-M1-7-06	Fix Screw	固定螺丝	4
7	PMZ50-M1-G-007	ZH-M1-7-07	Outer Bush	外衬套	1
8	PMZ50-M1-G-008	ZH-M1-7-08	Inner Bush	内衬套	1
9	PMZ50-M1-G-009	ZH-M1-7-09	Front Tire Axle	前轮轴	1

PART 8:



NO.	ICEBEAR PARTS NO.	Factory PARTS NO.	Description	Chinese name	QTY
1	PMZ50-M1-H-001	ZH-M1-8-01	Wiring Harness Assy	线束总成	1
2	PMZ50-M1-H-002	ZH-M1-8-02	Regulator	稳压器	1
3	PMZ50-M1-H-003	ZH-M1-8-03	Ignition Relay	启动继电器	1
4	PMZ50-M1-H-004	ZH-M1-8-04	Horn Bracket	喇叭支架	1
5	PMZ50-M1-H-005	ZH-M1-8-05	Horn	喇叭	1
6	PMZ50-M1-H-006	ZH-M1-8-06	Ignition Switch Lock	点火开关锁	1
7	PMZ50-M1-H-007	ZH-M1-8-07	Ignitor	点火器	1
8	PMZ50-M1-H-008	ZH-M1-8-08	Flasher	闪光器	1
9	PMZ50-M1-H-009	ZH-M1-8-09	Ignition coil	点火线圈	1
10	PMZ50-M1-H-010	ZH-M1-8-10	Fuel Tank Cap	油箱盖	1
11	PMZ50-M1-H-011	ZH-M1-8-11	Keys	钥匙	2
12	PMZ50-M1-H-012	ZH-M1-8-12	Headlamp	前大灯	1
13	PMZ50-M1-H-013	ZH-M1-8-13	Instrument Panel	仪表盘	1
14	PMZ50-M1-H-014	ZH-M1-8-14	Headlamp Bracket	前大灯支架	1
15	PMZ50-M1-H-015	ZH-M1-8-15	Rubber Washer	胶皮垫圈	3
16	PMZ50-M1-H-016	ZH-M1-8-16	Small Rubber Cap	小胶皮头	2
17	PMZ50-M1-H-017	ZH-M1-8-17	Big Rubber Cap	大胶皮头	2
18	PMZ50-M1-H-018	ZH-M1-8-18	Front Turn Signal	前转向灯	2
19	PMZ50-M1-H-019	ZH-M1-8-19	Rear Turn Signal	后转向灯	2
20	PMZ50-M1-H-020	ZH-M1-8-20	Reflecting Mirror	反射镜片	1
21	PMZ50-M1-H-021	ZH-M1-8-21	Break Light	刹车灯	1
22	PMZ50-M1-H-022	ZH-M1-8-22	Tail Light	后尾灯	1
23	PMZ50-M1-H-023	ZH-M1-8-23	Tail Light Bracket	尾灯支架	1

PART 9:



NO.	ICEBEAR PARTS NO.	Factory PARTS NO.	Description	Chinese name	QTY
1	PMZ50-M1-I-001	ZH-M1-9-01	Fuel Tank	油箱	1
2	PMZ50-M1-I-002	ZH-M1-9-02	Fuel-level Sensor	油位传感器	1
3	PMZ50-M1-I-003	ZH-M1-9-03	Fix Rubber	固定橡皮塞	2
4	PMZ50-M1-I-004	ZH-M1-9-04	Fix Bush	衬套	2
5	PMZ50-M1-I-005	ZH-M1-9-05	Fuel Tank Gasket	邮箱盖密封圈	1
6	PMZ50-M1-I-006	ZH-M1-9-06	Rubber Washer	胶皮垫圈	3
7	PMZ50-M1-I-007	ZH-M1-9-07	Fuel Hose & Filter	油管.过滤器	1

PART 10:



NO.	ICEBEAR PARTS NO.	Factory PARTS NO.	Description	Chinese name	QTY
1	PMZ50-M1-J-001	ZH-M1-10-01	Seat	座椅	1
2	PMZ50-M1-J-002	ZH-M1-10-02	Seat Lock	座椅锁	1
3	PMZ50-M1-J-003	ZH-M1-10-03	Seat Lock Latch	座椅锁闩	1
4	PMZ50-M1-J-004	ZH-M1-10-04	Seat Lock Wire	座椅锁线	1
5	PMZ50-M1-J-005	ZH-M1-10-05	Battery Box	电池	1
6	PMZ50-M1-J-006	ZH-M1-10-06	Battery Liquid	电池液	1
7	PMZ50-M1-J-007	ZH-M1-10-07	Rearview Mirror	后视镜	1
8	PMZ50-M1-J-008	ZH-M1-10-08	Rearview Mirror Screw	后视镜固定螺丝	1