

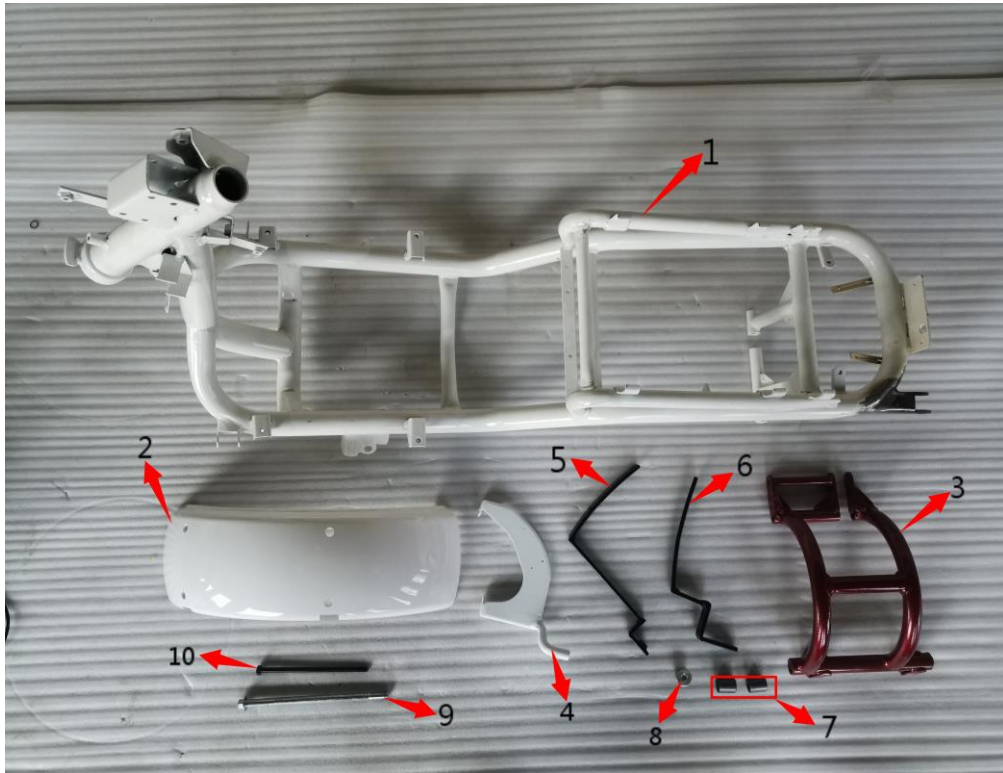

PMZ50-22 五代压低祖玛50两轮



| 序号 SR NO. | 件号 PART NO. | 名称 Description | 名称 Description | 数量 Qty |
|--------------|----------------|----------------------------|-------------------|-----------|
| 1 | PMZ50-22-A-1 | Frame | 车架 | 1 |
| 2 | PMZ50-22-A-2 | Rear fender | 后挡泥板 | 1 |
| 3 | PMZ50-22-A-3 | Hanger | 吊架 | 1 |
| 4 | PMZ50-22-A-4 | Muffler bracket | 消音器支架 | 1 |
| 5 | PMZ50-22-A-5 | Rear fender bracket, rear | 后泥板支架后 | 1 |
| 6 | PMZ50-22-A-6 | Rear fender bracket, front | 后泥板支架前 | 1 |
| 7 | PMZ50-22-A-7 | Hangger bushing | 吊架缓冲衬套 | 2 |
| 8 | PMZ50-22-A-8 | Step bushing | 台阶衬套 | 1 |

| | | | | |
|----|---------------|---------------------|-----------|---|
| 9 | PMZ50-22-A-9 | Hanger shaft 8*172 | 8*172吊架轴 | 1 |
| 10 | PMZ50-22-A-10 | Hanger shaft 10*215 | 10*215吊架轴 | 1 |

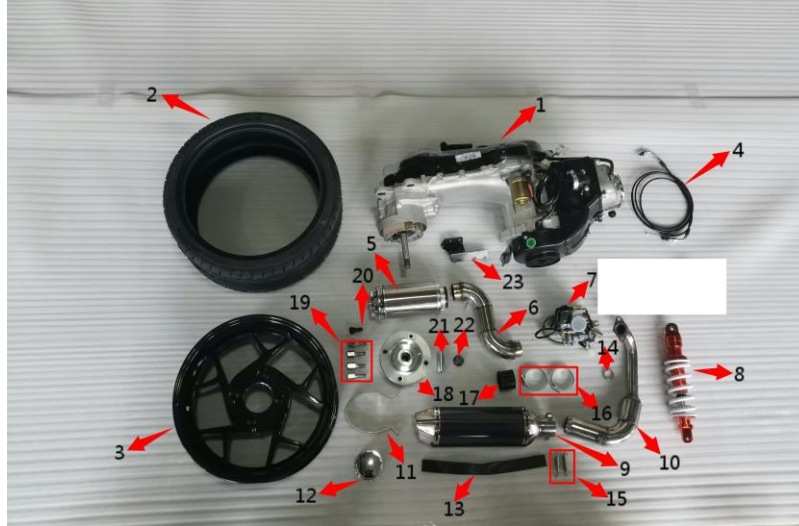

| 序号 SR NO. | 件号 PART NO. | 名称 Description | 名称 Description | 数量 Qty |
|--------------|----------------|------------------------------|-------------------|-----------|
| 1 | PMZ50-22-B-1 | Engine | 发动机 | 1 |
| 2 | PMZ50-22-B-2 | Rear tire | 后轮胎 | 1 |
| 3 | PMZ50-22-B-3 | Rear rim | 后轮钢圈 | 1 |
| 4 | PMZ50-22-B-4 | Throttle cable | 油门线 | 1 |
| 5 | PMZ50-22-B-5 | Air filter cartridge | 空滤筒子 | 1 |
| 6 | PMZ50-22-B-6 | Air filter bend | 空滤弯管 | 1 |
| 7 | PMZ50-22-B-7 | Carburetor | 化油器 | 1 |
| 8 | PMZ50-22-B-8 | Rear Shock | 后减 | 1 |
| 9 | PMZ50-22-B-9 | Muffler | 消音器筒子 | 1 |
| 10 | PMZ50-22-B-10 | Exhaust | 消音器弯管 | 1 |
| 11 | PMZ50-22-B-11 | Muffler clip | 消音器抱箍 | 1 |
| 12 | PMZ50-22-B-12 | Chrome decorative cover | 镀铬装饰盖 | 1 |
| 13 | PMZ50-22-B-13 | Muffler clamp leather | 消音器卡箍皮 | 1 |
| 14 | PMZ50-22-B-14 | Muffler washer | 消音器垫圈 | 1 |
| 15 | PMZ50-22-B-15 | Muffler spring | 消音器弹簧 | 1 |
| 16 | PMZ50-22-B-16 | Air filter clamp | 空滤卡箍 | 2 |
| 17 | PMZ50-22-B-17 | Air filter rubber connecting | 空滤橡胶接头 | 2 |
| 18 | PMZ50-22-B-18 | Rear wheel core | 后轮芯 | 1 |
| 19 | PMZ50-22-B-19 | Nut | 螺母 | 4 |
| 20 | PMZ50-22-B-20 | Tubeless valve | 气门嘴 | 1 |

| | | | | |
|----|---------------|---------------------------------|-------|---|
| 21 | PMZ50-22-B-21 | Rear wheel core supporting tube | 后轮芯撑管 | 1 |
| 22 | PMZ50-22-B-22 | M16 nut | M16螺母 | 1 |
| 23 | PMZ50-22-B-23 | Air filter bracket | 空滤支架 | 1 |



| 序号 SR NO. | 件号 PART NO. | 名称 Description | 名称 Description | 数量 Qty |
|--------------|----------------|----------------------------|-------------------|-----------|
| 1 | PMZ50-22-C-1 | Main wire | 导线总成 | 1 |
| 2 | PMZ50-22-C-2 | Headlight | 前大灯 | 1 |
| 3 | PMZ50-22-C-3 | Wind leaf decorative cover | 风叶装饰罩 | 1 |
| 4 | PMZ50-22-C-4 | Front turn signal lamp | 前转向灯片 | 2 |
| 5 | PMZ50-22-C-5 | Rear light | 后尾灯 | 1 |
| 6 | PMZ50-22-C-6 | Headlight bracket | 大灯支架 | 1 |
| 7 | PMZ50-22-C-7 | License plate light | 牌照灯 | 1 |
| 8 | PMZ50-22-C-8 | License plate bracket | 牌照支架 | 1 |
| 9 | PMZ50-22-C-9 | Speedometer | 仪表 | 1 |
| 10 | PMZ50-22-C-10 | Sensor | 传感器 | 1 |
| 11 | PMZ50-22-C-11 | Ignition coil | 高压泵 | 1 |
| 12 | PMZ50-22-C-12 | Starter relay | 启动继电器 | 1 |
| 13 | PMZ50-22-C-13 | Relay assy, tunsignal | 闪光器 | 1 |
| 14 | PMZ50-22-C-14 | Horn | 喇叭 | 1 |
| 15 | PMZ50-22-C-15 | Regulator | 稳压器 | 1 |
| 16 | PMZ50-22-C-16 | CDI | 点火器 | 1 |

| | | | | |
|----|---------------|-------------------------------|---------|---|
| 17 | PMZ50-22-C-17 | Turning light cover | 转向灯罩 | 2 |
| 18 | PMZ50-22-C-18 | Sensor bracket | 传感器支架 | 1 |
| 19 | PMZ50-22-C-19 | Speedometer bracket | 仪表支架 | 1 |
| 20 | PMZ50-22-C-20 | Special license plate bracket | 狂野的牌照支架 | 1 |
| 21 | PMZ50-22-C-21 | Ornamental buckle | 装饰扣 | 3 |

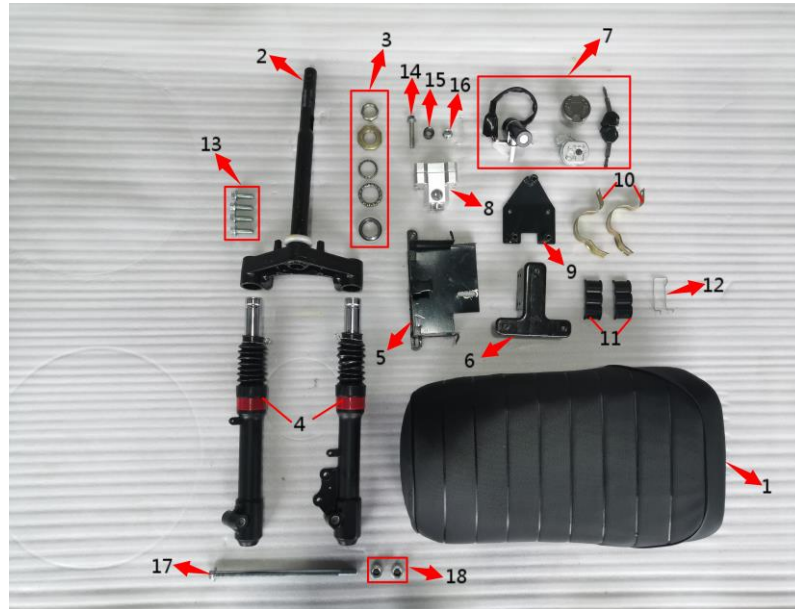

| 序号 SR NO. | 件号 PART NO. | 名称 Description | 名称 Description | 数量 Qty |
|--------------|----------------|----------------------------|-------------------|-----------|
| 1 | PMZ50-22-D-1 | Seat | 坐垫 | 1 |
| 2 | PMZ50-22-D-2 | Steering stem | 下联板 | 1 |
| 3 | PMZ50-22-D-3 | Steel bowl | 钢碗 | 5 |
| 4 | PMZ50-22-D-4 | Front shock | 前减 | 2 |
| 5 | PMZ50-22-D-5 | Holder, battery | 电瓶盒 | 1 |
| 6 | PMZ50-22-D-6 | Front shield install frame | 面板支架 | 1 |
| 7 | PMZ50-22-D-7 | Key set | 套锁 | 4 |
| 8 | PMZ50-22-D-8 | Handle guide | 把手座 | 1 |
| 9 | PMZ50-22-D-9 | Front fender bracket | 前泥板支架 | 1 |
| 10 | PMZ50-22-D-10 | Seat attachment 1 | 坐垫附件1 | 2 |
| 11 | PMZ50-22-D-11 | Seat attachment 2 | 坐垫附件2 | 2 |

| | | | | |
|----|---------------|--------------------|---------|---|
| 12 | PMZ50-22-D-12 | Seat attachment 3 | 坐垫附件3 | 1 |
| 13 | PMZ50-22-D-13 | 10*30 screw bolt | 10*30螺栓 | 4 |
| 14 | PMZ50-22-D-14 | 10*55 screw bolt | 10*55螺栓 | 1 |
| 15 | PMZ50-22-D-15 | Waist type bushing | 腰型衬套 | 1 |
| 16 | PMZ50-22-D-16 | M10 nut | M10螺母 | 1 |
| 17 | PMZ50-22-D-17 | Front axle | 前轮轴 | 1 |
| 18 | PMZ50-22-D-18 | front axle bushing | 前轮衬套 | 2 |



| 序号 SR NO. | 件号 PART NO. | 名称 Description | 名称 Description | 数量 Qty |
|--------------|----------------|---------------------|-------------------|-----------|
| 1 | PMZ50-22-E-1 | Latter guard shield | 前罩 | 1 |
| 2 | PMZ50-22-E-2 | Rear shield | 后罩 | 1 |
| 3 | PMZ50-22-E-3 | Front fender | 前泥板 | 1 |
| 4 | PMZ50-22-E-4 | Frame mud guard | 车架挡泥板 | 1 |
| 5 | PMZ50-22-E-5 | Cover under seat | 座垫下护板 | 1 |
| 6 | PMZ50-22-E-6 | Fuel tank cover | 油箱盖板 | 1 |



| 序号 SR NO. | 件号 PART NO. | 名称 Description | 名称 Description | 数量 Qty |
|--------------|----------------|----------------------|-------------------|-----------|
| 1 | PMZ50-22-F-1 | Fuel tank | 油箱 | 1 |
| 2 | PMZ50-22-F-2 | Rear mirror LH | 左后视镜 | 1 |
| 3 | PMZ50-22-F-3 | Rear mirror RH | 右后视镜 | 1 |
| 4 | PMZ50-22-F-4 | Lfet hand grip | 左胶套 | 1 |
| 5 | PMZ50-22-F-5 | Throttle grip | 油门胶套 | 1 |
| 6 | PMZ50-22-F-6 | Left control panel | 左开关 | 1 |
| 7 | PMZ50-22-F-7 | Right control panel | 右开关 | 1 |
| 8 | PMZ50-22-F-8 | Handlebar | 方向把 | 1 |
| 9 | PMZ50-22-F-9 | Rear brake cable | 后刹线 | 1 |
| 10 | PMZ50-22-F-10 | Front footpeg | 前脚蹬 | 2 |
| 11 | PMZ50-22-F-11 | Front footpeg spring | 前脚蹬弹簧 | 2 |
| 12 | PMZ50-22-F-12 | Front footpeg pin | 前脚蹬销子 | 2 |
| 13 | PMZ50-22-F-13 | Kick stand | 单撑 | 1 |
| 14 | PMZ50-22-F-14 | Kick stand bolt | 单撑螺栓 | 1 |
| 15 | PMZ50-22-F-15 | Kick stand spring | 单撑弹簧 | 1 |

| | | | | |
|----|---------------|---------------------|-------|---|
| 16 | PMZ50-22-F-16 | Gas sensor | 油位传感器 | 1 |
| 17 | PMZ50-22-F-17 | Oil pump | 油泵 | 1 |
| 18 | PMZ50-22-F-18 | Balance bar bracket | 平衡杆支架 | 1 |
| 19 | PMZ50-22-F-19 | Fixed ring | 固定圈 | 1 |
| 20 | PMZ50-22-F-20 | Oil seal | 油封 | 1 |
| 21 | PMZ50-22-F-21 | Oil tubing | 油管 | 3 |



| 序号 SR NO. | 件号 PART NO. | 名称 Description | 名称 Description | 数量 Qty |
|--------------|----------------|-----------------------------|-------------------|-----------|
| 1 | PMZ50-22-G-1 | Front tire | 前轮胎 | 1 |
| 2 | PMZ50-22-G-2 | Front rim | 前轮钢圈 | 1 |
| 3 | PMZ50-22-G-3 | Front brake | 前碟刹 | 1 |
| 4 | PMZ50-22-G-4 | Front brake disc | 前碟刹盘 | 1 |
| 5 | PMZ50-22-G-5 | Battery | 蓄电池 | 1 |
| 6 | PMZ50-22-G-6 | Front brake disc screw bolt | 碟刹盘螺栓 | 3 |
| 7 | PMZ50-22-G-7 | 8*45 screw bolt | 8*45螺栓 | 2 |
| 8 | PMZ50-22-G-8 | 16*12*8.5 bushing | 16*12*8.5衬套 | 2 |
| 9 | PMZ50-22-G-9 | Tubeless valve | 气门嘴 | 1 |
| 10 | PMZ50-22-G-10 | Battery attachment | 电瓶安装附件 | 4 |