

HAWK 250CC BIKE VEHICLE PARTS CATALOGUE



车架FRAME



发动机总成 ENGINE COMP



- 1, 发动机总成 Engine comp **\$350.00**
- 2, 尾盖 Tail cover **\$15.00**
- 3, 变档杆 Gearshift lever **\$15.00**
- 4, 发动机上悬挂, 2件 Engine top suspension 2pcs **\$10.00**
- 5, 发动机前悬挂, 2件 Engine front suspension 2pcs **\$10.00**
- 6, 发动机后悬挂 Engine rear suspension **\$10.00**
- 7, 发动机下悬挂螺栓及紧固螺母3件 Engine bottom suspension bolt and nut, 3sets **\$10.00**
- 8, 尾盖紧固螺栓2件 Tail cover bolt 2pcs **\$2.50**
- 9, 上悬挂紧固螺栓3件, 紧固螺母3件 **\$10.00**
Top suspension bolt and nut, 3sets
- 10, 前悬挂紧固螺栓3件, 紧固螺母3件 **\$10.00**
Front suspension bolt and nut, 3sets
- 11, 后悬挂与车架紧固螺栓2件 **\$2.50**
Bolt, 2sets for rear suspension and frame

2

消声器总成 MUFFLER

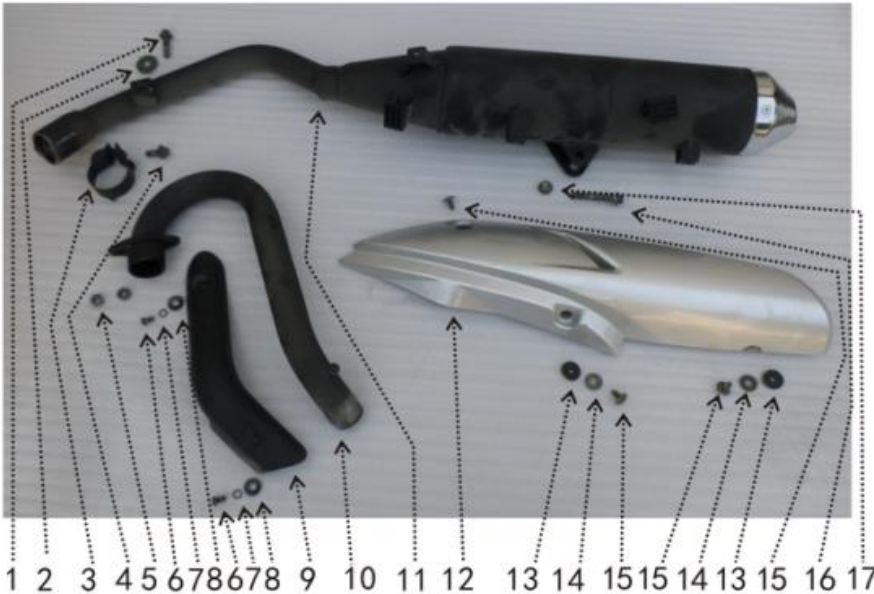

- 11, 消声器筒体 Muffler pipe **\$40.00**
- 10, 消声器前段 Front part, muffler **\$25.00**
- 3, 消声器前段与后段连接抱箍
Hold hoop, muffler front part and rear part **\$10.00**
- 4, 连接抱箍紧固螺栓
Bolt, hold hoop. **\$1.00**
- 12, 消声器前段隔热防烫板
Insulating panel, muffler front part **\$20.00**
- 13.14.15, 防烫板紧固螺栓2件, 弹簧垫圈2件, 平垫圈2件
Bolt 2pcs, spring washer 2pcs, plate washer 2pcs **\$3.00**
- 5, 消声器与发动机紧固螺母2件
Nut 2pcs, muffler and engine **\$2.00**
- 9, 消声器筒体防烫装饰板
Insulating panel, muffler rear part **\$10.00**
- 6.7.8, 防烫装饰板与筒体紧固螺栓3件, 平垫圈3件,
胶圈3件
Bolt 3pcs, plate washer 3pcs, rubber ring 3pcs for insulating panel
and muffler rear part **\$3.00**
- 1, 消声器与车架连接螺栓1件
Bolt 1pcs, muffler and frame **\$1.00**
- 2, 平垫圈1件
Plate washer 1pcs **\$1.00**
- 16.17, 消声器与车架连接螺栓1件, 螺母1件
Bolt 1pcs, nut 1pcs, for muffler and frame **\$2.00**

3

前轮总成 FRONT WHEEL COMP



- 1, 前轮胎 Front tire **\$35.00**
- 2, 前轮毂 Front rim **\$75.00**
- 3, 前碟刹盘 Front brake disc **\$20.00**
- 4, 前轮轴 Frong wheel axle **\$15.00**
- 5, 计速器 Speed Sensor **\$20.00**
- 6, 前轮轴紧固螺母 Nut, front wheel axle **\$5.00**
- 7, 前轮左衬套 Left bush, front wheel **\$5.00**
- 8, 止退片2件 2X Stabler, brake disc bolt **\$10.00**
- 9, 碟刹盘与前轮连接螺栓4件
Bolt 4pcs, brake disc and front wheel **\$10.00**

4

后轮总成 REAR WHEEL



- 1, 后轮胎 Rear tire **\$45.00**
- 2, 后轮毂 Rear rim **\$85.00**
- 3, 链盘 Sprocket **\$20.00**
- 4, 后碟刹盘 Rear brake disc **\$20.00**
- 5, 链盘与轮毂连接螺栓及螺母 4套,
Bolt and nut 4sets, sprocket and rear rim **\$20.00**
- 6, 后碟刹钳与平叉定位板
Position plate, rear disc calliper and rear fork **\$10.00**
- 7, 后轮轴
Rear wheel axle **\$20.00**
- 8, 后轮左衬套
Left bush, rear wheel **\$5.00**
- 9, 链条调节器挡板2件
Block 2pcs, chain adjuster **\$10.00**
- 10, 后轮轴紧固螺母
Nut, rear wheel **\$5.00**

前减震器 FRONT SHOCK

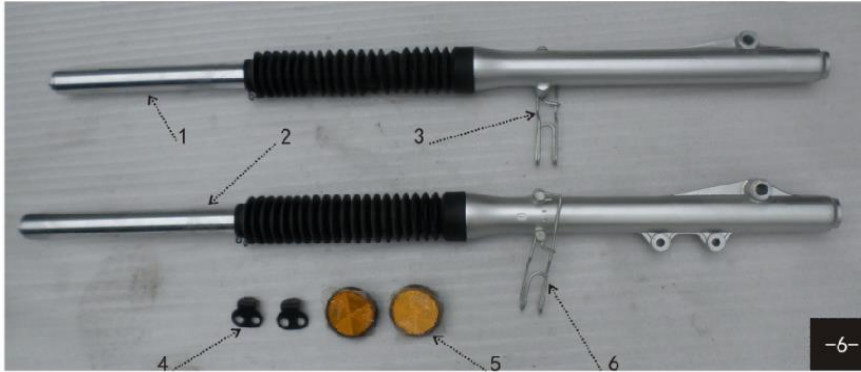

- 1, 前右减震器 Right, front shock \$40.00
- 2, 前左减震器 Left, front shock \$40.00
- 3, 里程线夹 Clamp, mileage cable \$5.00
- 4, 碟刹油管线夹 Clamp, front brake oil line \$5.00
- 5, 反射器与方向柱连接支架2件
Bracket 2pcs, for reflector and steering stem \$2.00
- 6, 反射器2件
Reflector 2pcs \$4.00

后减震 REAR SHOCK

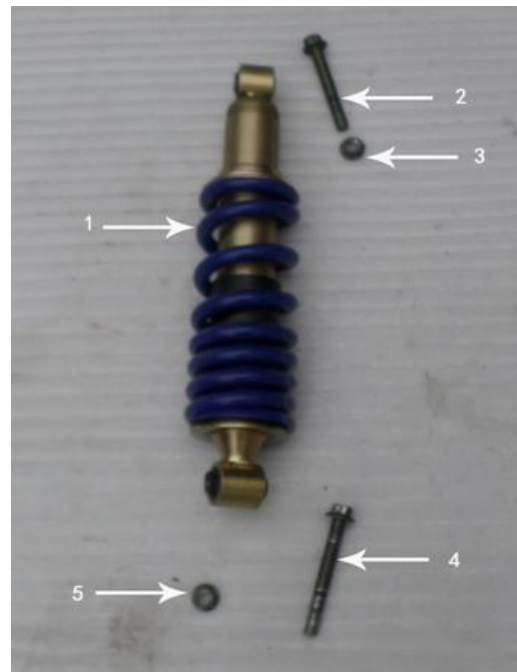

- 1, 后减震器 Rear shock \$35.00
- 2, 后减震器与车架连接螺栓
Bolt, rear shock and frame \$5.00
- 3, 紧固螺母
Nut \$1.00
- 4, 后减震器与平叉连接螺栓1件
Bolt 1pcs, rear shock and \$5.00
- 5, 紧固螺母
Nut \$1.00

平叉 REAR FORK

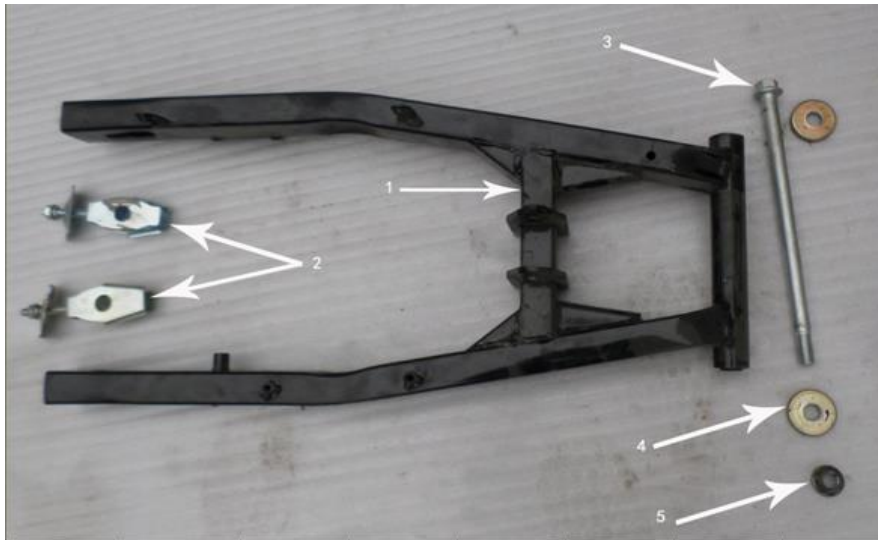

- 1, 平叉 Rear fork \$45.00
- 2, 链条调节器 Chain adjuster \$20.00
- 3, 平叉轴 Fork axle \$15.00
- 4, 平叉管防尘盖2件 Dust cap 2pcs, rear fork \$5.00
- 5, 平叉轴紧固螺母 Nut, rear fork axle \$5.00

燃油箱总成 GAS TANK COMI



- 1, 燃油箱体 Gas tank \$45.00
- 2, 燃油箱锁盖 Gas cap with key \$30.00
- 3, 油位传感器 Gas tank sensor \$15.00
- 4, 油开关 Gas tank cock \$10.00
- 5, 油箱与车架连接胶垫 Rubber washer, gas tank and frame \$2.00
- 6, 油箱与车架连接紧固螺栓1件, 平垫圈1件 Nut and plate washer 1set, gas tank and frame \$2.00
- 7, 油位传感器与油箱紧固螺母4件 Nut 4pcs, gas tank sensor and gas tank \$2.00
- 8, 油箱与左、右覆盖件连接“工”字胶2件 Rubber washer 2pcs, gas tank and left&right body cover \$2.00
- 9, 油箱与车架固定胶塞2件 Rubber block 2pcs, gas tank and frame \$2.00

方向柱总成 STEERING STEM

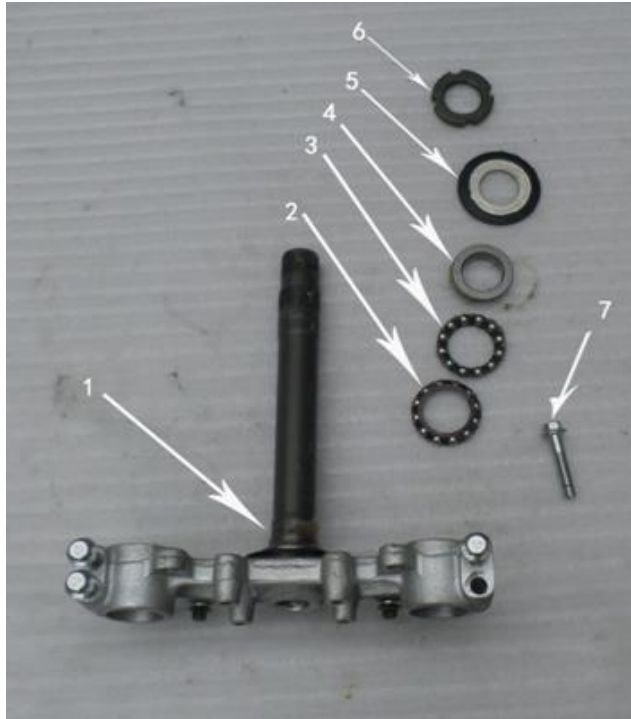

- 1, 方向柱 Steering stem \$55.00
- 2, 方向柱下轴承 Lower bearing, steering stem \$3.00
- 3, 方向柱上轴承 Upper bearing, steering stem \$3.00
- 4, 轴承上座圈 Upper ring, bearing \$3.00
- 5, 方向柱紧固平垫圈 Plate washer, steering stem \$3.00
- 6, 方向柱紧固螺母 Nut, steering stem \$2.00

蓄电池 BATTERY

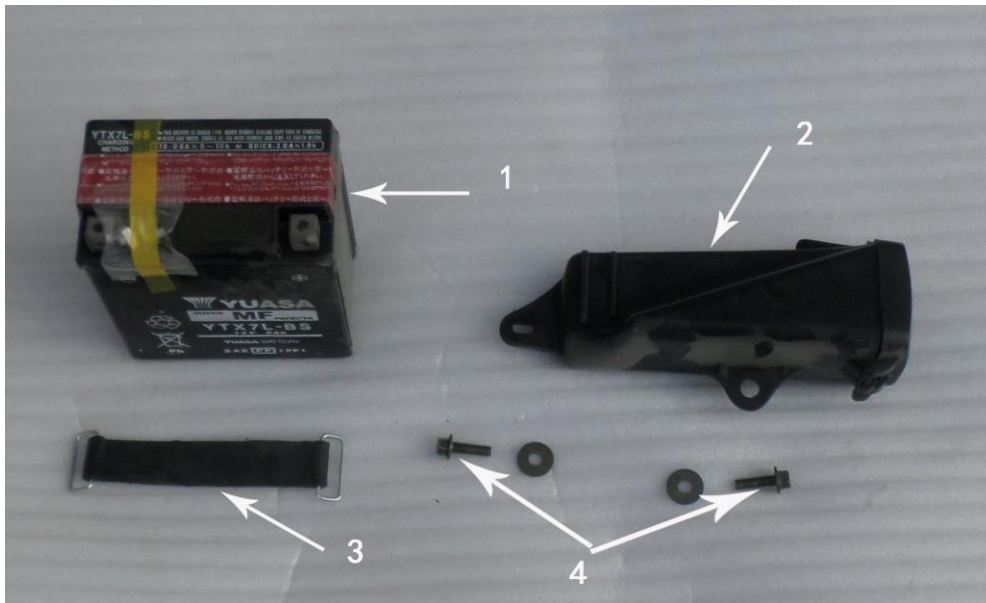

- 1, 蓄电池 (电瓶) Battery \$35.00
- 2, 随车工具箱 Tool kit box \$10.00
- 3, 电瓶固定胶带(Strap, battery) \$5.00
- 4, 工具箱与车架连接固定螺栓2件, 平垫圈2件
Bolt and plate washer 2sets, tool kit box and
frame(cancelled) \$2.00

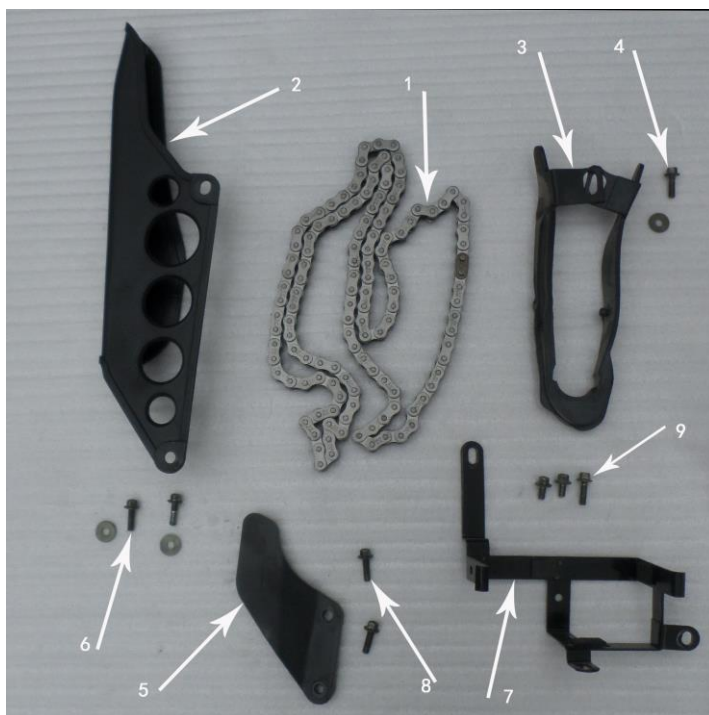
链条、电瓶支架 CHAIN,BATTERY BRACKET

1, 链条 Chain **\$35.00**

2, 链盒 Chain box **\$15.00**

3, 链条护卡 Chain protection **\$10.00**

4, 链条护卡与平叉连接紧固螺栓1件, 平垫圈1件
Bolt and plate washer 1set, chain protection and rear fork **\$2.00**

5, 链条下护板

Lower protective plate, chain **\$10.00**

6, 链盒与平叉连接紧固螺栓2件, 平垫圈2件
bolt and plate washer 2set, chain box and rear fork **\$2.00**

7, 电瓶支架

Battery bracket **\$5.00**

8, 链条下护板与平叉连接紧固螺栓2件
Bolt 2pcs, chain lower protective plate and rear fork **\$2.00**

9, 电瓶支架与车架连接紧固螺栓3件

Bolt 3pcs, battery bracket and frame. **\$3.00**

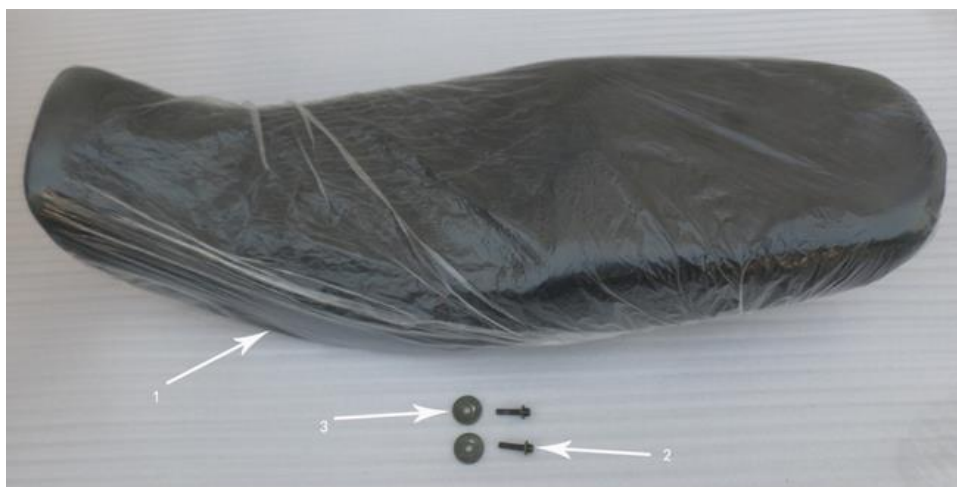
座垫 SEAT

1, 座垫 Seat **\$45.00**

2, 座垫与车架连接紧固螺栓2件
Bolt 2pcs, seat and frame **\$2.00**

3, 平垫圈2件

Plate washer 2pcs **\$1.00**

手把管总成 HANDLE BAR COMP

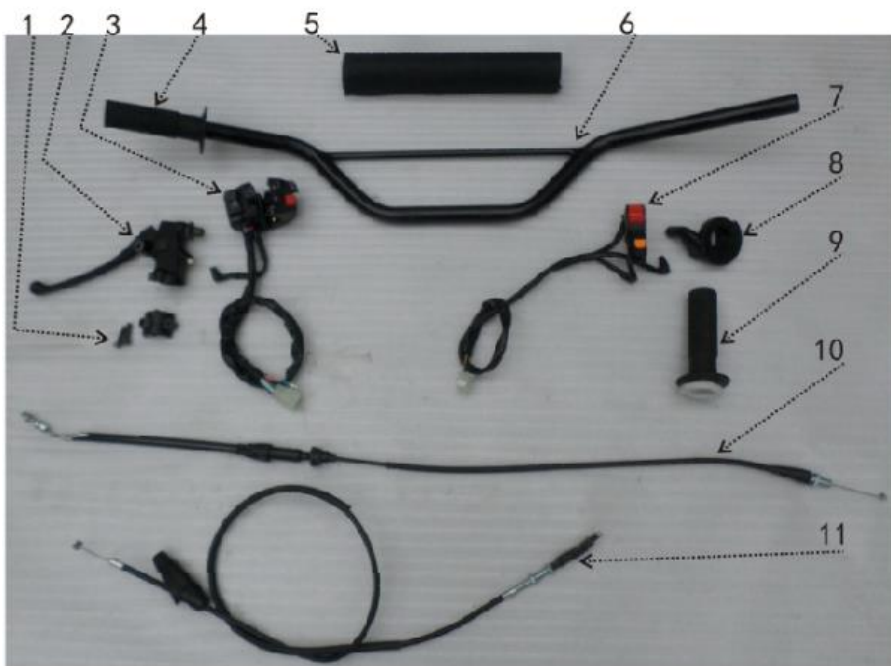

- 6, 手把管 Handle bar **\$25.00**
- 4, 左手把胶 Left handle grip **\$5.00**
- 5, 防撞棒 Anti dumper **\$5.00**
- 2, 离合手柄 Clutch lever **\$15.00**
- 1, 离合手柄与手把管连接紧固螺栓2件
Bolt 2pcs, clutch lever and handle bar **\$3.00**
- 3, 闸把 Left Handle bar switch **\$20.00**
- 7, 油门拉索 Throttle cable **\$15.00**
- 8, 离合拉索 Clutch cable **\$15.00**
- 9, 右手把胶（及加油器）Right handle bar grip
(accelerator is included) **\$10.00**
- 10, 熄火开关 Kill switch **\$10.00**
- 11, 油门拉索座 Throttle cable housing **\$10.00**

上连板 UPPER CONNECTING PLATE

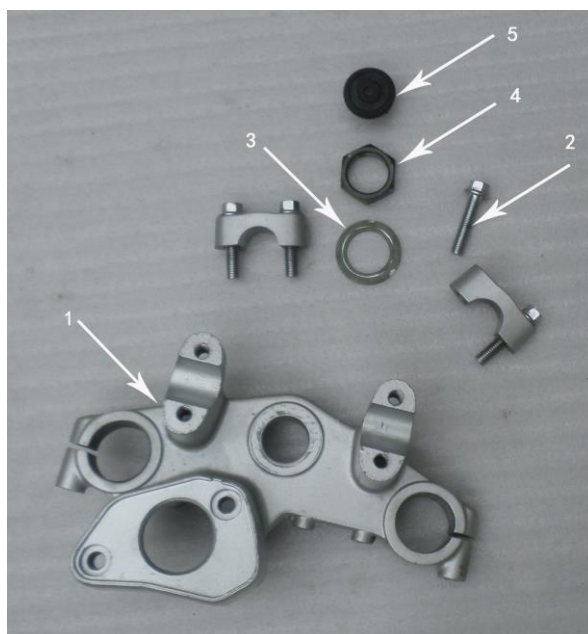

- 1, 上连板 Upper connecting plate **\$30.00**
- 2, 手把管与上连板紧固螺栓4件
Bolt 4pcs, handle bar and upper connecting plate **\$4.00**
- 3, 平垫圈
Plate washer **\$1.00**
- 4, 方向柱与上连板连接紧固螺母
Nut, steering stem and upper connecting plate **\$1.00**
- 5, 方向柱防尘胶塞
Rubber dust block, steering stem **\$1.00**



大灯、脚蹬、后视镜 HEADLIGHT, FOOT REST, MIRROR

- 1, 前大灯 Head light **\$35.00**
- 2, 前面罩 Head light cover **\$20.00**
- 3, 左后视镜 L mirror **\$10.00**
- 4, 右后视镜 R mirror **\$10.00**
- 5, 右脚蹬 R foot rest **\$15.00**
- 6, 左脚蹬 L foot rest **\$15.00**
- 7, 脚蹬与车架连接紧固螺栓4件
Bolt 4pcs, foot rest and frame **\$4.00**
- 8, 前面罩与方向柱连接紧固螺栓2件
Bolt 2pcs, head light cover and steering stem **\$2.00**
- 9, 前大灯与方向柱连接胶套2件
Rubber sleeve 2pcs, head light and steering stem **\$2.00**
- 10, 面罩与大灯连接紧固自攻钉4件, 平垫圈4件
Screw and plate washer 4sets, head light cover and head light. **\$4.00**

前碟刹总成 FRONT BRAKE COMP

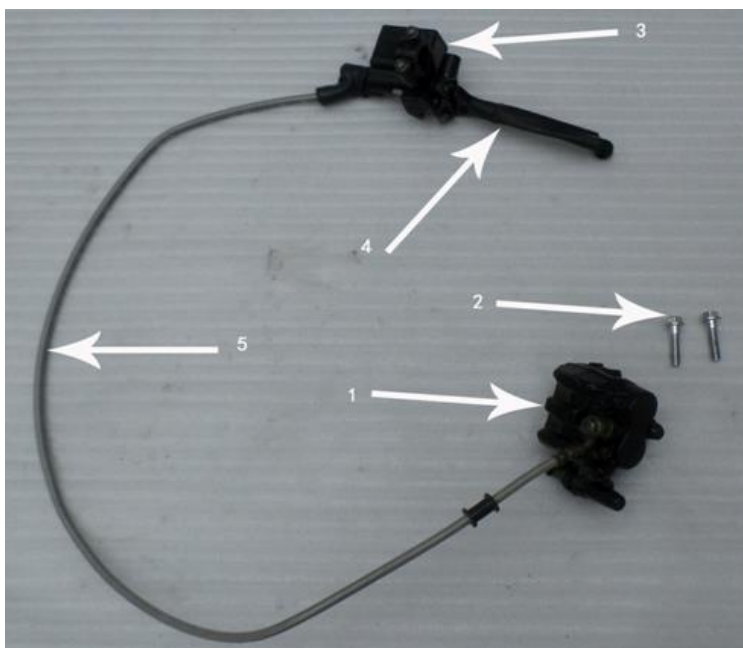

- 1, 前碟刹钳 Front brake calliper **\$35.00**
- 2, 前碟刹泵紧固螺栓2件 Bolt 2pcs, front brake pump **\$2.00**
- 3, 前碟刹油杯 Oil reservoir, front brake **\$35.00**
- 4, 前碟刹手柄 Front brake lever **\$15.00**
- 5, 前碟刹油管 Front brake oil line **\$15.00**

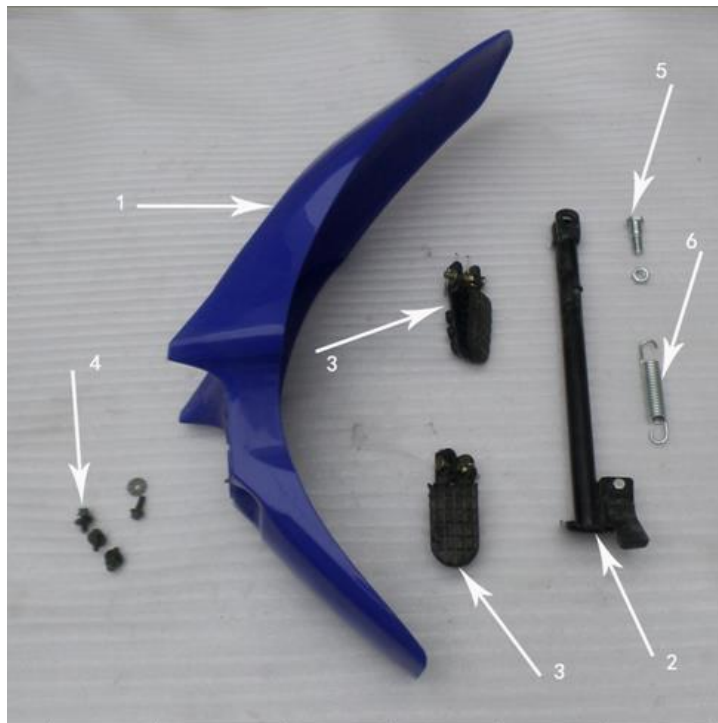

前挡泥板、侧支架、主搁脚 FRONT FENDER, SIDE STAND, MAIN STAND

- 1, 前挡泥板 Front fender **\$35.00**
- 2, 侧支架 Side stand **\$20.00**
- 3, 左、右搁脚 L&R foot rest **\$20.00**
- 4, 前挡泥与方向柱连接紧固螺栓4件, 平垫圈4件
Bolt and plate washer 4sets, for front fender and steering stem **\$4.00**
- 5, 侧支架与车架连接螺栓1件, 螺母1件
Bolt and nut 1set, for side stand and frame **\$1.00**
- 6, 侧支架回位弹簧
Spring, side stand **\$1.00**

后挡泥总成 REAR FENDER COMP



- 1, 后挡泥板 Rear fender **\$35.00**
- 2, 尾灯 Tail light **\$25.00**
- 3, 牌照灯总成 Licence plate light **\$15.00**
- 4, 后牌照支架 Licence plate bracket **\$5.00**
- 5, 后牌照支架与后挡泥连接螺栓,平垫, 螺母2套
Bolt,plate washer, nut 2sets, licence plate bracket and rear fender **\$1.00**
- 6, 尾灯与后挡泥连接螺母2件, 平垫圈2件
Nut and plate washer 2sets, tail light and rear fender **\$1.00**
- 7, 牌照灯与后挡泥连接自攻钉3件, 平垫圈3件
Screw and plate washer 3 sets, licence plate light and rear fender **\$1.00**
- 8, 后挡泥与车架连接紧固螺栓2件, 平垫圈2件
胶平垫2件
Bolt, plate washer and rubber plate washer 2 sets, rear fender and frame **\$1.00**

后扶手, 后转向灯 REAR ARMREST

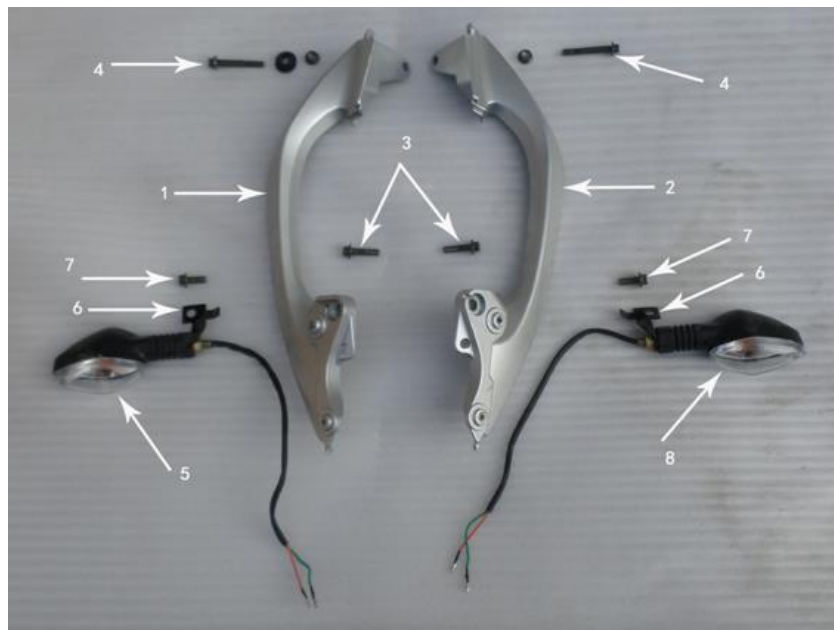

1, 左后扶手 Left rear armrest **\$25.00**

2, 右后扶手 Right rear armrest **\$25.00**

3, 后扶手与车架连接紧固螺栓2件
Bolt 2pcs, rear armrest and frame **\$1.00**

4, 后扶手与车架连接紧固螺栓, 工字胶, 螺母2件,
Bolt, rubber, nut 2sets, rear armrest and frame **\$2.00**

5, 后左转向灯 Rear left turn light **\$10.00**

6, 转向灯与后扶手连接支架2件
Bracket 2pcs, rear turn light and rear armrest **\$1.00**

7, 转向灯与后扶手连接紧固螺栓2件
Bolt 2pcs, turn light and rear armrest **\$1.00**

8, 后右转向灯
Rear right turn light **\$10.00**

空滤器 AIR FILTER



1, 空滤器 Air fliter **\$25.00**

2, 空滤器与化油器连接抱箍
Clamp, air fliter and carburetor **\$3.00**

3, 头盔锁
Lock **\$5.00**

4, 头盔锁与车架连接紧固螺栓2件
Bolt 2pcs, lock and frame **\$1.00**



21

后碟刹总成 REAR DISC BRAKE COMP

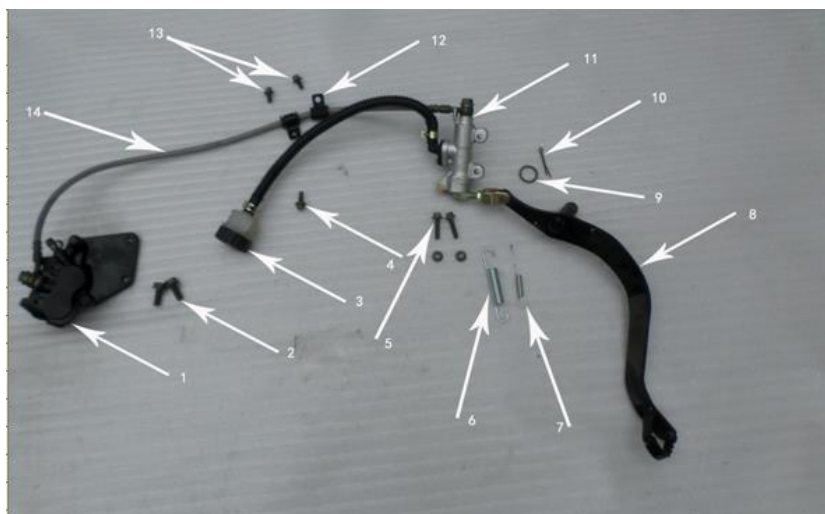

- 1, 后碟刹钳 Rear brake caliper **\$35.00**
- 2, 后碟刹钳与平叉连接定拉板紧固螺栓2件
Bolt 2pcs, rear brake caliper and rear fork **\$1.00**
- 3, 后碟刹油杯
Rear brake oil reservoir **\$1.00**
- 4, 后碟刹油杯与车架连接紧固螺栓
Bolt, rear brake oil reservoir and frame **\$1.00**
- 5, 后碟刹总成与车架连接紧固螺栓2件, 螺母2件
Bolt and nut 2sets, rear brake comp and frame **\$2.00**
- 6, 后制动踏板回位弹簧
Spring, rear brake pedal **\$1.00**
- 7, 后碟刹车灯开关弹簧
Switch spring, rear brake light **\$1.00**
- 8, 后制动踏板
Rear brake pedal **\$15.00**
- 9, 后制动踏板与车架连接平垫圈
Plate washer, rear brake pedal and frame **\$0.5**
- 10, 开口销
Cotter pin **\$0.5**
- 11, 后碟刹泵
Rear brake bump **\$30.00**
- 12, 后碟刹油管与平叉固定支架2件
Bracket 2pcs, rear brake oil line and rear fork **\$2.00**
- 13, 后碟刹油管与平叉连接紧固螺栓2件
Bolt 2pcs, rear brake oil line and rear fork **\$2.00**
- 14, 后碟刹油管
Rear brake oil line **\$10.00**

22

化油器总成 CARBURETOR

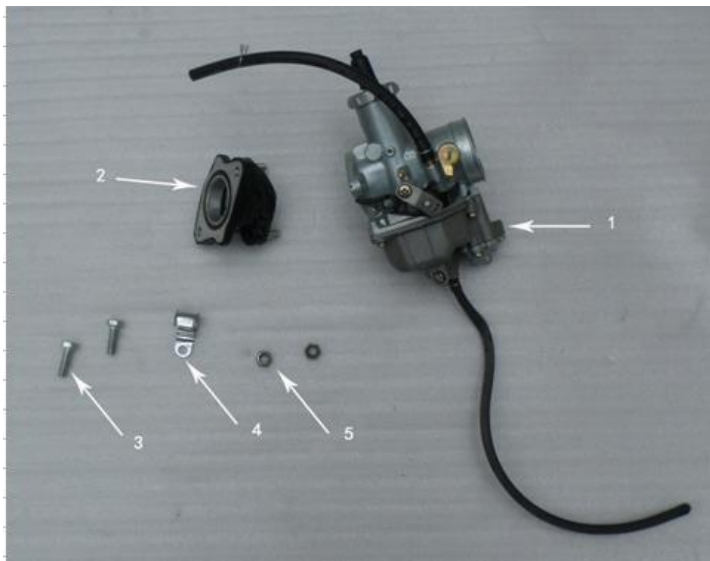

- 1, 化油器总成 Carburetor **\$35.00**
- 2, 进气管 Air intake **\$15.00**
- 3, 进气管与发动机连接紧固螺栓2件
Bolt 2pcs, air intake and engine **\$2.00**
- 4, 点火线圈线夹
Clamp, ignition coil **\$1.00**
- 5, 进气管与化油器连接紧固螺母2件
Nut 2pcs, air intake and carburetor **\$1.00**



尾框、起动杆 TAIL COVER, KICK LEVER

1, 尾框架 Bracket, tail cover **\$35.00**

2, 座垫挂钩 Hook, seat **\$3.00**

3, 座垫挂钩与车架连接紧固螺栓2件
Bolt 2pcs, seat hook and frame **\$1.00**

4, 尾框与车架连接螺栓装饰胶塞2件
Rubber block 2pcs, tail cover and frame bolt

5, 尾框与车架连接紧固螺栓4件

Bolt 4pcs, tail cover and frame **\$2.00**

6, 平垫圈4件

Plate washer 4pcs **\$1.00**

7, 起动杆

Kick lever **\$15.00**

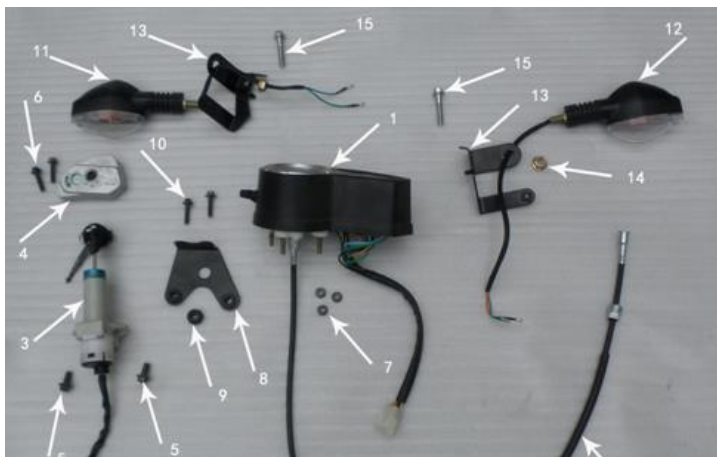

仪表、点火锁、前转向灯 METER, IGNITION LOCK, FRONT TURN

1, 仪表
Meter **\$40.00**

2, 里程线
Mileage cable **\$15.00**

3, 方向锁
Steering lock **\$15.00**

4, 方向锁盖
Steering lock cap **\$5.00**

5, 方向锁与方向柱连接紧固螺栓2件
Bolt 2pcs, steering lock and steering stem **\$1.00**

6, 方向锁盖与上连板连接紧固螺栓2件
Bolt 2pcs, steering lock cap and top connecting plate **\$1.00**

7, 仪表与仪表支架连接紧固螺母3件
Nut 3pcs, meter and meter bracket **\$1.00**

8, 仪表支架
Meter bracket **\$5.00**



- 9, 仪表与仪表支架连接“工”字胶3件
 Rubber parts 3pcs, meter and meter bracket \$0.5
- 10, 仪表支架与上连板连接紧固螺栓2件
 Bolt 2pcs, meter bracket and top connecting plate \$1.00
- 11, 前左转向灯
 Front left turn light \$10.00
- 12, 前右转向灯
 Front right turn light \$10.00
- 13, 转向灯支架
 Bracket, turn light \$3.00
- 14, 转向灯与支架连接紧固螺母2件
 Nut 2pcs, turn light and bracket \$1.00
- 15, 转向灯支架与上连板连接紧固螺栓2件
 Bolt 2pcs, turn light bracket and top connecting plate \$1.00

油箱左、右覆盖件 LEFT&RIGHT COVER, GAS TANK

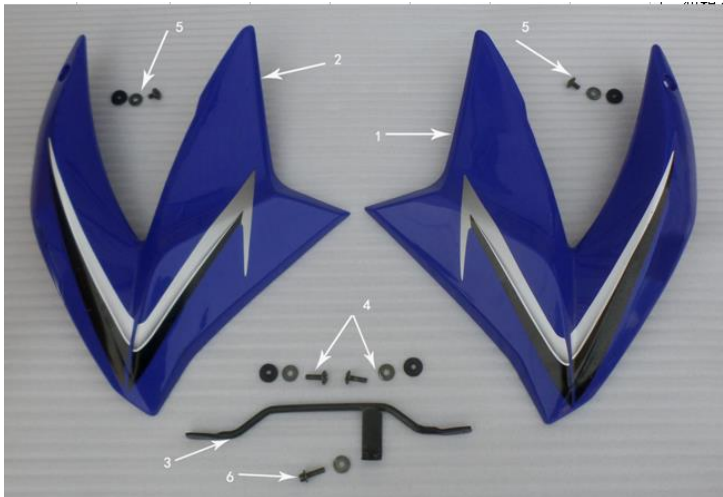

- 1, 油箱右覆盖件
 Right cover, gas tank \$35.00
- 2, 油箱左覆盖件
 Left cover, gas tank \$35.00
- 3, 油箱覆盖件支架
 Gas tank cover bracket \$10.00
- 4, 油箱覆盖件与支架连接螺栓2件, 平垫圈2件, 紧固螺母2件
 Bolt, plate washer and nut 2sets, gas tank cover and bracket \$1.00
- 5, 油箱覆盖件与油箱连接紧固螺栓2件, 平垫圈2件, 胶平垫2件
 Bolt, plate washer and rubber washer 2sets, gas tank cover and gas tank \$1.00
- 6, 油箱覆盖件支架与车架连接紧固螺栓1件, 平垫圈1件
 Bolt and plate washer 1pcs, gas tank cover bracket and frame \$1.00

26

主线、电器件 CABLE HARNESS, ELECTRIC PARTS

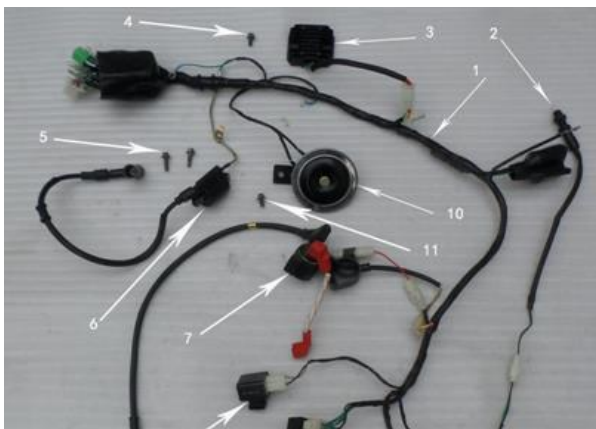

- 1, 主线缆
 Cable harness \$45.00
- 2, 制动灯开关线
 Brake light switch \$10.00
- 3, 调压器
 Regulator \$10.00
- 4, 调压器与车架紧固螺栓
 Bolt, regulator and frame \$1.00
- 5, 点火线圈与车架紧固螺栓2件
 Bolt 2pcs, ignition coil and frame \$2.00
- 6, 点火线圈
 Ignition coil \$10.00
- 7, 继电器
 Starting relay \$10.00
- 8, 闪光器



- Flasher \$10.00
- 9, 点火器 CDI \$10.00
- 10, 喇叭 Horn \$15.00
- 11, 喇叭与车架固定螺栓 Bolt, horn and frame \$1.00



左、右侧盖

LEFT&RIGHT SIDE COVER

- 1. Right side cover \$35.00
 - 2. Left side cover \$35.00
 - 3. Rubber plate washer 2pcs \$1.00
 - 4. Plate washer 2pcs \$1.00
 - 5. Screw 2pcs, side cover and frame \$2.00
- 1. 右侧盖
 - 2. 左侧盖
 - 3. 胶平垫2件
 - 4. 平垫圈2件
 - 5. 侧盖与车架连接紧固螺钉2件