

C200 AUTOMATIC PET FEEDER



User Manual

Specification

- **Programming** : 1 to 5 meals per day
- **Dimension** : L331mm x W323mm x H83mm (Assembled)
- **Capacity** : 1.6 Liter(around 1.6Lbs dry food, or 2Lbs wet food)
- **Weight** : 1.4 kg (without batteries & food)
- **Power** : Require 3 * "D" size batteries.(Batteries not included)
Adapter 5V DC 1A with power cord.
(USB cable and power adapter not included)

Key Features:

- Humanized design, simply setting
- Voice record/play at the programmed meal time
- Five separate large food trays for dry or wet food
- Dual power supply: battery and power adapter
- Soft rubber sealing preservation.

-1-

How to Install C200

(1) Twist the lid as picture showing to open the lid. After filling in the food, place lid and twist to lock lid into place.

Open the lid :

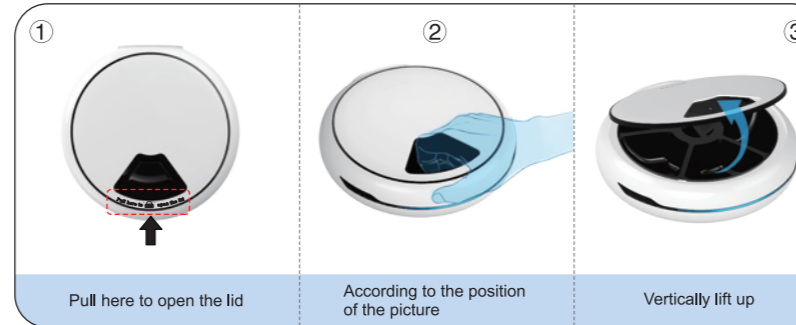

Lock the lid :

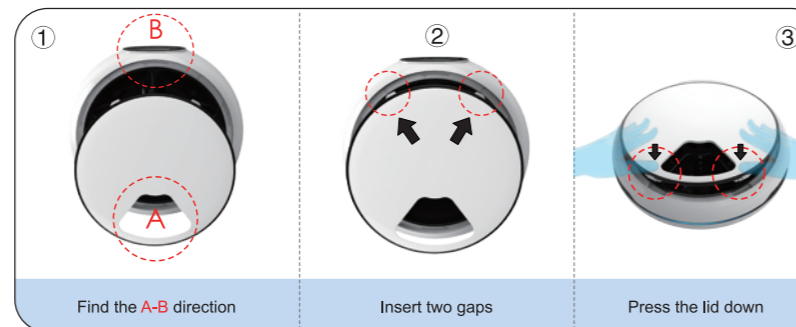

(2) It works with AC adapter and 3 "D" size batteries as an optional back up power. If do not want to use power adaptor, you can change to install batteries to the base (3 new "D" size, alkaline batteries. Batteries, USB cable and power adapter not included.)

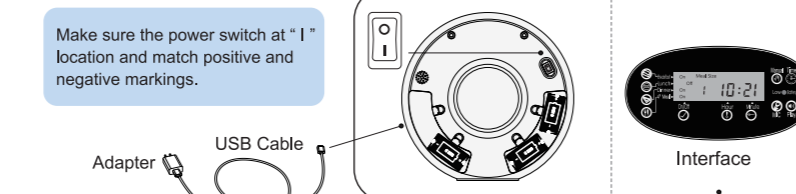

(3) Setting the feeder per the following instruction.

-2-

Quickly Setting Guide

(1) Manual Testing

- Keep pressing "Manual" button for 3 seconds, if the rotor will rotate 1 portion, it means the machine has no problem. You can also use this feature to feed manually.



(2) Current Time Setting

- Keep pressing the "Time" button and simultaneously click the "Hour" and "Minute" button to set the right time.

For example: Current time is 21:51



(3) Breakfast Setting

- **To set breakfast or not**
Keep pressing the "Breakfast" button and simultaneously click the "On/Off" button.
- **To set breakfast time**
Keep pressing the "Breakfast" button and simultaneously click the "Hour" button and the "Minute" button.

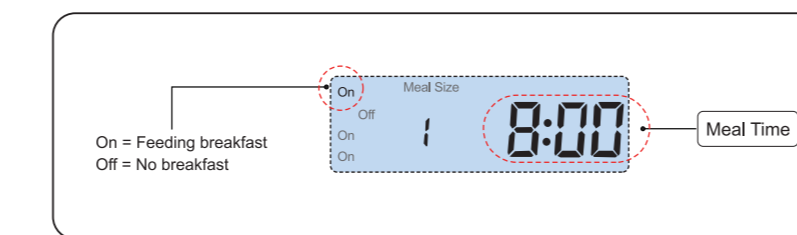

-3-

(4) Setting Lunch, Dinner or 4th Meal

- As above, press and hold "Lunch" and related buttons to setting lunch. Press and hold "Dinner" and related buttons to set dinner. Same goes with 4th meal.

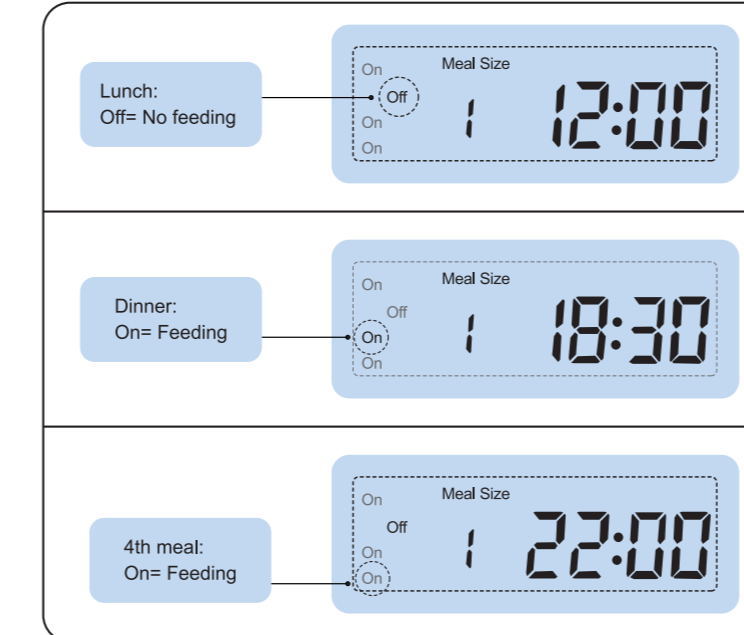

(5) Voice Recording and Play (Figure 5-1)

- **Recording**
Keep pressing "MIC" button until LCD screen flashes then record your voice. You can say "Bobby, time for eating" to the microphone, release the hand after recording.
- **Cancel Recording**
Keep pressing "MIC" button until LCD screen flashes, release your hand without saying anything.
- **Play Your Recording**
Keep pressing "Play" button until LCD screen flashes to replay your recording. (The played voice is very low for people, but the pet's hearing is more sensitive than ours, so the voice should not be too loud.)

-4-

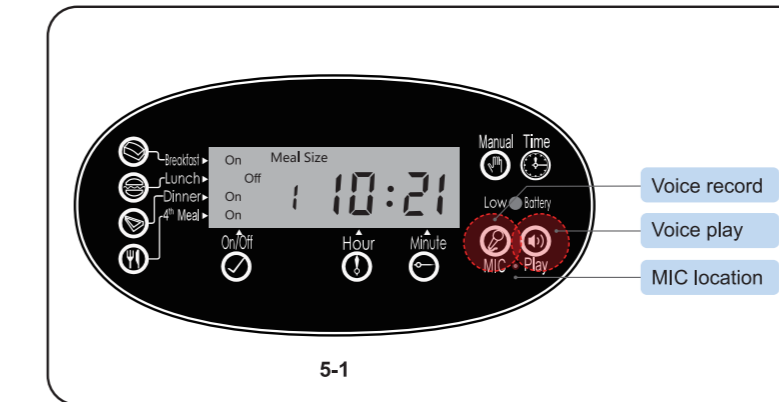

Cleaning

(1) Disassembly the Lid and Food tray.

- (2) Hand clean with soft cloth and hand dry.
Warning : Base unit should not be submerged in water at any time, that will damage electronic components and void the warranty.

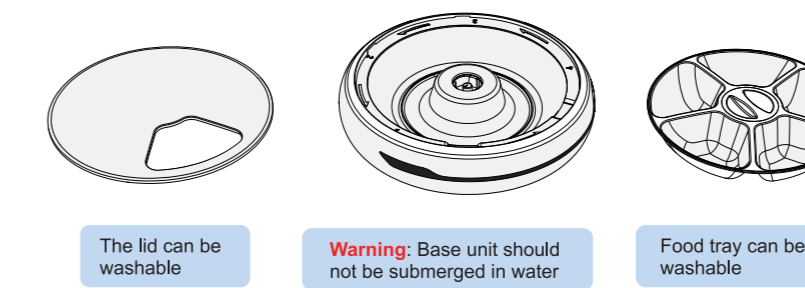

-5-

Trouble Shooting

(1) The "Low battery" light is flashing?

- Change 3 new "D" size, alkaline batteries. Normally 3 new "D" size, alkaline batteries can last around 1 year.

WARNING:

- Require three "D" size batteries. Batteries NOT included. Use alkaline batteries only .
- Estimated life of one set of batteries is one year.
- Keep fingers and hands clear of food wheel.
- Always turn unit off before cleaning.
- Always turn unit off before adding food.
- Always turn unit off before removing lid or hopper.
- Check the low battery light frequently to be sure the feeder has power.
- Check the level of food frequently to be sure the feeder is dispensing properly.

Important Notes:

- (1) Low voltage is on the right side of the control panel (Low battery).When you go out or travel, you must confirm whether the voltage light is lit, if when it is in the discharge or making a sound there are lights or flashing lights, please replace the battery to prevent hunger your pet.
- (2) Do not put your fingers into the machine at any time.
- (3) Power on / off. The switching power supply is located at the bottom of the product. Shutdown for more than 10 seconds all settings will be restored by default.
- (4) This product uses three "D" size batteries. (alkaline batteries can last around 1 year.)
Note: the old battery should be dealt with according to the state regulations (pay attention to environmental protection).
When the feeder is not used for a long time, remove the battery and prevent the electrolyte from flowing out.
- (5) If you have any questions, please contact the dealer or manufacturer.

-6-

Frequently Asked Questions

(1) My pet feeder discharges inaccurately.

- If after you use it for a period of time, this problem appears, mostly because the battery is too low, please replace the battery.

(2) My feeding device shows unclear or functions abnormally.

- This problem appears, most likely because the battery is too low, please replace the battery.

(3) How do I view the parameters that I set?

- Respectively, follow the breakfast button, lunch button, dinner button, the fourth meal button, you can view the parameters you set. If you want to change the parameters, please re-set, or replace the battery owing to the low battery.

C200-040-1173-R01

-7-