



Nature9^{Plus}

Outdoor Hybrid Sauna

PRODUCT MANUAL



Thanks for purchasing our products. In order to use these products safely and effectively, please read this manual carefully before use. We reserve the right to change this manual and improve our products.

TABLE OF CONTENTS

Table of Contents -----	1
Preparation/Parts List-----	2
Nature 9 Plus Installation Instructional Video-----	3
Installing the Electricity Box -----	3-4
Parts Drawing -----	5
Installation Drawing -----	6-10
Operation Instructions -----	11-15

The safety and operation of your sauna was checked before being shipped.

Only one electrical socket is required to power the nature sauna.

Assembling the sauna's electric components requires the expertise of a professional electrician. It must only be done by a professional.

Tools required: Phillips screwdriver, Ruler, 8mm Allen wrench



PREPARATION / PARTS LIST



Screwdriver
(Power Drill Recommended)



3m
Tape Measure



8mm
Allen Wrench

1. Check the quantity of your components according to the packing or parts list.
2. Check to see if there is damage on the surface of the sauna or its components.
3. A grounded outlet with at least 25-amps and a GFCI or ALCI is required to operate this device.
4. A professional electrician is required to install the sauna's electrical components.

If you cannot satisfy the above conditions, stop installing the sauna immediately and contact Medical Sauna™ at (818) 210-4955.





NATURE 9^{PLUS} INSTALLATION INSTRUCTIONAL VIDEO

Please go here to watch the video that will show you step-by-step how to install the NATURE 9 Plus.
<https://www.medicalsaunas.com/demo-nature9plus.php>

INSTALLING THE ELECTRICITY BOX

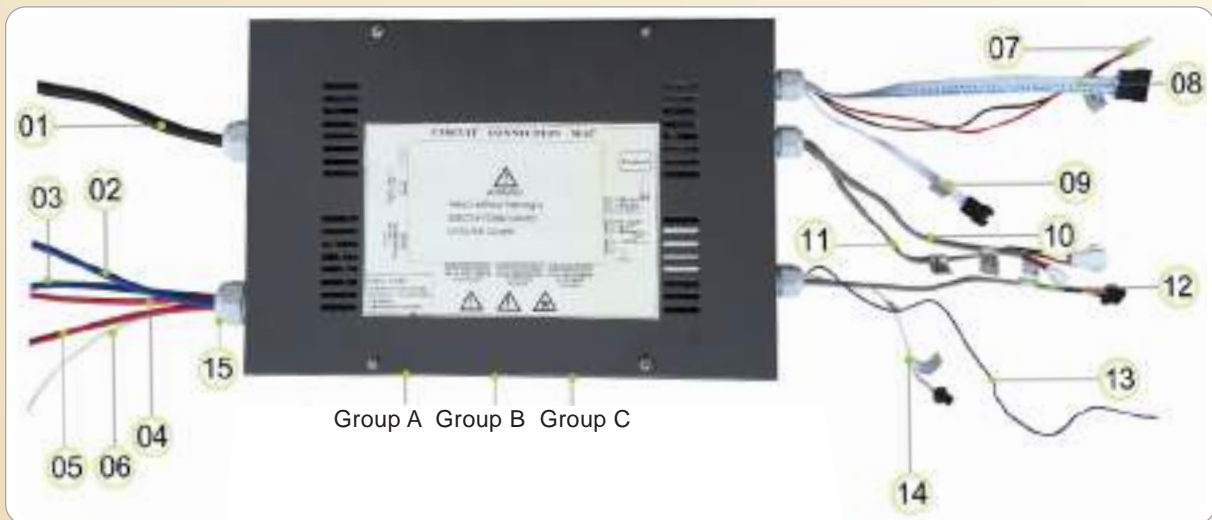
► Powerbox Indicator



 Attention: ground wires should be connected by a professional electrician.

- 01 Main Power Supply
- 02 N1
- 03 N2
- 04 L1
- 05 L2
- 06 Ground Wire
- 07 Oxygen Ionizer
- 08 7P Signal Wire: To get a signal for the control panel
- 09 Speaker Wire: Connects to the left and right speaker
- 10 Fan Wire: Connects to the fan
- 11 Colour Wire (optional): Connects to the roof lamp
- 12 USB Input: for flashdrive or memory card
- 13 The Antenna
- 14 Temperature Protector Wire: To connect the temperature protector in the cabin (will not work if the connection is cut)
- 15 Traditional Sauna Output

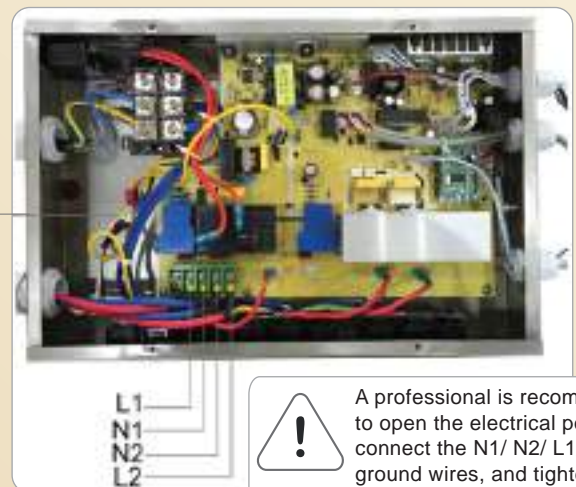

 A professional is recommended to open the electrical power box, connect the N1/ N2/ L1/ L2/ ground wires, and tighten the wires on the Terminals.



INSTALLING THE ELECTRICITY BOX

The plug of the electrical box and the load have different shapes with corresponding identification stickers. Be sure to connect them properly.



PARTS DRAWING

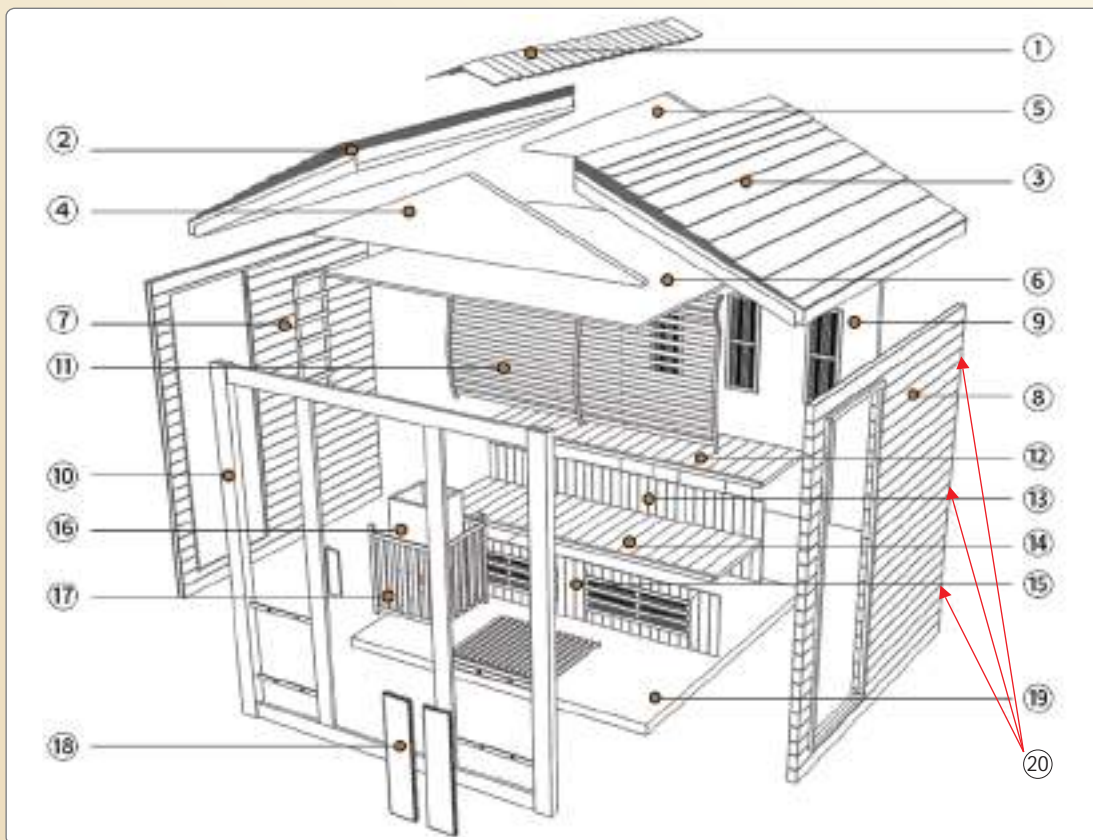

No.	Part Name	QTY.
①	Top roof	
②	Left side roof	
③	Right side roof	
④	Front triangle panel	
⑤	Back triangle panel	
⑥	Inner roof panel	
⑦	Left panel	
⑧	Right panel	
⑨	Back panel	
⑩	Front panel	

No.	Part Name	QTY.
⑪	Backrest	
⑫	Large bench top panel A	
⑬	Large bench front support A	
⑭	Large bench top panel B	
⑮	Large bench front support B	
⑯	Sauna stove	
⑰	Heater guard	
⑱	Mobile heater	
⑲	Floor panel	
⑳	Panel lock latches	

INSTALLATION DRAWING

▶ Step 1

Note: for 1 Person setup, place the sauna floor against a wall (same height). Line the back wall to bottom piece. Lean back wall against the back wall (drywall), then line side up on side and clamp down to lock in.

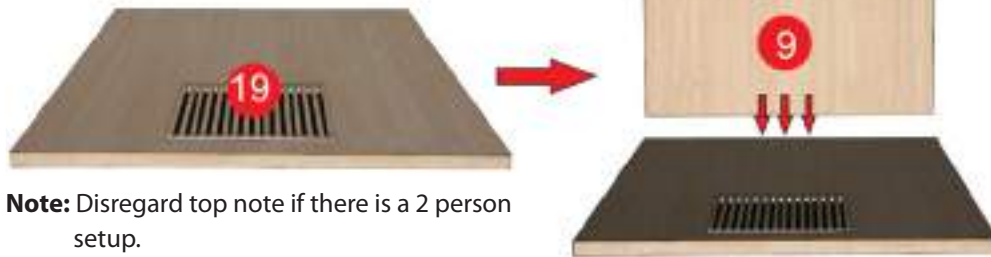

Note: Disregard top note if there is a 2 person setup.

▶ Step 2

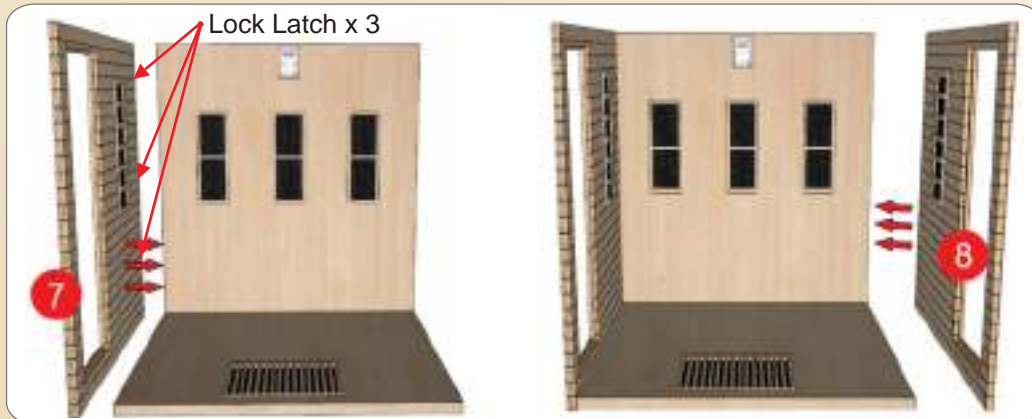

▶ Step 3



Note: the seat's bottom plate needs to be mounted in the side-plate's mounting bracket.

INSTALLATION DRAWING

▶ Step 4

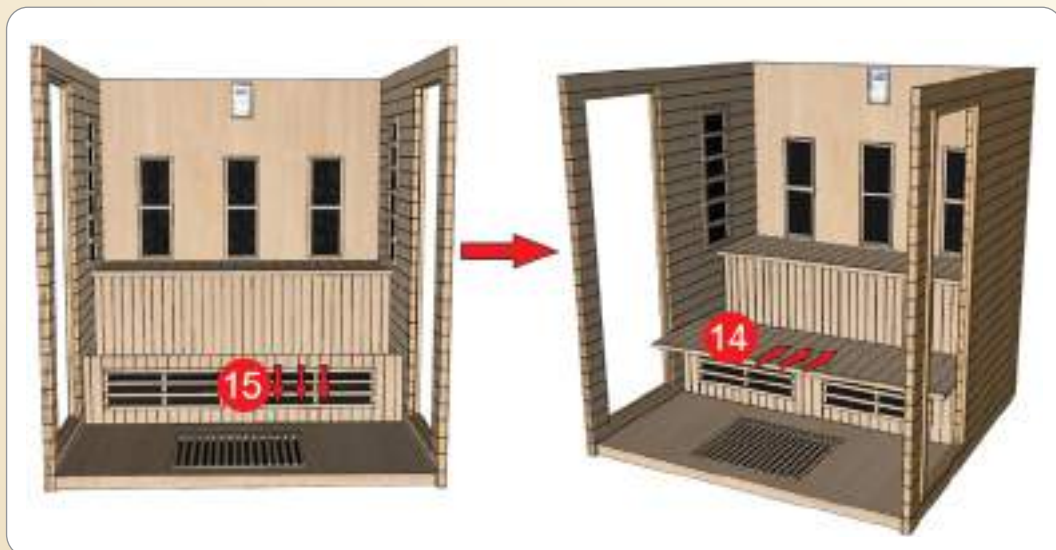

▶ Step 5

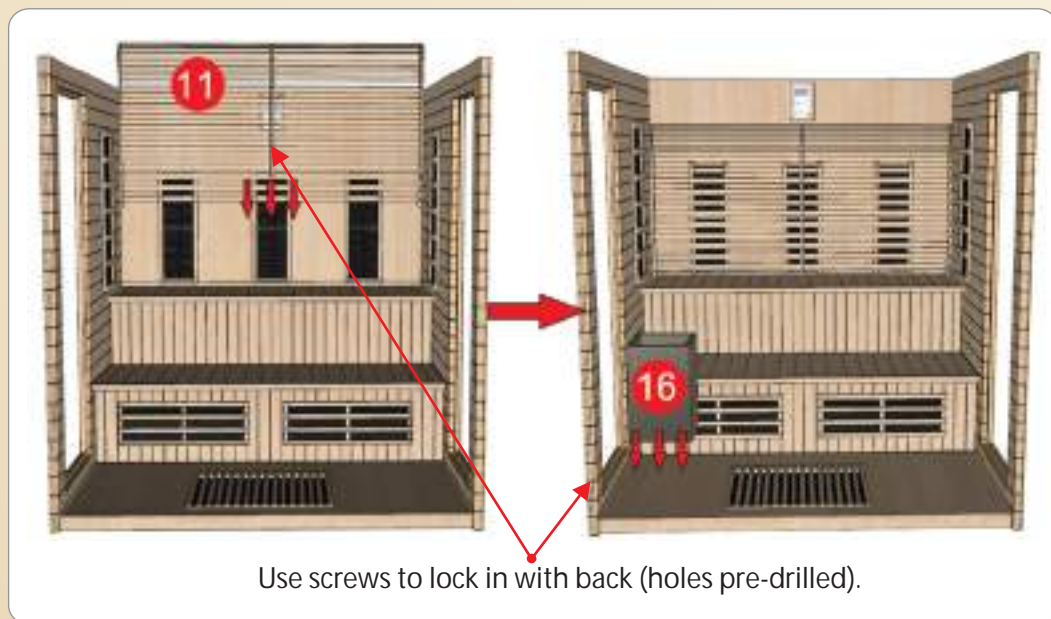

INSTALLATION DRAWING

▶▶ Step 6



▶▶ Step 7

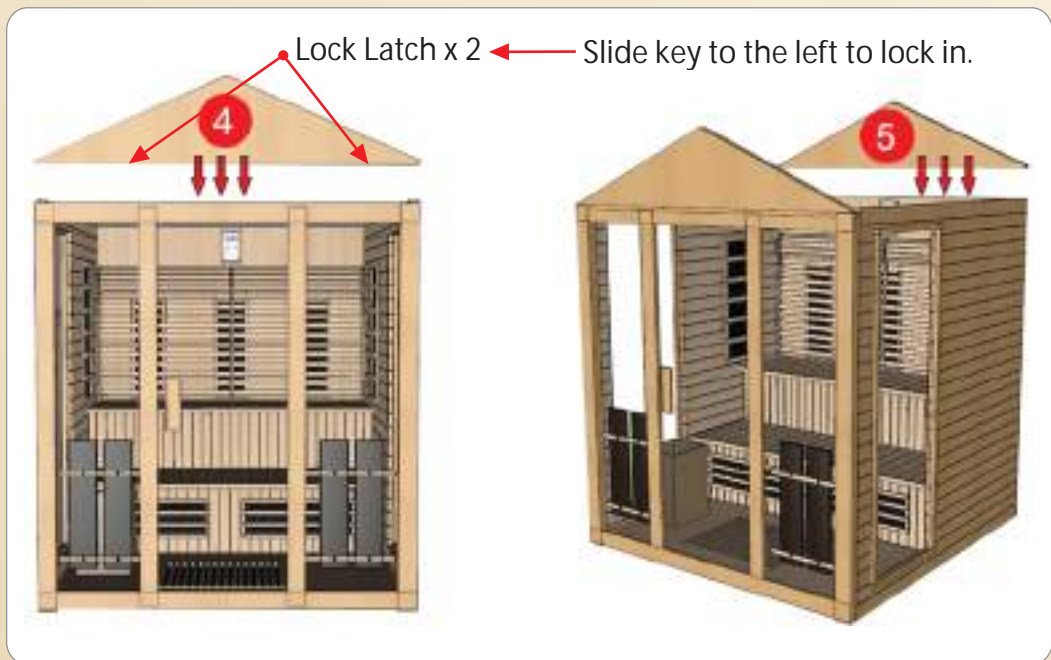



INSTALLATION DRAWING

▶ Step 8

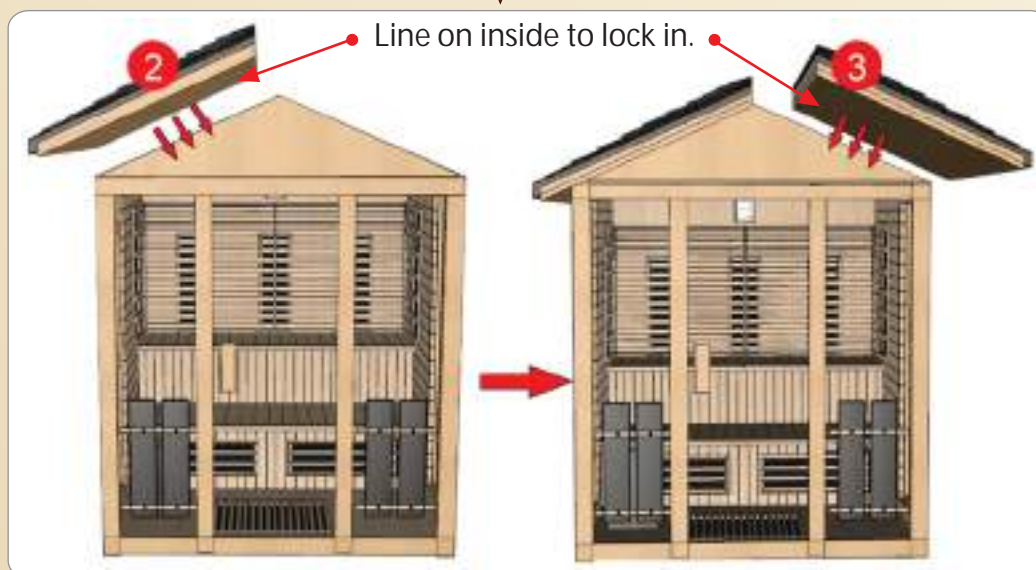

▶ Step 9



 **Note:** Before installing the glass door, double-check steps 3 and 7 to make sure all screws are securely fastened.

INSTALLATION DRAWING

▶ Step 9

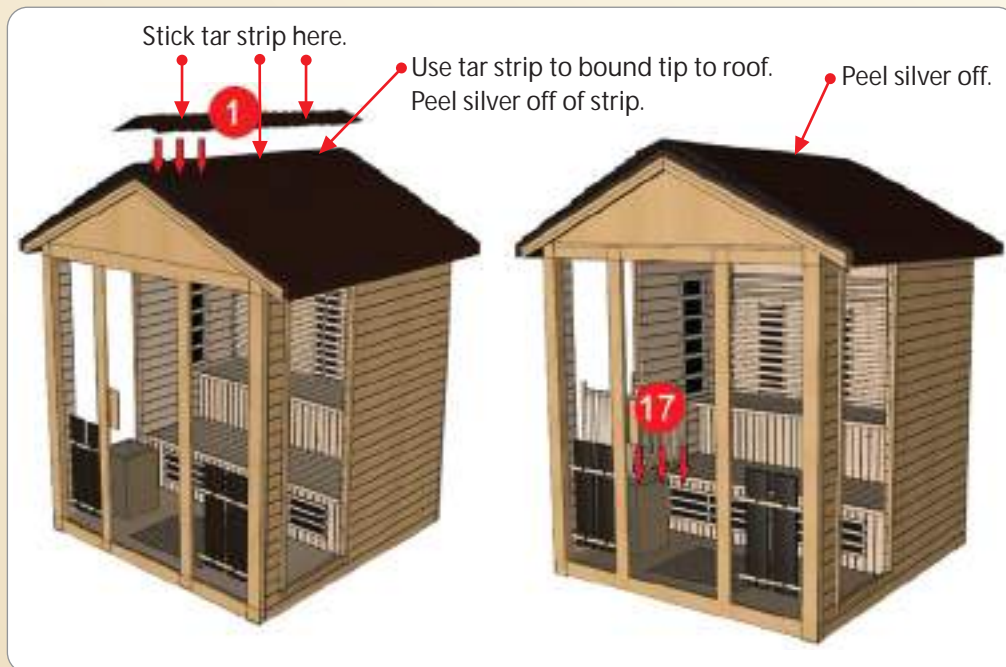

▶ Step 10



OPERATION INSTRUCTIONS

▶ Controller Functions

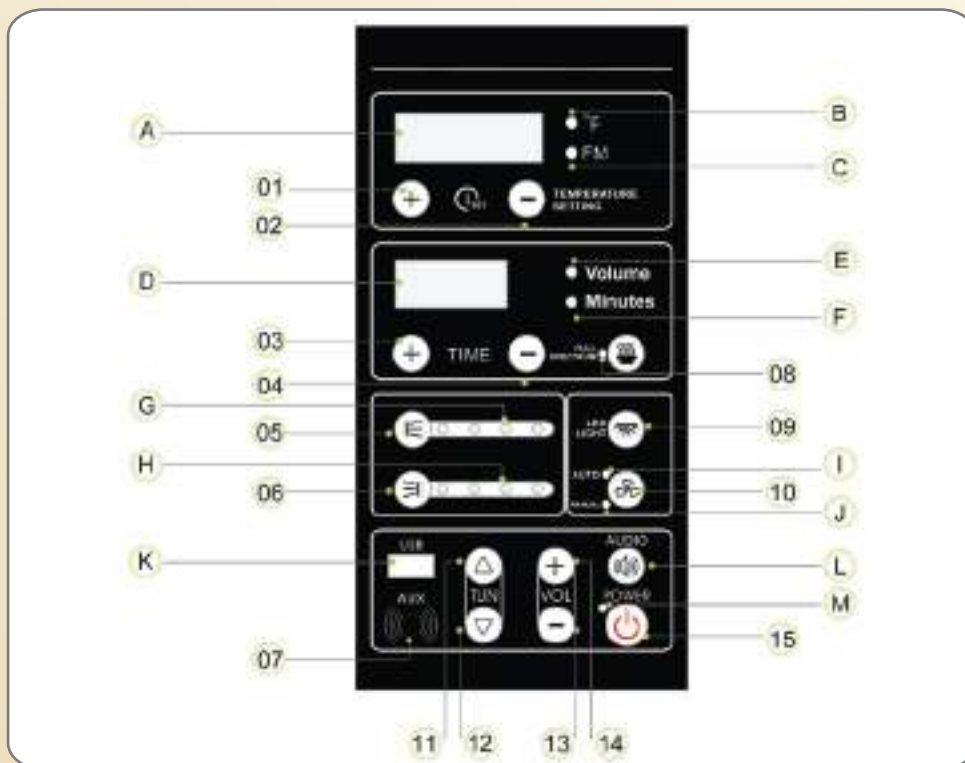

▶ Key

- | | | |
|---------------------------|--------------------------------|----------------|
| ① Temperature+ | ⑦ CD/MP3 input | ⑬ Volume+ |
| ② Temperature- | ⑧ Full spectrum infrared sauna | ⑭ Volume- |
| ③ Time+ | ⑨ LED light | ⑮ Power on/off |
| ④ Time- | ⑩ Fan | |
| ⑤ Infrared saunas group A | ⑪ FM frequency+ | |
| ⑥ Infrared saunas group B | ⑫ FM frequency- | |

▶ Display Areas

- | | | |
|-------------------------------------|------------------------------------------|--------------------------------|
| ① Temperature/FM | ⑥ Time setting indicator light | ④ Manual fan indicator light |
| ② Temperature indicator light | ⑦ Infrared sauna group a indicator light | ⑤ USB |
| ③ FM tuning indicator light | ⑧ Infrared sauna group b indicator light | ⑥ Music |
| ④ Volume/time | ⑨ Automatic fan indicator light | ⑦ Power on/off indicator light |
| ⑤ Volume adjustment indicator light | | |



OPERATION INSTRUCTIONS

▶ 1. Turn on/ Turn off

When the sauna is powered on, the power light indicator will turn on. Press it to turn the sauna on. Press the button "full spectrum" and the sauna will turn on.

▶ 2. Time/ Temperature setting

When the sauna is powered on, pressing the time +/time- button will increase or decrease the time by one minute. Holding down either time button lets you change the time more quickly. Time can vary between 1-60 minutes.

When the sauna is powered on, pressing the temperature+ or temperature- button will increase or decrease the temperature by five degrees. Holding down either temperature button lets you change the temperature more quickly.

Traditional sauna temperature can vary between 86-194 °F, while full spectrum infrared sauna can vary between 86-140 °F. Once your desired temperature is reached, the sauna will stop heating. When the temperature inside the sauna lowers, it will begin reheating automatically.

▶ 3. Multi-color therapy/ LED light

The multi-color therapy is controlled by the remote controller. Select any color buttons and the multi-color therapy will turn on. Press the power button to turn off the multi-color therapy. The LED light is controlled by the key on the control panel.

▶ 4. Fan function

When the sauna is powered on, press fan key to turn on the fan. When the fan is in auto mode, the sauna will stop heating and start using the fans.



OPERATION INSTRUCTIONS

▶ 5. Audio Function

You can switch through the sauna's multiple audio functions by toggling the device's AUDIO button.

Pressing the AUDIO button once will turn on the sauna's Bluetooth function.

Pressing the AUDIO button again (a second time) will turn on the USB function.

Pressing the AUDIO button again (a third time) will turn on the Radio function.

Pressing the AUDIO button again (a fourth time) will turn on the AUX function.

Pressing the AUDIO button again (a fifth time) will turn off voice function.



OPERATION INSTRUCTIONS

▶ WARNING

1. Do not change any electrical equipment yourself. If you experience any problems, ask a professional for help.
2. Do not touch the heater's surface after turning on the infrared function.
3. Do not use the product if you are apt to bleeding, have open or fresh wounds, suffer from heart disease, or have an extreme sensitivity to heat. If you have questions or concerns about your health regarding this device, consult your doctor.
4. Any children or disabled people using this product must be supervised by an adult.
5. Do not place flammable items near the sauna's heaters.
6. Power off the sauna before cleaning the cabin, replacing any parts, or removing any accessories or damaged parts.
7. Use caution when adjusting the volume on the speakers as high frequencies may damage the system.
8. Ensure the power cable is grounded reliably.
9. Pay attention to the rated voltage and power supply. If they do not match, then they cannot be used. Otherwise, it can damage the controller.

▶ NOTICE

1. The ideal using time is 30 minutes. The control system set time is 40 minutes.
2. The suitable temperature is 35-60 °C. Please adjust heater's temperature to match your needs.
3. Remove the power cable from its socket after use.
4. Make sure wires and sockets are securely connected before turning on the power.
5. After using the sauna for two cycles (60 minutes per cycle), turn off the heater for at least 30 minutes.

▶ REMINDER

1. In order to maintain the quality of the product, wait at least 30 seconds between cycles.
2. The control system continues to work even after turning off the heater or multicolor lamp. The best way to ensure the power is off is to unplug the sauna.
3. If a child is using this product, make sure they are not too close to the infrared lights so they are not injured.
4. In the case of an accidental shut down, wait a few minutes, then restart the sauna.
5. If at any time during the sauna you experience pain or discomfort, turn the sauna off immediately.
6. Before use, it is good to have something to drink (i.e. mineral water, fruit juice, vegetable juice, etc.) After use, it is good to have a bath or shower with water that is not too cold.

OPERATION INSTRUCTIONS

▶ MAINTENANCE

1. Use a general neutral liquid detergent to clean the product surface (surface contains: bamboo, composite boards, plastic, aluminum, plated and sprayed parts). Do not use strong alkaline cleansers or solvents (i.e. alcohol, thinner, ammonia, acetone, etc.).
2. Use a soft cloth to clean chrome-plated pieces. Never use rough tools.
3. Use fine sandpaper to polish wood surfaces if the surface is scratched or scraped.
4. Regularly open the door or window of the sauna to avoid mildew buildup.

▶ TROUBLE SHOOTING

Problem	Reasons	Remedy
No power	<ol style="list-style-type: none"> 1. Poor power connection. 2. Power failure of the leakage switch. 3. The fuse is off or damaged. 	<ol style="list-style-type: none"> 1. Make sure the power cable is connected. 2. Reconnect the leakage switch. 3. Replace the fuse.
No infrared	<ol style="list-style-type: none"> 1. The permanent temperature detector is off. 2. The heater plug is not well connected. 3. Infrared tube/board is damaged. 	<ol style="list-style-type: none"> 1. Turn the temperature off, then try again. 2. Reconnect the power cable. 3. Replace infrared tube/board.
No sound	<ol style="list-style-type: none"> 1. The volume is turned off or is too low. 2. The speaker is damaged. 	<ol style="list-style-type: none"> 1. Adjust the volume. 2. Replace the speaker.
No color light	<ol style="list-style-type: none"> 1. The sauna is turned off. 2. The multi-color lamp supply cord is loose. 3. The multi-color lamp is damaged. 	<ol style="list-style-type: none"> 1. Make sure the sauna is turned on. 2. Reconnect the supply cord. 3. Replace the multi-color lamp.
No fan	<ol style="list-style-type: none"> 1. The fan is off or automatic. 2. The fan supply cord is loose. 3. The fan is damaged. 	<ol style="list-style-type: none"> 1. Turn on the fan. 2. Reconnect the supply cord. 3. Replace the fan.



