

**ROSETTE/SHORT PLATE
PRE-ATTACHED
LEVER**

SINGLE CYLINDER HANDLESET

Note: Handlesets fit doors 1-3/4" to 2" thick.

A

USE INCLUDED DOOR PREPARATION TEMPLATE FOR NON-PREPARED DOORS.

USE INCLUDED PLASTIC TEMPLATE TO LOCATE AND DRILL THE 1/4" BOTTOM GRIP MOUNTING HOLE. (See note on reverse side.)

B

Install deadbolt and handleset latches.

C Latch tongue note

Bevel side of latch tongue should contact curved side of face plate, and curved side of strike plate.

D Deadbolt latch tongue note

E Install cylinder into plate

F Place cylinder assembly with plate on door exterior.

Attach deadbolt adaptor plate with provided screws.

G Attach thumbturn assembly with provided screws.

H Insert handleset spindle

IMPORTANT: SEE SPINDLE ORIENTATION NOTE IN NEXT PANEL.

I Spindle orientation note

Silver end of spindle must be in "Diamond" orientation while initially inserting into latch.

Once silver end of spindle is inserted, the gold end should be rotated to "Square" orientation before the spindle is completely inserted.

J

Install exterior handleset on door exterior.

MAKE SURE GOLD END OF SPINDLE IS IN "SQUARE" ORIENTATION. (see previous panel)

K

Install rosette/short plate with lever on door inside.

Tighten hex screw.

Insert bottom grip mounting screw.

L Install jamb strikeplate.

Exploded Drawing Single Cylinder Handset Rosette/Short Plate With Pre-Attached Lever

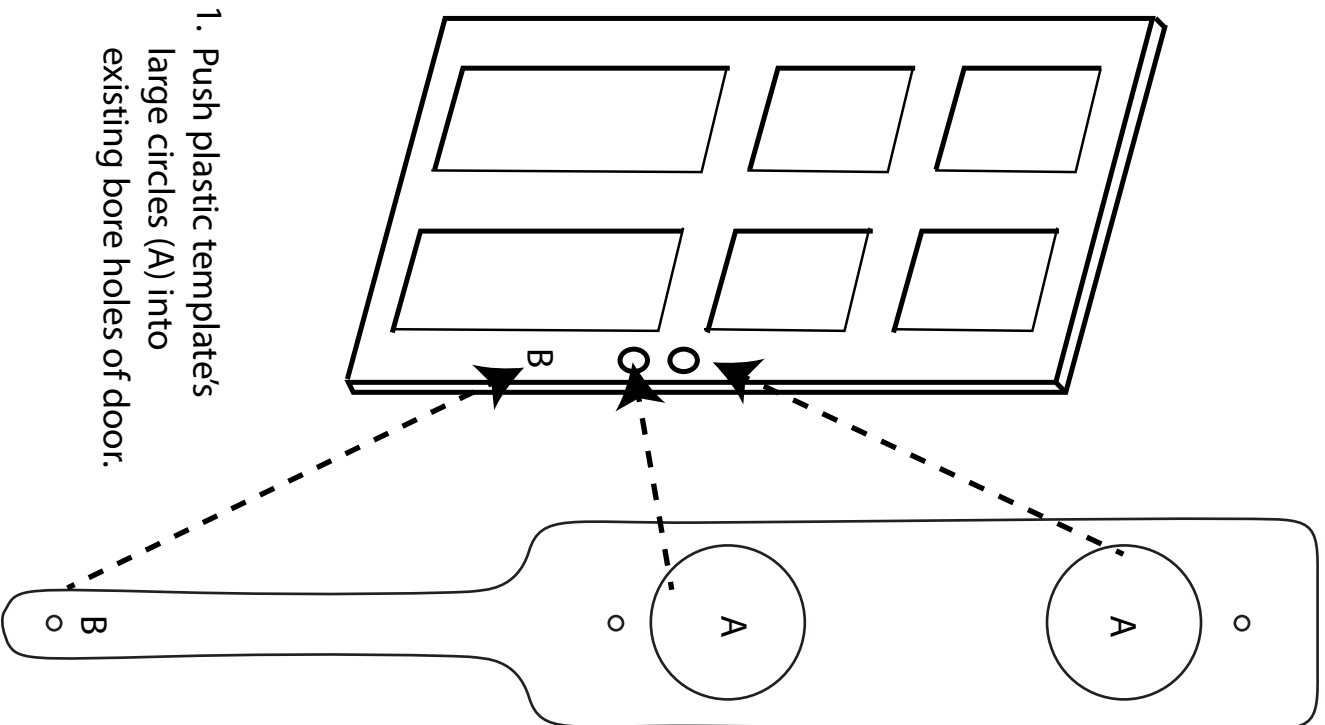

1. Push plastic templates large circles (A) into existing bore holes of door.
2. Use position of bottom hole (B) to mark and drill 1/4 inch bottom grip mounting hole.

<i>Part Number</i>	<i>Part Description</i>
1.	Deadbolt Latch
1A.	Latch Tongue
2.	3/4" Faceplate & Strike Wood Screws (8)
3.	Cylinder Assembly (W/Keys)
3A.	Cylinder Body
3B.	Tailpiece
3C.	Spin Ring
4.	Plate
5.	Deadbolt Adapter Plate
6.	2-3/8" Machine Screws (2) for 1-3/4" thick doors. 2-1/4" Machine Screws (2) for 2" thick doors.
7.	Thumbturn Assembly
8.	5/8" Thumbturn Machine Screws (2)
9.	Dustbox for Deadbolt
10.	Door Frame Reinforcer
11.	3" Reinforcer Wood Screws (2)
12.	Strike Plate for Deadbolt
13.	Handset Latch
13A.	Latch Tongue
14.	Latch Faceplate
15.	Handset Spindle
16.	Exterior Handset
17.	Rosette/Short Plate
18.	1-3/4" Machine Mounting Screws
19.	Lever
20.	Screw Cover Adapter
21.	2-1/2" Bottom Grip Mounting Screw for 1-3/4" thick doors. 2-3/4" for 2" thick doors.
22.	Mounting Screw Cover
23.	Dustbox for Handset
24.	Strike Plate for Handset

