

Long Plate Door Hardware

Installation Instructions

Updated June 2016

Passage

Fits doors 1-3/8" to 1-3/4" thick

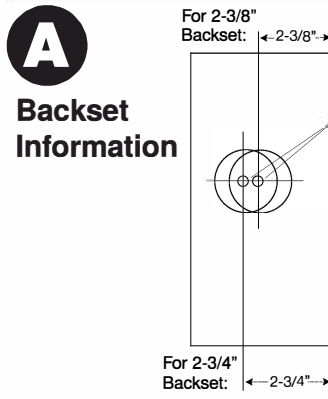

A Backset Information

NOTE:
DRILLING
TEMPLATES ON
SEPARATE
INCLUDED
SHEET

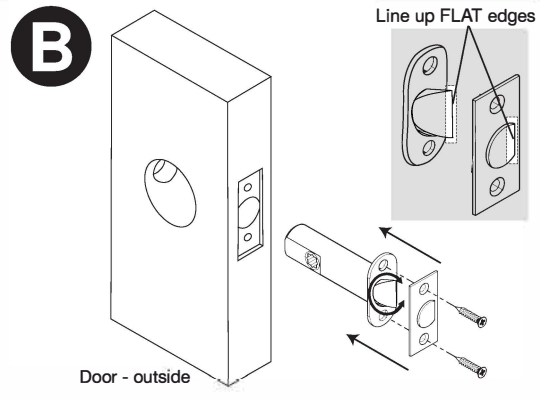

B

Door - outside

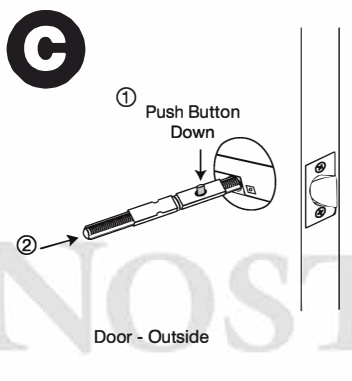

C

Door - Outside

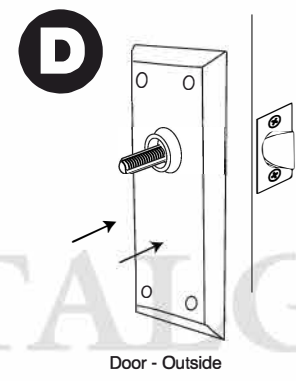

D

Door - Outside

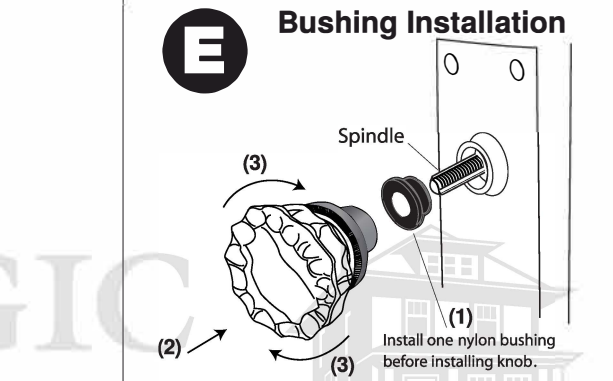

E Bushing Installation

Install one nylon bushing before installing knob.

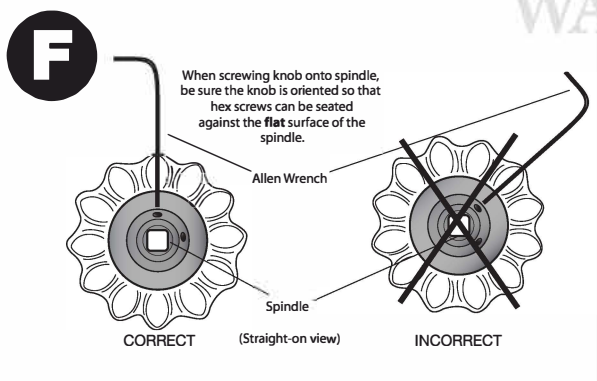

F

CORRECT (Straight-on view)

INCORRECT

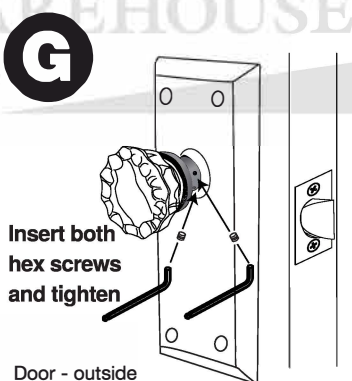

G

Door - outside

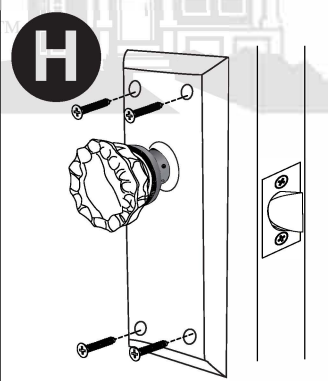

H

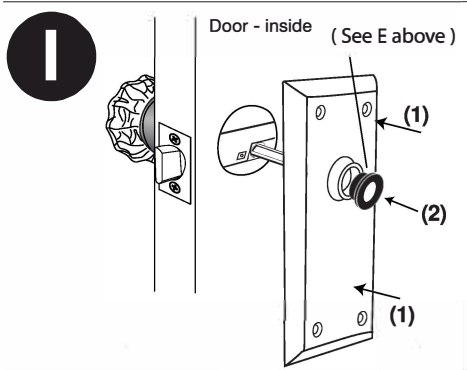

I

Door - inside (See E above)

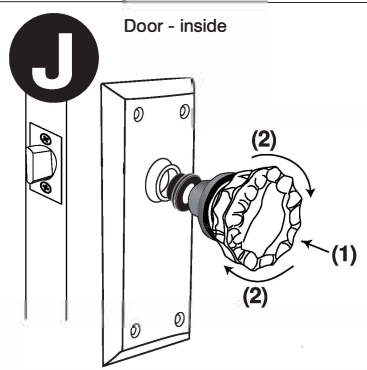

J

Door - inside

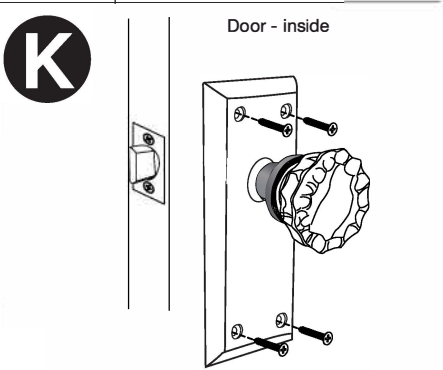

K

Door - inside

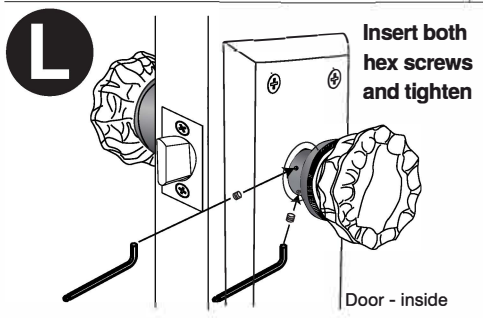

L

Door - inside

NOTE:
 If knobs do not turn freely;
 loosen one knob and rotate
 counter clockwise for
 1/4 turn, then retighten
 the hex screws.
 Repeat if necessary.

Need help?
 Please call us at
1-800-522-733
 Monday—Friday
 7 am—4 pm
 Mountain Time



Watch video