

 OFFNOVA

# DTF OVEN

## User Guide

DTF-A2



- Please read carefully before use

## ► Safety Instructions & Warranty

Read the instructions carefully before using this product.

1. Use this product in a horizontal and heat-resistant place, and keep away from heat sources to avoid damaging components.
2. When in use, the oven needs to be preheated, i.e., set the temperature and turn on the vacant burner for about 5 minutes so that the interior reaches the required baking temperature.
3. Cleaned parts and sprayed products should be left at room temperature (15-30 minutes) until flammable products have evaporated to a certain level before placing them in the oven for baking.
4. It is strictly forbidden to stack oil pots, oil drums, gas bottles, cotton yarn, cloth scraps, etc., near the oven is strictly forbidden to wash, scrape, or spray paint next to the oven.
5. It is strictly forbidden to clean the oven during operation and to wipe its surface with flammable objects such as petrol, Tannat water, etc.

## ► WARNING

- Make sure the power cord is well-connected and grounded reliably Before use.
- Make sure that the connected power supply is safely grounded.
- Unplug the product if you do not use it for a long time or before cleaning.
- Do not pull the plug by pulling on the wire.
- Do not touch the product in working condition to avoid burns.
- Avoid using this product in extreme temperature environments and exposing it to solid sunlight or moderately high temperatures.
- Do not move the product while it is in operation.
- Avoid sharing sockets with other high-power electrical appliances.
- Do not place this product near or on any electrical appliance.
- Keep the smoke extract vent clear, and do not insert foreign objects into the air vents.
- Check the product regularly. If the power cord is aging, please stop using it immediately.

## ► What's in the box



Power cord



Mounting screws  
Spare fuse



Handle



Insulation mesh



Conversion interface for  
smoke exhaust vent  
(Use with DTF Mini Purifier)



Manual

## ► Getting to know the DTF Oven

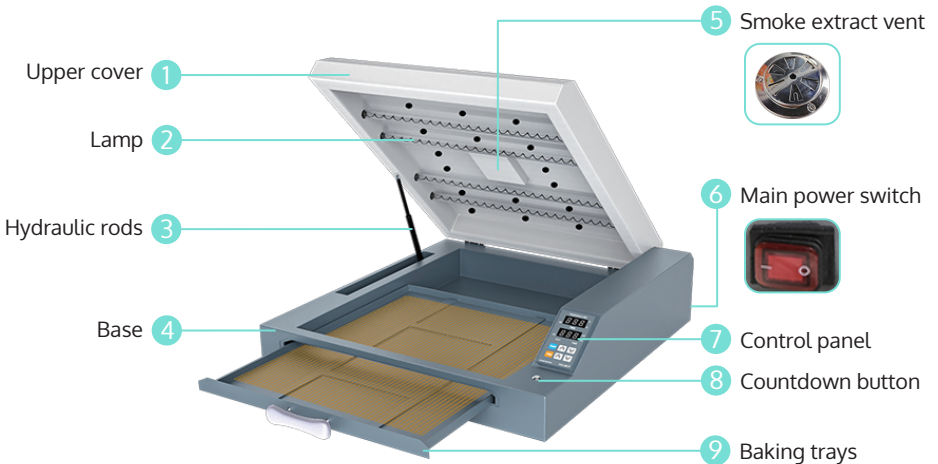

## ▶ How to operate the control panel

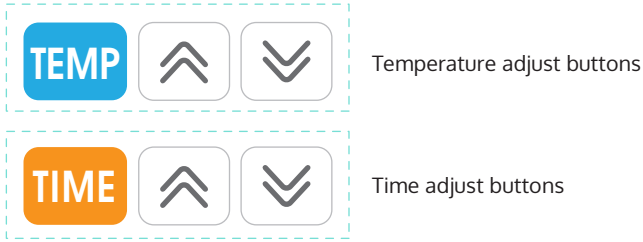

## ▶ Specification

Model: DTF-A2

Temp range: Ambient temperature~300°C/572°F

Time range: 0~999S

Power: 2250W

Voltage: AC 110V

Working area: 330 × 600 mm / 13" × 23.6" (suitable for A2/ A3/ A4/ A5 film)

Item size: 770 × 500 × 135 mm / 30.3" × 19.7" × 5.3"

## ▶ How-tos

**Step 1:** Unbox & use the accessory screws to install the baking tray handle.

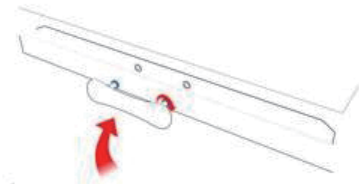

**Step 2:** Plug it in & turn on the power switch on the back of it.



**Step 3: Set time and temperature**

Note:

Default setting: 140°C/284°F for 400 seconds(No operation is required; it will automatically enter the default settings.)

Set time & temp:

Press **TEMP**, use **▲** **▼** to adjust temperature, then Press **TEMP** again to confirm

Press **TIME**, use **▲** **▼** to adjust time, then Press **TIME** again to confirm



**Step 4: Awaiting warming up to target temperature**

**Step 5:** After reaching the target temperature, pull out the baking tray and put the printed PET film on the drawer's insulating mat. Then, put the baking tray back into place and press the countdown button.

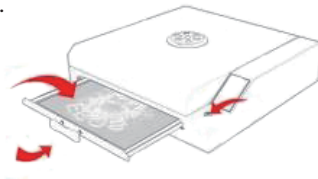

**Step 6: Remove the cured PET film when the timer beeps**

Note:

- a. The baking tray is very hot when working, please carefully remove the PET film.
- b. After the timer beeps, you need to press it once to turn off the beeps.

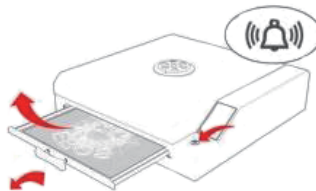

**Step 7: Press the power switch to turn off & unplug it**

## ► Cleaning and Maintenance

- Be sure to unplug the power plug before cleaning or maintaining this product.
- Do not clean or maintain the product while it is still hot
- Do not rinse this product directly with water or other liquids. Please keep the outside of the product dry.

## ► FAQ

**Q1:** What are the DTF oven maintenance cleaning hacks and tips?

**A:** Please ensure that the power is turn off completely before performing the following cleaning operations.

Step 1: Open the top cover

Step 2: Cleaning the inside of the (lamp/tray)

Step 3: Close the top cover

Step 4: Dismantling the chimney and cleaning the inside of the chimney

Step 5: Installation of chimneys

Step 1:

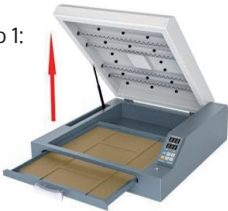

Step 2:



Step 3:



Step 4:



Step 5:



**Thank you so much for the purchase!**

Register and get extended warranty

[www.offnova.com](http://www.offnova.com)