



How to:
Unbox and
Assemble

FLY

Welcome to your new E-Trends Fly Electric Bike. Let's get started.

Carefully unpack the components and remove all of the transit packaging.



Take your time to read the manual and keep it for future reference.

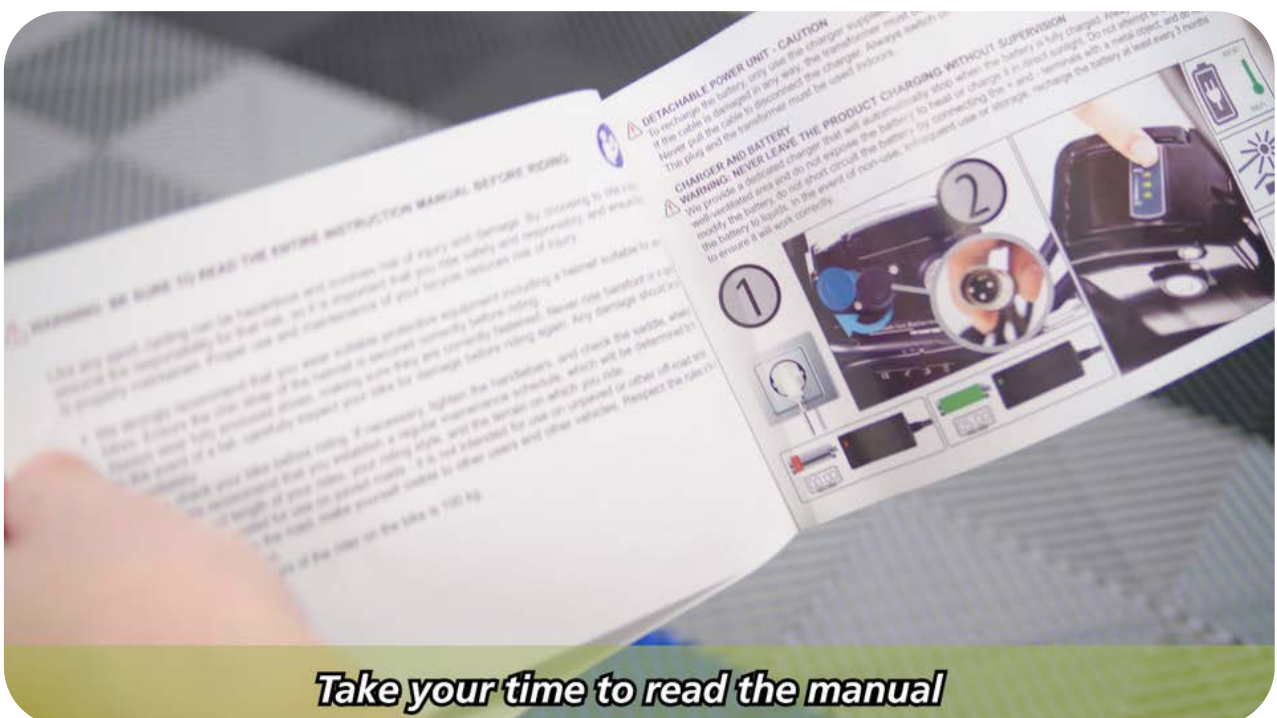

You should have all the parts you see here.



Fold out the frame and secure with the clamp as shown here.



Insert the steering stem into the head tube making sure the tapered nut is on the end of the bolt.



Straighten handlebars and tighten bolt with the tool supplied.



Fold up the handlebars and secure with the clamp.



Attach the pedals, noting that these are left and right-handed. These must be fitted on the correct side. Fasten the pedals securely with the spanner provided.



Remove the keys from the seat clamp.



Insert the seat post, adjust the height and secure it. Make sure the clamp is tight.

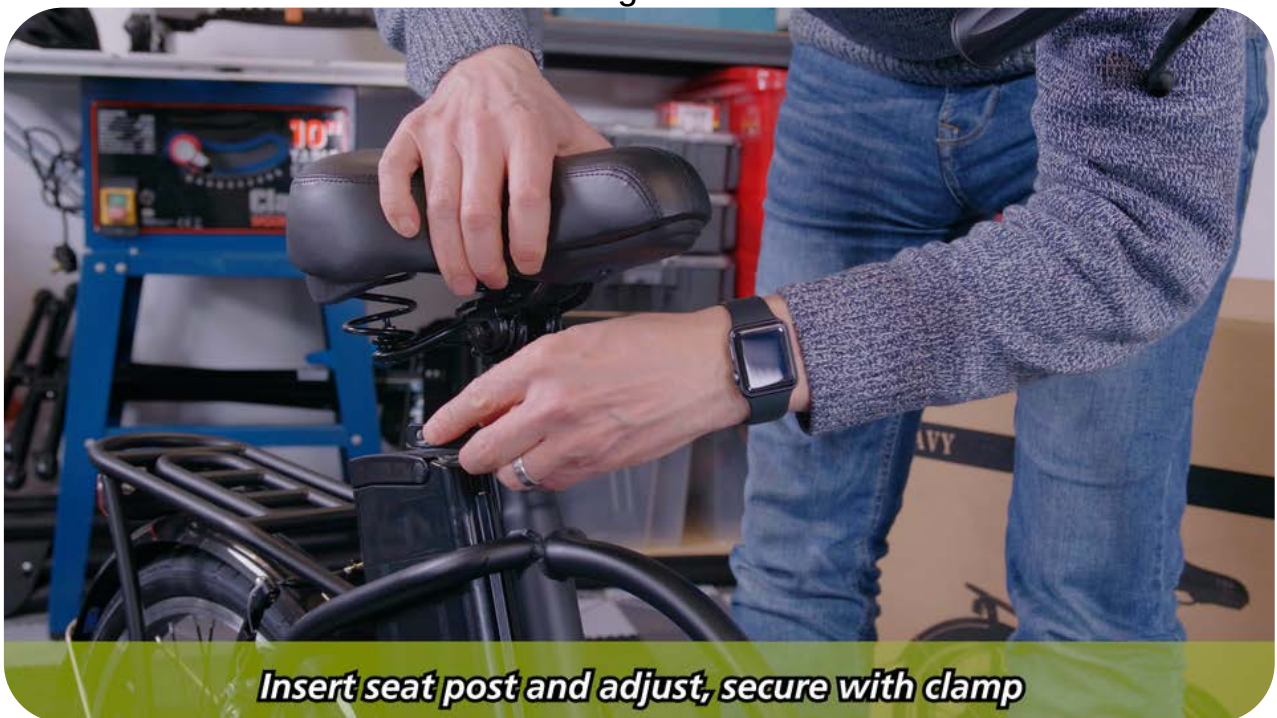

Adjust the height of the handlebars. Secure them with the clamp.



Use the hand-pump supplied to inflate front and rear tyres. Attach the hose to the tyre valve as shown. Inflate until each tyre is very firm to press.





How to:
Charge

FLY

Here's how to charge your Fly e-bike battery.

With the battery turned off insert the socket into the battery and plug into the mains.



Charge time is approximately 4-5 hours.



The battery can also be charged without being in the bike.



Press the button to see how much the battery is charged. This row of lights indicates the charge level.



The battery should be charged up at least every 3 months to ensure it works correctly, even if the e-bike has not been used.



The battery should be charged at least every 3 months

FLY





How to: Ride your e- bike

FLY

You are ready to ride your Fly e-bike!

Insert and turn the key to switch on.



Press buttons to turn on lights on & off and operate the horn.



Use the twist grip to provide up to 3.75 miles or 6km/hr assistance, either when walking alongside the bike or when starting off.



Use the twist grip to provide up to 3.75mph or 6km/hr assistance,

Otherwise, pedal to start the bike. Power assistance is provided for speeds up to 15.5mph or 25kmh.



Otherwise, pedal to start the bike, up to speeds of 15.5mph or 25km/hr of assistance



Enjoy your new ride



For post sales support call us on 01702 208175 or
email us at trends@jgdirect.net

FLY