

# Euky Bear™

## Sweet Dreams

The essential baby sleep aid

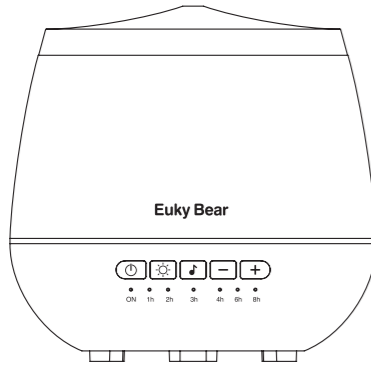

OPERATING MANUAL - MODEL 981

### FEATURES

- Pink noise & soothing sounds
- Red light sleep therapy
- 8 colour changing lights
- Aromatherapy diffuser
- Humidifies the air
- Safe & cool to touch
- Up to 10 hours mist operation
- Mist timer control: 1hr, 2hr, 3hr, 4hr, 6hr, 8hr
- Low water mist auto switch off
- Water capacity 300mL
- 1 year warranty

Please read the Operating Manual carefully and retain for reference.

**How Euky Bear Sweet Dreams works:** Combines aromatherapy, light and sound to create the ultimate sleep aid.

**Aromatherapy mist** Using high frequency oscillation (vibration), water and essential oils are converted into a fine mist and dispersed into the air.

**Light therapy** Red light therapy, scientifically known to encourage melatonin production to assist sleep. Plus choice of 7 more colours and rainbow function.

**Sound therapy** Soothing sounds, carefully crafted and chosen to relax and calm baby for sleep.

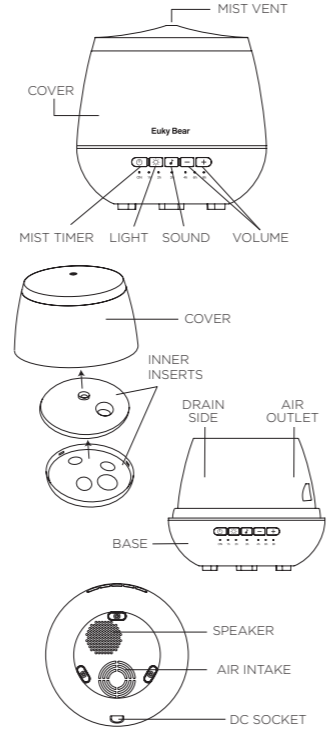

### OPERATING INSTRUCTIONS

- 1 Holding upright, carefully lift cover to remove. DO NOT tilt the unit if there is water remaining.
- 2 Connect the DC adapter into the DC socket in the base of the unit.
- 3 Add clean, cold filtered or tap water to the water tank using the measuring cup, without exceeding the maximum waterline (300mL). DO NOT spill any water outside the tank. DO NOT use hot water or refill while the unit is in operation.
- 4 Add 4-6 drops of Euky Bear Baby Essential Oils to the water.
- 5 Place the cover back on the water tank. To avoid spillage, DO NOT tilt the unit.
- 6 Plug the AC adapter into the power supply.
- 7 Place on a stable surface at least one metre away from cot or bed.
- 8 Choose your desired mist, light and sound settings (see next page).
- 9 If the unit is not going to be used for a long time, drain any remaining water, clean with diluted mild kitchen detergent and ensure the unit is completely dry before storing away. Ensure unit is disconnected from the power supply when cleaning.

### BUTTON FUNCTIONS

- Mist Settings:**
- First press: Continuous mist mode
  - Second press: 1hr mist timer
  - Third press: 2hr mist timer
  - Fourth press: 3hr mist timer
  - Fifth press: 4hr mist timer
  - Sixth press: 6hr mist timer
  - Seventh press: 8hr mist timer
  - Eighth press: Mist off
  - Hold down: Turns off all functions on unit
- If there is no water inside the water tank, or if the water level runs low, the mist will automatically stop operating. Light and sound function will continue.
- Sound Settings:**
- First press: Pink noise
  - Second press: Heart beat
  - Third press: Waterfall
  - Fourth press: Lullabies
  - Fifth press: Sound off
  - Hold down: Sound off only



- Light Settings:**
- First press: Fixed red light
  - Second press: Breathing red light (fade in & out)
  - Third press: Rainbow colour changing mode - cycles 8 colours
  - Fourth press: Fix on any colour while in rainbow mode
  - Fifth press: Light off
  - Hold down: Light off only

For sleep, use red light or breathing red light only. Other colours not recommended for sleep.

- Volume Settings:** - +
- Press or hold volume buttons to reduce/increase volume.

### MAINTENANCE

To ensure your unit stays in optimum condition, we recommend that you follow the operating and maintenance instructions carefully. Follow the steps below if the unit has been used for 5-6 times or for 2-3 days.

**STEP 1:** Disconnect the AC adapter from the power supply. Take off the cover while keeping the unit stable. Disconnect the DC plug from the unit.

**IMPORTANT: DO NOT** press heavily or scratch the ultrasonic vibration mechanism in the water tank during cleaning.

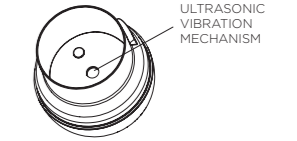

**STEP 2:** If there is water left in the tank, pour it from the drain side. DO NOT pour from the air outlet side as water may flow into the unit and cause malfunction.

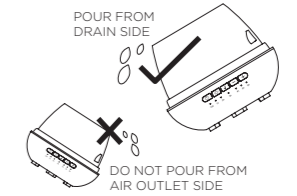

**STEP 4:** If there is any dirt inside the mist vent, remove the cover and inner inserts to clean it.

Re-insert the inner inserts by lining them up and clicking them into the top underside of the cover. Install the cover.

**STEP 3:** Use a damp cloth or cotton bud with water or diluted mild kitchen detergent to clean the outside or inside of the unit.

**STEP 5:** Add water into the tank with the measuring cup. Place the cover on. Run the unit for 30 minutes. Pour out remaining water and rinse the water tank.

**DO NOT** use chlorine, acidic (vinegar) or enzyme-based detergents to clean the outside or inside of the unit.

## THINGS TO NOTE

- Suitable for use 0 months +. For premature babies seek advice from a health professional before use.
- The amount and intensity of mist produced will vary, but this is not unusual and should not be considered as a fault. Factors that affect amount and intensity include water type, humidity, temperature and air currents.
- Only 100% natural essential oils can be used in the unit. Those containing chemical fragrance, spice or impurities will cause malfunction and void the warranty.
- Add 4-6 drops of Euky Bear Baby Essential Oils (suitable from 3 months +). Too much essential oil may clog the system and cause malfunction. Clean the unit as per the Maintenance instructions, before changing to a new type of essential oil.

## ACCIDENTAL LEAKAGE

In the event of the unit being knocked over or tipped during use, please follow the steps below to avoid malfunction.

- 1 Unplug the unit and remove cover.

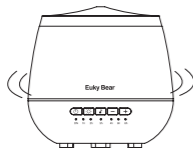

- 2 Pour any remaining water out of the water tank from drain side.

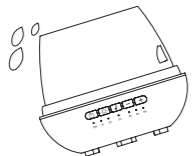

- 3 Shake the unit gently to drain any water from inside the mechanism and then allow to dry for at least 24 hours.

## PRECAUTIONS AND SAFETY WARNINGS

To ensure your unit stays in optimum condition and for safety in operation, please follow the instructions below:

- Do not fill the unit to over 300mL.
- Do not touch the ultrasonic vibration mechanism.
- Clean regularly as per Maintenance instructions to avoid malfunction.
- Always unplug from power supply before cleaning or maintenance.
- For hygiene reasons, after use, drain remaining water from "DRAIN SIDE" of tank and wipe with a clean, dry cloth.
- Essential oils can stain. In the event of spillage or contact to surfaces, please wipe away with a soft cloth.
- Only use the measuring cup provided to add water to the tank. Never fill directly from the tap.
- Do not let mist blow directly onto furniture, clothing, walls etc.
- Keep away from direct sunshine and heat sources.
- Always keep on a stable flat surface, at least 1 metre away from cot or bed.
- Keep away from electronic equipment such as computer, TV and audio equipment.
- Do not tip the unit as this may cause water to enter the mechanism and cause malfunction.
- Use filtered or tap water only. Do not use hot water, mineral or sparkling water.
- Do not touch any part of the unit with wet hands.
- Keep out of reach of children and pets. This appliance is not to be used by persons with reduced physical, sensory or mental capabilities, lack of experience and knowledge, unless they have been given supervision or instruction.
- Do not cover the unit or block the mist outlet.
- Do not use the unit if the power lead has been damaged or the socket is loose.

## TROUBLESHOOTING

Please refer to the table below in the event of the unit operating abnormally:

ISSUE	POSSIBLE CAUSE	SOLUTION
Mist switching off too early	<ul style="list-style-type: none"> <li>• Is there enough water in the tank?</li> <li>• Is the power cord connected properly?</li> </ul>	<ul style="list-style-type: none"> <li>• Add water to the tank.</li> <li>• Disconnect, check cables and re-connect carefully.</li> </ul>
No mist or abnormal mist	<ul style="list-style-type: none"> <li>• Not enough water</li> <li>• Too much water</li> </ul>	<ul style="list-style-type: none"> <li>• Add suitable amount of water in the tank.</li> <li>• Water must never be filled over 300mL (MAX) line.</li> </ul>
	<ul style="list-style-type: none"> <li>• Dirt on the Ultrasonic vibration mechanism</li> </ul>	<ul style="list-style-type: none"> <li>• Refer to Maintenance Instructions.</li> </ul>
	<ul style="list-style-type: none"> <li>• Cover and inner inserts are not installed properly</li> </ul>	<ul style="list-style-type: none"> <li>• Remove and re-install inner inserts correctly, so vapors can be released freely. Ensure both inner inserts are clicked into top underside of the cover.</li> </ul>
Water leakage from the unit	<ul style="list-style-type: none"> <li>• Dirt on the air intake port on the underside of the base</li> </ul>	<ul style="list-style-type: none"> <li>• Clean the air intake port of any dust. Restricted airflow will affect the mist.</li> </ul>
	<ul style="list-style-type: none"> <li>• Cover and inner inserts are not installed properly</li> </ul>	<ul style="list-style-type: none"> <li>• Remove and re-install inner inserts correctly, so vapors can be released freely. Ensure both inner inserts are clicked into top underside of the cover.</li> </ul>
	<ul style="list-style-type: none"> <li>• Has the unit been tipped over?</li> </ul>	<ul style="list-style-type: none"> <li>• Follow accidental leakage instructions.</li> </ul>
No light	<ul style="list-style-type: none"> <li>• Low temperature or high humidity in the room</li> </ul>	<ul style="list-style-type: none"> <li>• Under these conditions, the mist may condense quickly into water droplets.</li> </ul>
	<ul style="list-style-type: none"> <li>• Light button is not pressed</li> </ul>	<ul style="list-style-type: none"> <li>• Disconnect, check cables and reconnect carefully. Press the LIGHT button to activate.</li> </ul>
No sound	<ul style="list-style-type: none"> <li>• Sound button is not pressed</li> </ul>	<ul style="list-style-type: none"> <li>• Disconnect, check cables and reconnect carefully. Press the SOUND button to activate and check volume settings.</li> </ul>

## SPECIFICATIONS - MODEL 981

Dimensions	Approx. 140mm x 130mm
Weight (excluding adapter)	Approx. 338g
Power: Input/Output	AC100-240V/DC 24V 500mA
Timer Modes	ON 1h 2h 3h 4h 6h 8h
Water Capacity	300mL
Accessories	AC Adapter Measuring Cup Operating Manual Sleep Booklet
Ultrasonic Frequency	2.4mHz
Speaker volume	<70 dB
LED Light	8 colours

## 1 YEAR WARRANTY

This product has been produced with the greatest care for normal, household use. Following directions carefully will ensure dependable operation. If you experience unsatisfactory operation or are dissatisfied with your Euky Bear Sweet Dreams Sleep Device (Model 981) please contact our friendly Customer Service team at FGB Natural Products.

Modification to the product by the consumer or failure to follow the manufacturer's operating instructions will void the warranty.

If repair is required under the warranty period, the product should be returned with proof of purchase.

The purchaser assumes responsibility for the proper care and use of the product in accordance with the printed Operating Manual. The purchaser or user must make his or her judgment as to when to use the product and the length of use. Keep the Operating Manual available as it is your guide to safe, efficient operation.

Our goods come with guarantees that cannot be excluded under the Australian Consumer Law 2011. You are entitled to a replacement of the faulty unit or refund for a major failure.

**For warranty claims please call 1800 655 841**