

Product Specification 45° Bends

Overview

- Fits the AS:1528.3 standard
- Standard New Zealand dairy dimensions
- 1.5D nominal centreline radius

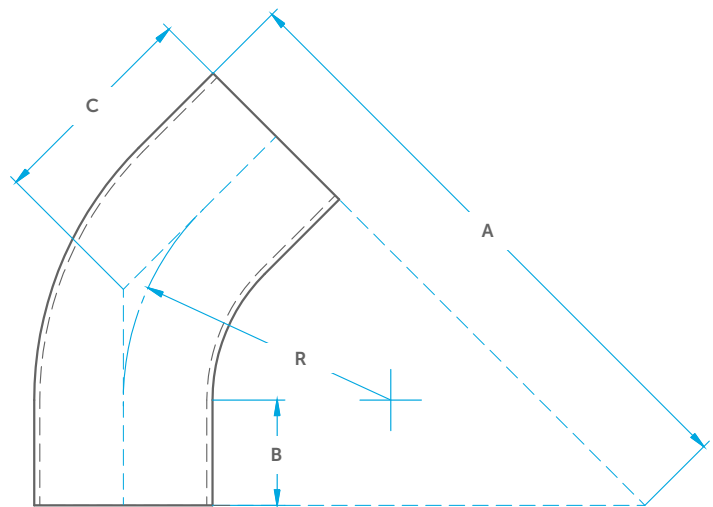

45° UNI (AS:1528.3) / 45° NEW ZEALAND



Diameter mm	WT mm	Product Code		Dim A mm	Dim B mm	Dim C mm	Radius* mm	Weight Per Unit kg	Standard Pack size
		304	316						
19.1	1.6	N/A	07664U	110.5	30.0	41.8	28.7	0.06	10
25.4	1.6	10644U	10664U	123.0	30.0	45.7	37.1	0.08	10
31.8	1.6	12644U	12664U	136.0	30.0	49.8	47.6	0.12	10
38.1	1.6	15644U	15664U	148.0	30.0	53.4	57.2	0.12	10
44.5	1.6	17644N	17664N	193.6	38.1	71.0	79.4	0.23	60
50.8	1.6	20644U	20664U	174.0	30.0	61.6	76.2	0.23	60
63.5	1.6	25644U	25644U	199.0	30.0	69.3	95.3	0.32	32
76.2	1.6	30644U	30664U	225.0	30.0	77.4	114.3	0.43	20
101.6	1.6/2.0	40644U	40664U	275.0	30.0	92.9	152.4	0.66	18
127.0	1.6/2.0	50644U	50664U	350.6	40.0	118.9	190.5	1.12	4
152.4	2.0	602044U	602064U	401.4	40.0	134.7	228.6	2.00	3

TOLERANCES

Diameter ± 0.5% of OD

Square Target <0.2mm, Max 0.4mm

Dim A ± 1.5mm

Dim B/C Nominal

Radius Nominal

POLISH FINISHES

OD Polish 'P' Suffix on stock-code

*Nominal dimensions only. Typically a bend is formed to a slightly tighter radius to allow for radial growth and springback. The 'A' dimension will always be correct. If the radius dimension is critical to your end use please contact us to discuss options.