

2019-2024 RAM 1500 DT, REBEL

AUXBEAM SWITCH MOUNTING KIT

130196 & 130197 (5.7 HEMI), 130196 & 130199 (3.0 ECODIESEL)

INSTALLATION INSTRUCTIONS

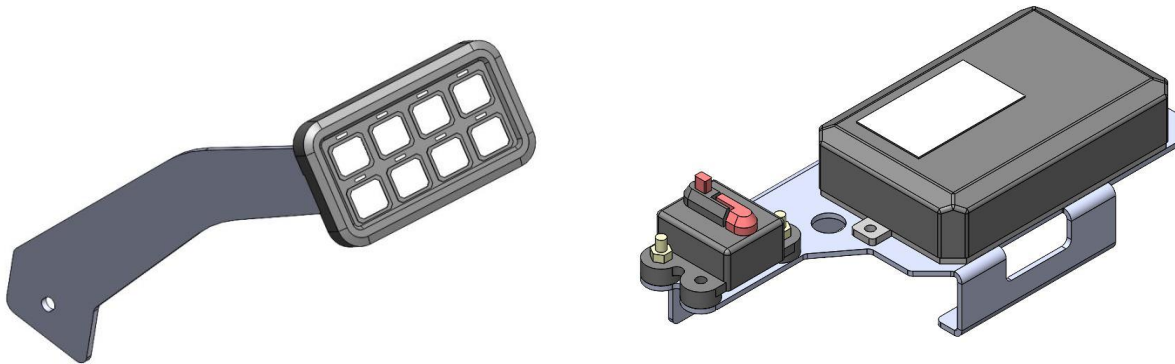

SAFETY

Your safety is extremely important to us. Working on vehicles has ever-present hazards which require precautions at all times to avoid injury or death. We've outlined some precautions to take below in order to help you make informed decisions about your safety before installing this product. This is not an exhaustive list, and you must use your own good judgment before performing any work in each step of this installation.

ALWAYS:

- wear eye protection
- use tire blocks and emergency brake
- disconnect battery(s)
- use care when moving components
- route electrical cables away from moving parts
- identify all pinch points
- wear gloves
- identify slipping and tripping hazards
- wear steel toe footwear
- understand proper use of tools before use
- work on a flat surface
- use care when lifting components
- insulate cables
- jack your vehicle from the OEM's lifting points
- torque all fasteners to suggested specs
- remove any hazards before starting on the job

LIABILITY

All liability for installation and use of this product rests with the owner. Improper installation, maintenance, and operation can result in serious injury or death as well as equipment or vehicle damage. Use this product at your own risk

KIT COMPONENTS

130196 - AUXBEAM 8GANG CAB BRACKET ASSEMBLY

ITEM NO.	PART NUMBER	DESCRIPTION	QTY.
1	100216	Auxbeam 8gang Cab Bracket, 2019-2024 RAM [5th Gen]	1
2	240199	Black Plastic Unthreaded Spacer, 3/4 Long, 3/4 OD, 1/4 ID	1
3	240200	M6-1.0 x 45mm Hex Flange Bolt	1
4	240198	Push-In Rubber Bumper, 1/8 Material, 1/4" ID , 7/16" OD, 3/16" Tall	1
5	240185	M6-1.0 x 14mm Zinc SHCS	2
6	240201	M6 Washer, Zinc	2
7	240202	M6 Flange Nut, Steel Zinc	2

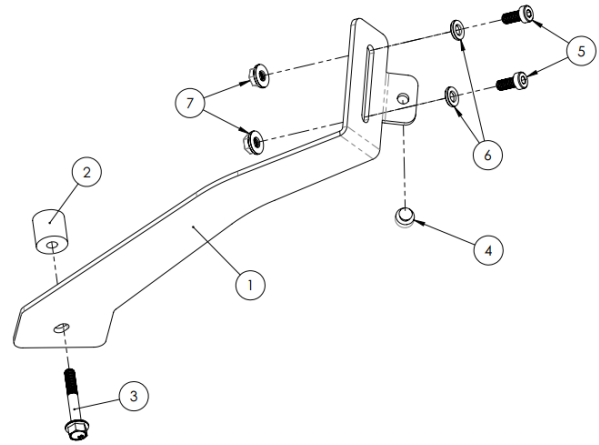

130197 – AUXBEAM SWITCH MOUNTING ENGINE BRACKET ASSEMBLY (5.7 HEMI)

ITEM NO.	PART NUMBER	DESCRIPTION	QTY.
1	100217	Auxbeam Switch Assembly Mounting Bracket , 2019-2024 RAM 1500 5.7 HEMI [5th Gen]	1
2	240201	M6 Washer, Zinc	4
3	240185	M6-1.0 x 14mm Zinc SHCS	2
4	240202	M6 Flange Nut, Steel Zinc	4
5	240114	M6-1.0 x20mm Socket Head Screw	2
6	200110	Rubber Grommet, 7/16 Hole, for 11/16 Hole, 1/8 Material Thickness	1
7	240198	Push-In Rubber Bumper, 1/8 Material, 1/4" ID , 7/16" OD, 3/16" Tall	2
8	200113	1/4 SPLIT LOOM, BLACK PLASTIC (INCHES)	48.0
9	200109	Black Zap Strap, 8 Inch	6

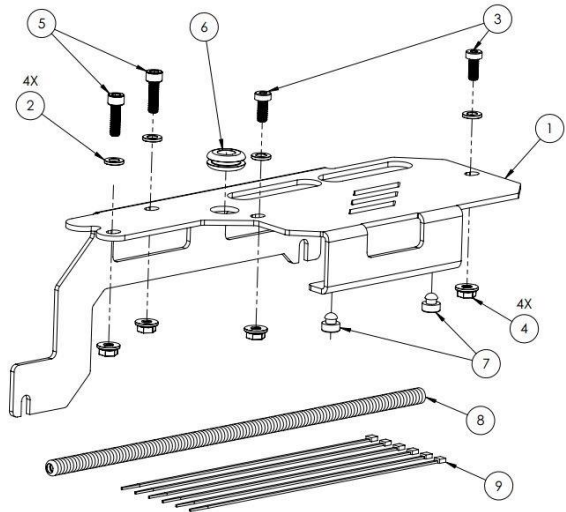

130199 - AUXBEAM SWITCH MOUNTING ENGINE BRACKET ASSEMBLY (3.0 ECODIESEL)

- Substitute bracket 100215 for 100217 in above BOM

SET UP

1. Read this entire document before performing any work.
2. Ensure you have all the parts and hardware shown in Kit Components. Unpack everything from our kit as well as the Auxbeam BA80 Switch Panel Kit (sold separately)
3. Gather the tools required, outlined in **Table 1**.

Table 1

Tool List	
<input type="checkbox"/>	Metric Socket Set
<input type="checkbox"/>	4mm Allen Key
<input type="checkbox"/>	Electrical Tape
<input type="checkbox"/>	Clip Pry Tool / Small flathead Screw Driver
<input type="checkbox"/>	Side Cutters

4. Install the Auxbeam Switch Assembly (fuse panel) onto the engine bracket as per figure 1 below. Ensure to line up the wiring slots on the bottom side of the Auxbeam unit, with those on the bracket. Fasten down the Switch Assembly using provided M6x14mm socket head cap screws, washer, and flange nut. A
5. Install the rubber wiring grommet into the 3/4" hole.
6. Install the 60A Breaker onto the engine bracket using the longer M6x20 socket head cap screws, washer and flange nuts.

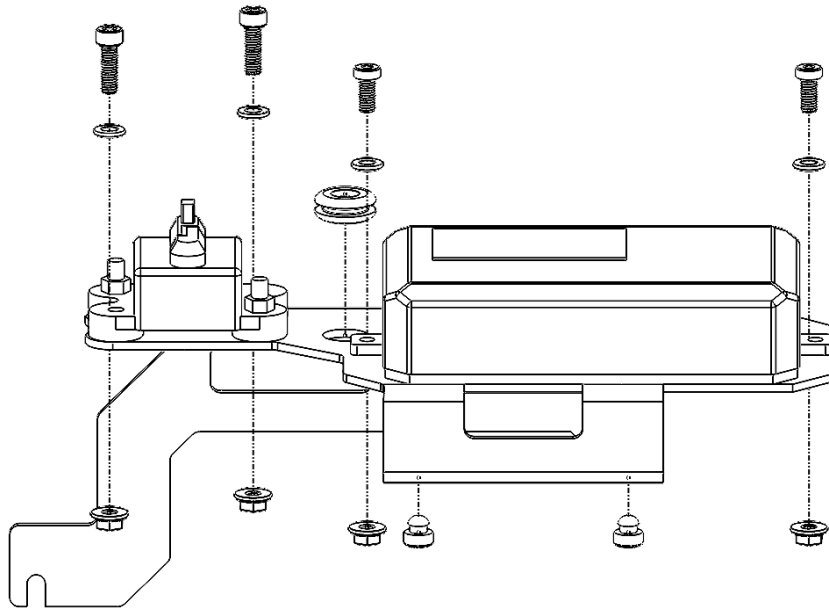

Figure 1

7. Install the two rubber mounting feet into the bottom two 0.25" holes on the engine bracket.

8. Locate the two red 8 gauge wires from the Auxbeam kit. Cut the plastic loom (provided in our kit) to the length of these cables, and slide it over them and secure the loom in place with zip ties or electrical tape.
9. Slide the shorter red cable down through the rubber grommet in the engine bracket, and up into the Switch assembly. Attach it to the red positive terminal beside the fuses. Secure the other end to the 60A breaker terminal (Red Circles, Figure 2)

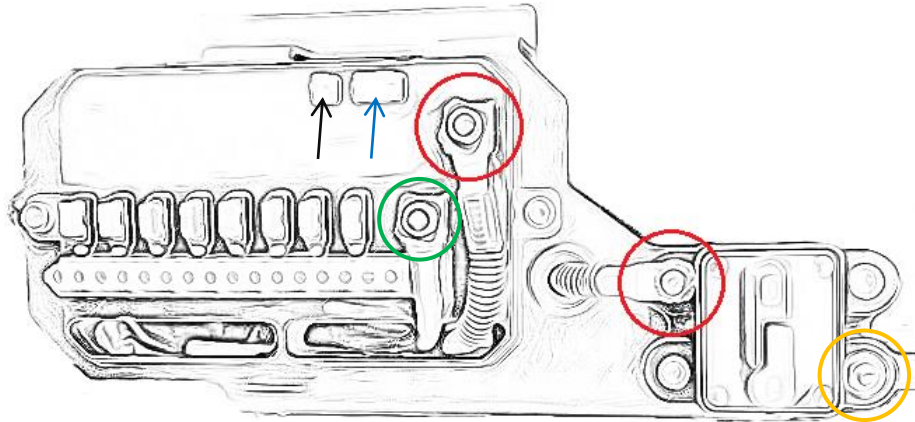

Figure 2

10. With your vehicle in park on flat ground and e-brake applied, pop the hood and disconnect the battery negative terminal using a 10mm socket. Tie the battery terminal out of the way so that it cannot make contact with the battery.
11. Using an 8mm socket, loosen off (but do not completely remove) the fasteners holding the ECU mounted to the vertical plastic pillar adjacent to the battery. Positions for the fasteners on the Gas trucks are circled in red, Ecodiesel circled in yellow in Figure 3.

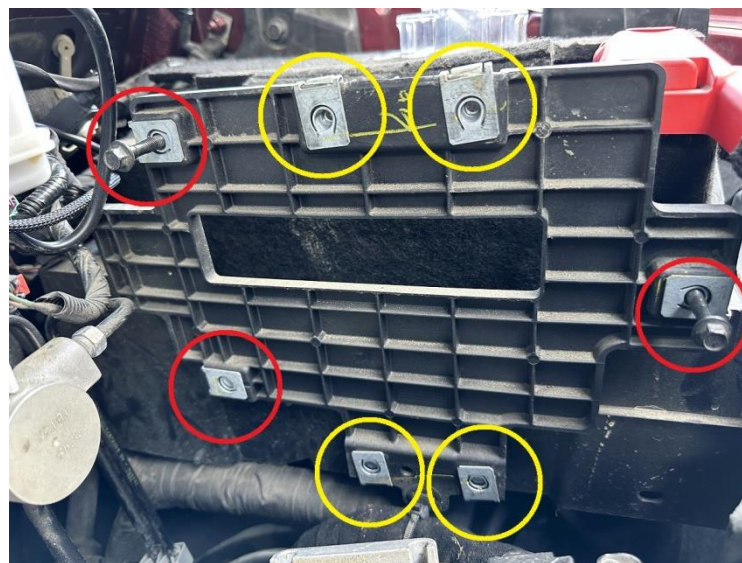
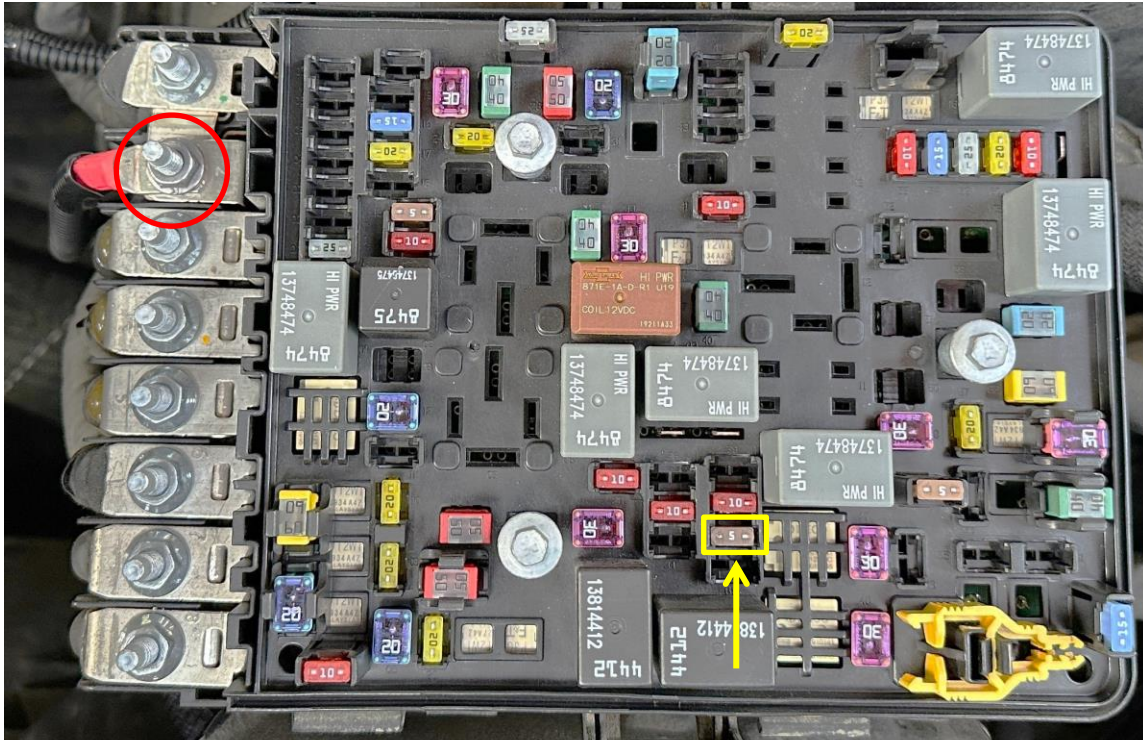

Figure 3

12. Slide the slots in the engine bracket over the top two fasteners, pinching the bracket between the ECU and plastic pillar. The rubber feet on the bracket will rest on the battery blanket.
13. Locate the ACC wire (small diameter wire with plastic connector) and Micro piggyback fuse tap (the smaller fuse Auxbeam Supplies). Trim the ACC wire to approx 24" and crimp it to the piggyback Fuse Tap. Cover the assembly with the rest of the 1/4" loom as per step 8.
14. Connect the ACC wire to the plug in the Switch Assembly plug (Black arrow Figure 2)
15. Remove the 5amp microfuse in spot #37 in the engine bay fuse box, and insert it into the empty port on the micro fuse tap. Plug the assembly back into #37 Fuse port (Yellow Box, Figure 4)



FRONT OF TRUCK

Figure 4

16. Install the supplied rubber grommet into the Auxbeam 8-gang cab bracket as shown in the BOM.
17. Install the Auxbeam 8-gang panel onto the interior bracket using the supplied M6 x 14mm hardware, washer, and flanged nut. Leave it finger tight so you can adjust the angle you'd like once installed in the truck.
18. On the drivers side, locate and remove the square panel on the center console using a plastic panel tool or a small flathead screwdriver.
19. Install the Cab Bracket using the M6 x 45mm Flange bolt, pinching the black spacer between the bracket and the center console. Slide the Auxbeam panel in the slots until you are happy with the positioning. Remove the bracket, tighten down the fasteners, and re-install. The finished assembly is shown in Figure 5.



Figure 5

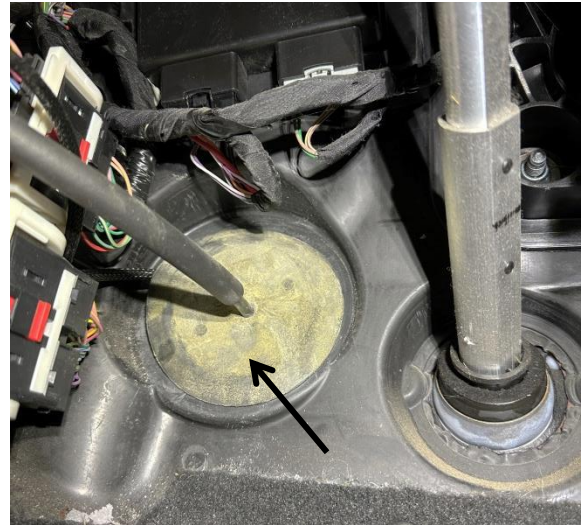

Figure 6

20. Back in the engine bay, plug the 4-Pin Controller Harness into the Switch Assembly Port (blue arrow Figure 2). Route the cable through the opening in the engine bracket and towards the truck firewall.
21. Route the 4 pin cable through the firewall. The easiest place to get the plug through is via the hood latch cable grommet (Black Arrow, Figure 6). From inside the cab, peel the first layer of the rubber grommet back. Poke through the second rubber layer with an Awl or small knife. Feed the cable through the opening into the cab.
22. Remove the interior panel below the steering wheel by first removing the two fasteners using a 7mm socket. Pull the panel, which is secured by 6 clips, straight towards the seat
23. Route the 4 pin 8-gang controller cable through the right opening close to the rotary shifty knob and connect it to the cable from the Switch Assembly. **Make sure the cable follows existing wiring routing, away from any moving parts, especially brake and gas pedal!** Bundle and secure excess cable securely. Re-attach interior panel removed in Step 22.
24. Attach one end of the remaining 8 gauge red loomed wire to the remaining terminal of the 60A breaker (Yellow Circle, Figure 2). Attach the other end to the second positive 6mm terminal on the fuse box (Red Circle, Figure 4)
25. Attach the Black 8 gauge wire to the Auxbeam Switch Negative (Green Circle, Figure 2). Route it down through the opening and attach the other end to the terminal of the Battery Negative Connector (with the terminal still not attached to the battery).
26. Connect your accessories to the Auxbeam controller as per the manufacturer's instructions.
27. With all connections tight, you may now attach the negative terminal back onto the battery negative Lug.
28. Secure all wires with zip ties such that they will not move, rub or contact sharp edges
29. Enjoy control of all your accessories from a single controller!