

2021-2022 RAM TRX

Reverse LED Lighting Kit

INSTALLATION INSTRUCTIONS

SAFETY

Your safety is extremely important to us. Working on vehicles has ever-present hazards which require precautions at all times to avoid injury or death. We've outlined some precautions to take below in order to help you make informed decisions about your safety before installing this product. This is not an exhaustive list, and you must use your own good judgment before performing any work in each step of this installation.

ALWAYS:

- wear eye protection
- use tire blocks and emergency brake
- disconnect battery(s)
- use care when moving components
- route electrical cables away from moving parts
- identify all pinch points
- wear gloves
- identify slipping and tripping hazards
- wear steel toe footwear
- understand proper use of tools before use
- work on a flat surface
- use care when lifting components
- insulate cables
- jack your vehicle from the OEM's lifting points
- torque all fasteners to suggested specs
- remove any hazards before starting on the job

LIABILITY

All liability for installation and use of this product rests with the owner. Improper installation, maintenance, and operation can result in serious injury or death as well as equipment or vehicle damage. Use this product at your own risk.

Component Checklist

The following components are included In this kit.

Brackets and Hardware

Item No.	PART NUMBER	DESCRIPTION	QTY
1	100126	Reverse Light Bracket Set, TRX Driver Side	1
2	Mirror 100126	Reverse Light Bracket Set, TRX Passenger Side	1
3		3/8" x 1" Carrage Bolt Grade 5	4
4		3/8" Nut , Yellow Zinc	6
5		3/8" Washer, Yellow Zinc	8
6		3/8"-16 x 0.75" Hex Head Bolt	2

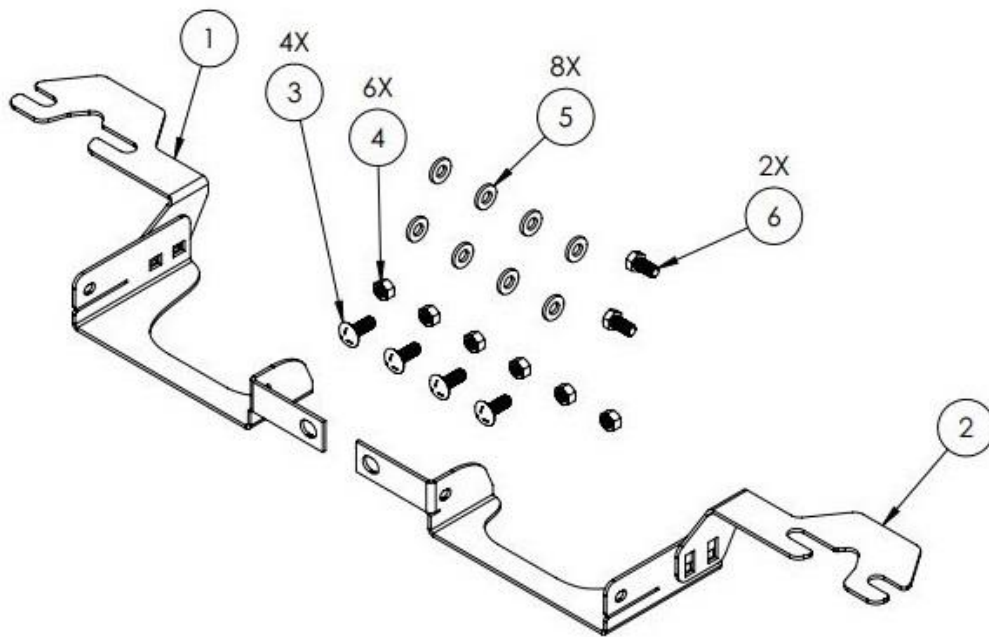

LED Lights and Wiring

Item No.	PART NUMBER	DESCRIPTION	QTY
7	10-10005	8" Single Row Lightbar	2
8	10-30036	Deutch DT 2 Light Harness Splitter	1
9	300106	HARNESS, 7-PIN TO DEUTSCH, REVERSE LT	1

SET UP

1. Read this entire document before performing any work.
2. Gather the tools required, outlined in **Table 1**.

Table 1

Tool List
<ul style="list-style-type: none">• 9/16 Socket• 21mm Socket• 9/16 Box Wrench• Torque Wrench

3. Park your vehicle on flat ground, engage the emergency brake, block the tires
4. Loosen, but do not fully remove, the two rearward 21mm fasteners holding the rear tow hooks in place, as shown by Figure 1



Figure 1

5. Slide the slotted Light mount between the bolt head and tow hook . Snug up the 21mm fasteners to hold it in place. It will be torqued later.

6. Install the 8" Single Row LED Lightbar into the brackets using the hardware that comes with the lightbar.
7. Using the 3/8" Carriage Bolts (2 per), attach the light bracket assembly, to the bracket you installed in Step 5. (Circled in yellow, Figure 2)
8. Using the 3/8"x 0.75" Hex bolt, attach the light bracket assembly to slot beside the 2" Receiver. (Circled in Red, Figure 2)

**Figure 2**

9. Torque 3/8" Fasteners to 23 ft lbs, and Tow hook Bolts to 85 ft lbs.

Wiring:

10. Depress the two tabs on the back side of your 7pin trailer connector, and pull the connector out of your bumper. Unplug the 7 pin connector from the factory Harness.
11. Plug our harness adapter into the Factory Harness, and into the 7 pin connector. Put the Deutch (2 wire) connector through the plug opening so the harness is behind the bumper. Re-install the 7 pin connector into the bumper.
12. Plug the Harness splitter female end into the wiring installed in Step 11, and the 2 male ends into the lights.
13. Use zap straps to tidy the wires and secure them in place behind the bumper, such that they do not rub on any sharp edges.
14. Enjoy being able to see when you put your truck into reverse!