

Cherry Blossom Speaker



USER MANUAL

Attention

Please read and keep this manual, and be aware of the following warnings.

- Low battery level may cause sound distortion, please charge it in time.
- Please do not use it when you are near strong magnetic or electric fields.
- Please do not disassemble, repair or rebuild.
- Please do not clean the product with water.

Please disconnect the power supply if it will not be used for a long time.

Specifications

Audio Port: Micro SD/USB-A /AUX
Speaker: Dual Speaker Units, 4Ω 5W
Charging Interface: Micro-USB
Charging Time: 3-4h
Battery Capacity: 1200mAh
Working Time: 7-9h
Frequency Response: 100Hz~16KHz
Input Voltage: DC5V=1A
FM Frequency Range: 87.5-108Hz
Dimension: 205*66*53mm
Audio Support: MP3 for external storage mode

Charging the Speaker

Connect the speaker to a 5V 1A adapter with the Micro USB cable. The charge indicator lights up in red while charging is in progress and it will go off when the speaker is fully charged in 3-4 hours.

Power On/Off

Press the power button to turn on or turn off the speaker, the power indicator lights up in blue when the speaker is powered on. The indicator will go off when the speaker is powered off.

Wireless Connection Mode

Device Pairing

Before using your speaker in Wireless mode, you need to pair it with a Wireless-enabled device, such as your phone, music player, PC or tablet.

One-to-One Connection

In this mode, your Wireless device will connect to one speaker

1. Power on the speaker and you will hear a prompt tone. The Wireless indicator will keep flashing in blue.
2. Open the device's Wireless search function to find the speaker name "SPEAKER 5.0".
3. Click "Connect", and the speaker will make a sound of a successful pairing.

Note:

- When the speaker and the device have both been connected before, and both have Wireless turned on, the speaker will automatically pair with the device.
- If there are more than two nearby devices connected to the speaker, the last connected device will be selected by default (The effective connection range is within 33 feet/10 meters).

One-to-Two Connection

In this mode, your Wireless device will connect to two speakers simultaneously (sold separately).

1. When connecting your device to two speakers at the same time, please link the two speakers first:
 - a. Power on both speakers, then press both (⏸) buttons on the speakers for 2 seconds at the same time, release the buttons after the speakers make prompt tones.
 - b. The prompt light will flash blue rapidly, indicating the speakers are starting to connect with each other.
 - c. The connection will be successful after 5-7 seconds, the indicator light will remain lit.
2. Enable the Wireless Connection of your Wireless device, search and find the linked speakers' name "SPEAKER 5.0".
3. Click "Connect", the speaker emits a sound of the successful pairing.

Handsfree Call

When the speaker is connected to your phone via Wireless, press the pause button (⏸) on the speaker to answer incoming calls. Press the pause button again to hang up.

Note: The hands-free function is only available in Wireless Connection mode.

External Storage Mode

Power on the speaker, insert the Micro SD card or the USB drive, the speaker will automatically play the supported audio files within those storage devices.

Press the (⏪) or (⏩) to switch songs; Hold down the (⏪) or (⏩) to adjust the volume.

Note: If the U disk or Micro SD card is inserted at the same time, the speaker will only read the last inserted memory card. (Only audio files in MP3 format are supported in this mode, Audio files must be placed in the root directory to be

Aux Wired Connection Mode

Power on the speaker, plug in both ends of the 3.5mm audio cable to your device and the AUX jack of the speaker. Once connected, the blue light will keep flashing.

Note:

1. Switching songs can only be operated by the music player of your device, the (⏪) button of the speaker is to decrease the volume, and the (⏩) button is to increase the volume.
2. The (M) button and the (⏸) pause button on the speaker cannot be used in this mode.
3. The AUX jack of the speaker cannot be plugged into any earphones or headsets.

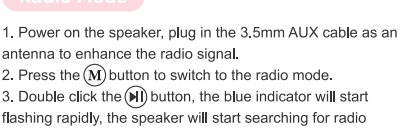
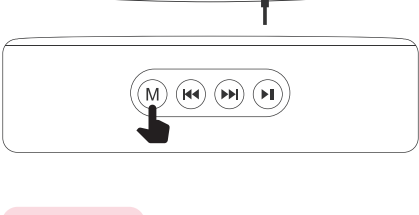

Radio Mode

1. Power on the speaker, plug in the 3.5mm AUX cable as an antenna to enhance the radio signal.
2. Press the (M) button to switch to the radio mode.
3. Double click the (⏸) button, the blue indicator will start flashing rapidly, the speaker will start searching for radio stations automatically with no other operations required.
4. After entering the radio mode, you can press the "(⏪)" or "(⏩)" button to select the radio stations.

Volume Adjustment

Press (⏪) and (⏩) once for "Previous Song" and "Next Song"; Long press for "Volume Down" and "Volume Up".

Package Includes

- 1x Cherry Blossom Speaker
- 1x 3.5mm Audio Cable
- 1x Micro USB
- 1x User Manual