





INDUSTRIAL SKILLS by:

# SEVEN --- FRIDAY

M-SERIES

# NFC AUTHENTICATION & REGISTRATION:



-  **DOWNLOAD APP:**  
[sevenfriday.com/app](https://sevenfriday.com/app)
-  **CREATE ACCOUNT**
-  **SCAN BACK OF YOUR WATCH**
-  **CONFIRM OWNERSHIP**

**SEVENFRIDAY** watches guarantee authenticity through scanning the integrated NFC chip, which is readable by NFC enabled devices\*.

Download the **SEVENFRIDAY** app, scan to ensure authenticity, create your account and register as the official owner.

\*The chip is completely passive, data exchange is activated and powered by the device from close distance of 2-5mm. iPhones are not NFC enabled devices.

# M-SERIES

## INSTRUCTION MANUAL

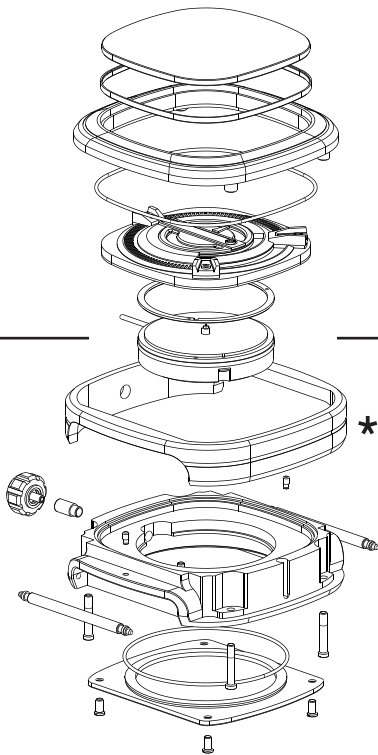

AUTOMATIC MOVEMENT

MIYOTA 8215 - MADE IN JAPAN

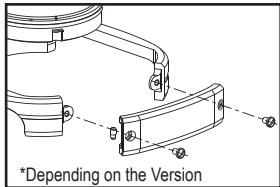
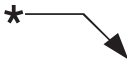

## DISPLAY

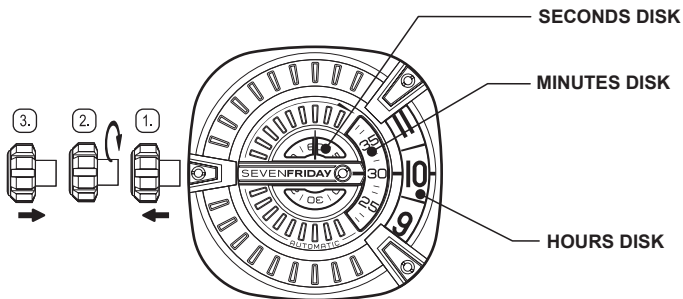

## WINDING THE MAINSPRING

Automatic winding watch can also be hand wound by turning the crown clockwise in normal position. Wind 15-20 times and it will start to move, after slightly shaking.

## SETTING THE TIME

1. Pull the crown out to the 2nd Click - Time setting position.
2. Turn the crown to set hour and minute disk.
3. After the time has been set, push the crown back to the normal position.

# TIME READING

**DISK**

**SECONDS  
READING  
AXIS**

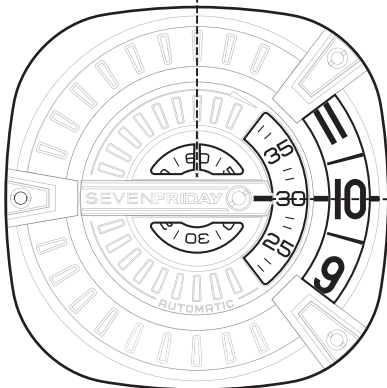

**HOUR- MINUTES  
TIME READING  
AXIS  
(FROM RIGHT TO LEFT)**

**> All 3 disks rotate clockwise**

DISPLAY (12h)

EXAMPLE 1

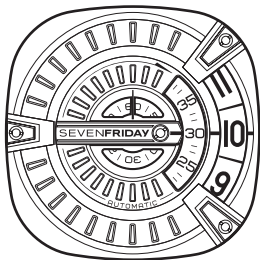

10:30:60

HOURS: 10AM OR PM

MINUTES: 30MIN

SECONDS: 60 = 0S

EXAMPLE 2

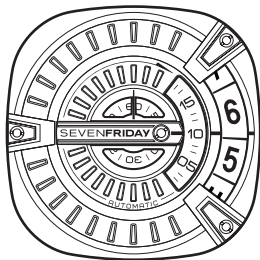

6:10:60

HOURS: 6AM OR PM

MINUTES: 10MIN

SECONDS: 60 = 0S

[WWW.SEVENFRIDAY.COM](http://WWW.SEVENFRIDAY.COM)

All rights reserved to SEVENFRIDAY®, unless stated otherwise, this manual is forbidden to be duplicated, published or modified for any purpose or reason.