

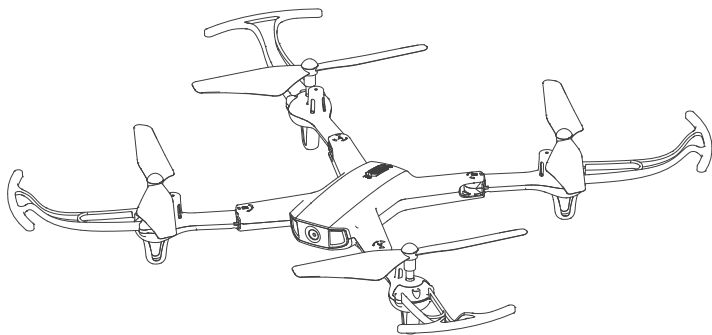

## X800W FOLDING DRONE



User manual



## Contents

EN	ENGLISH INTRODUCE .....	1-22
DE	DEUTSCH EINFÜHRUNG .....	23-46

# Contents

<b>1.0 Important safety information</b> .....	2
<b>2.0 About this product</b> .....	3
2.1 Specifications .....	3
2.2 Install the SYMA FLY app .....	3
2.3 Drone components .....	4
2.4 Remote control components .....	4
<b>3.0 Assembling the product</b> .....	5
3.1 Installing the propeller protectors .....	5
3.2 Charging the drone battery .....	6
<b>4.0 Flight guide</b> .....	8
4.1 Flight preparation and turning the drone on/off .....	8
4.2 The method of Remote control flight controlling .....	9
4.3 Stunt functions .....	10
4.4 Trimming .....	11
<b>5.0 Function introduction</b> .....	11
<b>6.0 Real-time transmission function</b> .....	15
<b>7.0 Accessories (available separately)</b> .....	16
<b>8.0 Contact Us</b> .....	17

# 1.0 Important safety information

Thank you for purchasing this SYMA product. To ensure that you operate the aircraft correctly and conveniently, please read these instructions carefully before first use and store them in a safe place for future reference.

## Safety Guide

1. Adult or experienced RC pilot's supervision is recommended for children.
2. Rechargeable batteries are to be removed from the toy before being charged.
3. Batteries are to be inserted with the correct polarity.
4. Rechargeable batteries are only to be charged under adult supervision.
5. Non-rechargeable batteries should not be recharged; Batteries should be inserted with a correct polarity; Different types of batteries, new or used batteries should not be mixing.
6. Turn off the drone/transmitter and remove the batteries when not in use.
7. The supply terminals are not to be short-circuited.
8. Keep away from the rotating blades (rotating blades may cause bodily injuries, or damage to property).
9. Attention: please assemble the drone with the guidance of adults.
10. Do not look directly into the LED lights of the drone as it can damage your eyes.
11. Exhausted batteries are to be removed from the aircraft.
12. Please store the smaller-sized drone accessories in places that are out of reach of children.
13. This drone is very powerful. For all first-time flights, the left joystick must be slowly pushed up in order to prevent the drone from ascending too fast to avoid unnecessary collision and possible damage and injury.
14. When the flight is ended, first turn off the power of the remote control. Then turn off the power of the drone.
15. Avoid placing the batteries in places with high temperatures and exposure to heat.
16. Please keep a safe distance from the spinning propellers to avoid injury.
17. To ensure the electromagnetic environment requirement of the aviation radio (station), using remote controls in the zone, which is in a radius of about 5000m zone from the circle center of the airport runway, is forbidden. All users also should abide by the regulation of the radio set forth by government and regulatory agencies including the duration and area.
18. Pay attention to keeping distance of 2-3 meters from the user or other people when the drone is flying, avoid the drone landing to hit the head, face or face or body of another person.
19. Attention: Drone assembly under adult supervision.
20. The packing has to be kept since it contains important information.

## Repair and maintenance

1. Use clean and soft cloth to clean the product.
2. Keep away the product from heat sources.
3. Avoid water exposure to this product. Moisture may cause damages of drone electronic parts.
4. Transformers used with the drone should be examined regularly, such as propeller blade, motor, battery and other parts. In case of any damages is found, please stop using it unless it is repaired or replaced.

## 2.0 About this product

### 2.1 Specifications

#### Aircraft

Brand Name	SYMA
Model/ITEM NO.	X800W
Aircraft weight	Approx. 62g
Aircraft Size	305x305x55 mm
Range	Approx. 30 m
Altitude	Approx. 10 m
Flight time	Approx. 12 mins
Motor	ø6
Battery	3.7V 400mAh
Charging time	Approx. 60 minutes

#### Remote control

Operating frequency	2.4 GHz
Operating temperature	0°C to 40°C

#### Package contents

Aircraft	1
Remote control	1
USB charging cable	1
Propeller	4 (A/B)
Propeller protection frame	2
User manual	1
Phone holder	1

### 2.2 Install the SYMA Fly app

Scan the QR code with your mobile device or download the app from your app store.



iOS



Android

**Note:**

\*For best results, use a device with iOS 8.0/Android 5.0 or later.

## 2.3 Drone components

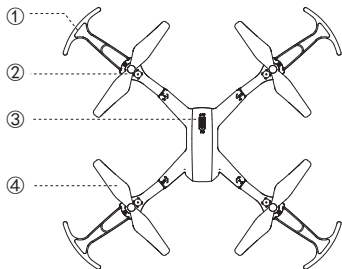

- ① Propeller protection frame
- ② Motor
- ③ Power switch
- ④ Propellers

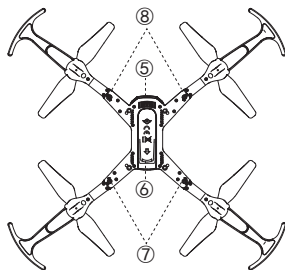

- ⑤ Lens
- ⑥ Battery cover
- ⑦ Rear indicator
- ⑧ Front indicator

## 2.4 Remote control

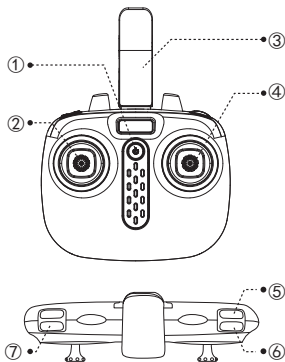

- ① Power switch
- ② Left joystick  
(press and hold for trimming adjustments and release when finished)
- ③ Phone holder
- ④ Right joystick  
(short press to toggle between high and low speed mode)
- ⑤ 3D flip button
- ⑥ One-touch take-off/landing button
- ⑦ Spin button

## 3.0 Assembling the product

### Folding the quadcopter

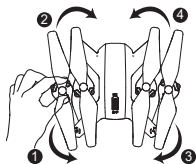

1. Unfold the arms in the direction of the arrow

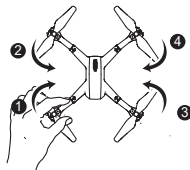

2. Fold the arms in the direction of the arrow until the quadcopter is fully folded.

### Detaching the propellers

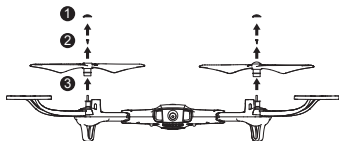

Remove the propeller covers and screws in the direction of the arrow

### Re-installing the propellers

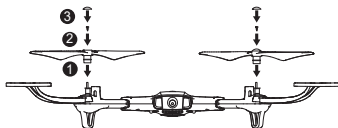

Insert the propellers onto the body of the quadcopter in the direction of the arrow

#### **Note:**

\* The propellers are labelled "A/B". Ensure that each propeller is inserted in the corresponding position on the arms, and then tighten the screw, and then tighten the screws and attach the propeller covers.

## 3.1 Installing the propellers

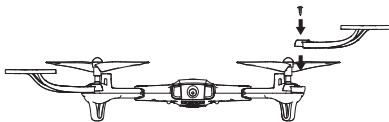

Insert the protective frame into the fuselage in the direction of the arrow, and fasten the screws.



## Attaching the phone holder

Insert the phone holder into the opening on the remote control.



Press the spring to adjust the size of the phone holder.

## 3.2 Charging the drone battery

### Remove the battery

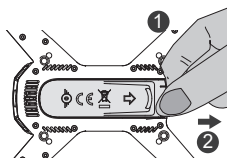

Push the battery cover back, then flip it up to remove the battery

### Insert the battery

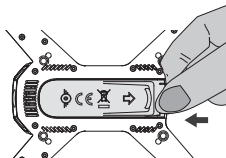

Insert the battery and close the battery compartment cover.

\*Ensure that the battery holder clicks into place.

### Charge the battery

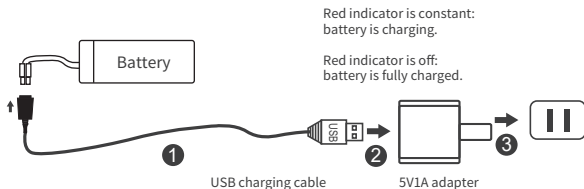

**Note:**

\* Charge the drone with the USB charging cable that came with the product.

\* Using adapters with a lower rated current will result in a longer charging time.

**Note:**

- \*Do not short circuit or compress the battery, as this may cause an explosion.
- \*Rechargeable batteries should be removed from the aircraft before charging
- \*Failure to follow all the instructions may result in serious injury, irreparable damage to the battery and may cause a fire, smoke or explosion
- \*Always check the battery's condition before charging or using it
- \*Replace the battery if it has been dropped, or in case of an odor, overheating, discoloration, deformation or leakage
- \*Use only the supplied charging cable.
- \*Exhausted batteries should be removed from the aircraft
- \*The battery temperature must never exceed 60°C (140°F), otherwise the battery could be damaged or ignite.
- \*Never charge on a flammable surface, near flammable products or inside a vehicle (Preferably place the battery in an on-flammable and nonconductive container).
- \*Never leave the battery unattended during the charging process. Never disassemble or modify the housing's wiring, or puncture the cells. Always ensure that the charger output voltage corresponds to the voltage of the battery. Do not short circuit the batteries.
- \*Never expose the battery to moisture or direct sunlight, or store it in a place where temperatures could exceed 60°C (drone in the sun, for example)
- \*Improper battery use may result in a fire, explosion or other hazard.

### Inserting the remote control batteries

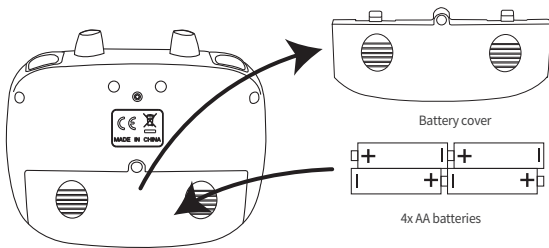

To insert the controller batteries, open the battery cover on the back of the remote control and insert 4x AA alkaline batteries, ensuring that you observe the polarity markings (batteries are not included and must be purchased separately).

**Note:**

- \* When installing the batteries, ensure that you match the + and - ends of the battery with the + and - signs on the controller.
- \* During the battery installation, it must be ensured that the polarities of the batteries are matched with that of the battery box. No battery shall be installed with the opposite polarity.
- \* Please do not use new and old batteries together.
- \* Please do not use different types of batteries together.
- \* Remote control do not use rechargeable batteries.
- \* Exhausted batteries are to be removed from the Remote control.

## 4.0 Flight guide

### 4.1 Flight preparation and turning the drone on/off

#### Pairing the remote control with the drone

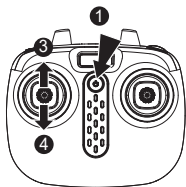

Remote control indicator flashes rapidly

Switch on the remote control  
Indicator flashes rapidly  $\geq$   
slowly

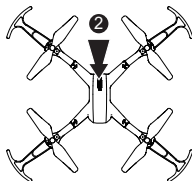

The indicator will stay constant when pairing is complete.

EN

#### **Note:**

\*After you switch on the remote control, the indicator will flash quickly to indicate that the remote control is waiting to be paired with the drone.

#### Turning the drone on



**Method one**

Move the left joystick upwards



**Method two**

Pull the joysticks in a V shape

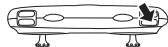

**Method three**

Press the ascend/descend button

#### **Note:**

1. If the aircraft is flown out of range from the remote control, the aircraft indicator light will start to flash and the aircraft will land slowly.
2. If the remote control suddenly turns off or runs out of power during flight, the aircraft will automatically land and come to a stop. If the remote control is turned back on during this process, you will be able to control the aircraft again.

## Turning the drone off



Method one

Push to the bottom for 2-3 seconds



Method two

Pull the joysticks in a V shape

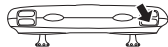

Method three

Press the ascend/descend button

## 4.2 The method of Remote control flight controlling

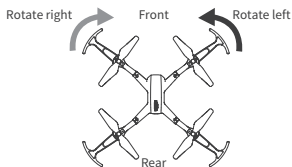
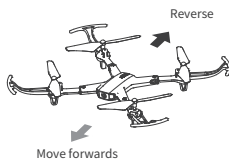
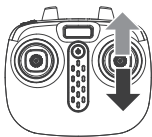
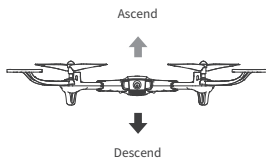

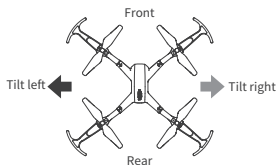

### 4.3 Stunt functions

Press the spin button

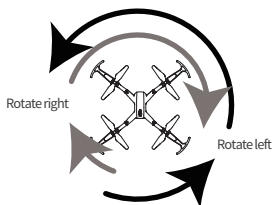
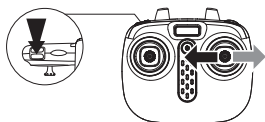

Press the spin button on the top-left of the remote control while holding the right joystick to the left or right. The drone will spin to the left or right accordingly.

Press the spin button

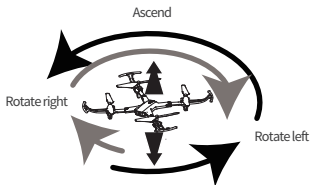
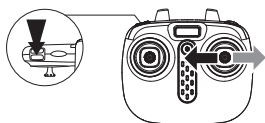

Press the spin button on the top-left of the remote control and move the right joystick to the top or bottom. The drone will spin in circles and ascend for approximately 60-90cm.  
Maximum radio-frequency power transmitted < 10 dBm. Frequency range:2409-2475MHZ

## 4.4 Trimming

Trimming forwards and backwards

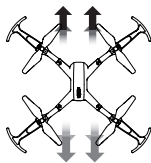

If the aircraft drifts forwards or backwards when it is hovering, hold the left joystick down and push the right joystick down/up until the aircraft stops drifting.

Trimming left and right

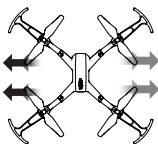

If the aircraft drifts to the left or right when it is hovering, hold the left joystick down and push the right joystick right/left until the aircraft stops drifting.

This toy is only to be connected to equipment bearing either of the following symbols:



## 5.0 Function introduction

Undervoltage



### Undervoltage protection

A flashing red indicator light on the base of the aircraft indicates that the battery level is low. When this occurs, bring the aircraft back to land.



### Overcurrent protection

If the aircraft's blades collide with another object or become stuck, the aircraft's circuit will engage the overcurrent protection mechanism.

## Level calibration

Place the aircraft on a level surface and move the left and right joysticks to the lower right corner for approximately 3 seconds. The indicator will flash rapidly and then stay constant to indicate that the calibration process is complete.

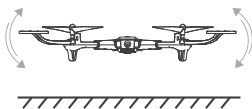

## High/low speed mode

Briefly press the right joystick to switch between high and low speed mode.

1. Low speed mode is enabled by default when the drone is switched on.
2. The remote control beeps twice when high speed mode is enabled and once when low speed mode is enabled.

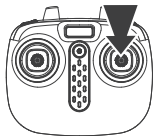
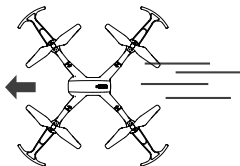

## One - Key take-off/landing

1. When the aircraft is in standby, press the take-off button to make the aircraft take off automatically and hover at a height of 1.5 m.
2. When the drone is in the air, press the one-touch take-off/landing button to make the aircraft land automatically.

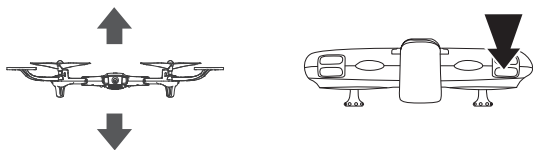

Once you have mastered the basic controls, you can try performing some flip manoeuvres. Start by flying the drone to an altitude of at least 3 m. Then hold down the button on the top-right corner of the remote control (flip button) and push the right joystick all the way up/down/left/right to flip the aircraft forward/backwards/left/right.

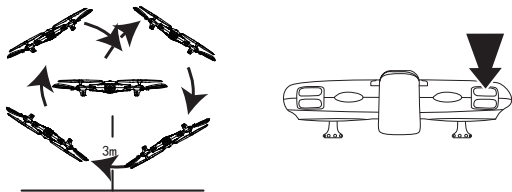

## Atmospheric pressure positioning

When you release the left joystick (throttle) after ascending/descending, the drone will continue to hover at the current height.

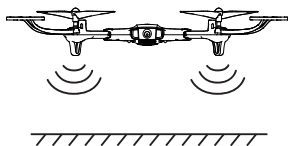





### 1. Define the front

When the aircraft is powered on for the first time, the direction of the aircraft nose is straight ahead.

### 2. Start headless function

#### Headless mode

After the linking is completed, press and hold the right joystick (about 2S), the remote controller will emit a "dididi,,," sound, and the indicator light on the aircraft will flash slowly, indicating that it has entered the headless state; press and hold the right joystick again (about 2S), When you hear a long beep, you will exit the headless state to the headless state, the controller does not need to identify the position of the aircraft' s nose. but to control the aircraft according to the direction of the joystick of the remote control.

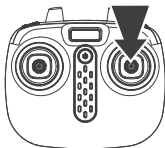

#### Define the positive direction function correction:

When the aircraft collides with a headless state, if you find that the fixed head direction is deviated, you only need to re-orient the aircraft and move the left and right joysticks of the remote control to the lower left at the same time. When the indicator on the aircraft flashes slowly 3 A long light after a second indicates that the calibration is complete.



## 6.0 Real-time transmission function

### 1. Download and install the app.

If you have an Android device, download the SYMA FLY app from the Syma website ([www.symatoys.net](http://www.symatoys.net)), or scan the QR code shown.

If you have an iOS device, download the Syma Fly app from the Apple App Store, or scan the QR code shown.

**Note:**

\* The QR code is printed on the packaging and on the back cover of the user manual. Visit the Syma website or your app store to download the latest version of the Syma Fly app.

### 2. SYMA FLY App Connection operation

- ① Install the SYMA FLY app on your phone. Note: Scan the QR code with your mobile device or download it from the app store.
- ② First pair the drone with the remote control, then turn on the Wifi Settings of the mobile device and select FPV\_WIFI\_\*\*\*\* from the Wifi list.
- ③ Wait a few seconds until your smartphone connects to the drone's Wifi network.
- ④ Open the Syma fly application, select the corresponding model, and then click Start, the camera image will be displayed on the screen, indicating that the connection is successful.

## 7.0 Accessories (available separately)

The following section contains a list of optional accessories that are available to purchase. Accessories can be purchased from your local retailer. Please indicate your preferred colour when making your purchase.



Drone body



Arm

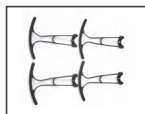

Propeller protection frame



Box



Propeller blades

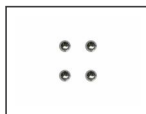

Propeller decorations

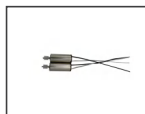

Motor A

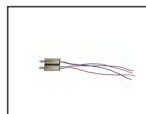

Motor B



Lights



Battery

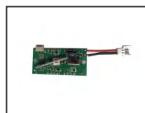

Receiver board



USB cable



Remote control



Phone holder



Camera circuit board

## Rectification Procedures

Problem	Reason	Solution
The drone does not respond	<ol style="list-style-type: none"><li>1. The drone has entered into low-voltage protection.</li><li>2. When the power of the remote control is weak, the power light indicator will blink.</li></ol>	<ol style="list-style-type: none"><li>1. Charge up the drone.</li><li>2. Change the batteries of the remote control.</li></ol>
The flight response of the drone is not sensitive	<ol style="list-style-type: none"><li>1. The power of the remote control is weak.</li><li>2. There is an interference with the same frequency as that of the remote control.</li></ol>	<ol style="list-style-type: none"><li>1. Change the batteries.</li><li>2. Change to a place where there is no interference with the same frequency.</li></ol>
The drone is flying towards its side in one direction during hovering	<ol style="list-style-type: none"><li>1. The drone is not calibrated level to the ground.</li></ol>	<ol style="list-style-type: none"><li>1. Re-adjust the calibration until the drone is level to the ground. For further details.</li></ol>
In the headless state, it is biased towards the front direction	<ol style="list-style-type: none"><li>1. Many collisions may cause head drift.</li></ol>	<ol style="list-style-type: none"><li>1. Re-define the front direction. For further details.</li></ol>
Fixed high instability / up and down movement	<ol style="list-style-type: none"><li>1. The drone is not calibrated level to the ground.</li><li>2. Unstable air pressure under the severe weather condition.</li><li>3. Violent collision resulting in data disorder of gyroscope.</li></ol>	<ol style="list-style-type: none"><li>1. Re-adjust the calibration until the drone is level to the ground. For further details.</li><li>2. Avoid to fly under the severe weather condition.</li><li>3. Make level adjustment again.</li></ol>

## 8.0 Contact Us

Please do not hesitate to contact us if you need more further support.

✉ [warranty@symatoys.com.cn](mailto:warranty@symatoys.com.cn)

☎ +1 718-312-0558(US) +44 (0)7723708421(UK)  
+4933545519201(DE)



For online support, please scan this code with Facebook Messenger

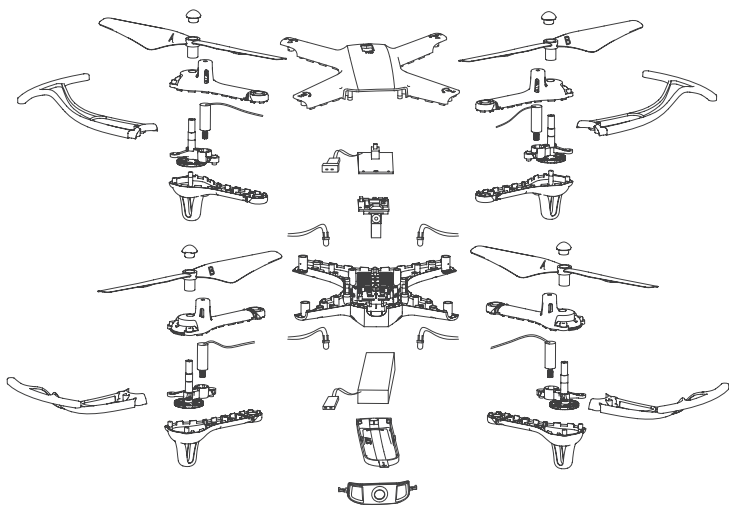

Warning: Changes or modifications to this unit not expressly approved by the party responsible for compliance could void the user's authority to operate the equipment.

#### FCC Notice.

Any Changes or modifications not expressly approved by the party responsible for compliance could void the user's authority to operate the equipment.

This device complies with part 15 of the FCC Rules.

Operation is subject to the following two conditions:

1. This device may not cause harmful interference, and
2. This device must accept any interference received, including interference that may cause undesired operation.

NOTE: This equipment has been tested and found to comply with the limits for a Class B digital device, pursuant to Part 15 of the FCC Rules. These limits are designed to provide reasonable protection against harmful interference in a residential installation. This equipment generates, uses and can radiate radio frequency energy and, if not installed and used in accordance with the instructions, may cause harmful interference to radio communications. However, there is no guarantee that interference will not occur in a particular installation. If this equipment does cause harmful interference to radio or television reception, which can be determined by turning the equipment off and on, the user is encouraged to try to correct the interference by one or more of the following measures:

- Reorient or relocate the receiving antenna.
- Increase the separation between the equipment and receiver.
- Connect the equipment into an outlet on a circuit different from that to which the receiver is connected.
- Consult the dealer or an experienced radio/TV technician for help.

“This device complies with FCC radiation exposure limits set forth for general population (uncontrolled exposure). This device must not be collocated or operating in conjunction with any other antenna or transmitter.”

RF frequency band: 3.55dBm

Transmitter power: 2445MHz-2475MHz

Product name: DRONE

Hereby, [GUANGDONG SYMA MODEL AIRCRAFT INDUSTRIAL CO., LTD], declares that this [drone] is in compliance with Directive 2014/53/EU. The full text of the EU declaration of conformity is available at the following internet address: <http://www.symatoys.com/download-declaration-of-conformity.html>

European Representative:  
CET PRODUCT SERVICE LTD.  
Osterholzallee 144  
71636 Ludwigsburg Germany  
Phone: +4971416432236  
Email: info.cetservice@gmail.com

British Representative:  
CET PRODUCT SERVICE LTD.  
Beacon House Stokenchurch Business Park,  
Ibstone Rd, Stokenchurch  
High Wycombe HP14 3FE UK  
Tel: +447419325266  
E-mail: info.cetservice@gmail.com

United States Representative:  
Duvin Trade Inc 5800 Wood Sorrel Dr, Littleton, Co, 80123, United States  
Phone: 718-312-0558  
E-mail: amz@symatoys.com

Manufacturer: GUANGDONG SYMA MODEL AIRCRAFT INDUSTRIAL CO.,LTD  
Address: NO.2 WEST XINGYE ROAD LAIMEI INDUSTRIAL AREA CHENG HAI , Shantou, China  
Postal Code: 515800

☎ +1 718-312-0558 (US)      +44(0)7723708421 (UK)      +49 335-4551-9201(DE)  
✉ usa@symatoys.com(US)      eu@symatoys.com(EU)  
🌐 <http://www.symatoys.com>

SYMA is a trademark of Guangdong Syma Model Aircraft Industrial Co., Ltd. registered in the United States and/or other countries.



The company has the right of  
final interpretation of this user manual.



## WARRANTY:

LIMITED 2-YEAR WARRANTY AND FREE LIMITED REPLACEMENT PARTS FOR 2-YEARS Symatoys.com.cn warrants to the original buyer only that its products will be free from defects in material and workmanship for 2 years from the date upon which the product is shipped, either directly from symatoys.com.cn or from an Authorized Re-seller's location, to the buyer.

The following condition's must to be eligible for warranty coverage:

1. During the warranty period product is used as intended by the manufacturer.
2. The Product has not been disassembled or modified.
3. The labels and serial numbers show no signs of tampering or altering.
4. Buyer has a warranty code obtained by registering their product online prior to making a claim.

EXCEPTIONS: THE LIMITED WARRANTY SHALL NOT APPLY TO:

- Damage caused by normal wear and tear
- Accident, negligence, abuse, misuse, misapplication or willful damage by buyer (or its agents), or acts of nature
- Crash or burning caused by non-manufacturing factors
- Damage caused by authorized modification or disassembly not authorized by the instruction manual
- Damage. caused by incorrect use or operation
- Damage caused by mismatch or misuse of battery or charger
- Failure of the operator to follow the operating instruction or use outside the products operating parameters
- Damage caused by operating the product in or around electromagnetic interference (i.e., radio transmitting tower, high-voltage wire, substation, etc.)
- Damage caused by operating the product where there may be interference caused by other wireless devices
- Operating the product with load capacity in excess of the sale weight listed in the manual
- Operating the product with aged, damaged or unauthenticated third-party components
- Operating the product with a defective battery

### WARRANTY

PROCEDURE: Any claims for breach of the foregoing limited warranty shall only be valid if buyer makes such claim in writing within 2 year of the date of shipment of the product to which the claim. To make a warranty claim, please email [warranty@symatoys.com.cn](mailto:warranty@symatoys.com.cn) with your full name. address. phone number, order number. vehicle type. part type and purchase date and product issue.



**LIMITED REMEDY:**

Symatoyos.com.cn's sole liability, and buyer's sole remedy for any breach of the foregoing warranty shall be at Symatoyos.com.cn's option to exchange the product with a new product or a refurbished product that is functionally equivalent to the original product, or issue a credit or refund to the purchase price the product.

Any replaced products shall be warranted as set forth herein, provided that the period within which buyer may make further claims shall be limited to the remainder of the original period. for the applicable product or 2 years, whichever is longer (although the warranty period shall be suspended during any period of replacement)

**DISCLAIMER:****Haftungsausschluss:**

THE WARRANTY AND REMEDIES ARE EXCLUSIVE AND IN LIEU OF ALL OTHER WARRANTIES. AND Symatoyos.com.cn DISCLAIMS ALL OTHER WARRANTIES, EXPRESS OR IMPLIED, INCLUDING WITHOUT LIMITATION THE IMPLIED WARRANTIES OF MERCHANTABILITY AND FITNESS FOR A PARTICULAR PURPOSE, NON-INFRINGEMENT AND ANY WARRANTIES ARISING OUT OF COURSE OF DEALING, COURSE OF PERFORMANCE AND TRADE USAGE.

Symatoyos.com.cn IS NOT RESPONSIBLE FOR DIRECT, SPECIAL, INCIDENTAL OR CONSEQUENTIAL DAMAGES RESULTING FROM ANY BREACH OF WARRANTY OR CONDITION, OR UNDER ANY OTHER LEGAL THEORY. INCLUDING BUT NOT LIMITED TO COSS OF USE; LOSS OF REVENUE; LOSS OF ACTUAL ANTICIPATED PROFITS (INCLUDING LOSS OF PROFITS ON CONTRACTS); LOSS OF THE USE OF MONEY, LOSS OF ANTICIPATED SAVINGS; LOSS OF BUSINESS COSS OF OPPORTUNITY; LOSS OF GOODWILL, LOSS OF EPUTATION; LOSS OF DAMAGE TO COMPROMISE OR CORRUPTION OF DATA; OR ANY INDIRECT OR CONSEQUENTIAL LOSS OR DAMAGE HOWSOEVER CAUSED INCLUDING THE REPLACEMENT OF EQUIPMENT AND PROPERTY. ANY COSTS OF RECOVERING OR REPRODUCING ANY DATA STORED IN OR USED WITH THE PRODUCT OR ANY FAILURE TO MAINTAIN THE CONFIDENTIALITY OF INFORMATION STORED THE PRODUCT.

Some states do not allow the exclusion or limitation of incidental or consequential damages. so the above limitation or exclusion may not apply to you. In addition, some states do not allow limitations on how long an implied warranty lasts. so the above limitation may not apply to you.

**FREE REPLACEMENT PARTS FOR 2 YEARS:** Symatoyos.com.cn .com shall also make available any spare part needed for registered vehicles free of charge for 2 years from the date of purchase, with the exception of batteries, motors. circuit boards and transmitters. Shipping charges may apply Limit one part type request per registered vehicle (e.g., registrants are entitled to one extra set of batteries per registered vehicle). To request spare parts. please email [warranty@symatoyos.com](mailto:warranty@symatoyos.com) with your warranty code, vehicle name/model, current shipping address, purchase date and part type

**GET YOUR WARRANTY CODE AT [symatoyos.com.cn/pages/warranty-signup](http://symatoyos.com.cn/pages/warranty-signup)  
HAVE YOUR ORDER NUMBER AND/OR VEHICLE UPC READ**