

POWERED BY PHILIPS LED MODULES



Features

- Powered by high output PHILIPS LED.
- Constant Voltage.
- Integrated transparent 170° optic lens.
- 20 pcs per string.
- CE, RoHS, UL, TUV, BIS, CB and LM-80 certified.

Application

- Apply to 6–15 cm depth signs at airports, metros, banks, buildings and shopping malls, etc.

Parameters

Items	Parameters			
Part Number	ZE01QAW	ZE02QAW	ZE03QAW	ZE04QAW
CCT (K)	6500K	6500K	6500K	6500K
Beaming Angle (°)	170°	170°	170°	170°
CRI (Ra)	≥70	≥70	≥70	≥70
Luminous Flux (lm)	70	125	182	218
Voltage (V)	DC12	DC12	DC12	DC12
Power (W)	0.36	0.72	1.08	1.2
Driving Method	Constant Voltage	Constant Voltage	Constant Voltage	Constant Voltage
Dimension (mm)	17.4*23*9.9	52*18.5*9.9	78*18.5*9.9	42.1*42.1*9.9
Working Tem. (°C)	-25 ~ +60	-25 ~ +60	-25 ~ +60	-25 ~ +60
Storage Tem. (°C)	-25 ~ +70	-25 ~ +70	-25 ~ +70	-25 ~ +70
Protection Grade	IP66	IP66	IP66	IP66

Dimension

Unit: mm

ZE01QAW

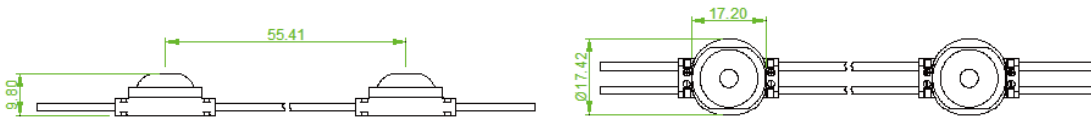

ZE02QAW

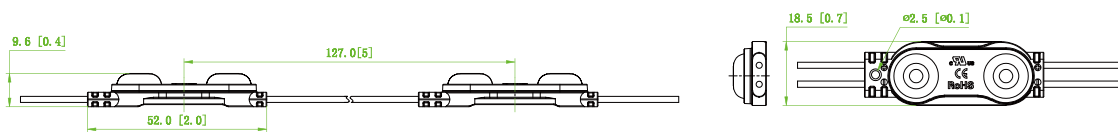

ZE03QAW

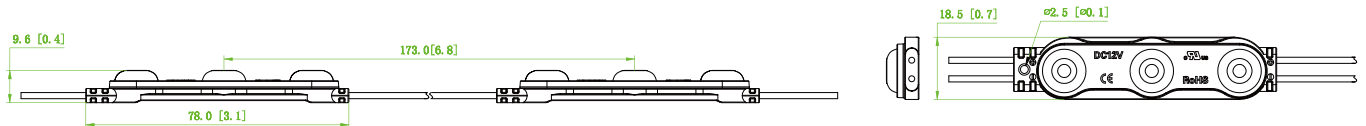

ZE04QAW

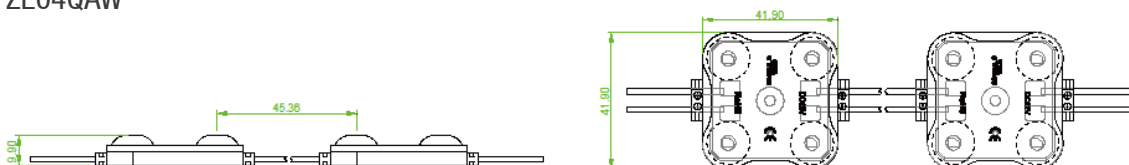

Beaming Angle

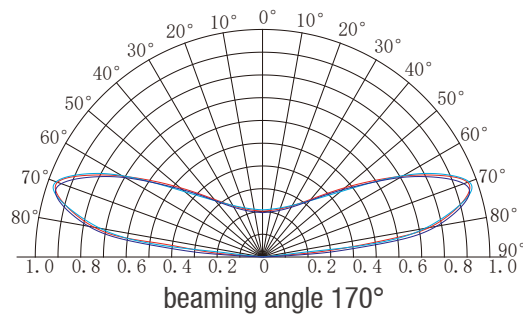

Reference Scheme

Part Number	Depth(mm)	Maximum Spacing(mm)	Density(pcs/m ²)	Illumination(lux)
ZE01QAW	Dz=30	40	73	4800
	Dz=40	50	66	4000
	Dz=50	60	79	2500
	Dz=60	70	71	2000

Part Number	Depth(mm)	Distance(mm)	Density(pcs/m ²)	Illumination(lux)
ZE02QAW	Dz=60	Dx=100 Dy=90	111	6000
	Dz=80	Dx=120 Dy=110	76	5500
	Dz=100	Dx=140 Dy=130	55	4700
	Dz=120	Dx=160 Dy=150	42	3100
	Dz=140	Dx=160 Dy=150	42	2500

Part Number	Depth(mm)	Distance(mm)	Density(pcs/m ²)	Illumination(lux)
ZE03QAW	Dz=60	Dx=100 Dy=130	77	5300
	Dz=80	Dx=120 Dy=150	55	4700
	Dz=100	Dx=140 Dy=170	39	4200
	Dz=120	Dx=160 Dy=170	31	3500
	Dz=140	Dx=180 Dy=170	31	3000

Part Number	Depth(mm)	Distance(mm)	Density(pcs/m ²)	Illumination(lux)
ZE04QAW	Dz=60	Dx=130 Dy=130	59	5500
	Dz=80	Dx=150 Dy=150	44	5300
	Dz=100	Dx=170 Dy=170	35	4400
	Dz=120	Dx=190 Dy=190	28	3200
	Dz=140	Dx=190 Dy=190	28	2900

Remark :

01. The transmittance of the advertising fabric was 30%.
02. The above data is for reference only.

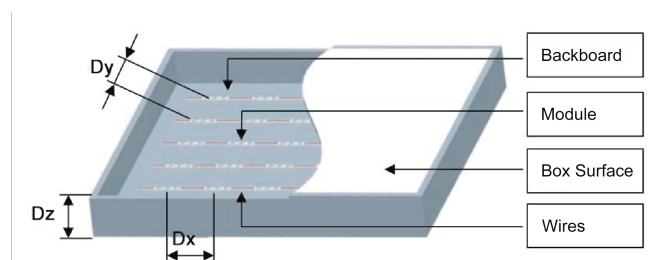

Wire Connection

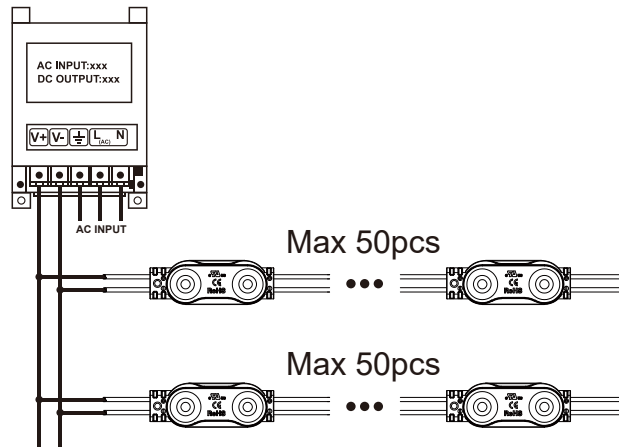

Declaration

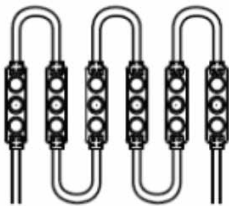

ZE01QAW 20 pcs per string
 ZE02QAW 20 pcs per string
 ZE03QAW 20 pcs per string
 ZE04QAW 20 pcs per string

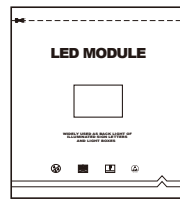

200 pcs in per bag
 140 pcs in per bag
 100 pcs in per bag
 80 pcs in per bag

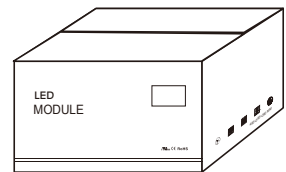

2000 pcs in a carton
 1400 pcs in a carton
 1000 pcs in a carton
 800 pcs in a carton

Packing Specification

- Antistatic bag adopted
- Packing information

Part Number	ZE01QAW	ZE02QAW	ZE03QAW	ZE04QAW
Carton dimension(mm)	490*450*220	490*450*220	490*450*220	490*450*220
Bags per carton	10	10	10	10
Quantity per carton(pcs)	2000	1400	1000	800
Net Weight(kg)	10.4(1±10%)	12(1±10%)	14(1±10%)	17.6(1±10%)
Gross Weight(kg)	12.4(1±10%)	14.1(1±10%)	15.18(1±10%)	19.9(1±10%)

Due to the packing manner difference, please adhere to the original products in case of discrepancy found between the picture and actual product.

Self-provided tools & material

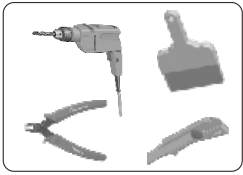

Dust brush, cutter, pencil, wire stripper, and drill

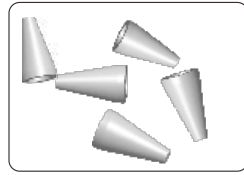

Wire Connector (Standard)

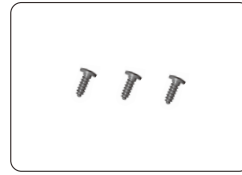

Screw

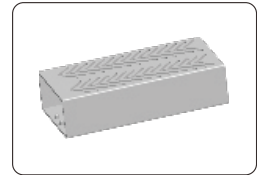

Power Supply

Installation Guidance

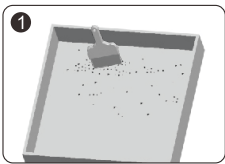

- Clean inside the light box.

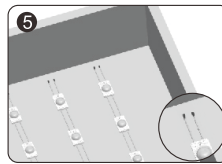

- Strip the end wire for 10mm and cap with the wire connector. Waterproof and anti-corrosion must be done on the connectors.

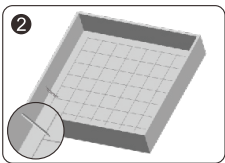

- Determine the appropriate layout.

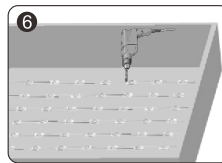

- Adjust modules to the optimal position and secure with screws.

⚠ Note: Avoid breaking the module and wire when fixing with a drill.

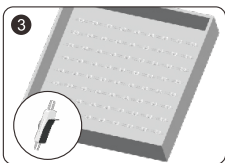

- Peel tape backing and stick modules into place.

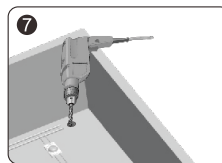

- Drill a hole for connecting power cable. Fixation and protection for the cable must be done on the hole.

⚠ Note: Avoid breaking the light box in drilling the hole.

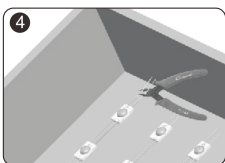

- Remove the unneeded modules.
- ⚠ Note: Cut in the middle position of the wires between modules.

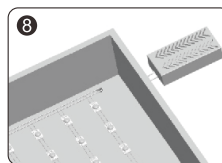

- Connect to the power cable and make sure that the polarity for connection is correct.

⚠ Note: Red wire is positive and black wire is negative.

Instructions

01. **Make sure the input voltage is sufficient 12V.**
02. Disassembling or modifying the product is not allowed.
03. Installation with power on is not allowed.
04. Any organic solvent chemical is not allowed.
Acidic or alkaline adhesive is not allowed when install, neutral glass cement could be used for installation purpose, make it drying in open environment for four hours.
05. Isolation and corrosion prevention on all wiring points and wire ends.
06. Make sure the power wire is thick enough and ensure the input voltage and connections are correct before power on.
07. This product should be used in a sign, do not expose it in opening site.
08. Installation and maintaining should be done by professional staff.
09. Maximum 20 pcs in a serial connection.
Initial location with 3M tape, then secure with screws.

Declaration

01. Warranty: 5 years.
02. In order to ensure the safety, the broken wires need to be replaced by the manufacturer or the service agent, or by the staff with the similar qualification.
03. The given data in the specification was based on the laboratory testing, there may be discrepancy found in the actual products.
04. The given drawings in the specification are only for reference, there may be discrepancy found in the actual products.
05. The products are subject to change without prior notification.



SHENZHEN LINGBENYANG IND. CO., LTD.

Tel: +86-755-83544570

E-mail: info@lbyled.com

Fax: +86-755-83056229

[Http://: www.lbyled.com](http://www.lbyled.com)

Company Address.: 28F, Luban Building, Hongli West Road, Futian District, Shenzhen 518034, China

Factory Address: 6F, Xinyongfeng Industrial Area, Yingrenshi Village, Shiyuan Town, Bao'an District, Shenzhen 518108, China