



**Side Mounted Rigid Bar Series**

**YX03DD1**

**YX05DD1**



**Shenzhen LingBenYang Co.,Ltd.**

17D Block A, Qingtianhuating Building, Shangbao Road, Futian District, Shenzhen, China, 518034

Tel: +86-755-8354-4570

Fax: +86-755-8305-6229

Web: www.szlby.cn

Email: info@szlby.cn



## Application

Apply to 18-40cm depth double-sided light box or 10-20cm depth single-sided light box signs at airports, metros, banks, buildings and shopping malls, etc.

## Features

1. Adopting super bright OSRAM LED, better heat dissipation and longer lifespan.
2. Special lens design, 45\*15°beaming angle and light evenly
3. Well sealed:anti-dusting, anti-moisture, waterproof, anti-shock.
4. CE , RoHS and UL certified

## Parameters

Items	Parameters	
Part Number	YX03DD1	YX05DD1
CCT (K)	7000	
Beaming Angle(°)	45*15	
CRI (Ra)	≥75	
Luminous Flux(lm)	635	1055
Voltage(V)	DC24V	
Power(W)	9	15
LED Type	OSRAM LED	
LED Qty(pcs)	3	5
Dimension(mm)	295*27.5*15.6	495*27.5*15.6
Weight(g)	65	100
Drive Method	Constant Current	
Working Tem.(°C)	-25~+60	
Storage Tem.(°C)	-25~+70	
Protection Grade	IP64	

## Dimension

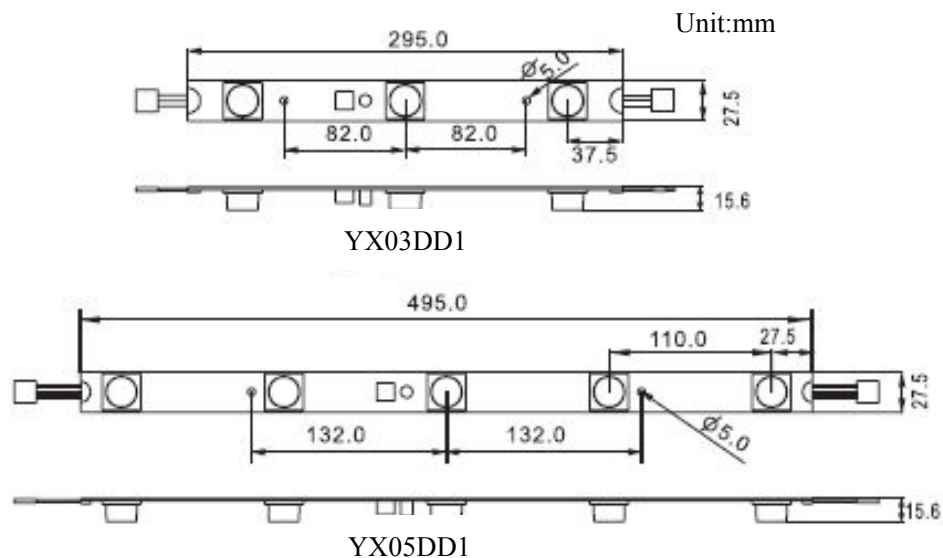

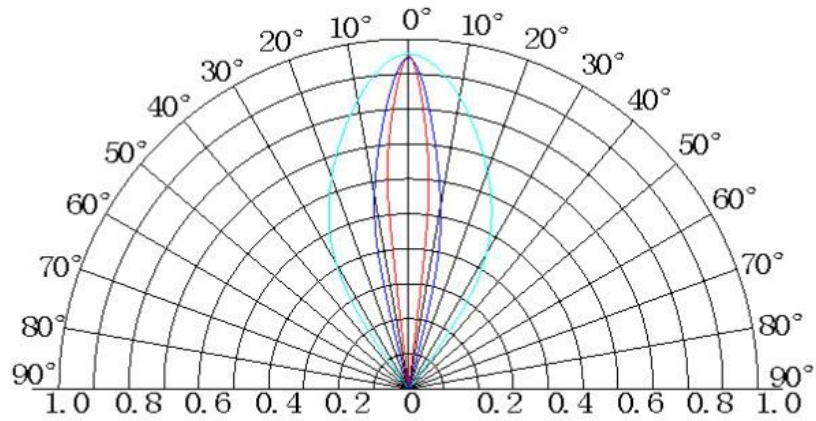
**Beaming Angle**

**Reference Scheme (YX05DD1)**

Size: L*W(mm)	Depth (mm)	Layout	Distance (mm)	Illumination(lux)	
3000*1400	200	4-side lighting	110	567	
		3-meter sides lighting		227	
	200	1.4-meter sides lighting	110	385	
		4-side lighting		535	
	300	3-meter sides lighting	110	225	
		1.4-meter sides lighting		368	
		4-side lighting		489	
		3-meter sides lighting		222	
	340	1.4-meter sides lighting	110	344	
		4-side lighting		481	
	1600*1400	160	1.6-meter sides lighting	110	513
			4-side lighting		1170
200		1.6-meter sides lighting	110	484	
		1.4-meter sides lighting		736	
240		4-side lighting	110	1151	
		1.6-meter sides lighting		447	
	1.4-meter sides lighting	648			
	4-side lighting	922			
300	1.6-meter sides lighting	110	421		
	1.4-meter sides lighting		580		
	4-side lighting		905		
	1.6-meter sides lighting		384		
340	1.4-meter sides lighting	110	459		
	4-side lighting		843		

**Remark:**

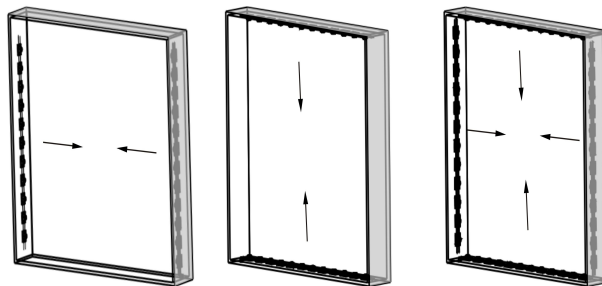
1. The test is done in a double-sided light box with 28% light transmittance 3M P2 white advertising fabric.
2. The above luminance data is the average data with uniform surface illumination under this depth.
3. The above data is for reference only.

**Wire Connection**

White&Red wire to positive  
White&Black wire to negative

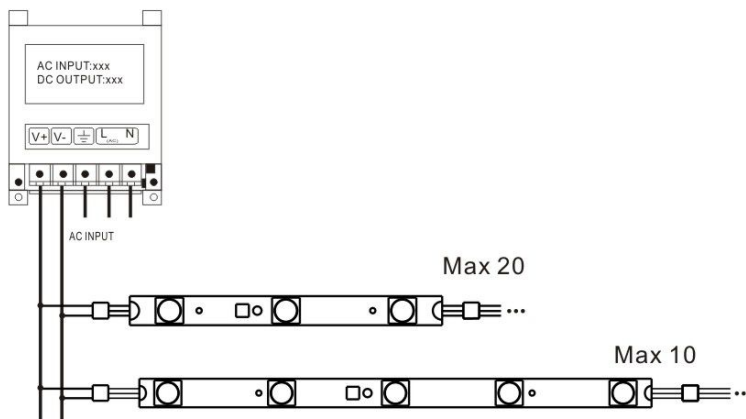
**Packing**

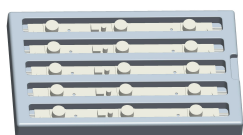

YX03DD1/YX05DD1

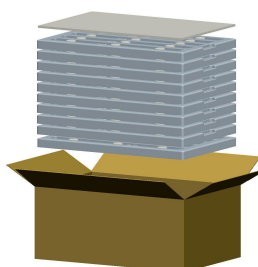

5pcs in one layer

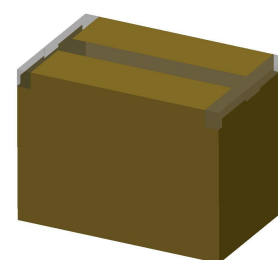

10 layers in a carton



50pcs in a carton

**Packing Specification**
**1. Packing information**

Part Number	YX03DD1	YX05DD1
Carton Dimension(mm)	370*242*270	583*242*270
Plates per carton	10	10
Quantity per carton(pcs)	50	50
Net Weight(kg)	2.78(1±10%)	4.73(1±10%)
Gross Weight(kg)	4.36(1±10%)	6.53(1±10%)

2. Due to the packing manner difference, please adhere to the original products in case of discrepancy found between the picture and actual product.

## Warning

1. Disassembling or modifying the product is forbidden.
2. Installation with power on is forbidden.
3. Any organic solvent chemical is forbidden.
4. Acidic or alkaline adhesive is forbidden when install, neutral silicon could be used for installation purpose, make it drying in opening sites for four hours.
5. Isolation and corrosion prevention on all wiring points and wire ends.
6. Make sure the power wire is strong enough and ensure the voltage and connection are all correct before power on.
7. This products shall be used in a light box, do not expose it in the opening site.
8. Installation, maintaining shall be done by professional staff.
9. YX03DD1:20 pcs in a serial connection maximum, YX05DD1:10 pcs in a serial connection maximum.
10. The power wire between power supply and rigid bar should be less than two meters to keep the same brightness on all parts.

## Declaration

1. Warranty: 5 years.
2. To ensure the safety, the broken wires need to be replaced by the manufacturer or the service agent, or by the staff with the similar qualification
3. The given data in the specification is the laboratory data, there may be discrepancy found in the actual products.
4. The given drawings in the specification are only for reference, there may be discrepancy found in the actual products.
5. The products are subject to change without prior notification.



RoHS



Address: 17D, Block.A, QingTian HuaTing, ShangBao Road, FuTian District, ShenZhen, China

Website: [www.szlby.cn](http://www.szlby.cn) E-mail: [info@szlby.cn](mailto:info@szlby.cn) Tel: +86-755- 8354 4570 Fax: +86-755- 8305 6229