

KTS Series

Package Content

Main Box

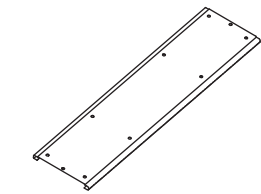

17.75" Track 1 PCE

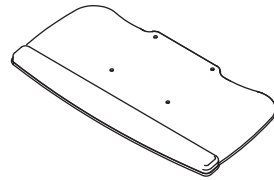

Tray 1 PCE

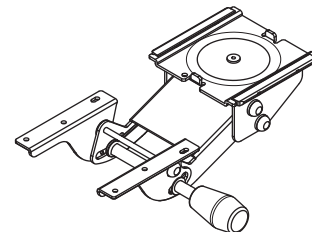

Articulating Arm
<Basic version> 1 PCE

Parts Pack



#10-5/8" Pan head
Self tapping screw 8 PCS



Pre-screwed
rubber bumper 1 PCE



3M Command
double-sided tape 2 PCS



Allen wrench 1 PCE

1



Please make sure everything is in the package before the installation.

Parts Pack



#10-5/8" Pan head
Self tapping screw 3 PCS

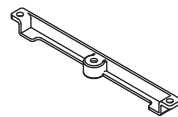

Track guard 1 PCE

2

Parts Pack



M5-0.8x17mm
Flat head screw 4 PCS



M5 wrench 1 PCE



M5-0.8mm
Acron Nuts 4 PCS

3

Parts Pack



Cable clip 4 PCS



Mouse guard 1 PCE



Mouse pad 1 PCE

Accessories

fersgo

Selection

High Performance Keyboard Tray

KTS Series

Basic

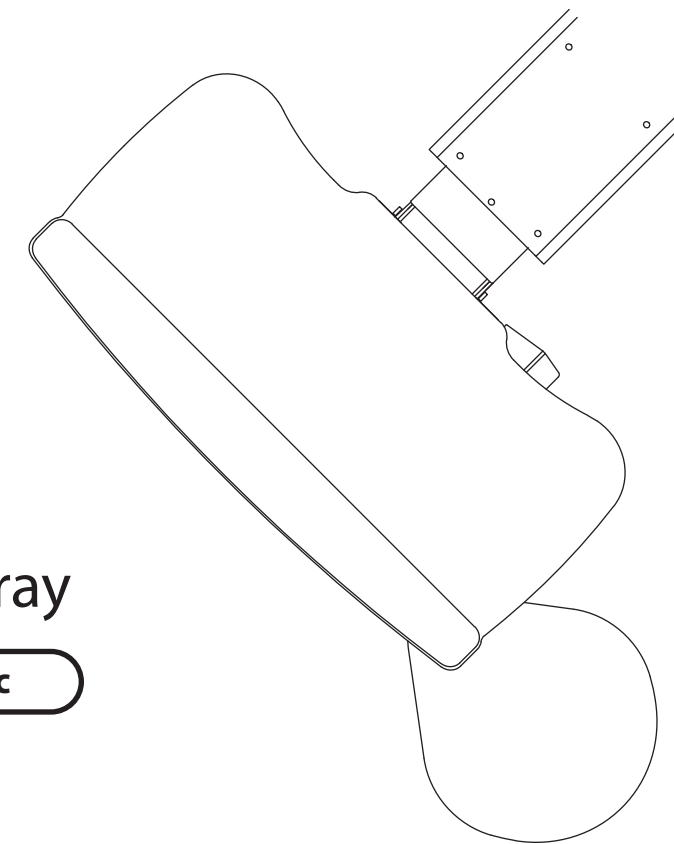

Quick Installation Guide



Please check your desk before installation

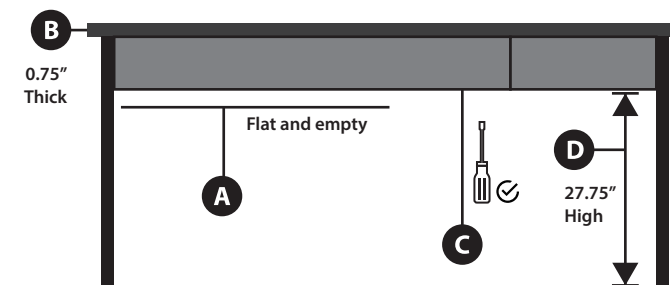

Front view

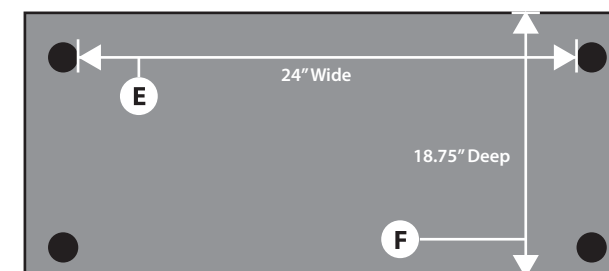

Bottom view

- A** My desk's underside is flat and free from any obstacles.
- B** My desk has at least 0.75 "thick.
- C** My desk can be screwed with bolts.
- D** My desk is at least 27.75" high from its underside to the floor.
- E** My desk is at least 24" wide between the legs.
- F** My desk is at least 18.75" deep.

Fersgo Selection
High Performance Keyboard Tray
KTS Series - Basic Version
Product designed and assembled in Taiwan.
Meet BIFMA x 5.5 Standard.
For home and office use only.
Please visit fersgo.com for more supports.



STEP 1

Install the track

STEP 2

Install the track guard

STEP 3

Install the tray

STEP 4

Install the accessories

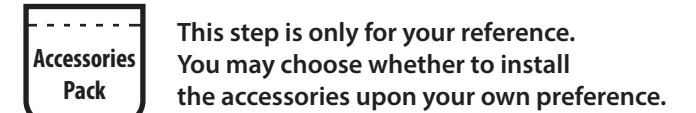
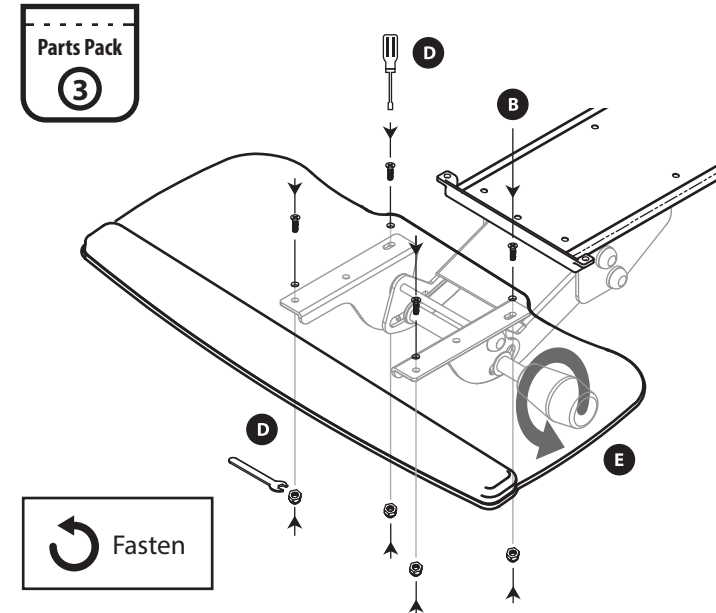
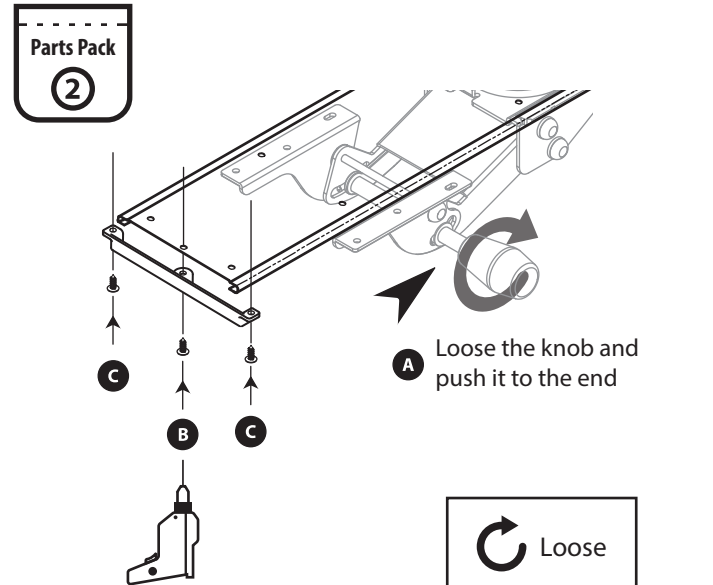
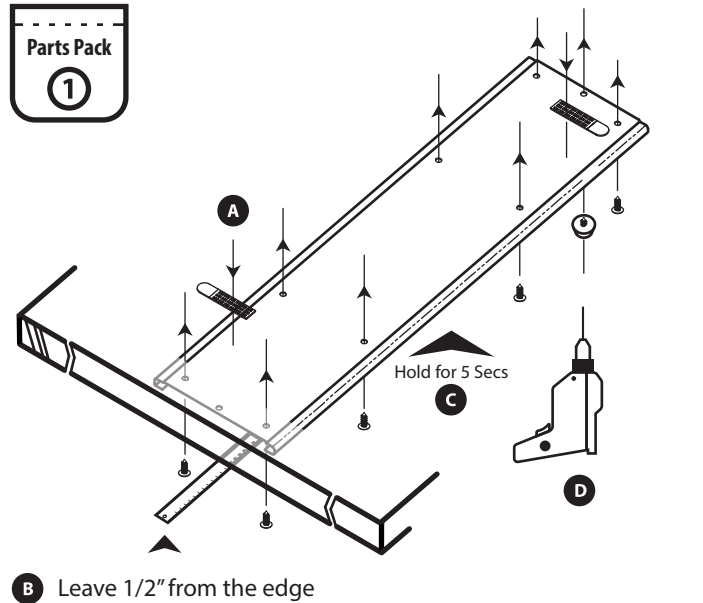

Mouse Guard

Insert it into the front edge of the mouse tray

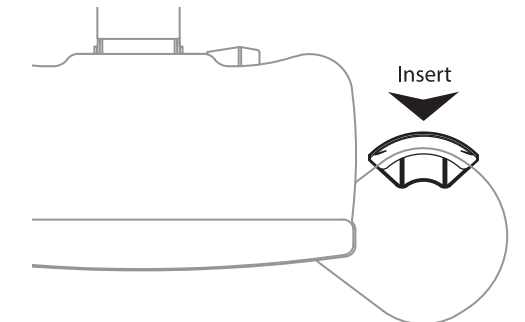

Cable Clips

Stick on the side of the tray assembly and the surface of the underside of the desk.

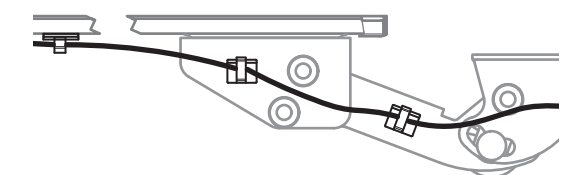

Adjustment

Mouse orientation

Adjustment

Keyboard height

Adjustment

Tray tilting

Adjustment

Tray swivelling

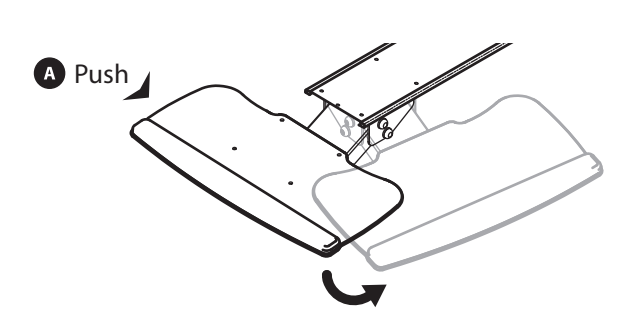
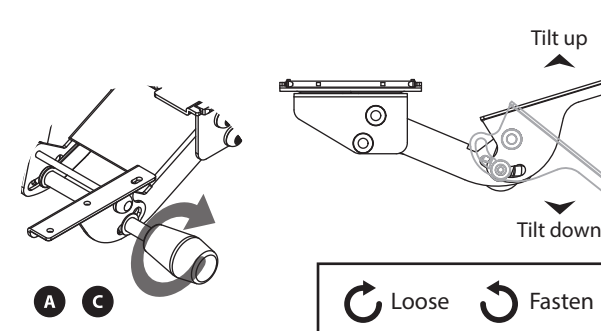
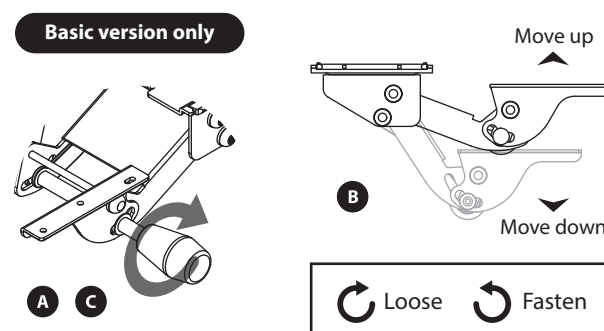
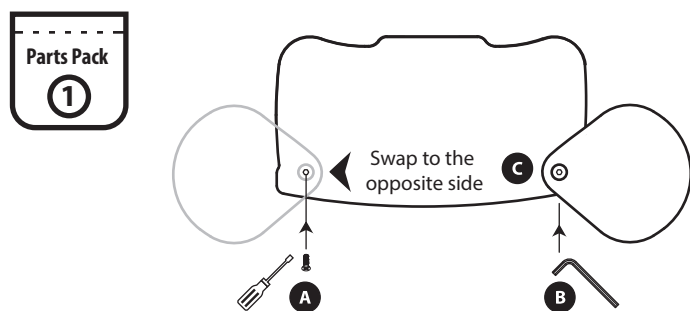

- A** Flip the tray and remove the screw at the opposite position.
- B** Use the allen wrench to remove the mouse tray.
- C** Swap their position and re-screw them until fastened.
- !** Please confirm the mouse orientataion before installation work begins.

- A** Loose the knob handle.
- B** Gently move the arm assembly up or down to preferred position.
- C** Fasten the knob handle.

- A** Loose the knob handle.
- B** Hold on to the both sides of the tray and tilt it to the desired angle.
- C** Fasten the knob handle.

- A** Push the side of the tray assembly to left or right direction.
- B** You can also hold on to the both side of the tray and move it to the left or right.