

S2000 SUBFRAME HARD COLLAR KIT



APPLICATIONS

2000-2009 Honda S2000

BEFORE INSTALLING PRODUCT, PLEASE READ INSTALLATION GUIDE FIRST. IF YOU HAVE ANY QUESTIONS OR CONCERNS, PLEASE REFERENCE THE VEHICLE'S FACTORY SERVICE MANUAL OR CONTACT AN EXPERIENCED MECHANIC OR TECHNICIAN.

IMPORTANT NOTES

During installation, do not use impact tools. Only use hand tools. Re-torque mounting bolts after the 1st 500 miles or after each track racing events.

REQUIRED TOOLS

- Lug, Socket and Box Wrenches
- Torque wrench
- Jack and jack stands (or access to lift)

ASSEMBLY

1. Using an automotive lift or hydraulic jack, raise vehicle and remove tires.
2. Disconnect the link join on the steering column shaft. Make sure to mark the position of the shaft vs. the linkage to properly align the two during re-installation.

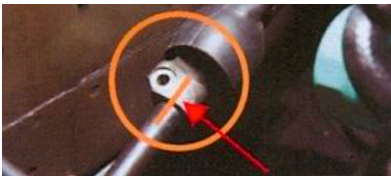

3. Loosen the bolts on the subframe. **DO NOT REMOVE THE BOLTS.** Drop the subframe 8mm from the chassis of the vehicle.

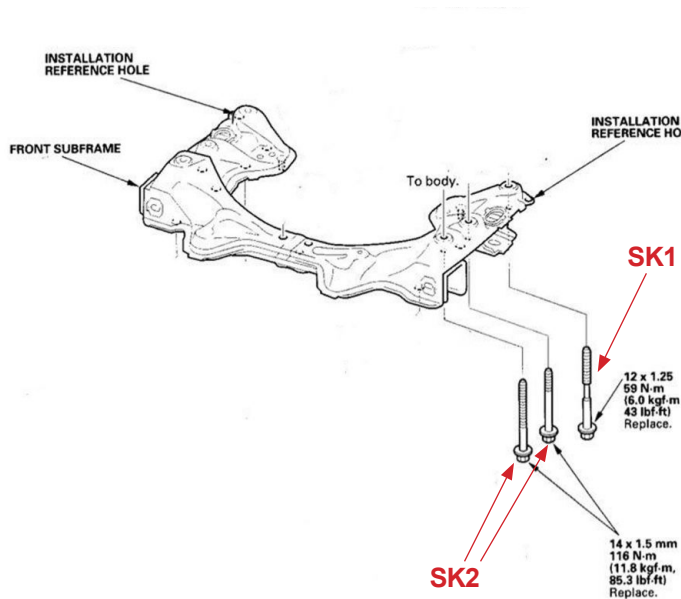

FRONT

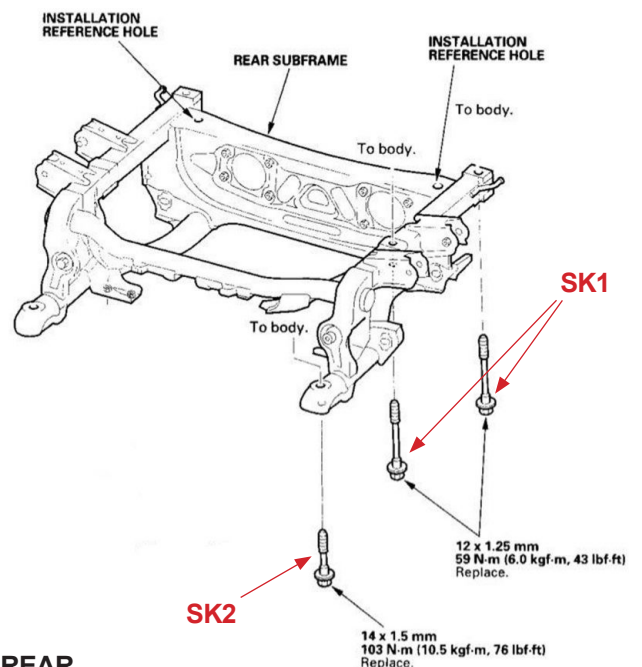

REAR

4. Please match the imprinted part numbers on each collar to the appropriate position and orientation shown in the diagram.
5. Install collar SK1 in between the body and subframe with part number and logo facing toward ground.
6. Install collar SK2 to the front outer position with part number facing up.
7. **TORQUE ALL BOLTS EVENLY TO THE CORRECT FACTORY SPECS ENSURING PROPER AND LEVEL/EVEN INSTALLATION.**

