



Rangehood

Instruction For Installation And Use

Model: RH10390

RH50190

RH90590

RH90660

RH30190

RH30160B

RH30190B

Important! Read these instructions for installation and use carefully. Keep these instructions for future reference. Any questions regarding the operation, maintenance service or warranty of the appliance should be directed to GASLAND chef.



Local Service:

ozmyhomeappliances@gmail.com

www.gaslandchef.com.au



Global Service:

+1(844)-538-7890

support@gaslandchef.com

www.gaslandchef.com



INTRODUCTION

Thank you for choosing this range hood.

This instruction manual is designed to provide you with all required instructions related to the installation, use and maintenance of the appliance.

In order to operate the unit correctly and safely, please read this instruction manual carefully before installation and usage.

The range hood uses high quality materials, and is made with a streamlined design.

Equipped with large power electric motor and centrifugal fan, it also provides strong suction power, low noise operation, non-stick grease filter and easy assembly installation.

SAFETY PRECAUTION

Never let the children operate the machine.

The range hood is for home use only, not suitable for barbecue, roast shop and other commercial purpose.

The range hood and its filter should be cleaned regularly in order to keep in good working condition.

Clean the range hood according to the instruction manual and keep the unit from danger of burning. There is a fire risk if cleaning is not carried out in accordance with the instructions.

Forbid the direct baking from the gas cooker.

Please keep the kitchen room a good convection.

If the supply cord is damaged, it must be replaced by the manufacturer, its service agent or similarly qualified persons in order to avoid a hazard.

There shall be adequate ventilation of the room when the range hood is used at the same time as appliances burning gas or other fuels.

The air must not be discharged into a flue that is used for exhausting fumes from appliances burning gas or other fuels.

Regulations concerning the discharge of air have to be fulfilled.

This appliance can be used by children aged from 8 years and above and persons with reduced physical, sensory or mental capabilities or lack of experience and knowledge. If they have been given supervision or instruction concerning use of the appliance in a safe way and understand the hazards involved.

Local Service:



 ozmyhomeappliances@gmail.com

 www.gaslandchef.com.au

GASLAND
chef



Global Service:

 +1(844)-538-7890

 support@gaslandchef.com

 www.gaslandchef.com



Children should be supervised to ensure that they do not play with the appliance. Cleaning and user maintenance shall not be made by children without supervision.

Do not flame under the range hood.

Accessible parts may become hot when used with cooking appliance.

The warning shall be in the same part of the instructions that include details of how to mount the equipment.

ELECTRICAL SHOCK HAZARD

Only plug this unit into a properly earthed outlet. If in doubt seek advice from a suitably qualified engineer.

Failure to follow these instructions can result in death, fire, or electrical shock.

WALL MOUNTING INSTALLATION

1. Prepare for installation

- If you have an outlet to the outside, your range hood can be connected as below picture by means of an extraction duct (enamel, aluminum, flexible pipe or inflammable material with an interior diameter of 150mm). (Fig.1)
- Before installation, turn the unit off and unplug it from the outlet. (Fig.2)
- The range hood should be placed at a distance of 65~75cm above the cooking plane for best effect. (Fig.3)

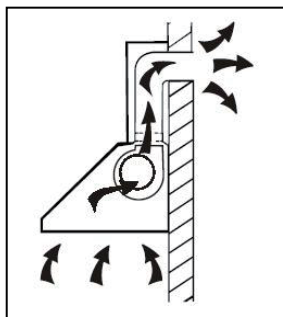

Pig.1



Pig.2

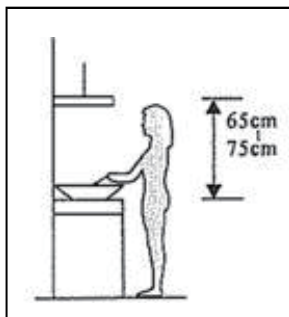

Pig.3

Local Service:

 ozmyhomeappliances@gmail.com

 www.gaslandchef.com.au

GASLAND
chef



Global Service:

 +1(844)-538-7890

 support@gaslandchef.com

 www.gaslandchef.com



2. Installation (Vent outside)

Attention! Observe the warning in the instruction sheet concerning the operation of the appliance when air is discharged from the room.

When the range hood and appliance supplied with energy other than electricity are simultaneously in operation, the negative pressure in the room must be not exceed 4 Pa (4×10^{-5} Bar)

- Drill 3 x 8mm holes to accommodate the bracket. Screw and tighten the bracket onto the wall with the screws & screw plugs provided. (Fig.4)

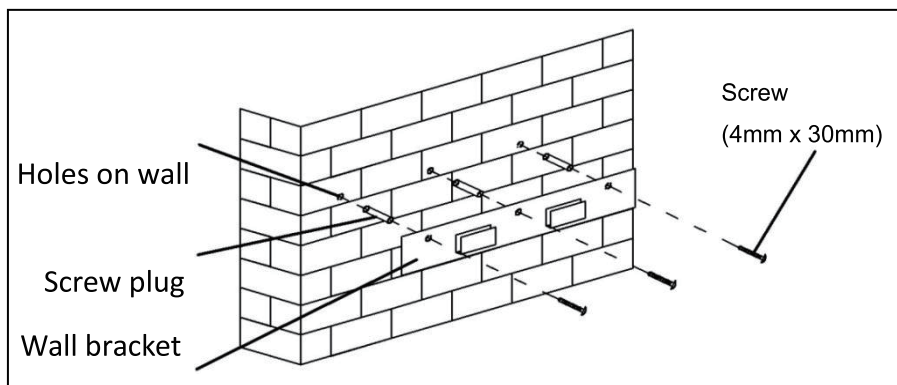

Fig.4

- Leave up the range hood and hang onto the wall bracket hook. (Fig.5)

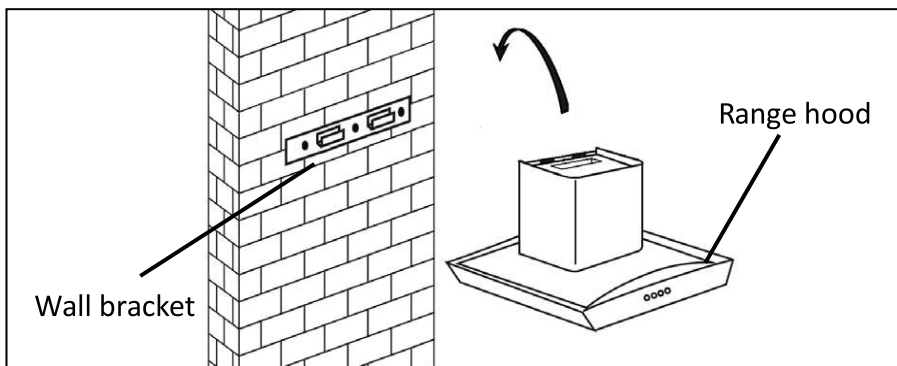

Fig.5

Local Service:

ozmyhomeappliances@gmail.com

www.gaslandchef.com.au

GASLAND
chef



Global Service:

+1(844)-538-7890

support@gaslandchef.com

www.gaslandchef.com



- Fix the one-way-valve to the air outlet of the range hood. Then, attached the exhaust pipe onto the one-way-valve as shown below. (Fig.6)

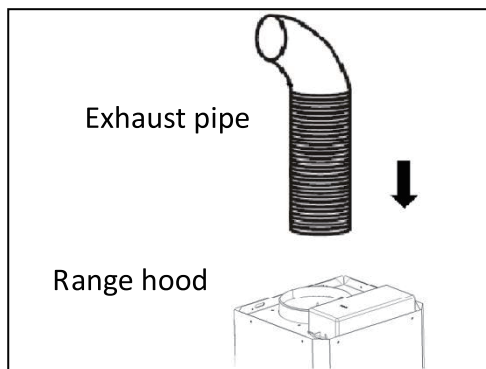

Pig.6

CHIMNEY INSTALLATION

For RH10390 / RH50190

- By put the upper chimney into lower chimney. Then pulling out the upper chimney upwards. Adjust to reach the height required. (Fig.7)

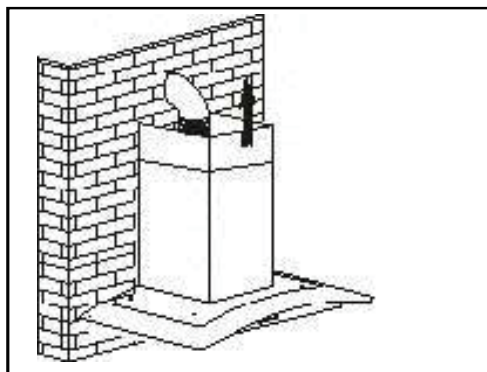

Pig.7



Local Service:

ozmyhomeappliances@gmail.com

www.gaslandchef.com.au

GASLAND
chef



Global Service:

+1(844)-538-7890

support@gaslandchef.com

www.gaslandchef.com



- Sliding the chimney to adjust the chimney height. When the height you required is reached, then hang the fixing hole to the fixing screws as showed in below pictures. (Fig.8)

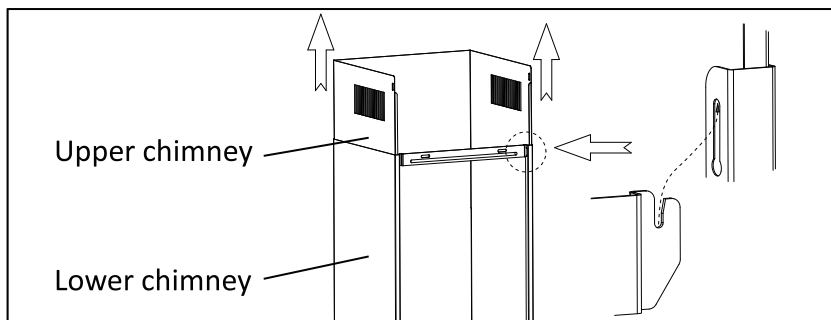

Fig.8

- Drill 2x8mm holes to accommodate the plate II. Screw and tighten the plate II onto the wall with 2 screws provided. Assembly the chimney onto the unit and fix it with 2 screws. (Fig.9)

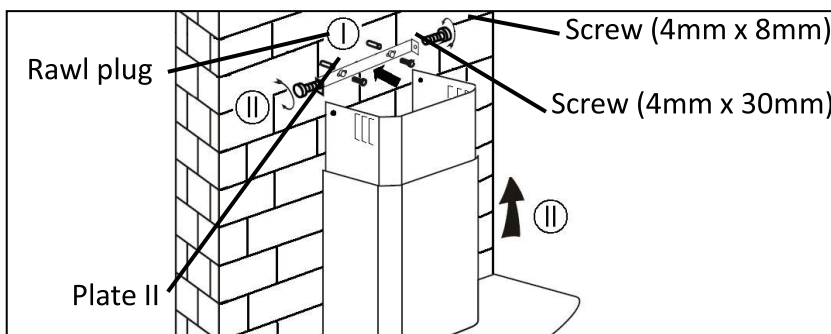

Fig.9

Warning:

Failure to install the screws or fixing device in accordance with these instructions may result in electrical hazards.



Local Service:

ozmyhomeappliances@gmail.com

www.gaslandchef.com.au



Global Service:

+1(844)-538-7890

support@gaslandchef.com

www.gaslandchef.com



For RH90590

Method One

- To install onto the wall drill 2 holes of Ø8mm on a suitable place according with the center distance of hole in the back of the range hood.
- Insert the nut into the holes.
- Insert the screws into the nuts and tight. Put the range hood onto the tighten screws. (Fig.10)

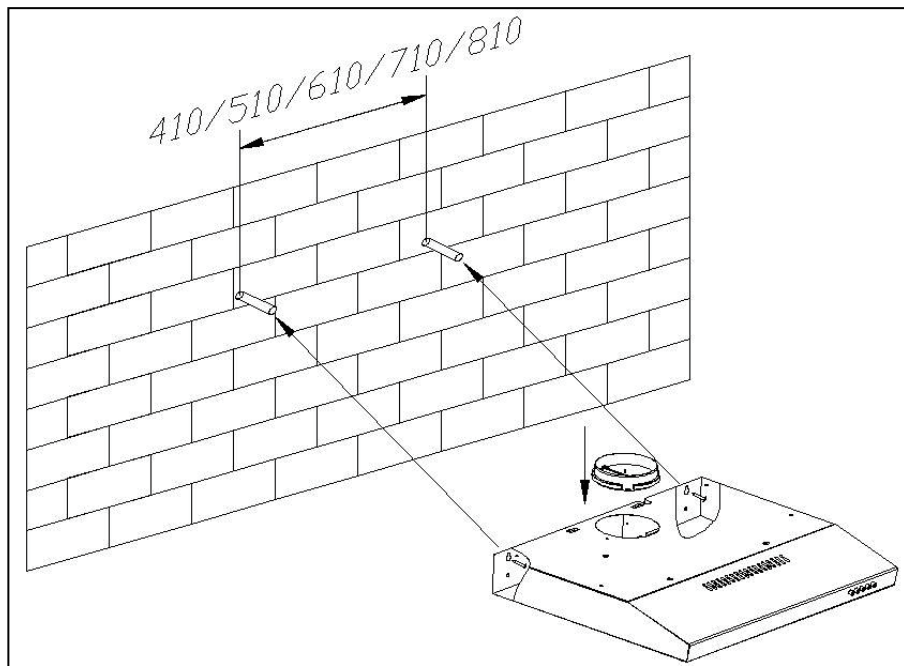

(Fig.10)

- Fix the range hood with safety screw. The two safety vents are positioned on the back casing, with diameter of 6mm.
- Put the one way valve onto the range hood.



Local Service:

✉ ozmyhomeappliances@gmail.com

🌐 www.gaslandchef.com.au

GASLAND
 chef

Global Service:

☎ +1(844)-538-7890

✉ support@gaslandchef.com

🌐 www.gaslandchef.com



Method Two

- Drill 4 holes of 6mm diameter at the bottom of the hanging cupboard.
- Put the one way valve on the range hood, then install the range hood on the bottom of the hanging cupboard, tighten the hood with enclosed 4 screws. (Fig.11)

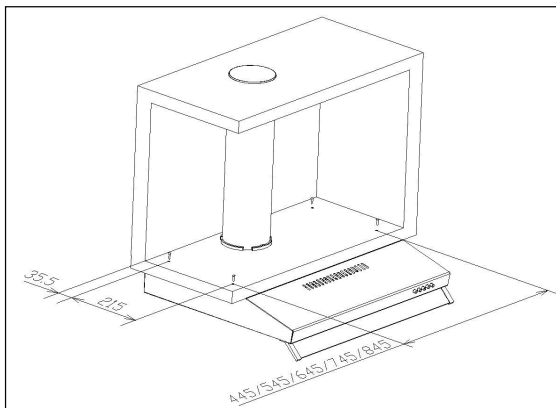

(Fig.11)

Note:

- 1.The extensible pipe are optional accessory, not supplied.
- 2.Take off protection film before installation.
- 3.There are 2 methods for ventilation, including "horizontal ventilation" and "vertical ventilation". Please pay attention to the ventilation method when installation.

Vertical ventilation: See Pic A, please use tool take out the round cover before using, and the air can be vented from top.

Horizontal ventilation: See Pic B, please use tool take out the rectangular cover before using, and the air can be vented from back.

The rectangular air outlet for horizontal ventilation is not supplied.

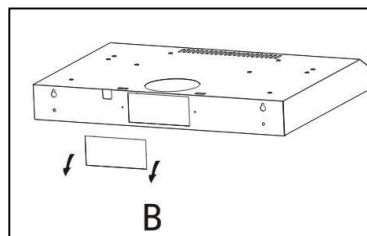
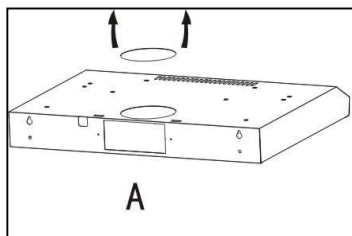

Local Service:

ozmyhomeappliances@gmail.com

www.gaslandchef.com.au

GASLAND
chef



Global Service:

+1(844)-538-7890

support@gaslandchef.com

www.gaslandchef.com



Air Ventilation Setting

- Outdoor exhausting: Turn the adjuster to outdoor position, install the outlet, turn on the range hood, then the air will be vented from the outside outlet. (Fig.12)
- Recycling: The recycling mode with carbon filter, turn the adjuster to indoor position, install the outlet cover, turn on the range hood, then the air can be vented from the inside outlet. (Fig.13)

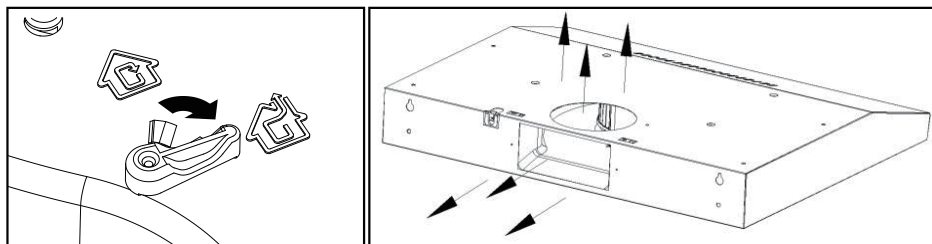

(Fig.12)

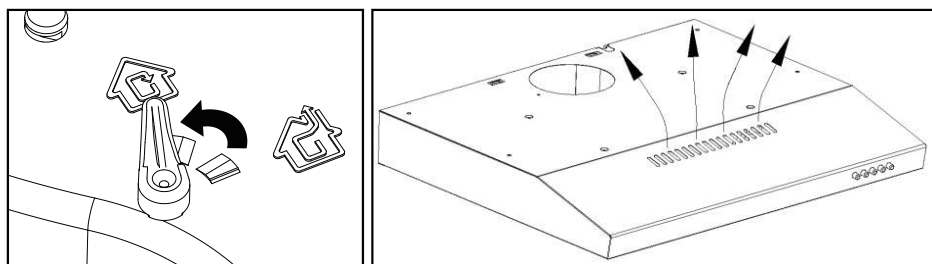

(Fig.13)

Note:

The charcoal filter is mounted on the back of the grill and must be changed once three month.

Warning:

The charcoal cannot be washed or recycled. It should be changed at most after 120 hours using. The carbon filter shouldn't be exposed to heat.

Local Service:

✉ ozmyhomeappliances@gmail.com

🌐 www.gaslandchef.com.au

GASLAND
 chef

Global Service:

☎ +1(844)-538-7890

✉ support@gaslandchef.com

🌐 www.gaslandchef.com



For RH90660

Method One

- To install onto the wall drill 2 holes of Ø8mm on a suitable place according with the center distance of hole in the back of the range hood.
- Insert the nut into the holes.
- Insert the screws into the nuts and tight. Put the range hood onto the tighten screws. (Fig.14)

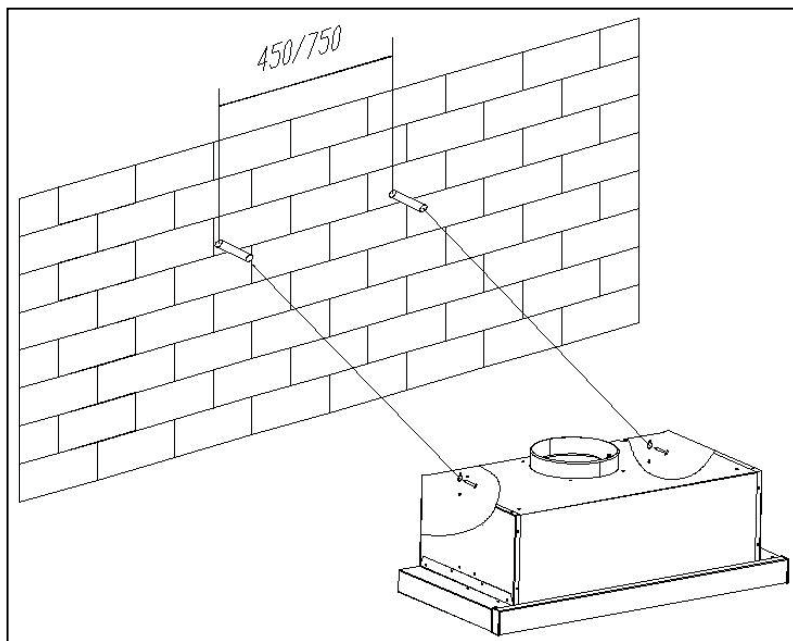

(Fig.14)

- Fix the range hood with safety screw. The two safety vents are positioned on the back casing, with diameter of 6mm.
- Put the one way valve onto the range hood.



Local Service:

ozmyhomeappliances@gmail.com

www.gaslandchef.com.au



Global Service:

+1(844)-538-7890

support@gaslandchef.com

www.gaslandchef.com



Method Two

- Drill 4 holes of 6mm diameter at the bottom of the hanging cupboard.
- Put the one way valve on the range hood, then install the range hood on the bottom of the hanging cupboard, tighten the hood with enclosed 4 screws. (Fig.15)

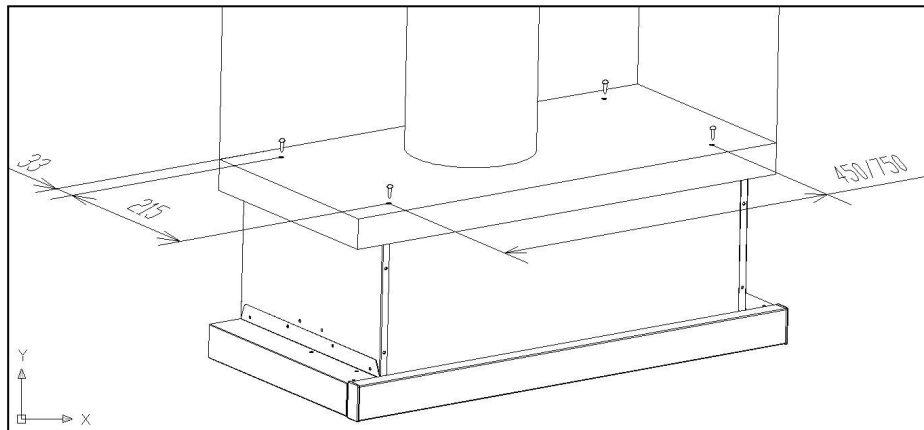

(Fig.15)

Note:

- 1.The extensible pipe are optional accessory, not supplied.
- 2.Take off protection film before installation.

For RH30190 / RH30160B / RH30190B

- By put the inner chimney into upper chimney. Then pulling out the upper chimney upwards. Adjust to reach the height required. (Fig.16)
- Fix the lower chimney with 2 pcs of 4x8mm screws. (Fig.17)
- Sliding the chimney to adjust the chimney height. When the height you required is reached, then fix 2 pcs of 4x8mm screws onto the hole fixing with plate I as showed in below pictures. (Fig.18-19)

Local Service:

o zmyhomeappliances@gmail.com

www.gaslandchef.com.au

GASLAND
chef



Global Service:

+1(844)-538-7890

support@gaslandchef.com

www.gaslandchef.com



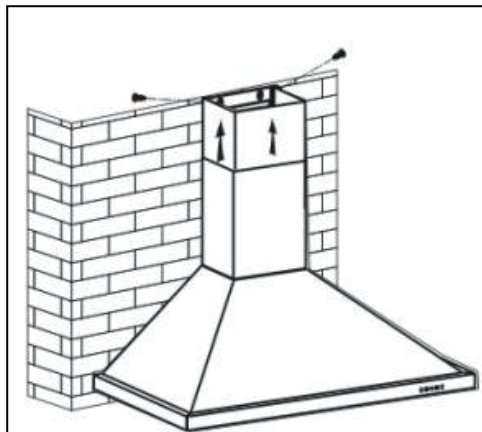

Pig.16

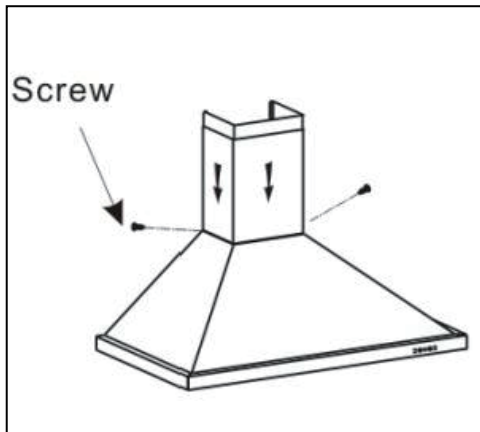

Pig.17

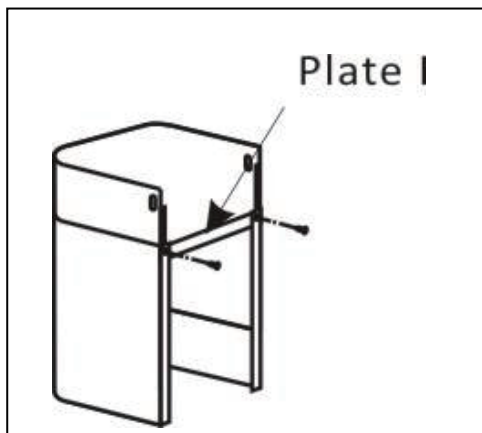

Pig.18

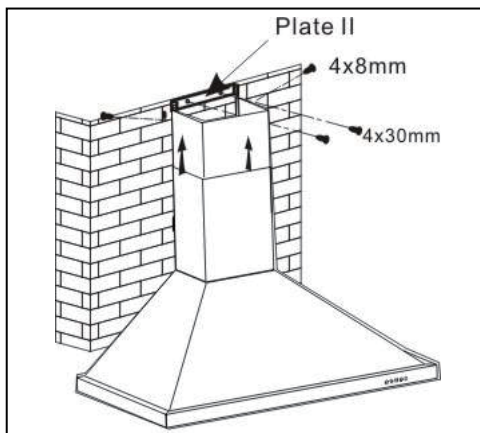

Pig.19

3. Installation (Vent Inside)

If you do not have an outlet to the outside, exhaust pipe is not required and the installation is similar to the one show in section "Installation (Ventoutside)". (Pig.20)

Activated carbon filter can be used to trap odors.

In order to install the activated carbon filter, the grease filter should be detached first. Press the lock and pull it downward. (Pig.21)



Local Service:

o ozmyhomeappliances@gmail.com

www.gaslandchef.com.au



Global Service:

+1(844)-538-7890

support@gaslandchef.com

www.gaslandchef.com



Plug the activated carbon filter into the unit and turn it in clockwise direction. Repeat the same on the other side. (Fig.22)

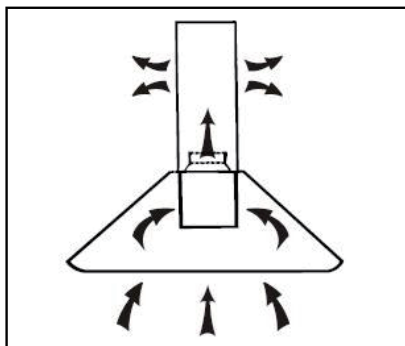

(Fig.20)

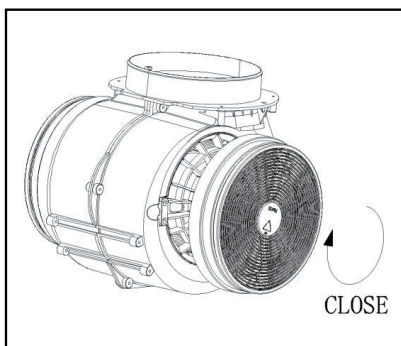

(Fig.21)

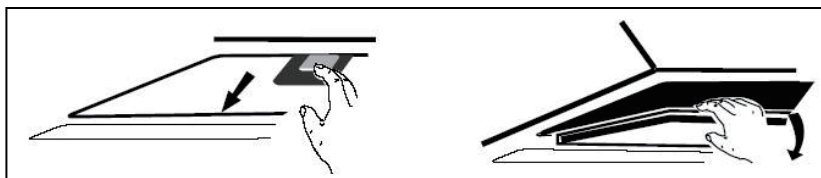

(Fig.22)

Note:

Make sure the filter is securely locked. Otherwise, it would loosen and cause dangerous.

When activated carbon filter attached, the suction power will be lower.

Local Service:

ozmyhomeappliances@gmail.com

www.gaslandchef.com.au

GASLAND
chef



Global Service:

+1(844)-538-7890

support@gaslandchef.com

www.gaslandchef.com



OPERATION

For RH10390 / RH50190

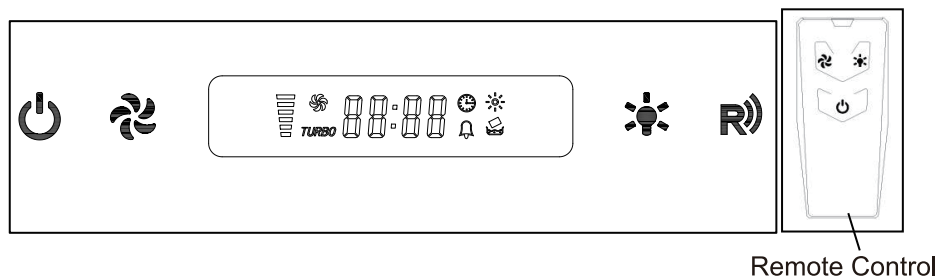

Before use the remote control, please remove the battery film!

Standby Mode

After plug in, just press flashing slowly, system is in standby mode.

"ON/OFF" Key

In standby mode, press display & all buttons light on, hood in working mode. If it's the first time start up motor working in low speed & light off automatically; or recover from the same setting of last working operation. (same for in remote control).

In working mode, press , motor stop working, but light will not change statue.

In working mode, press & hold for 3 seconds, motor & light stop working , back to standby mode. (same for in remote control with short press).

All other buttons just could work in working mode.

"FAN SPEED" Key

Button for changing the speed of motor following cycle "Low-Middle-High". (This key could not stop motor working.) (Same for in Remote control).

Light Button

Short press for lamp power control.

Long press

1. For turning off the "Cleaning symbol" & reset total working time when "Cleaning symbol" is on.
2. For checking current total working time when "Cleaning symbol" is off.



Local Service:

ozmyhomeappliances@gmail.com

www.gaslandchef.com.au



Global Service:

+1(844)-538-7890

support@gaslandchef.com

www.gaslandchef.com



Clock Setting

In standby mode, press + & hold for 1 second, the "88:88" flashing & enter the clock setting mode.

In this state: pressing for changing selecting hour or minute.

Press key to decrease. Press key to increase.

If press + key or without no any operation in clock setting.

Mode for 5 seconds, will save automatically & exit clock setting mode.

Timer Setting

When motor is working, press + & hold for 1 second, display flashing shows "00:00", enter the timer setting mode.

In this state: press to increase 15 minutes.

press to decrease 1 minutes.

press to increase 1 minute.

If press + key or without no any operation in clock setting mode for 5 seconds, will save automatically start to count down showing in display.

When time's up, both motor & light will turn off automatically & come back to standby mode.

LCD Display

1. Fan symbol, will turn when the fan is working

2. Time display

3. Timer

4. Light

5. Fan speed

6. Alarm symbol

7. Cleaning symbol, appear when total working time up to 14 hours or at the first time using after plugging.

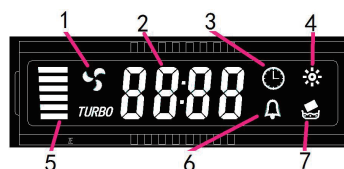

Auto (Heat & Smoke Sensor) Mode

In standby mode, press + and hold for 1 second, working mode stop & into gather mode (sensor collecting ambient information for 1min). After 1min LED display showing "auto" means into "auto" mode. Sensor monitor non-stop.

Dutton could stop "auto" mode and come back to standby mode.

Local Service:



o zmyhomeappliances@gmail.com

www.gaslandchef.com.au

GASLAND
chef



Global Service:

+1(844)-538-7890

support@gaslandchef.com

www.gaslandchef.com



For RH90590 / RH30190 / RH30160B / RH30190B



0 Off button

It's used for turning off the fan.

Low Speed button

It's used for ventilation on the kitchen. It is suitable for simmering and cooking which do not make much steam.

Medium Speed button

Airflow speed is ideally for ventilation in standard cooking operation.

High Speed button

When high density of smoke or steam produced, press high-speed button for highest effective ventilation.

Light button

For RH90660

It just appear in telescopic model.



Light button on the left side of hood.



Speed button on the right side of hood.

"=": High Speed Level.

"-": Low Speed Level.

"o": Off



Local Service:

 ozmyhomeappliances@gmail.com

 www.gaslandchef.com.au



Global Service:

 +1(844)-538-7890

 support@gaslandchef.com

 www.gaslandchef.com



MAINTENANCE

Before cleaning switch the unit off and pull out the plug.

1. Regular Cleaning

Use a soft cloth moistened with hand-warm mildly soapy water or household cleaning detergent. Never use metal pads, chemical, abrasive material or stiff brush to clean the unit.

2. Monthly Cleaning for Grease Filter

Essential: Clean the filter every month can prevent any risk of fire. The filter collects grease, smoke and dust, so the filter is directly affecting the efficiency of the range hood. If not cleaned, the grease residue (potential flammable) will saturate on the filter. Clean it with household cleaning detergent.

3. Annual Cleaning for Activated Carbon Filter

Apply solely to unit that installed as a re circulation unit (not vented to the outside). This filter traps odors and must be replaced at least once a year depending on how frequent the range hood used.

4. Bulb Replacement

- 1.Switch the unit off and unplug the appliance.
- 2.Remove the lamp cover by unscrewing the 2 screws.
- 3.Unscrew the incandescent bulb.
- 4.Replace with the same type and rated bulb/ lamp.

- E14 Incandescent bulb: (220V E14 Max 40W). (Fig.23)
- Halogen lamp (Max, 20W) & LED lamp (Max,1.5W). (Fig.24)
- For slim model. (Fig.25-26-27)

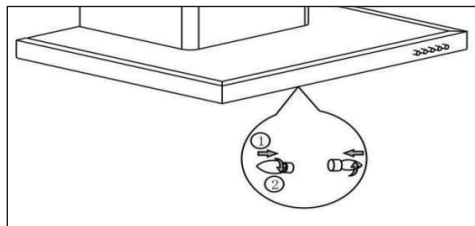

(Fig.23)

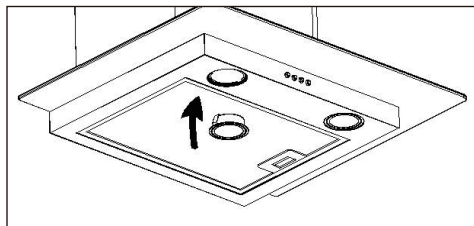

(Fig.24)



Local Service:

ozmyhomeappliances@gmail.com

www.gaslandchef.com.au



Global Service:

+1(844)-538-7890

support@gaslandchef.com

www.gaslandchef.com



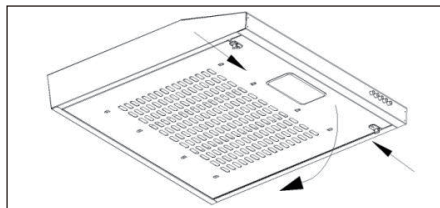

(Fig.25)

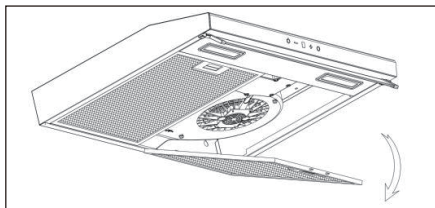

(Fig.25)

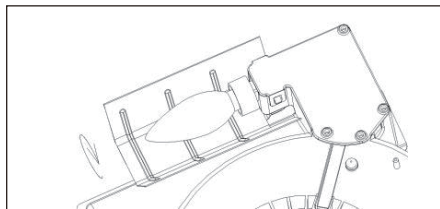

(Fig.27)

TROUBLESHOOTING

Fault	Cause	Solution
Light on, but fan does not work	The fan blade is jammed.	Switch of the unit and repair by qualified service personnel only.
	The motor is damaged.	
Both light and fan do not work	light bulb burn.	Replace the bulb with correct rating.
	Power cord looses.	Plug in to the power supply again.
Serious vibration of the unit	The fan blade is damaged.	Switch of the unit and repair by qualified service personnel only.
	The fan motor is not fixed tightly.	Switch of the unit and repair by qualified service personnel only.
	The unit is not hung properly on the bracket.	Take down the unit and check whether the bracket is in proper.
Suction performance	Too long distance between the unit and the.	Readjust the distance to 65-75cm.

Local Service:

 ozmyhomeappliances@gmail.com
 www.gaslandchef.com.au
GASLAND
 chef

Global Service:

 +1(844)-538-7890

 support@gaslandchef.com
 www.gaslandchef.com

ENVIRONMENTAL PROTECTION

Waste electrical products should not be disposed of with household waste. Please recycle where facilities exist. Check with your local authority or retailer for recycling advice.



By ensuring this product is disposed of correctly, you will help prevent potential negative consequences for the environment and human health, which could otherwise be caused by inappropriate waste handling of this product. The symbol on the product indicates that this product may not be treated as household waste. Instead it shall be handed over to the applicable collection point for the recycling of electrical and electronic equipment.

WARRANTY

The appliance comes with a 1 year limited warranty, provided it has been operated and maintained as per the manufacturer's specifications outlined in the instruction manual.

In the event of defects arising from faulty workmanship and/or materials for a period of 1 years from the date of purchase, GASLAND chef will replace or repair the appliance free of charge. In accordance with Australian Consumer law, you are entitled to a refund or a replacement in the event of a major failure, and compensation for any other reasonably foreseeable loss or damage. You are also entitled to have the unit replaced or repaired if it fails to be of acceptable quality and the failure does not amount to a major failure.

Local Service:



 ozmyhomeappliances@gmail.com

 www.gaslandchef.com.au



Global Service:

 +1(844)-538-7890

 support@gaslandchef.com

 www.gaslandchef.com





Local Service:

✉ ozmyhomeappliances@gmail.com

🛒 www.gaslandchef.com.au

Global Service:

☎ +1(844)-538-7890

✉ support@gaslandchef.com

🛒 www.gaslandchef.com

