

# earthwool<sup>the feel good insulation</sup>® Acoustic Roll

## Designed for use in internal walls and floors

### BENEFITS

- Provides a solution for compliance with Part E (resistance to the passage of sound) of the Building Regulations (England and Wales) and Section 5 (Scotland)
- Proven results by laboratory acoustic testing
- Can be used with all types and brands of plasterboard
- BIM Objects available for all thicknesses
- Non-combustible with a Euroclass A1 reaction to fire rating
- Manufactured using ECOSE® Technology, reducing embodied energy when compared to traditional mineral wool
- Awarded Eurofins Gold Standard for Indoor Air Quality



**KNAUFINSULATION**  
*it's time to save energy*

with **ECOSE**®  
TECHNOLOGY

# Earthwool Acoustic Roll

## Product information

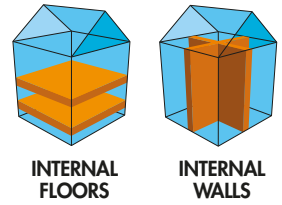

Designed specifically for the sound insulation of residential building elements such as internal walls, separating floors and internal floors and walls where compliance with acoustic regulation is required. Earthwool Acoustic Roll is also suitable for use with a wide range of commercial metal stud partitions.

### Product information

Thickness (mm)	Length (m)	Width (mm)	Area per roll (m <sup>2</sup> )
100	9.17	2x600	11.00
100	9.17	3x400	11.00
75	12.50	2x600	15.00
50	13.00	2x600	15.60
25	10.00	4x600	24.00

## Internal walls

## Acoustic performance

### Building Regulations

England and Wales: Approved Document E

All internal walls between a bedroom or room containing a WC and another room must provide a minimum sound insulation of 40 R<sub>w</sub> dB

### Building Regulations

Scotland: Section 5

All internal walls between a bedroom or room containing a WC and another room must provide a minimum sound insulation of 43 R<sub>w</sub> dB

## Timber studs - 63mm x 38mm

Region	Plasterboard	Roll thickness	Compliance
England and Wales	12.5mm Knauf Drywall Wall Board on each side	50mm	✓
Scotland	12.5mm British Gypsum Gyproc Soundbloc on each side	25mm	✓
Scotland	12.5mm Knauf Drywall SoundShield Plus on each side	25mm	✓

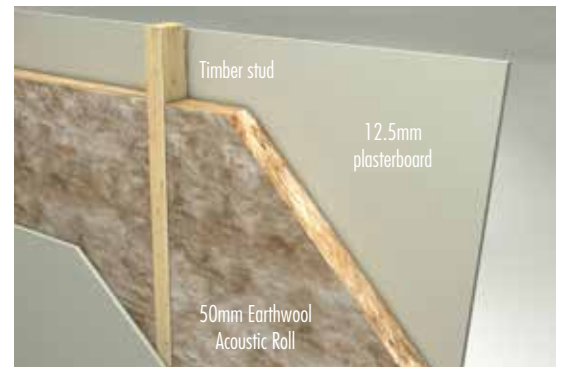

## Metal C studs - 48mm

Region	Plasterboard	Roll thickness	Compliance
England and Wales	12.5mm British Gypsum Gyproc Wallboard on each side	25mm	✓
England and Wales	12.5mm Knauf Drywall WallBoard on each side	25mm	✓
Scotland	12.5mm British Gypsum Gyproc Wallboard on each side	25mm	✓

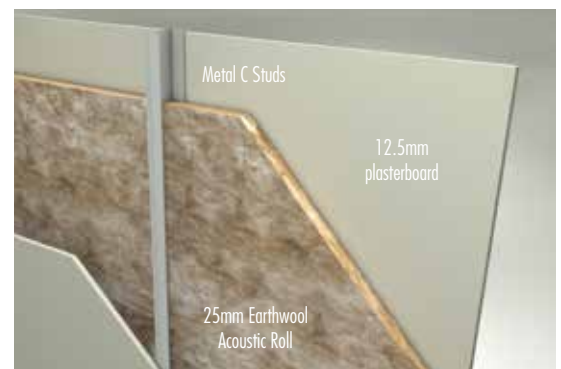

Note: Test reports available on request

Technical Support Team

**TEL: 01744 766 666**

technical.uk@knaufinsulation.co.uk

www.knaufinsulation.co.uk

KINE2207LFT - V0914

**KNAUF INSULATION**  
it's time to save energy