

Parts List + Surface Preparation

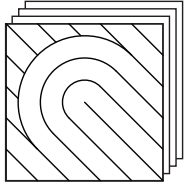

4 ACOUSTIC TILES

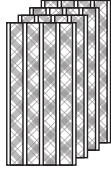

16 ADHESIVE STRIPS
(shipped upon request)

Prepare installation surface by cleaning it thoroughly and making sure it is flat and even.

1

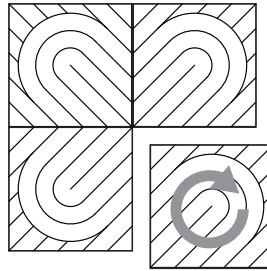

Select a pattern for installation. Test the arrangement on a clean surface. We recommend having a printed layout to reference during installation.

2

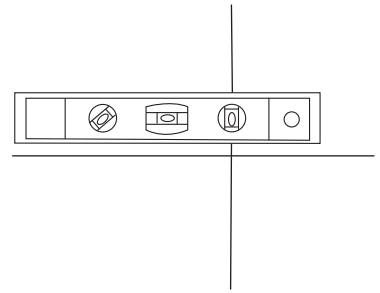

Use a level or a laser to mark where the first tiles will be placed.

Double-sided Tape Installation

3

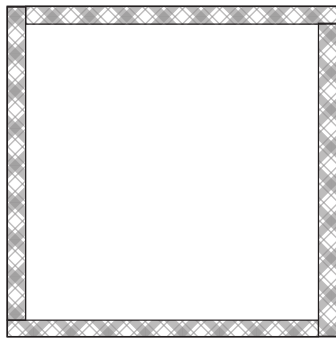

Apply adhesive strips as shown so that each corner is covered with tape.

4

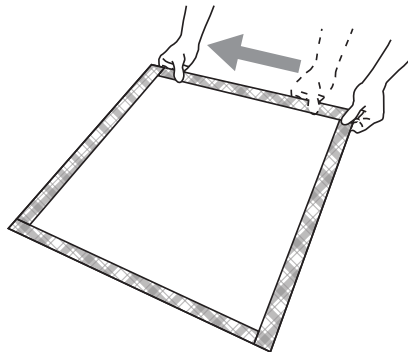

Press firmly along the entire perimeter to ensure tape is secure. Use a roller if available.

5

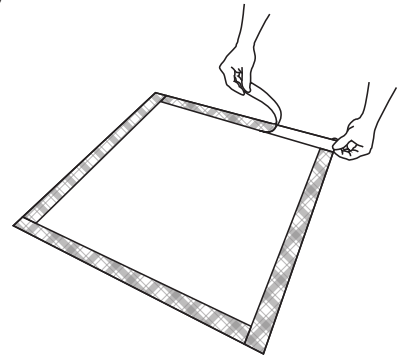

Peel backing off of each strip and apply tile to wall butting tile edges.

Construction Adhesive Installation

3



Wipe wall with a damp cloth for faster adhesive set times. It is recommended to sand installation surfaces that are too slick.

4

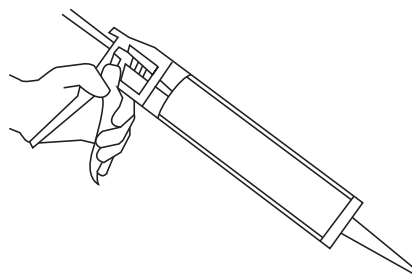

Apply Fuze*It All Surface Adhesive to the back of each tile. Apply adhesive one tile at a time to avoid drying before wall application.

5

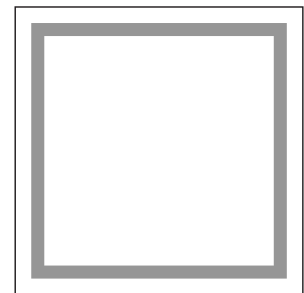

Apply a 1/4 inch adhesive bead to tile perimeter. Apply at least 1/4 in away from edge to prevent adhesive squeeze-out. Carefully remove and clean excess adhesive.

Final Step

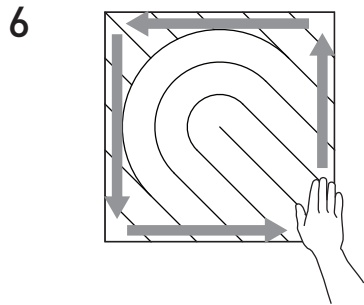

Once tiles are applied to wall, press firmly along each edge **repeatedly** until the tile is securely adhered. Carefully remove excess adhesive.

Cutting & Trimming Tiles

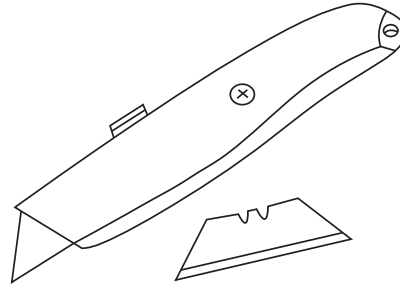

Tiles can be cut using a sharp utility knife and new blades or power tools with blades for cutting plastic.

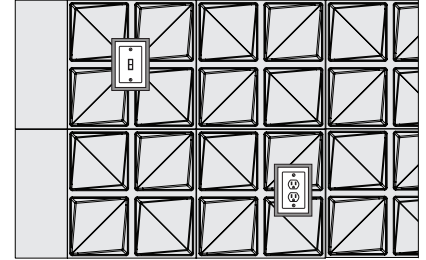

Install cut or Edge tiles where trim is least visible. Use wood trim around outlets, light switches, and mechanicals.

MIOCULTURE.COM

Still have questions?
Drop us a line or give us a call:



Email: info@mioculture.com
US Toll Free: 1-888-563-3916
International: +1 (215) 925-9359