

INSTRUCTION SHEET: DOMETIC BRISK AIR II, EVOLUTION, PENGUIN II, BLIZZARD AND GE



Tools Required

1. Stepstool or ladder
2. Cordless drill
3. 3/8-inch socket
4. Phillips head #2 screwdriver or drill adapter head
5. Square Head #2 screwdriver or drill adapter head

Airflow System Parts List

1. Duct inserts (two)
2. Airflow System (AFS)
3. HVAC Seal Tap
4. Duct Adapters (If Required)
5. Did Not Fit Card

Ceiling Assembly Parts List

1. Return Air Grille
2. Return Air Cover
3. Upper Divider Plate
4. AC Mounting Plate
5. 3/8-inch Lag Bolts (four)

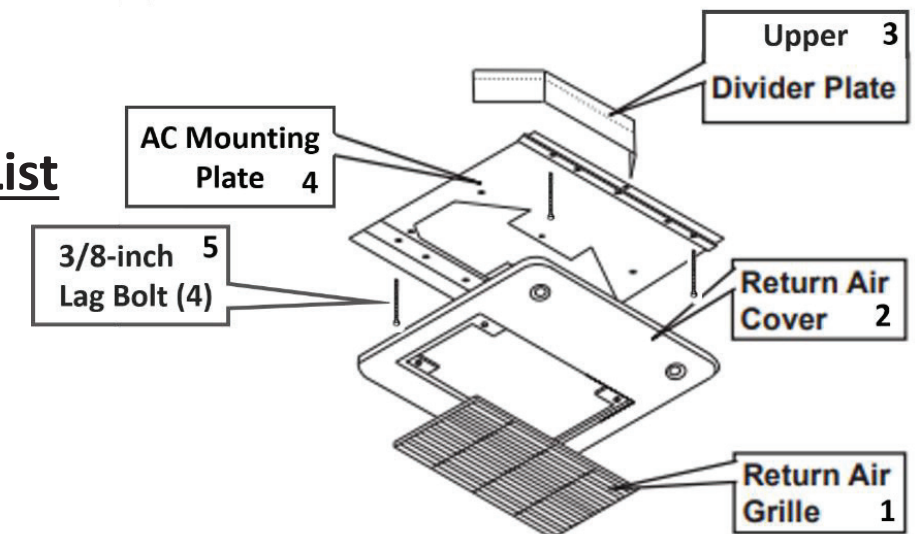

Remove Ceiling Assembly

1. Remove Return Air Grille.
2. Remove filter.
3. Remove screw covers.
4. Remove Return Air Cover (set all screws aside for later use).
5. Remove the two screws securing control box (see fig.1).
6. Remove AC Mounting Plate from plenum.
 - a. Remove the four 3/8-inch lag bolts.
 - b. Set aside for later use.
7. There are two divider plates in the plenum.
 - a. Lower Divider Plate: welded to AC Mounting Plate.
 - b. Upper Divider Plate: secured to lower divider plate by foil tape or white foam rubber (see fig.2).
 - c. Peel off foil tape or foam rubber connecting the two divider plates.
 - d. **Discard** foil tape/foam rubber and Upper Divider Plate.

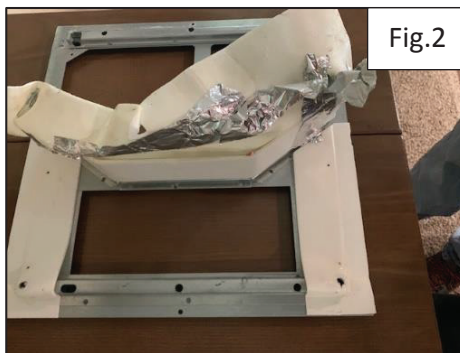
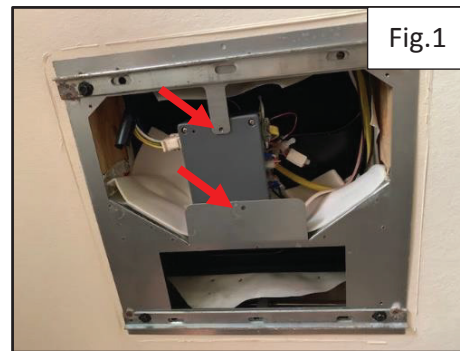

Plenum Area Preparation

Prepare plenum for Airflow System (AFS) installation.

1. Remove and replace all loose foil tape or foam rubber in plenum area.
2. Make sure the air conditioner bolt holes are centered to plenum.
3. Remove and discard factory installed duct inserts if present.

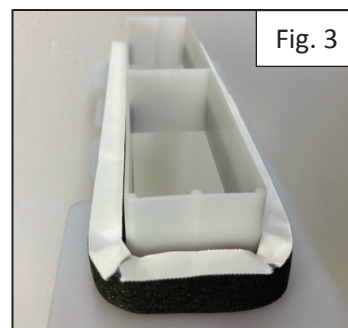

Install The AFS

1. Remove yellow strip from gasket and place around lip of duct insert.
2. Remove adhesive backing from duct inserts. (See fig. 3)
3. Place the inserts into the opening of the plenum ducts, shear edge to the back. (See fig. 4)
4. Place the AFS into the plenum. (See fig. 5)
 - a. Start with a 45-degree angle.
 - b. Handle with care to avoid damaging the AFS.
 - c. It should slide up against the top of plenum and the duct inserts.



INSTALLATION TIP:

If the AFS is too tight to insert:

1. Cut instruction sheet on the center line to use as shims.
2. Place between duct inserts and AFS.
3. Slide AFS into place using shims.
4. Gently remove shims.
5. You will notice our duct insert is 7.625 inches wide and our system is only 7.25 inches wide because we have our bolt path on the exterior of our kit. This means there could be some ducting exposed. (fig. 6 & 7)
6. You will need to cover this exposure with the HVAC tape that is included in your kit (fig. 8)

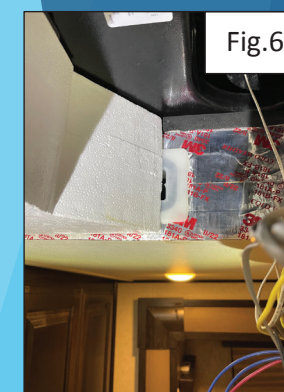
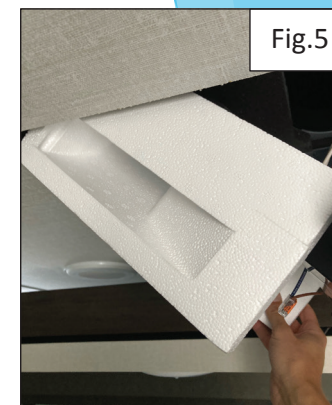

Restore Ceiling Assembly

1. Install mounting plate (HAND TIGHTEN ONLY).
 - a. Start with one lag bolt.
 - b. Insert in front corner while holding mounting plate at opposite corner.
 - c. Install remaining three lag bolts (start with other front lag bolt).
 - d. Using your drill, tighten all four lag bolts **EVENLY**, within 20-30 Inch pounder. If using a Wrench tighten 5-6 full revolutions past snug.
 - e. Torque specifications are in accordance with Dometic Manufacturing.

NOTE: Overtightening can damage the air conditioner's base pan. Not enough torque can cause inadequate roof seal leading to water intrusion.

2. Reinstall the two screws for the control box.
3. Reinstall Return Air Cover using all screws.
4. Reinstall screw covers.
5. Reinstall filter and Return Air Grill

For questions about installation please contact us at:
www.rvairflow.com
support@rvairflow.zendesk.com
(574)536-2472