

INSTRUCTION SHEET: COLEMAN MACH 3, 8, 10, 13.5, 15 Q



Tools Required

1. Stepstool or ladder
2. Cordless drill
3. Phillips head #2 screwdriver or drill adapter head
4. Square Head #2 screwdriver or drill adapter head
5. Utility Knife

Airflow System Parts List

1. Duct inserts (two)
2. Airflow System
3. HVAC Seal Tap
4. Duct Adapters (If Required)
5. Did Not Fit Card

Ceiling Assembly Parts List

1. Filter cover (two)
2. Filter (two)
3. Shroud
4. Air shower plate
5. Mounting plate
6. 1-inch separator
7. 5/16-inch lag bolt (four)

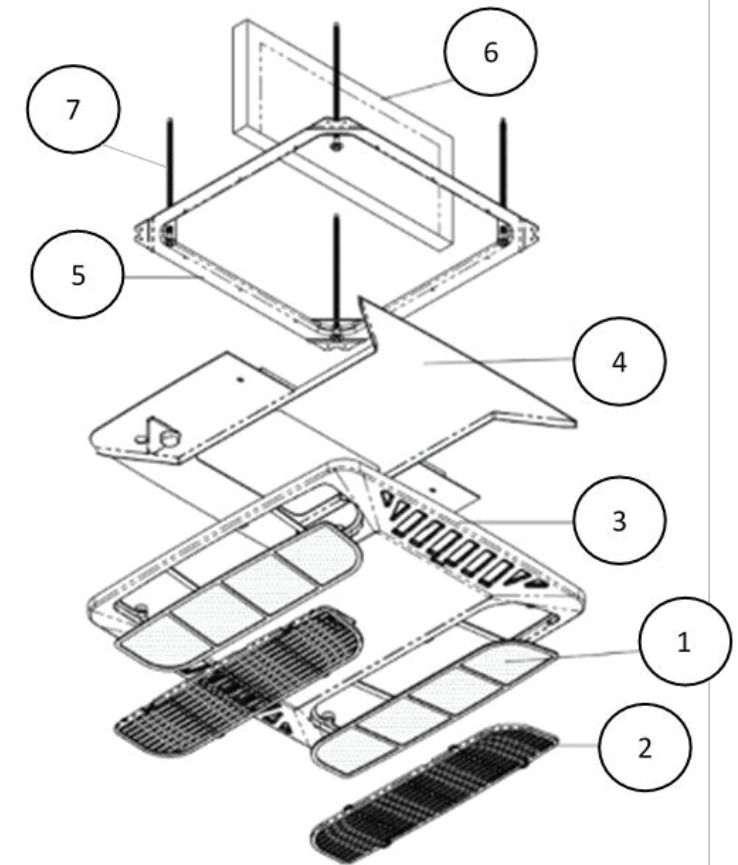

Part # CM31AS

Remove Ceiling Assembly

1. Remove filter covers.
2. Remove filters.
3. Remove Assembly cover (set all screws aside for later use).
4. Remove air shower plate **and discard**.
5. Remove mounting plate.
 - a. Remove the four 5/16-inch bolts.
 - b. Set aside for later use.
6. Remove 1-inch separator (see fig.1) **and discard**.
 - a. Remove any silver foil tape used to install the separator.

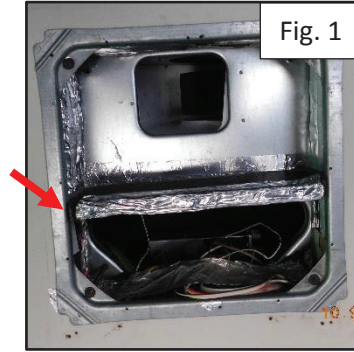

Plenum Area Preparation

Prepare the plenum for installing the Airflow System (AFS).

1. Remove and replace any loose foil tape in the main plenum area.
2. Remove and replace loose pieces of foil tape around ducts.
3. Remove and discard factory installed duct inserts if present.
4. Test fit AFS by doing the following.
 - a. Gently place AFS into plenum.
 - b. Insert rear lag bolts through AFS.
 - c. If they start and thread easily, proceed to installation procedures.
5. If lag bolts do not thread easily, then air conditioner needs to be centered.
 - a. Remove the AFS from the plenum, gently lift the air conditioner and move it side-to-side or front-to-back, to adjust air conditioner as needed.
 - b. The bolt holes should be aligned evenly in plenum (see fig.2).
 - c. Install AFS again to ensure lag bolts thread.
 - d. Repeat these steps, if needed, until lag bolts thread easily with AFS installed.
6. Be sure to remove the AFS before proceeding with installation procedures.

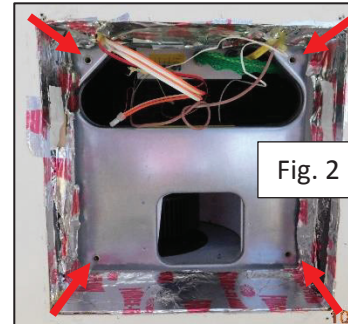

Install AFS

1. Remove yellow strip from gasket and place around lip of duct insert.
2. Remove adhesive backing from duct inserts (see fig.3).
3. Place duct inserts into opening of plenum ducts, shear edge to back (see fig.4).
4. Place AFS into plenum (see fig.5).
5. If ducting is smaller than 7.5" refer to back or "Did Not Fit" card.

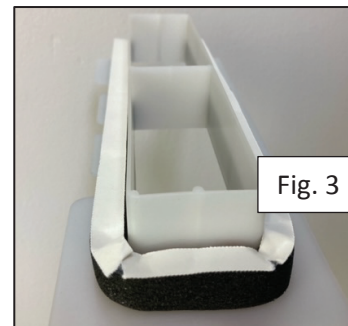

- a. Start with a 45-degree angle.
- b. Handle with care to avoid damaging AFS.
- c. It should slide up against top of plenum and duct inserts.

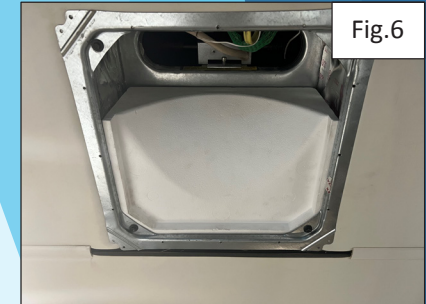

INSTALLATION TIP:

If the AFS is too tight to insert:

1. Cut instruction sheet on center line to use as shims.
2. Place between duct inserts and AFS.
3. Slide AFS into place using shims.
4. Gently remove shims.
5. Use HVAC tape to cover where AFS meets side wall of plenum.

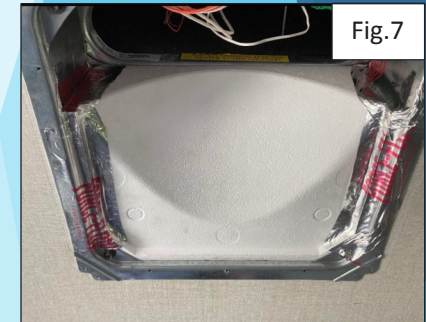

Restore Ceiling Assembly

1. Install mounting plate (**HAND TIGHTEN ONLY**).
 - a. Start with one lag bolt.
 - b. Insert in front corner while holding mounting plate at opposite corner.
 - c. Install remaining three lag bolts (start with other front lag bolt).
 - d. Using your drill, tighten all four lag bolts **EVENLY**, within 20-30 Inch pounder. If using a Wrench tighten 5-6 full revolutions past snug.
 - e. Torque specifications are in accordance with Coleman Manufacturing.

NOTE: Overtightening can damage the air conditioner's base pan. Not enough torque can cause inadequate roof seal leading to water intrusion.

2. Reinstall Assembly cover using all screws.
3. Reinstall filters and filter covers.

NOTE: Do not reinstall the air shower plate.
Refer to front page of instruction sheet

For questions about installation please contact us at:
www.rvairflow.com
support@rvairflow.zendesk.com
(574)536-2472