

Petree | Fully automatic cat litter box

Operation guide



Please read the instructions carefully before using the product, and keep them after reading

Product components

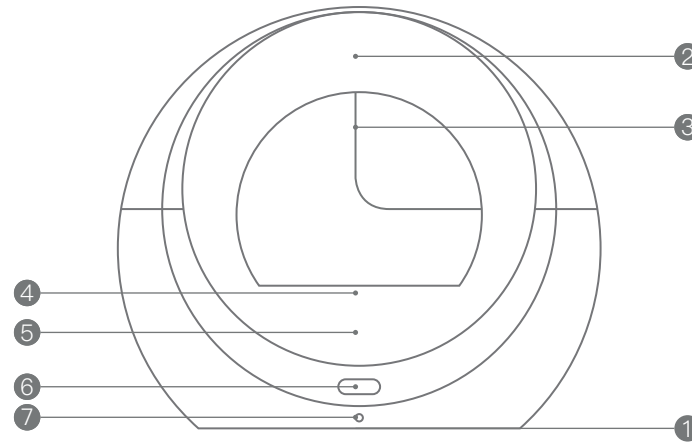

- ① Motor chassis (not washable)
- ② Spherical plastics hood(washable)
- ③ Patent separation structure
- ④ Sand removal pedal
- ⑤ Posterior closed deodorization litter can
- ⑥ Data display screen
- ⑦ Multifunctional button

Important safeguards

1. Place the machine on a stable and open ground to avoid vibration or interference of data measurement.
2. Do not stack items on the machine in order to avoid interfering with data measurement and prevent damage to machine components.
3. Do not place the machine at a humid environment and avoid placing it directly under water to prevent damage to electronic components.
4. Do not place the machine on a soft surface (carpet for example) to avoid interfering with data measurement.
5. Do not put the machine in direct or close contact with heat to prevent damage to machine components.
6. Use spherical bentonite cat litter.
7. Please lift and move the product with both hands. Do not drag it on flat surface.
8. When wast is dumped from the litter can, please install the litter can in place.
9. For the safety of the cats, please only use it for cats that are at least three-month old, and weighs over 1.5 Kg.

Product specifications

Product model	ACC-18-01	Noise	≤50dB (A)
Appearance size	624×587×537mm	Product weight	7.5Kg
Rated voltage	100-220V	Rated power	5W
Product material	PP plastic	Maximum range	20Kg
Minimum accuracy	0.01Kg	Maximum cat litter	4Kg

Functional mode



Sleep mode:

The machine goes into standby state and stops working. Automatically return back to normal operation mode after 10 hours. You can quit sleep mode manually in instant as well.



Emergency braking:

When the machine is running, you can press the multifunctional button to stop operation immediately.



Wait mode:

When the machine is activated with the cat in it, it will go to wait mode. Machine will go into operation after the cat leaves. If the cat stays in the box for a very short time, wait mode won't be activated, and the machine won't go into operation after the cat leaves.



Operation mode:

In this mode, the cat litter box will start rotating to cleaning procedures. Under this mode, when the cat enters or touches, the machine will immediately enter emergency braking mode. After the cat leaves, it will continue to complete the procedures.

Petree

Hangzhou Beiqu Technology Co., Ltd.

Operation guide

1 Trash bags

Pull up to open the rear trash bin to install garbage bags

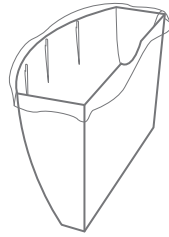

Normal size of trash bags are applicable, make it more convenient to replace.

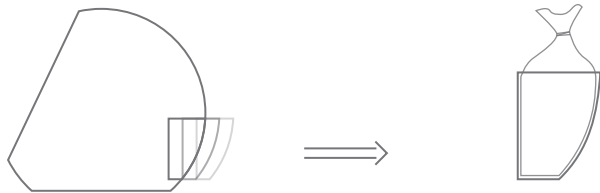

Pull out the trash can and take out the trash bag in one step, easy to dump.

3 Cat litter



Press the multifunctional button, the screen will show SLEEP, add litter when the machine is in sleep mode.

Note: When adding litter without machine entering sleep mode, the machine will mistakenly taken into cat's weight, and cause malfunction to the litter box.



Follow instruction of maximum litter line label, best add litter to the maximum line.

Attention: Failure to add cat litter according to the prescribed instructions will cause cat litter spill out of the box or other malfunction during operation.



After adding proper amount of cat litter, press the multifunctional button, wait until the screen shows GO, and the cat litter box rotates normally for two cycles.

Note: Exit sleep mode with button, the screen will show GO and the box will start rotating instantly.

2 Connecting to power supply

Power outlets is located under trash can, use adapter to connect to household power supplies.

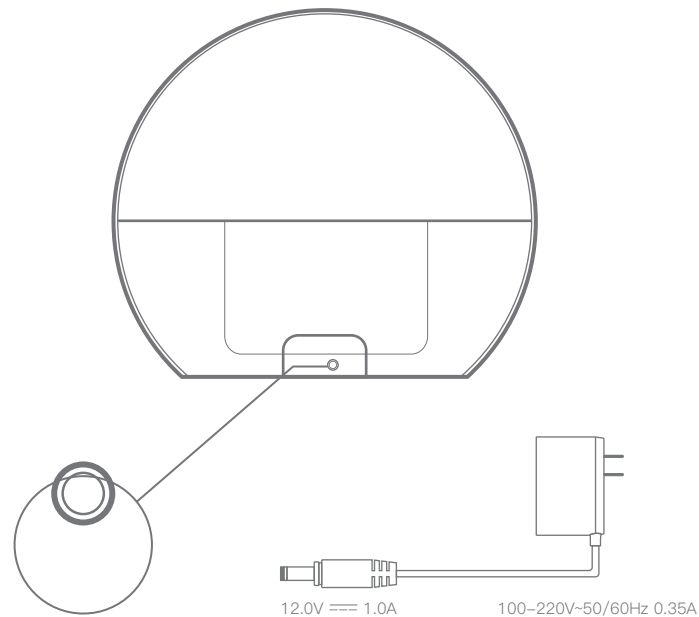

12V1A Safety Voltage, keep pets away to avoid electricity shock.

4 Use of equipment

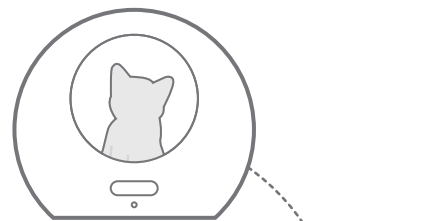

0.00kg

Real-time data will show on the screen when the cat enter into the box.

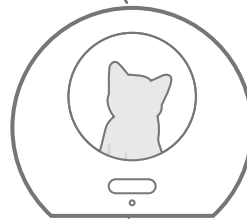

WAIT

When the cat stay in the box for a certain period of time, machine will take it as an effective excretion, and enter into standby mode.

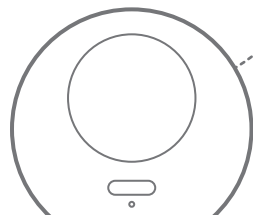

GO

After the cat is excreted, the machine starts running in 30 seconds to ensure effective separation of waste and litter, so that waste can be easily shoveled out.

Cleaning and maintenance

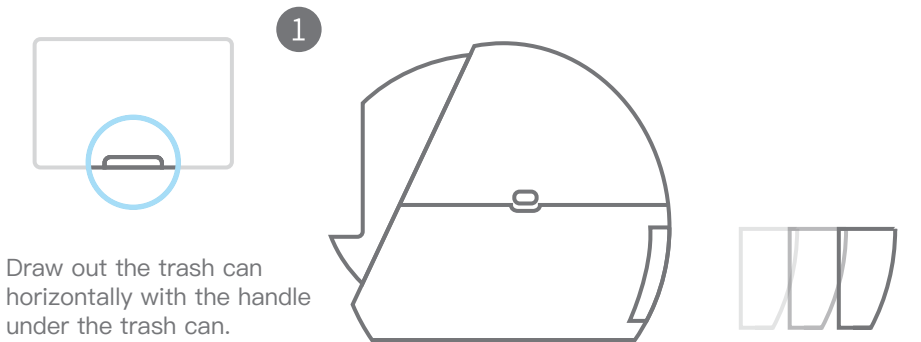

Draw out the trash can horizontally with the handle under the trash can.

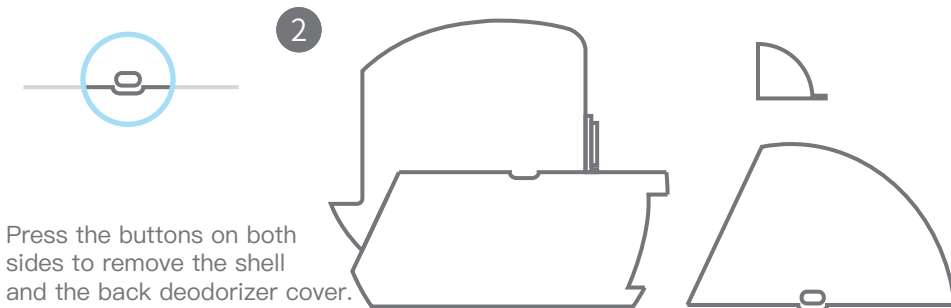

Press the buttons on both sides to remove the shell and the back deodorizer cover.



Unscrew the two long screws of the roller to separate the sphere from the base.

