



ASSEMBLY GUIDE  
GUIDE DE MONTAGE  
GUÍA DE MONTAJE

**CLASSIC**  
CLASSIQUE  
CLÁSICO

# MANCHESTER PRIVACY SCREEN

ÉCRAN DE CONFIDENTIALITÉ DE MANCHESTER  
PANTALLA DE PRIVACIDAD DE MANCHESTER

VA68246

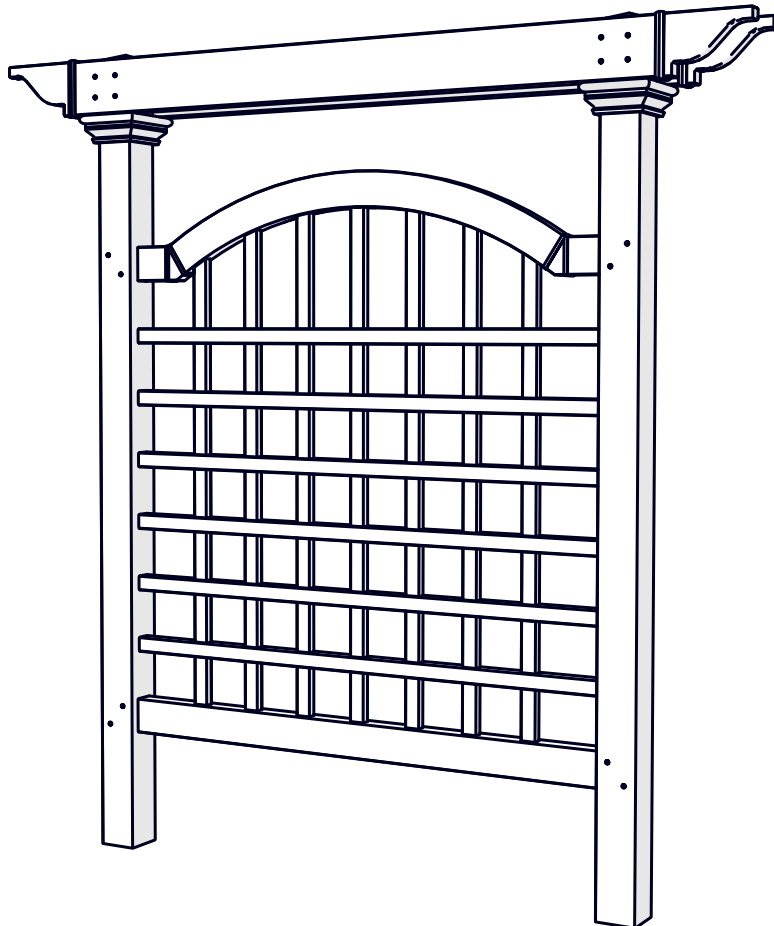

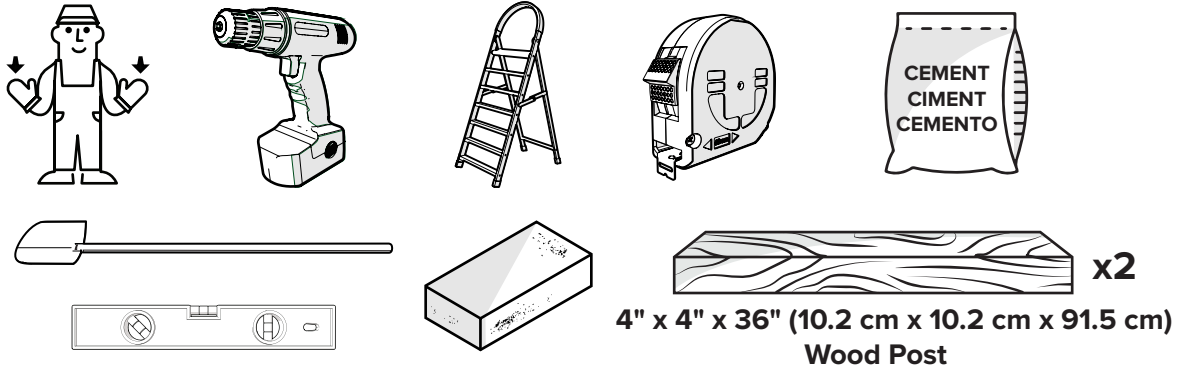
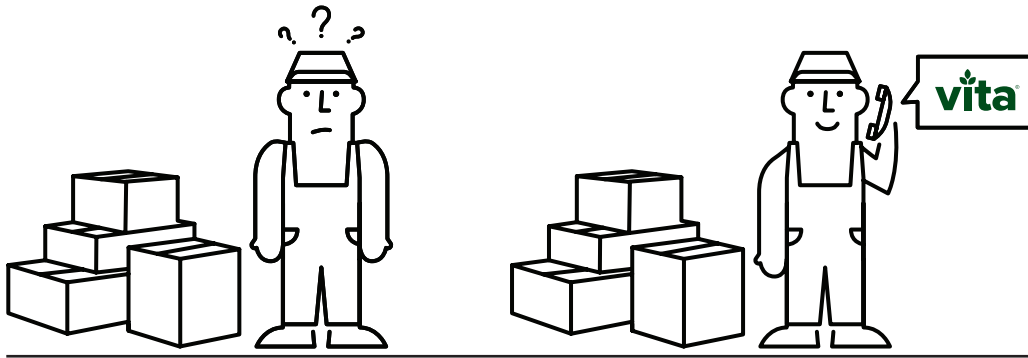

REQUIRED TOOLS AND MATERIALS (NOT INCLUDED)  
 OUTILS ET MATÉRIAUX REQUIS (NON INCLUS)  
 HERRAMIENTAS Y MATERIALES REQUERIDOS (NO INCLUIDOS)

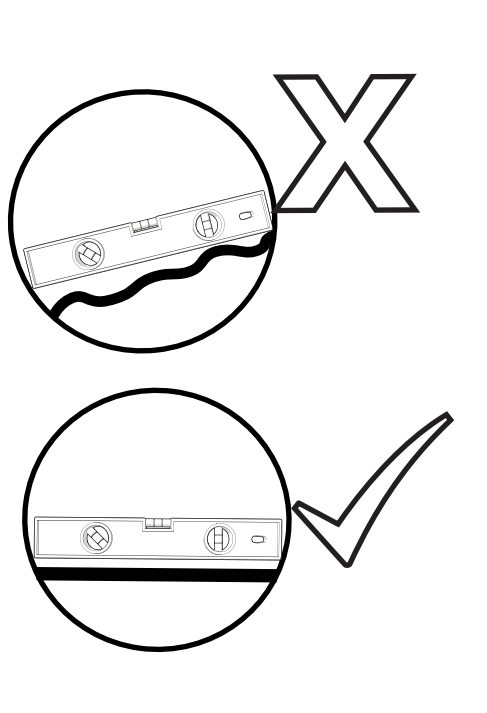

HELLO@WEAREVITA.COM



WWW.WEAREVITA.COM



8AM - 5PM EST



# PRODUCT DIMENSIONS

DIMENSIONS DU PRODUIT

DIMENSIONES DEL PRODUCTO

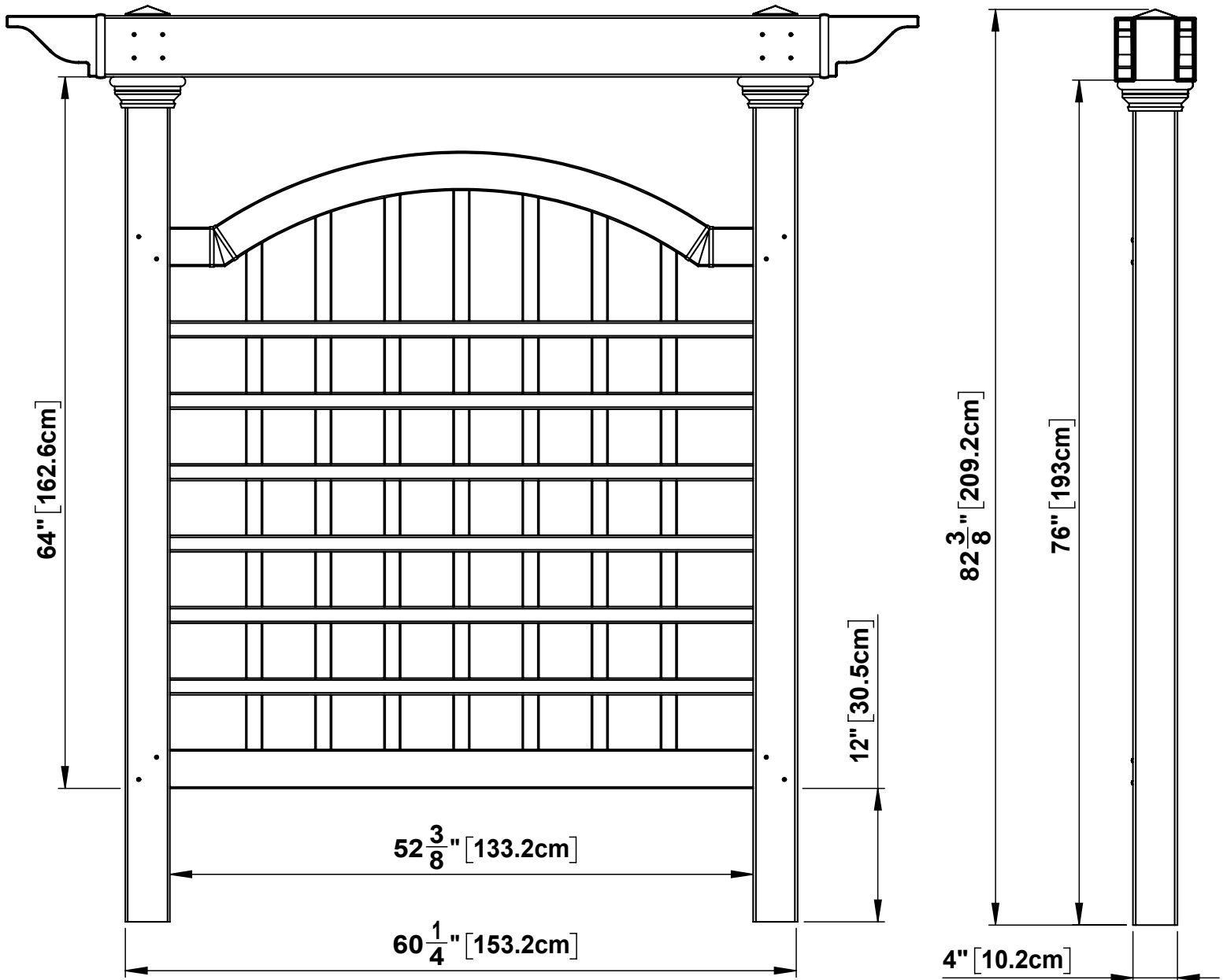
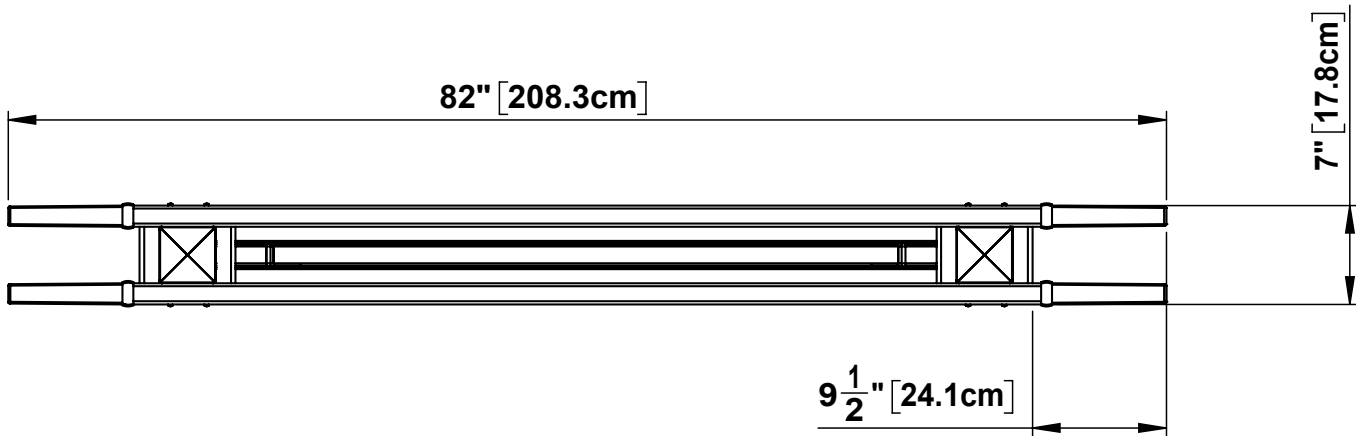

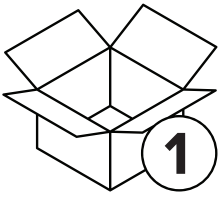

# PARTS LIST

LISTE DES PIÈCES  
LISTADO DE PIEZAS

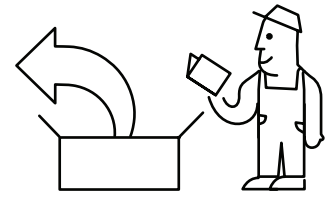

Left Post

1

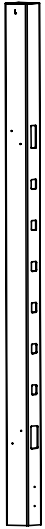

Right Post

2



Upper Beam

3

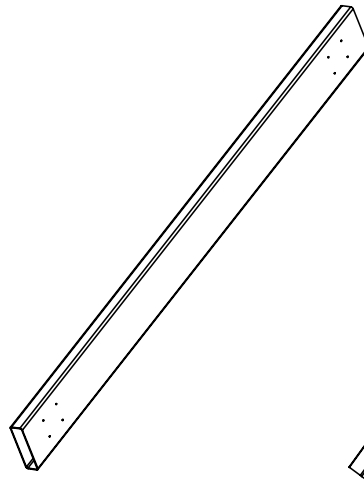

Lower Beam

4

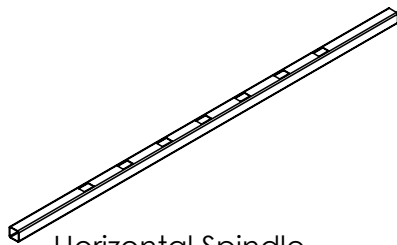
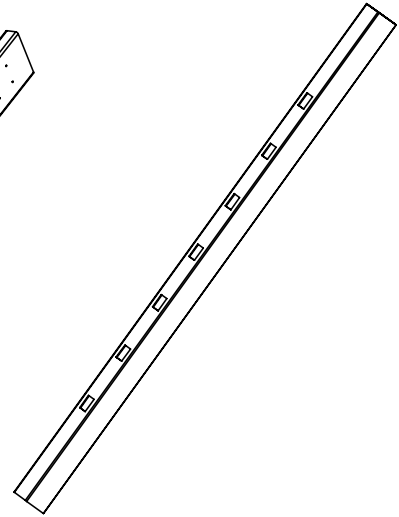

Horizontal Spindle

5

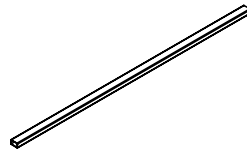

Vertical Spindle A

6

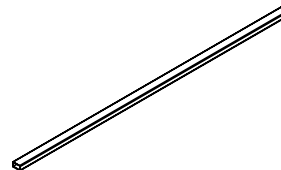

Vertical Spindle B

7

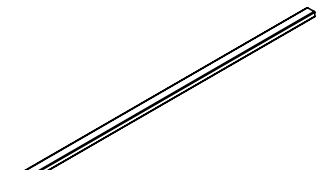

Vertical Spindle C

8

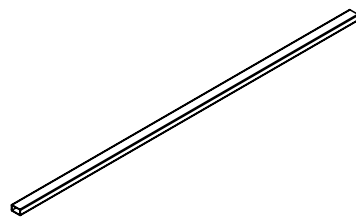

Vertical Spindle D

9



Phillips Screw

10

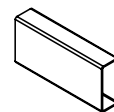

Arch Connector

11



Arch

12

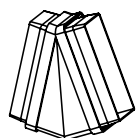

Arch Elbow

13

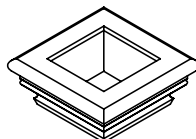

Post Trim

14

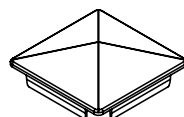

Post Cap

15

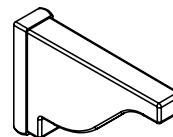

Decorative End Cap

16



Vinyl Weld Glue

17

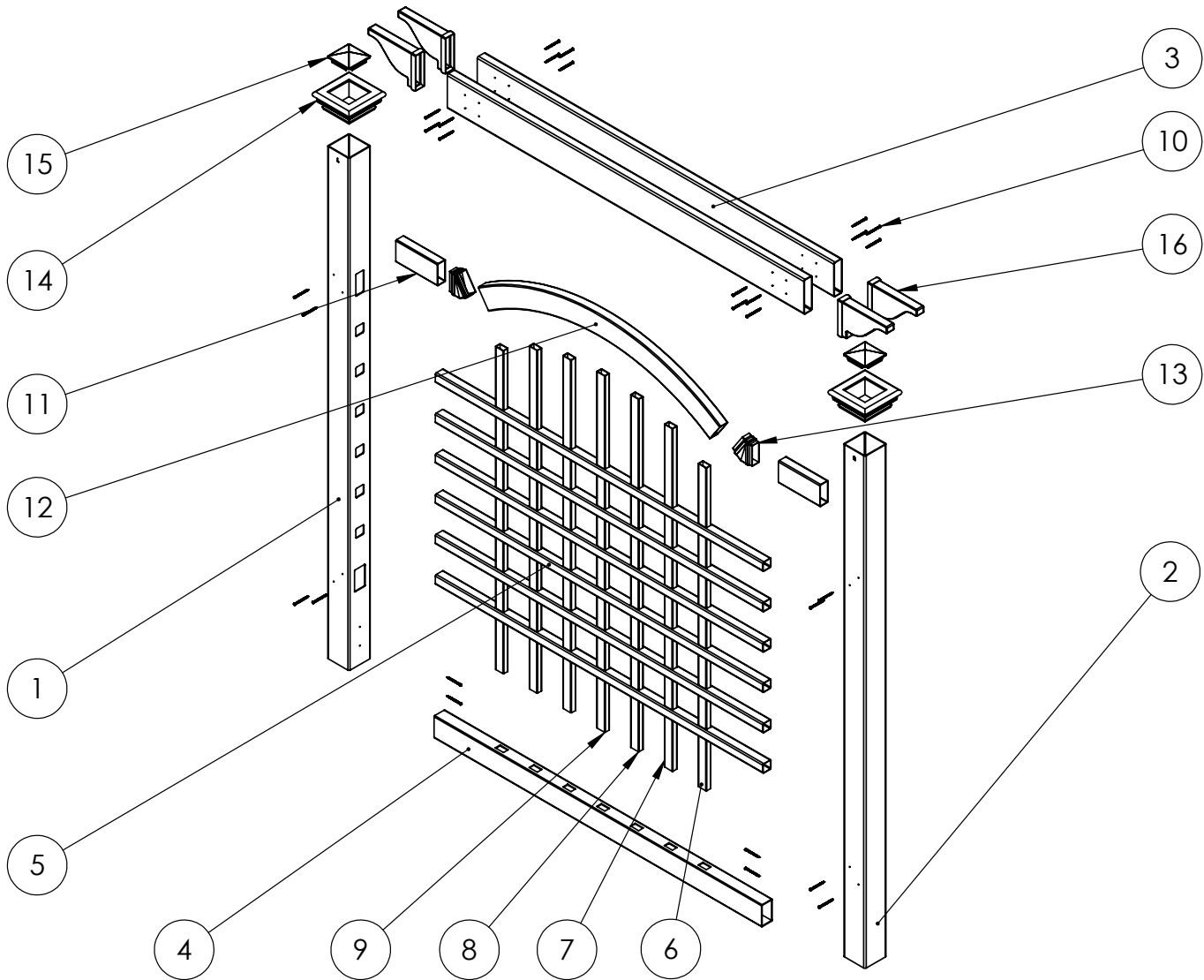





ITEM NO.	Part Number	DESCRIPTION	Dimensions	QTY.
1	10276	Left Post	81 1/2" (207 CM)	1
2	10277	Right Post	81 1/2" (207 CM)	1
3	10278	Upper Beam	65 1/2" (166.4 CM)	2
4	10281	Lower Beam	60 1/4" (153 CM)	1
5	10282	Horizontal Spindle	60 1/4" (153 CM)	6
6	10283	Vertical Spindle A	51 3/8" (130.5 CM)	2
7	10284	Vertical Spindle B	54 1/2" (138.5 CM)	2
8	10285	Vertical Spindle C	56 1/8" (142.6 CM)	2
9	10299	Vertical Spindle D	56 3/4" (144.2 CM)	1
10	20009-1	Philips Screw	2 1/2" (6.4 CM)	28
11	10328	Arch Connector	7 5/8" (19.4 CM)	2
12	10279	Arch		1
13	10327	Arch Elbow		2
14	10737	Post Trim		2
15	10824	Post Cap		2
16	30015	Decorative End Cap		4
17	20000	Vinyl Weld Glue		1

# INSTALLING LATTICE TOGETHER

ASSEMBLAGE DU TREILLAGE

MONTAJE DE LA CELOSÍA

-  ⑤ x6
-  ⑨ x1
-  ⑧ x2
-  ⑦ x2
-  ⑥ x2

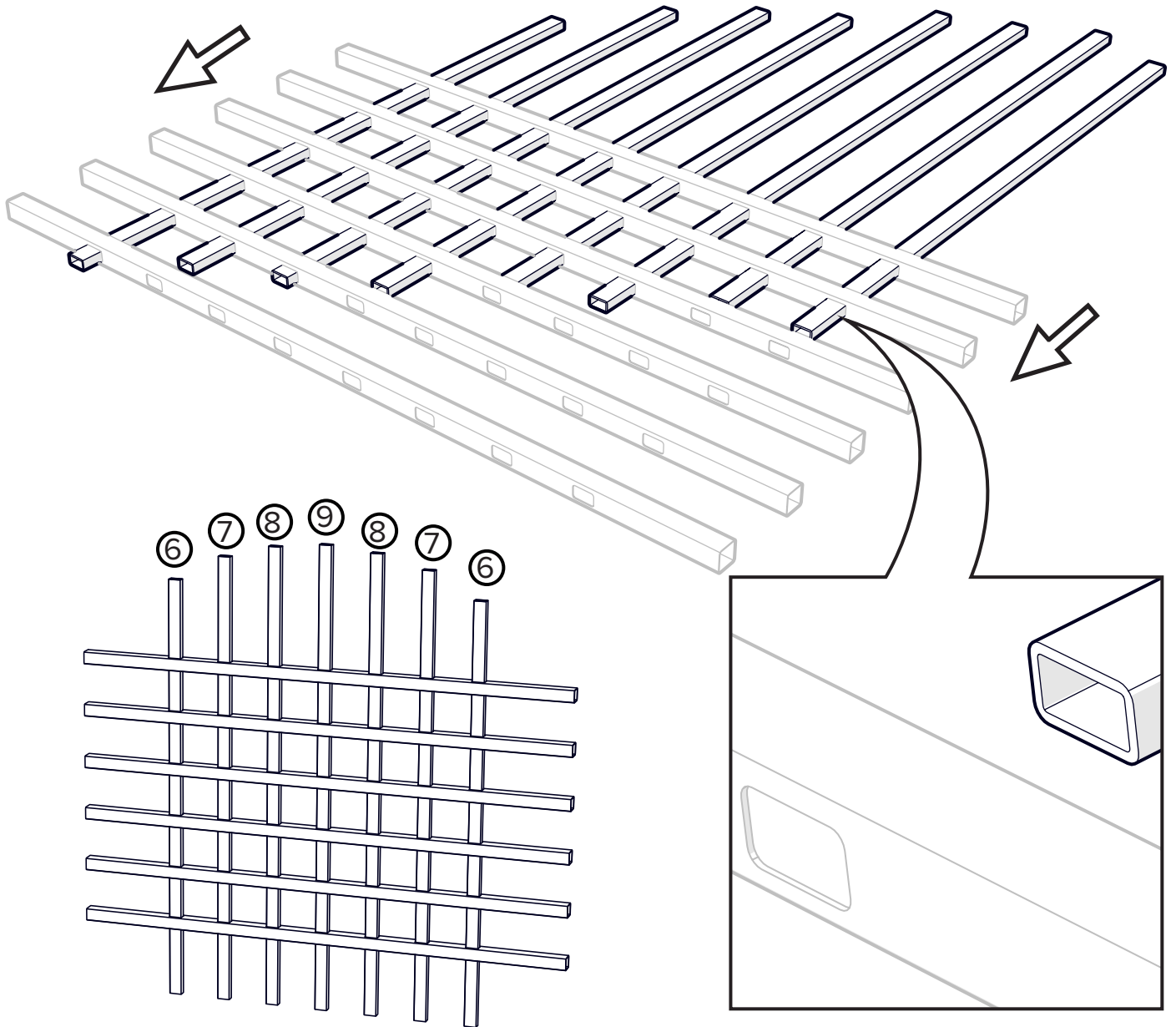
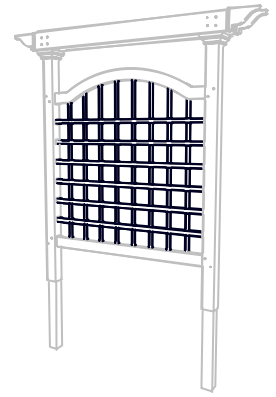

## 2 INSTALLING ARCH AND BOTTOM RAIL TO LATTICE

ASSEMBLAGE DE L'ARC ET DU RAIL INFÉRIEUR SUR LE TREILLAGE  
UNA EL ARCO Y EL RIEL INFERIOR AL ENREJADO

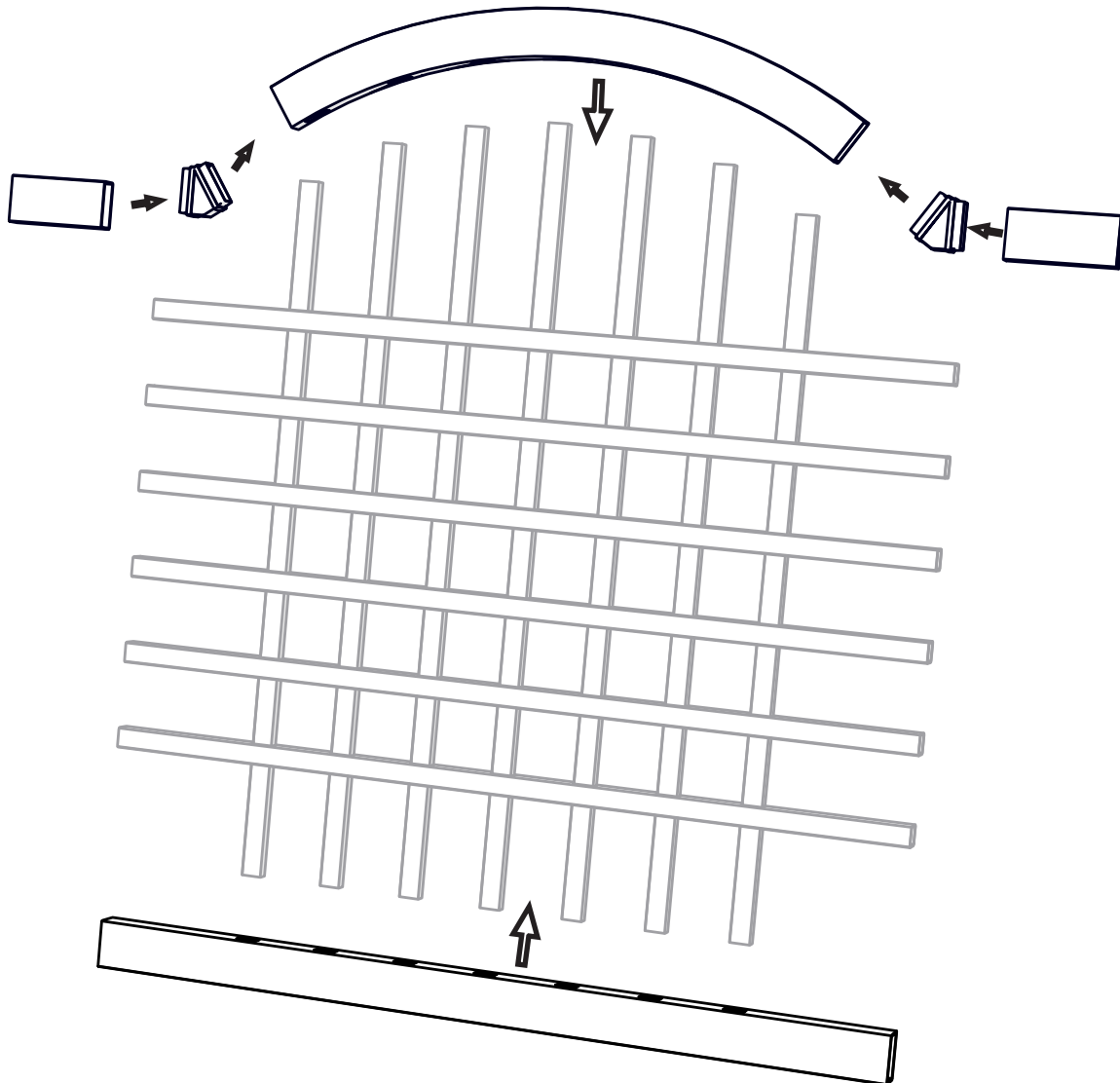
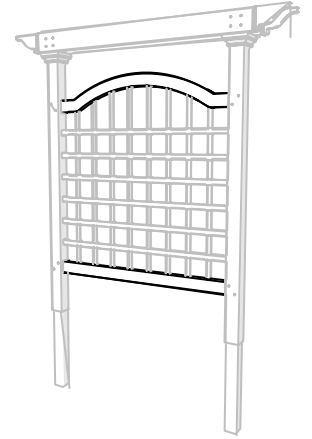
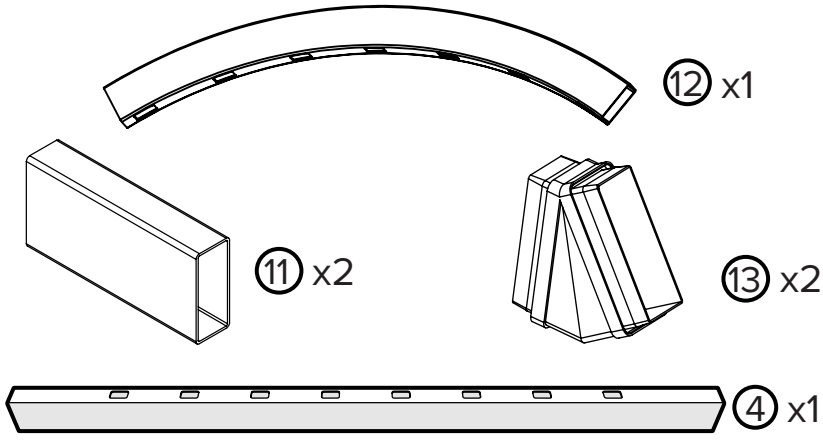

### 3 ATTACHING POSTS TO LATTICE AND RAILS

FIXATION DES POTEAUX SUR LE TREILLAGE ET LES RAILS  
ACOPLE LOS POSTES AL ENREJADO Y LOS RIELES

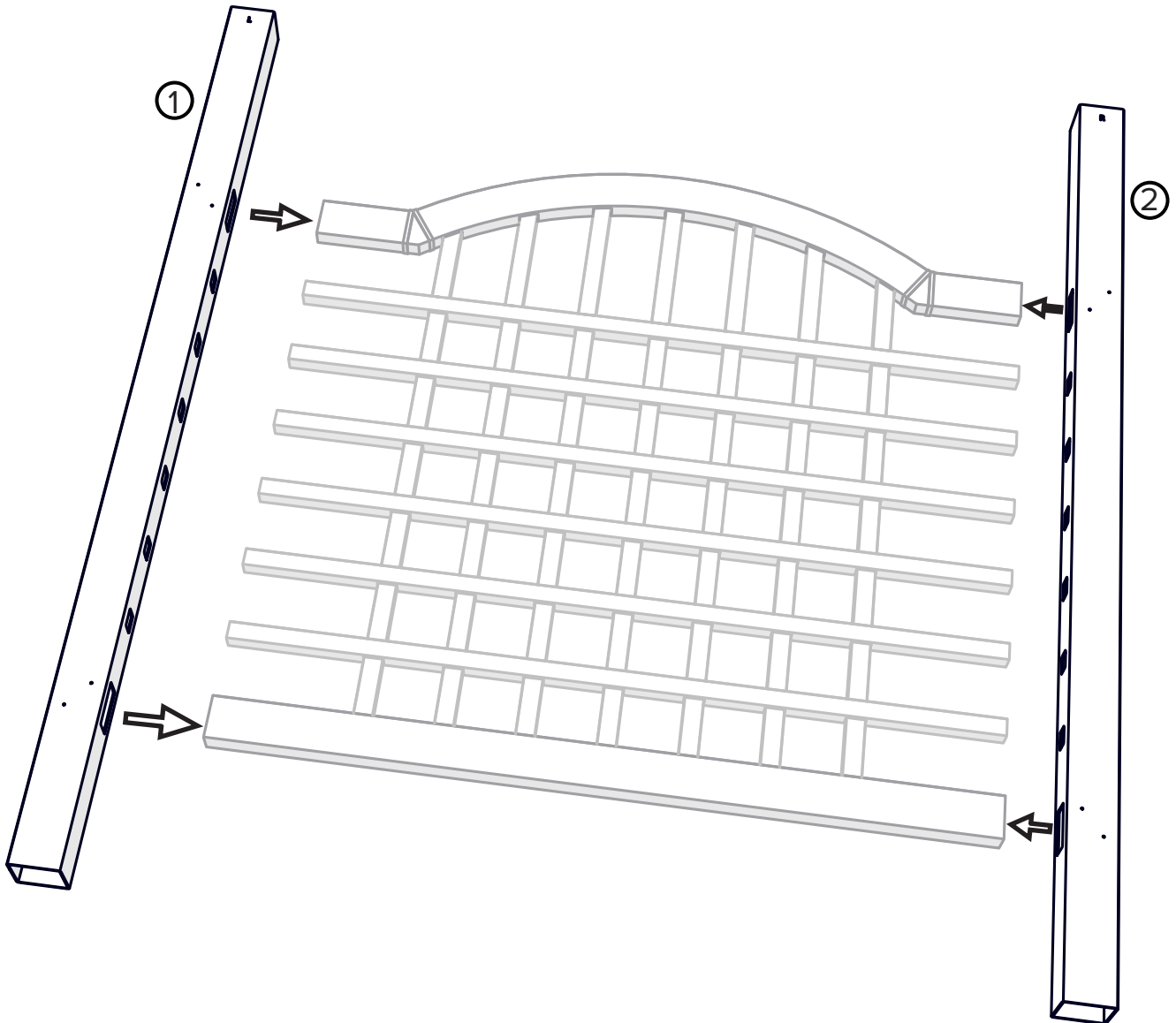
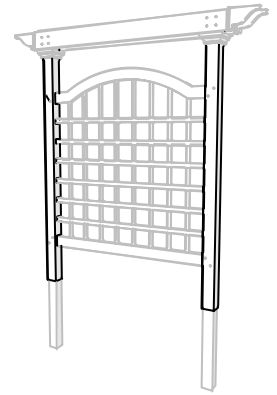



# 4 SECURING POSTS TO LATTICE AND RAILS

FAITES GLISSER LES GARNITURES DE POTEAUX VERS LE BAS, NE LES FIXEZ PAS  
ASEGURE LOS POSTES AL ENREJADO Y LOS RIELES

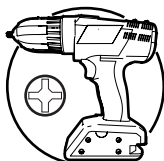
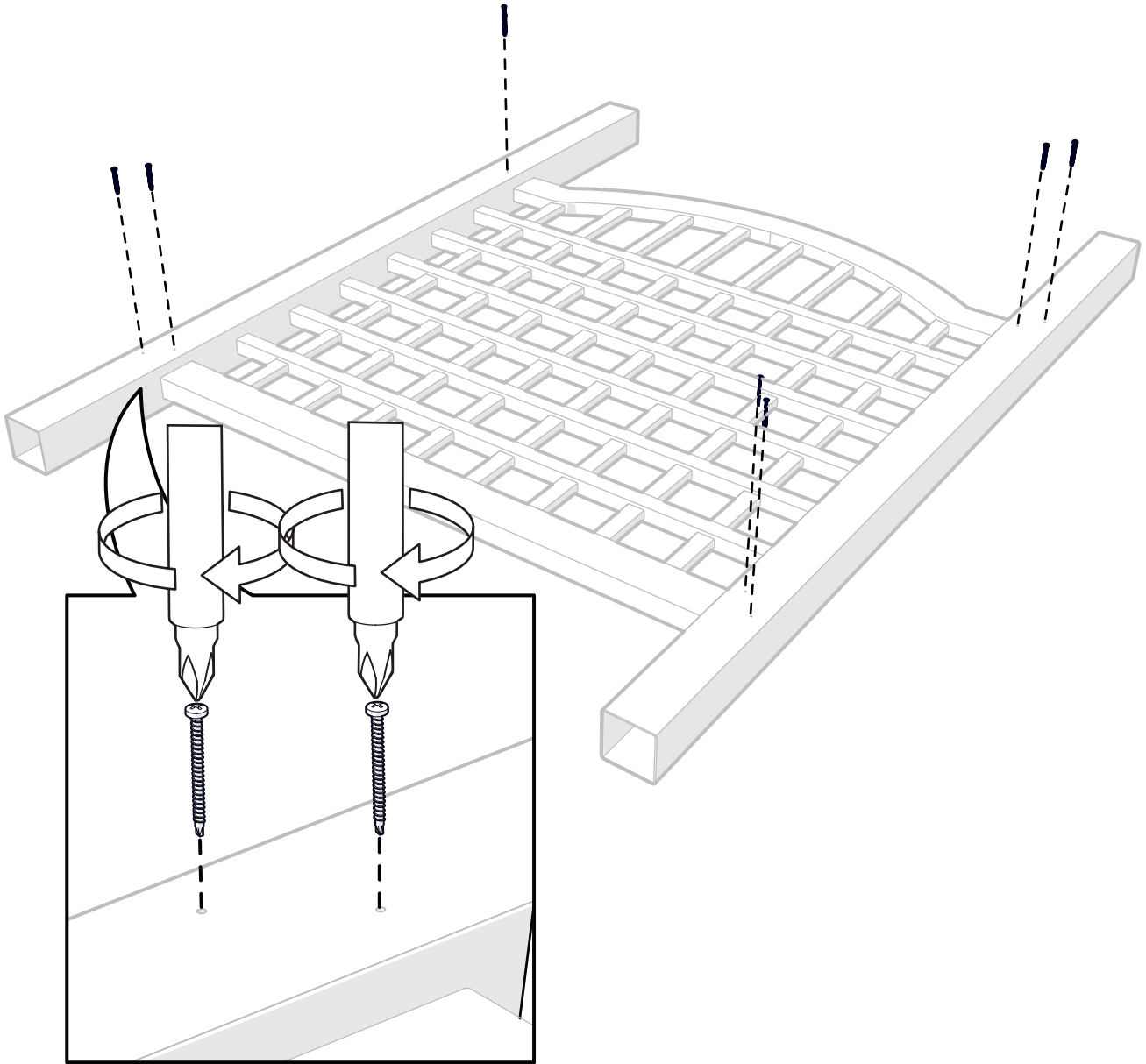
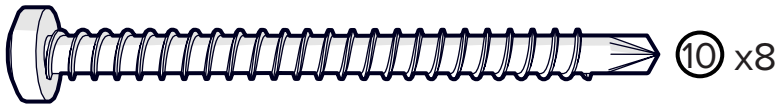
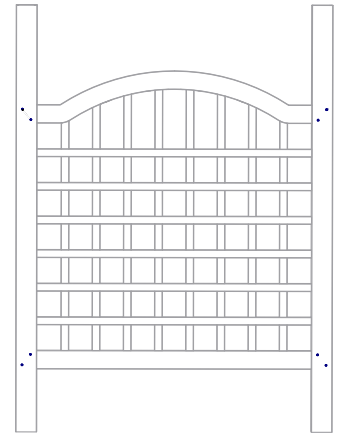

PHILIPS #2

# 5 SLIDE POST TRIMS DOWN, DO NOT SECURE THEM

COLLEZ LES EMBOUTS DÉCORATIFS SUR LES POUTRES PRINCIPALES  
DESLEICE LAS MOLDURAS DE LOS POSTES HACIA ABAJO, SIN FIJARLAS

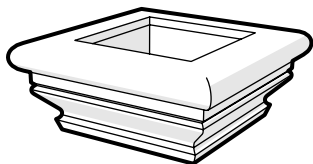

⑭ x2

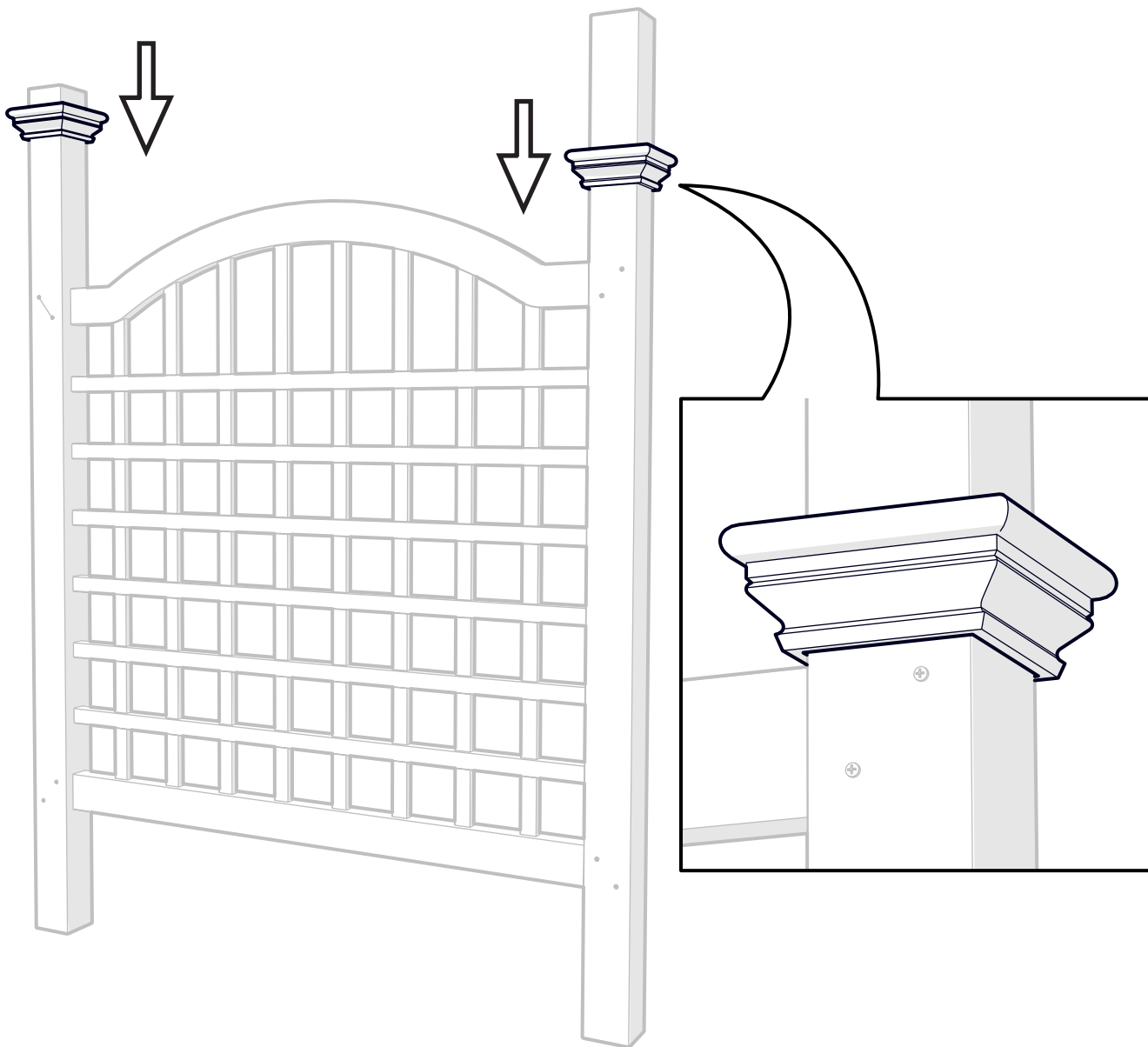
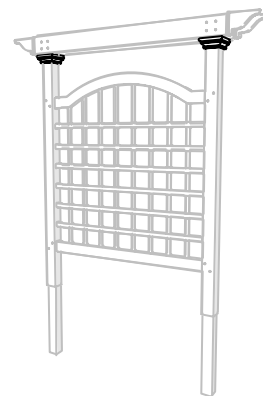

## 6 GLUE DECORATIVE END CAPS TO MAIN BEAMS

FIXEZ LES POUTRES PRINCIPALES ASSEMBLÉES SUR LES POTEAUX

PEGUE LOS TAPONES DECORATIVOS A LOS TERMINALES DE LAS VIGAS PRINCIPALES

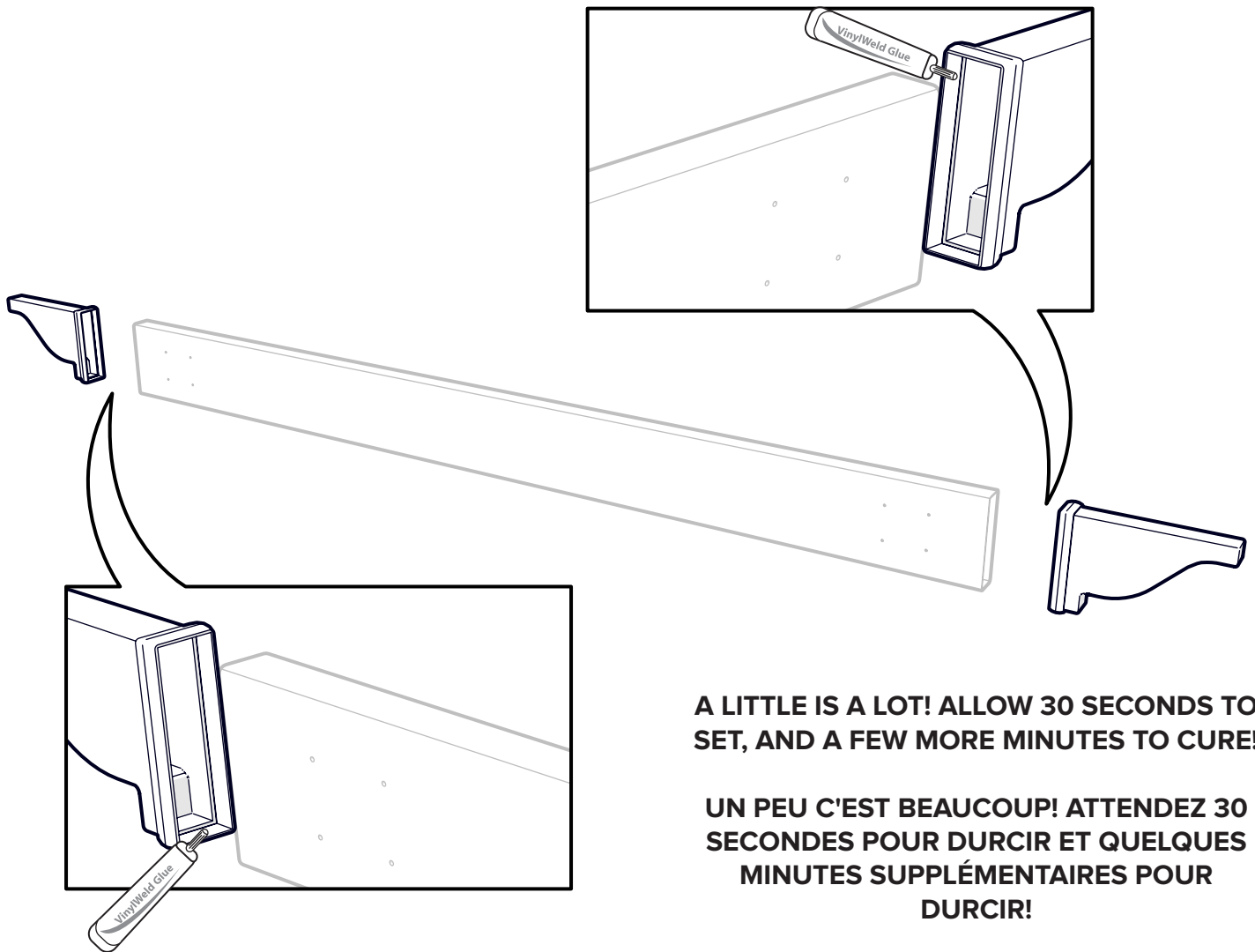
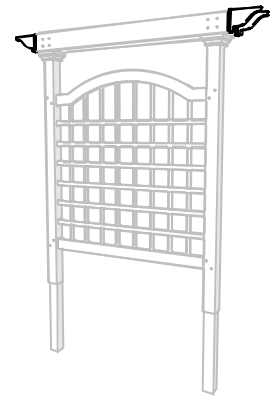
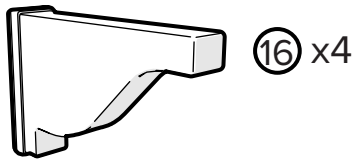

**A LITTLE IS A LOT! ALLOW 30 SECONDS TO SET, AND A FEW MORE MINUTES TO CURE!**

**UN PEU C'EST BEAUCOUP! ATTENDEZ 30 SECONDES POUR DURCIR ET QUELQUES MINUTES SUPPLÉMENTAIRES POUR DURCIR!**

**¡UN POCO ES MUCHO! ¡DEJE QUE SE SEQUE DURANTE 30 SEGUNDOS Y UNOS MINUTOS MÁS PARA QUE SE CURE!**



# 7 INSTALL MAIN BEAM ASSEMBLIES TO POSTS

LEVEZ ET FIXEZ VOS GARNITURES DE POTEAUX

UNA LAS VIGAS PRINCIPALES YA MONTADAS A LOS POSTES

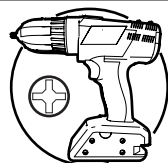
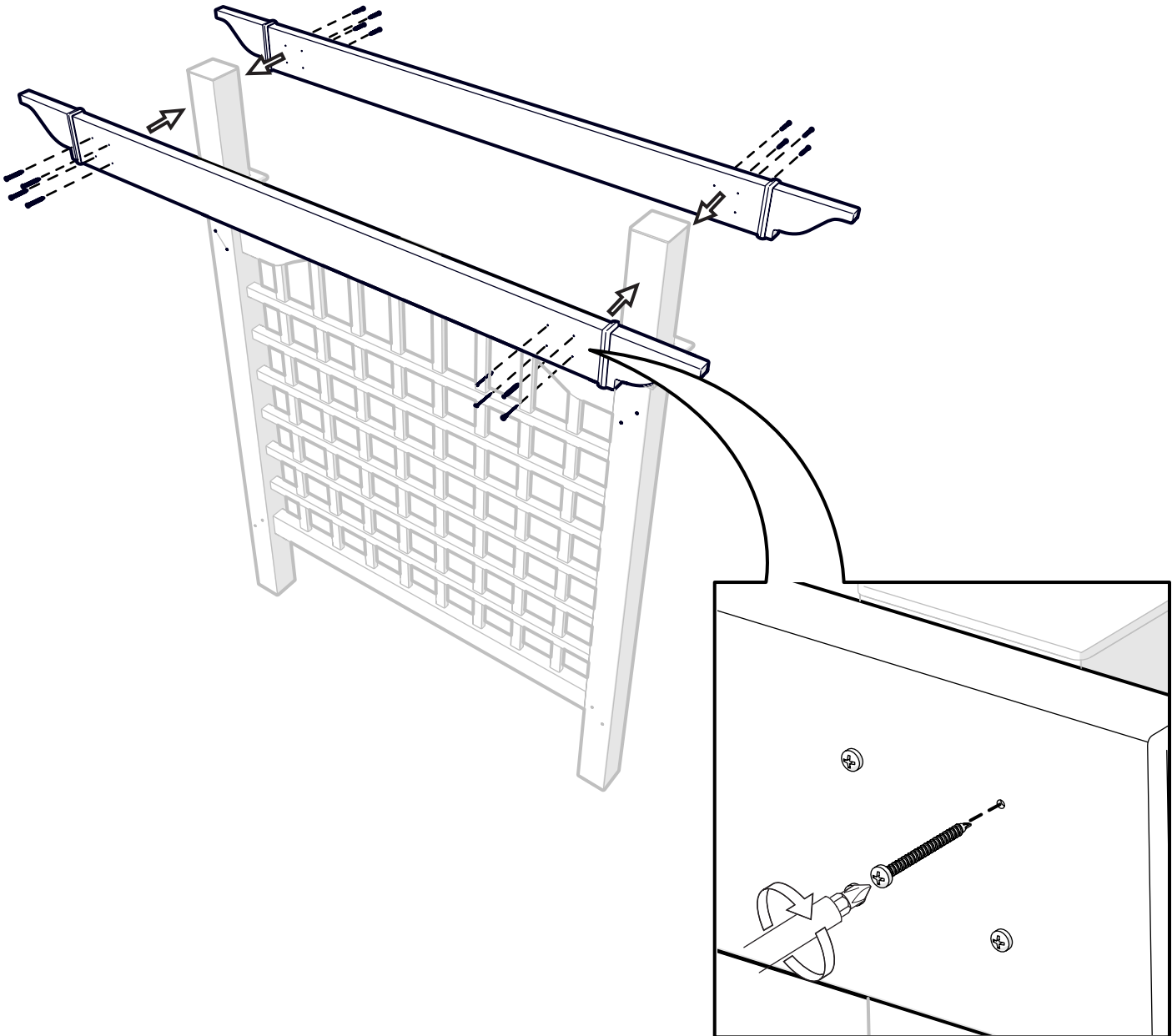
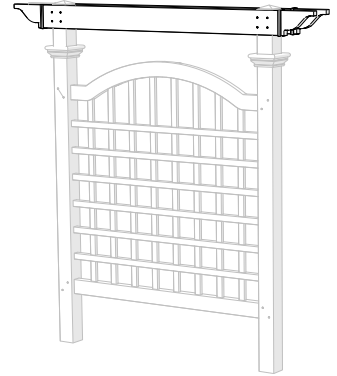
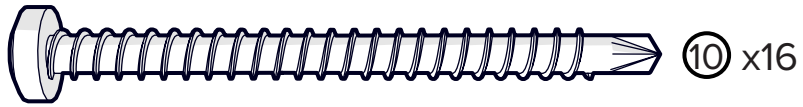

# 8 RAISE AND SECURE YOUR POST TRIMS

LEVEZ ET FIXEZ VOS GARNITURES DE POTEAUX  
LEVANTE Y FIJE LAS MOLDURAS DE LOS POSTES

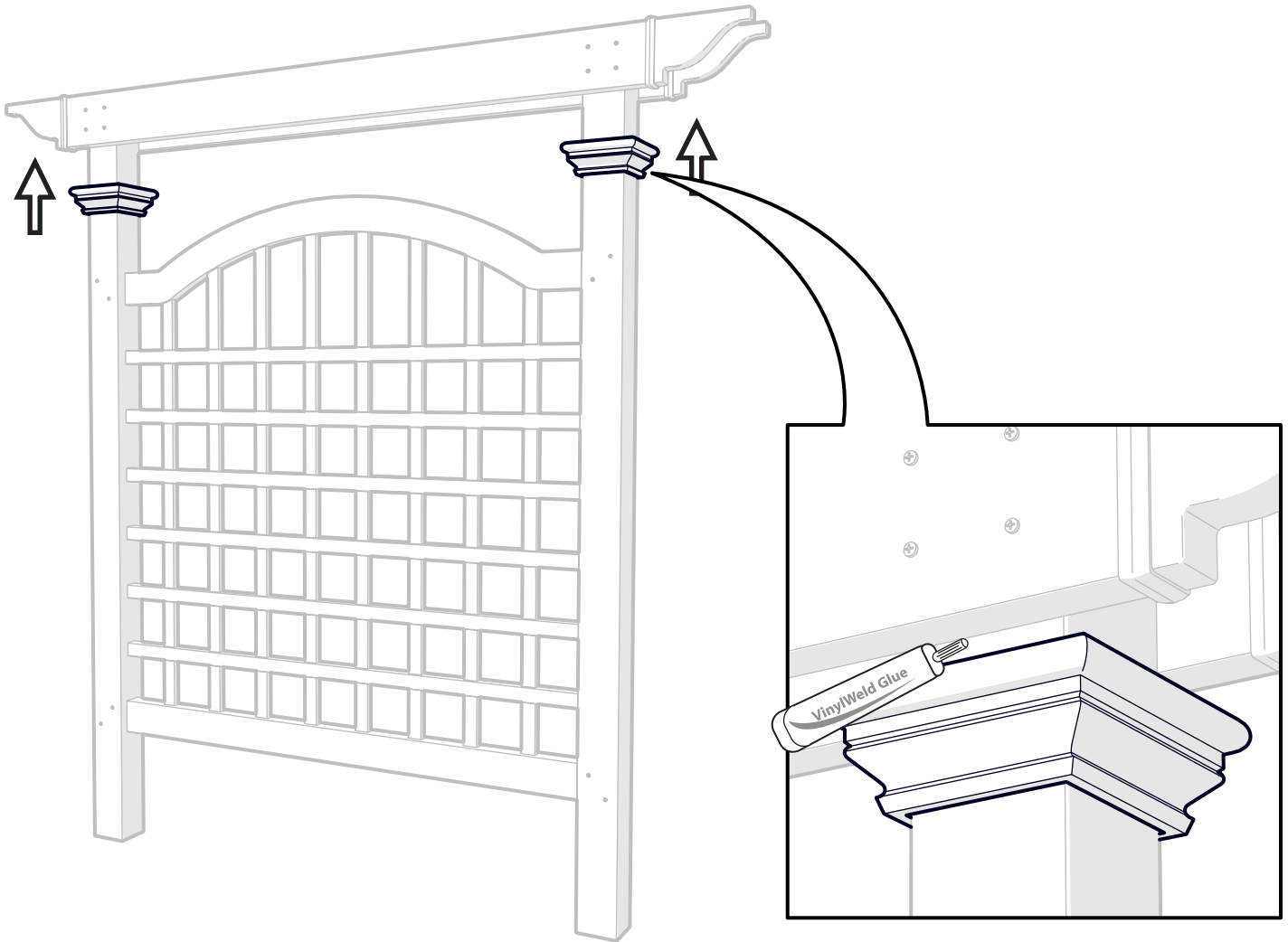
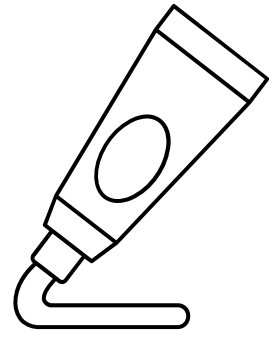

**9** INSERT AND ATTACH PRESSURE TREATED WOOD INTO POSTS.  
INSÉREZ ET ATTACHEZ SUR LES POTEAUX LE BOIS TRAITÉ PAR PRESSION  
INSERTE Y FIJE LA MADERA TRATADA A PRESIÓN EN LOS POSTES.

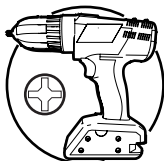
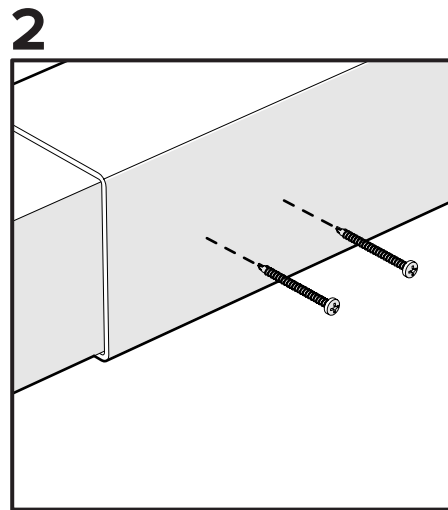
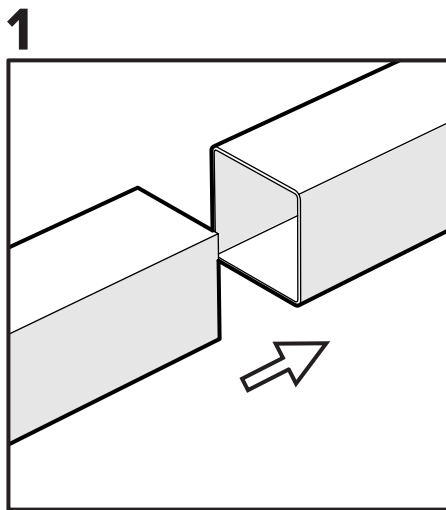
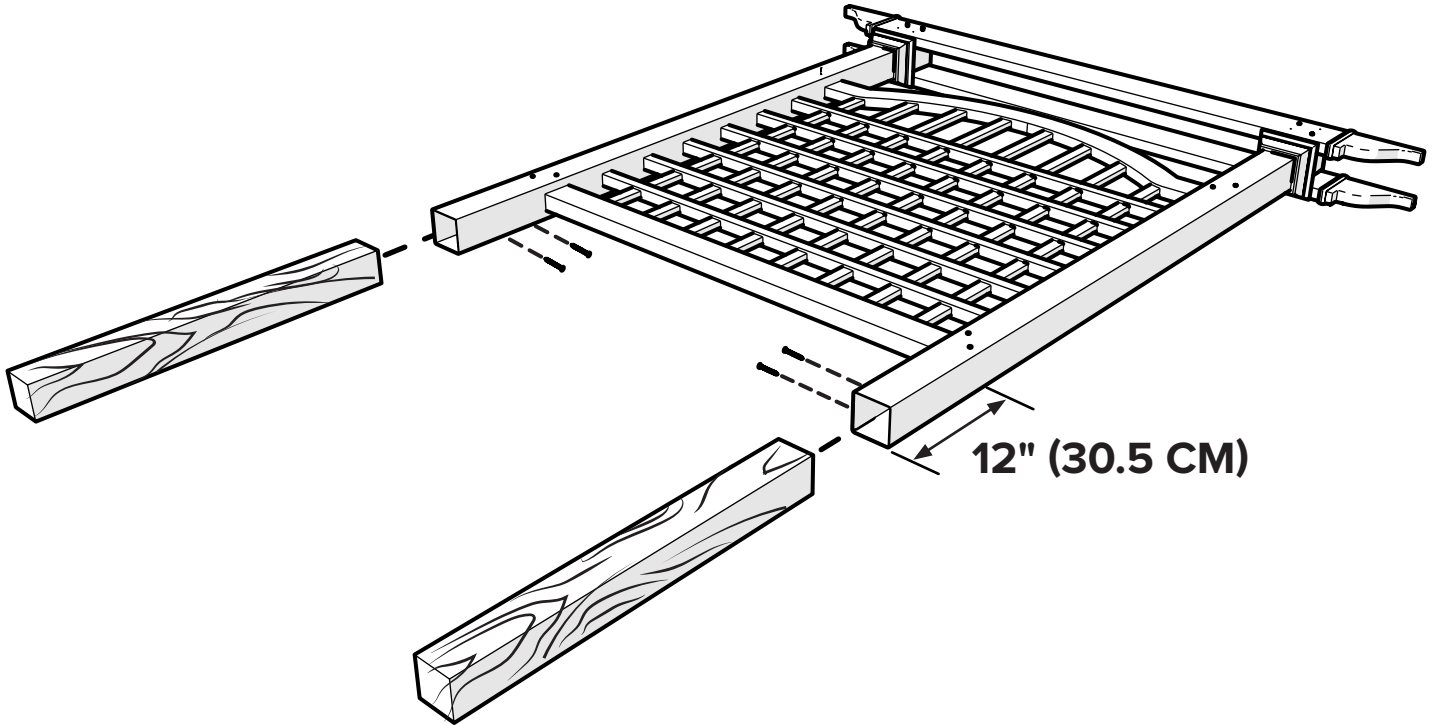
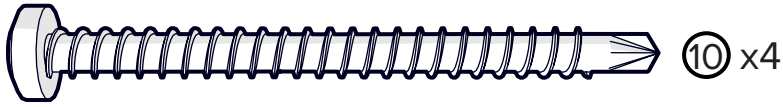
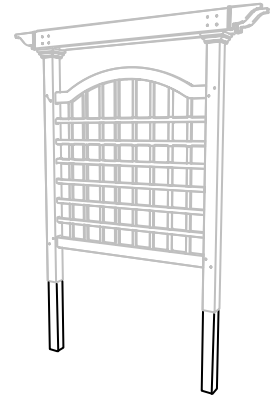

**10 ATTACH AND SECURE POST CAPS TO TOP OF POST**  
ATTACHEZ ET FIXEZ LES EMBOUTS DE POTEAUX SUR LE SOMMET DES POTEAUX  
COLOQUE Y FIJE LOS TAPONES SUPERIORES DEL POSTE

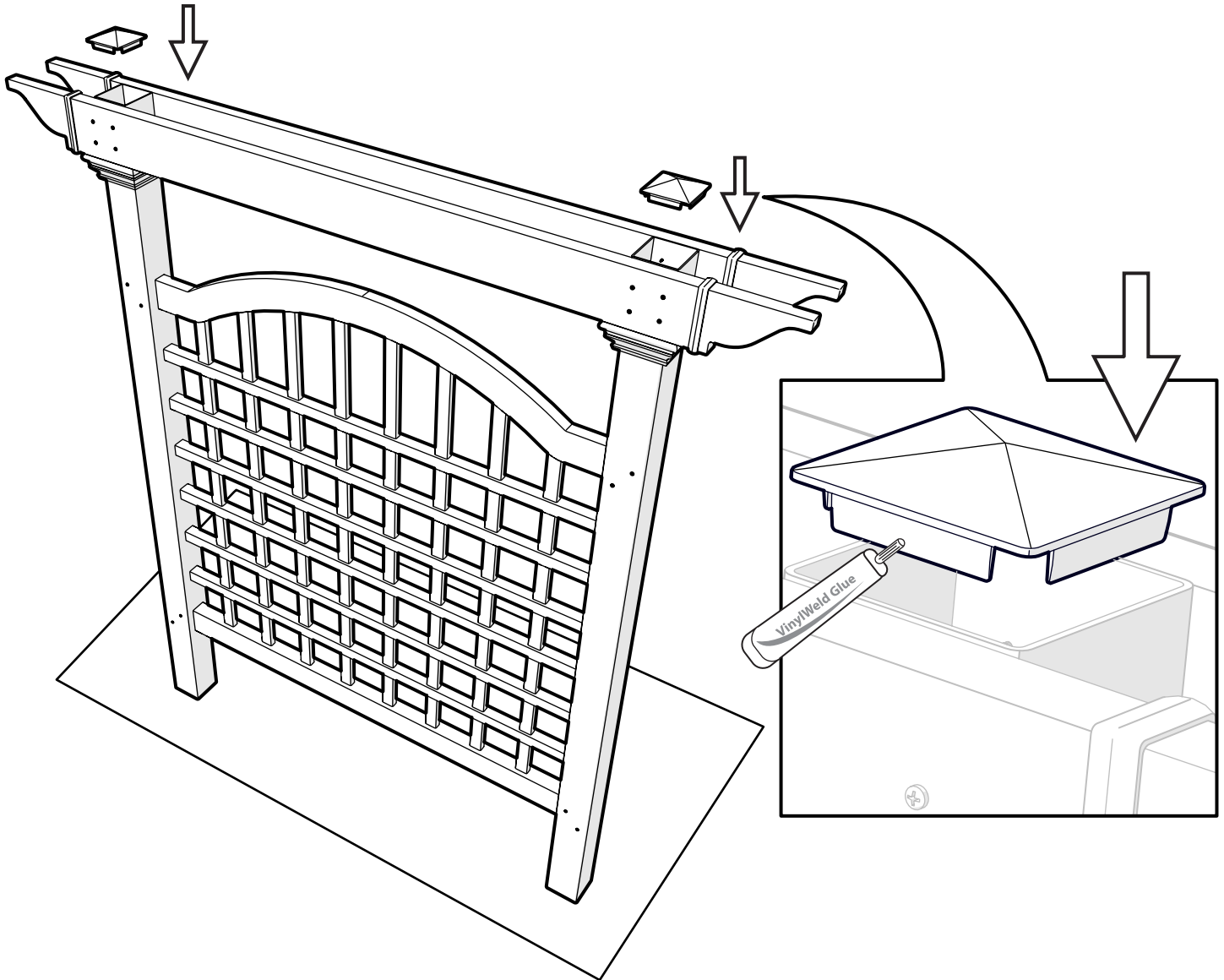
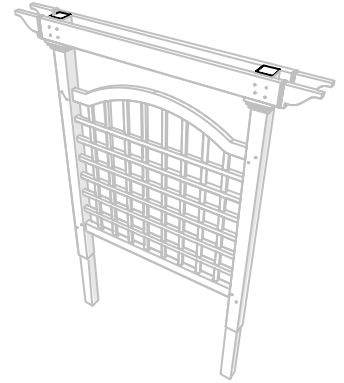
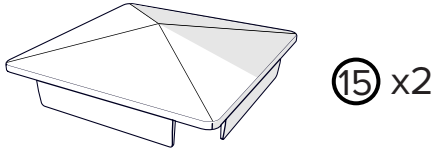

**DIG 2 HOLES 8" (20.3 CM) DIAMETER X 36" (91.4 CM) DEEP, AND 56 3/8" (143.3 CM) FROM CENTER TO CENTER. SET DIRT ASIDE. FILL EACH HOLE WITH 1 BAG OF QUICK MIX CONCRETE MIX PER HOLE. WITH A HELPER, CAREFULLY LEVEL AND PLUMB YOUR TRELLIS. USE A FEW BRICKS OR SOME WOOD TO HELP SECURE THE TRELLIS FROM SINKING. BACK-FILL WITH THE REMOVED SOIL ONCE CONCRETE HAS CURED AND PACK TIGHTLY, THEN MOVE ON TO STEP 11.**

**CREUSEZ 2 TROUS DE 20,3 CM DE DIAMÈTRE X 91,4 CM DE PROFONDEUR ET 143,3 CM DE CENTRE À CENTRE, ÉCARTEZ LA TERRE DE CREUSEMENT, REMPLISSEZ CHAQUE TROU AVEC UN SAC DE BÉTON À PRISE RAPIDE. AVEC UN NIVEAU, NIVELEZ ET FIXEZ VOTRE TREILLIS SOIGNEUSEMENT. UTILISEZ QUELQUES BRIQUES OU DU BOIS POUR SÉCURISER ET EMPÊCHER VOTRE TREILLIS DE S'ENFONCER. COMBLEZ A NOUVEAU UNE FOIS QUE LE BÉTON À PRIS AVEC LA TERRE QUE VOUS AVIEZ MISE DE CÔTÉ ET TASSEZ FERMEMENT, PUIS PASSEZ A L'ÉTAPE 8.**

**CAVE 2 ORIFICIOS DE 20,3 CM DE DIÁMETRO Y 91,4 CM DE PROFUNDIDAD, A UNA DISTANCIA DE 143,3 CM ENTRE SUS CENTROS. APARTE LA TIERRA RETIRADA. RELLENE LOS HOYOS CON UNA BOLSA DE CONCRETO DE MEZCLA RÁPIDA POR CADA UNO DE ELLOS. CON UN AYUDANTE, NIVELE CUIDADOSAMENTE Y UTILICE UNA PLOMADA PARA ALINEAR SU GLORIETA. USE ALGUNOS LADRILLOS O UN POCO DE MADERA PARA ASEGURARSE DE QUE LA GLORIETA NO SE HUNDA. UNA VEZ QUE EL CONCRETO SE HAYA SECADO, VUELVA A RELLENAR CON LA TIERRA RETIRADA ANTERIORMENTE Y COMPRIMA BIEN, LUEGO AVANCE AL PASO 8.**

