

# LUMBERJACK TOOLS®

made in usa

## 30° STAKING TOOL™ & 35° STAKING TOOL™ USER MANUAL

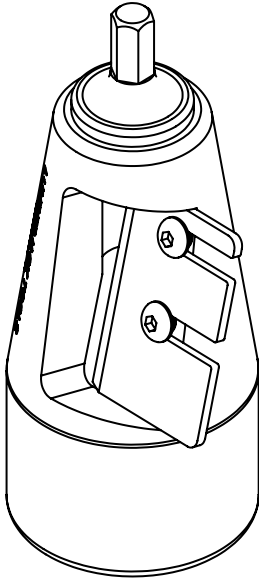

**ST2000**

30° Staking Tool

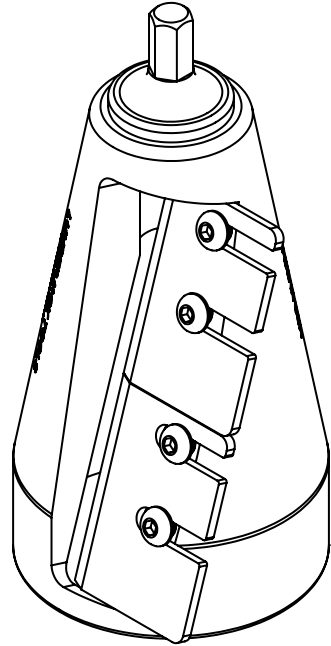

**ST3000**

35° Staking Tool

***Works Like a Giant Pencil Sharpener®***

All Rights Reserved.  
© 2023 Lumberjack Tools  
[www.lumberjacktools.com](http://www.lumberjacktools.com)  
Email: [info@lumberjacktools.com](mailto:info@lumberjacktools.com)  
Phone: 715-514-0319



MODELS:  
ST2000  
ST3000

## ABOUT YOUR PRODUCT

Thank you for purchasing one of our dual-blade staking tools! The ST2000 will cut a 30° point on up to 2.25" round material size. The ST3000 will cut a 35° point on up to 2.9" round material size. Staking tools will cut a point on the material in seconds. The tool's body is CNC machined from a solid aluminum billet to ensure precision. The blades are stamped, heat treated and ground to provide years of service if properly maintained.



Our lifetime guarantee covers the tool body and shank. The blades are covered for breakage under normal working conditions for 90 days from the date of purchase. Blades will dull faster cutting hardwoods versus softwoods (peeled or unpeeled). Soil and other abrasive substances will reduce blade life and are not covered under this warranty. When making a claim, you must show proof of purchase from an authorized distributor. The lifetime guarantee is only valid to the original buyer and not for tools sold secondhand, used, or sold "as is" to a second party.

### WHAT VOIDS WARRANTY

In order to keep our lifetime and 90 day warranty you must **AVOID** the following actions:

- Running the tool into a nail or foreign object
- Altering or misusing the tool from standard procedure

# SAFETY

Before beginning any project, carefully read and follow ALL safety and operational instructions for any tools or devices you use. Failure to do so may cause physical harm to yourself or those around you. If you feel uncomfortable using our staking tool, STOP immediately. Lumberjack Tools assumes no responsibility for injury caused to the operator, bystander, or tools used in conjunction with the use or misuse of our tools.



NEVER OPERATE POWER TOOLS UNDER THE INFLUENCE OF DRUGS, ALCOHOL, OR ANY MEDICATIONS.



ALWAYS WEAR SAFETY GLASSES, DUST MASK, AND ANY OTHER PERSONAL PROTECTION ITEMS AS NEEDED.



NEVER WEAR LOOSE ITEMS THAT COULD BE CAUGHT IN MOVING PARTS. SECURE LOOSE OR LONG HAIR AWAY FROM AREA.



WE STRONGLY RECOMMEND A SINGLE-SPEED, GEAR DRIVEN DRILL WITH RPMS OF 500 OR LESS. EXCEEDING THESE RPMS MAY RESULT IN DAMAGE TO THE TOOL.



ALWAYS DISCONNECT POWER AND ALLOW DRILL TO COME TO A COMPLETE STOP BEFORE INSTALLING, REMOVING, OR ADJUSTING THE TOOL.



NEVER APPLY BENDING FORCE (SIDE LOADING) TO THE TOOL. SIDE LOADING COULD CAUSE THE SHANK TO FAIL, OR MAY RESULT IN BLADE DAMAGE.



ALWAYS SECURE THE LOG IN A VISE OR CLAMP PRIOR TO STARTING YOUR DRILL. FAILURE TO DO SO MAY RESULT IN INJURY.



ALWAYS HANDLE THE BLADES WITH EXTREME CARE! FAILURE TO DO SO MAY RESULT IN SERIOUS INJURY.



NEVER PUT HANDS OR ANY BODY PART INSIDE THE TOOL WHILE THE BLADES ARE ATTACHED! DOING SO MAY CAUSE SERIOUS INJURY.



WHEN EXCESSIVE FORCE IS REQUIRED TO CUT, RE-SHARPEN OR REPLACE THE BLADES. A SHARP TOOL IS A SAFE TOOL!

# PART IDENTIFICATION

## ST2000

- ①A Tool Body (ST2000)
- ①B Blade (TB2500)
- ①C Blade Edge
- ①D Shank (SH1000)
- ①E Shim

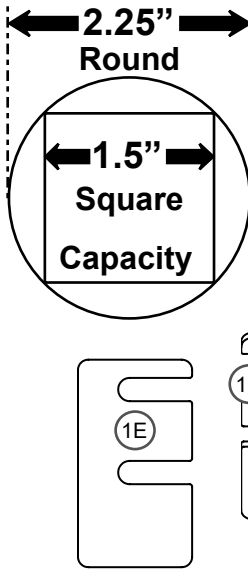

## ST3000

- ②A Tool Body (ST3000)
- ②B Blade (TB2500)
- ②C Blade Edge
- ②D Shank (SH1000)
- ②E Shim

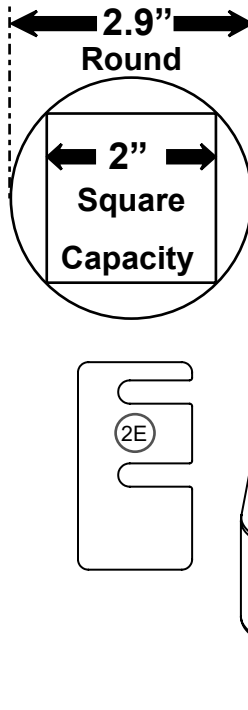

# BLADE SETTING: ST2000

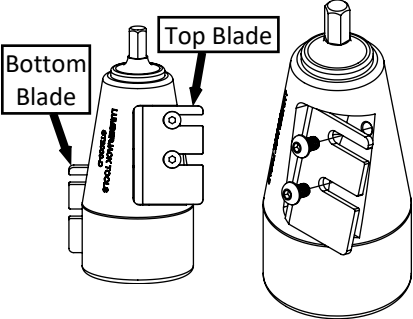

Max	Capacity
Round	2.25" Dia
Square	1.5" x 1.5"

- Install and secure the blades with the Button Head Cap Screws

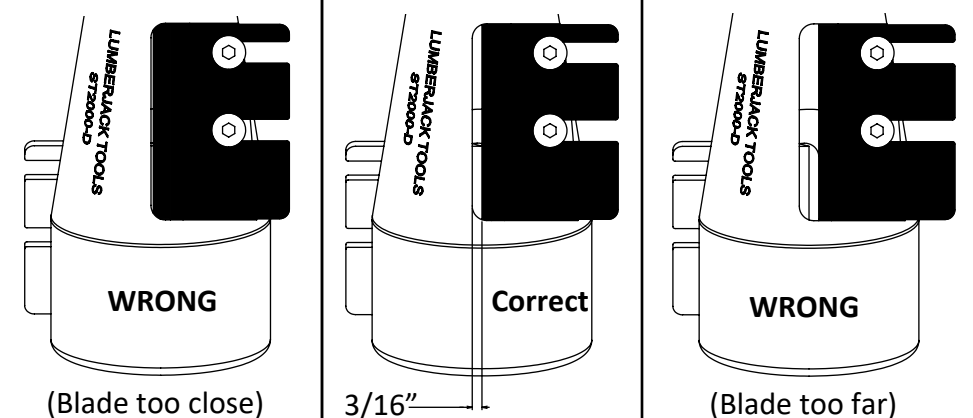

**WRONG**  
(Blade too close)

**Correct**  
3/16"

**WRONG**  
(Blade too far)

It is critical that both blades have the same "offset". Blade offset refers to the gap size between the blade edge and the side of the pocket. 3/16" is the standard gap size to use.

- The tool will not cut with 5/16" or greater spacing
- The tool will not cut with 1/16" or less spacing

 **TIP**

- The cardboard box that the tool comes in is about 3/16" thick
- Remove a piece of box to use as a quick spacer for blade gap setting

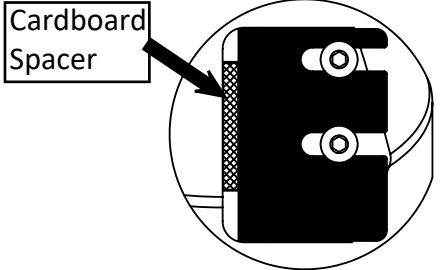

Cardboard Spacer

# BLADE SETTING: ST3000

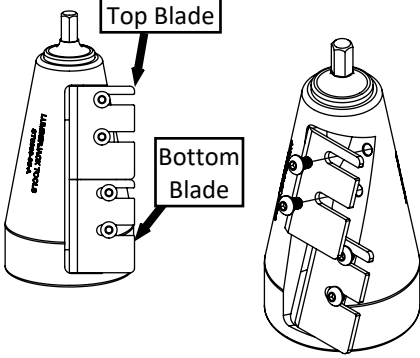

Max	Capacity
Round	2.90" DIA
Square	2.0" x 2.0"

- Install and secure the blades with the Button Head Cap Screws

It is critical that both blades have the same "offset". Blade offset refers to the gap size between the blade edge and the side of the pocket. 3/16" is the standard gap size to use.

- The tool will not cut with 5/16" or greater spacing
- The tool will not cut with 1/16" or less spacing

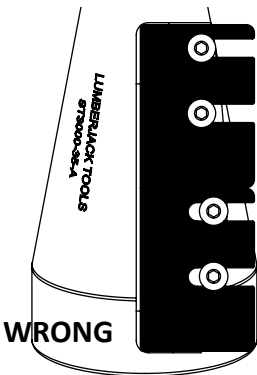
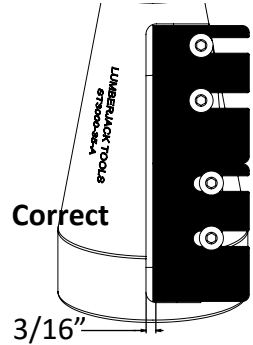

(Blades too close)

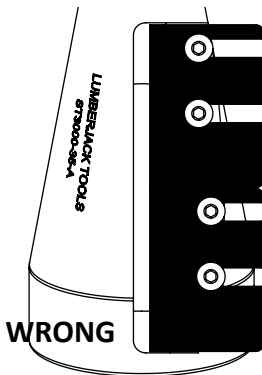

(Blades too far)

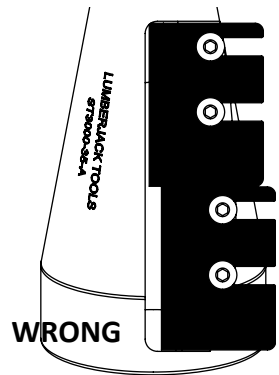

(Blades not parallel)

## TIP

- The cardboard box that the tool comes in is about 3/16" thick
- Remove a piece of box to use as a quick spacer for blade gap setting

Cardboard Spacer

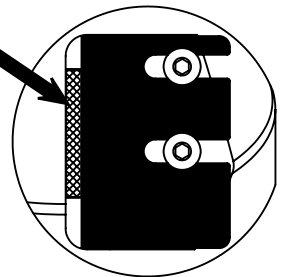

# FINE-TUNING STAKES

Fine-tuning requires minor blade adjustments and re-cutting until satisfied with the final result. Loosen screws one-quarter turn and tap the rear of the blade with a mallet or block of wood.

The following images are exaggerated examples of cut stake points:

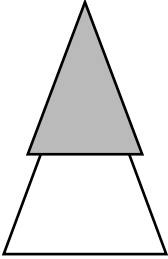

**Larger Top:** Top noticeably larger than bottom

Make the top blade gap smaller (reduce offset) by moving the blade and testing the cut. Repeat until point is even.

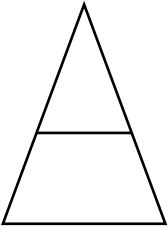

**Just Right:** Stake point is even

DO NOT MAKE ANY ADDITIONAL ADJUSTMENTS



**TIP**

Use a scribe or screwdriver to mark the blade position on the tool so you can repeat if the blades accidentally get moved.

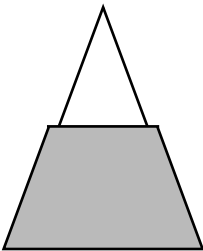

**Larger Bottom:** Bottom noticeably larger than top

Make the bottom blade gap smaller (reduce offset) by moving the blade and testing the cut. Repeat until point is even.



# WOULD YOU LIKE TO CUT SMOOTHER STAKES?

## INSTALLING SHIMS

Place a shim underneath a TB2500 blade and secure both with screws as shown

The shim should **NOT** extend into cutting area or cover the sharp edge of the blade

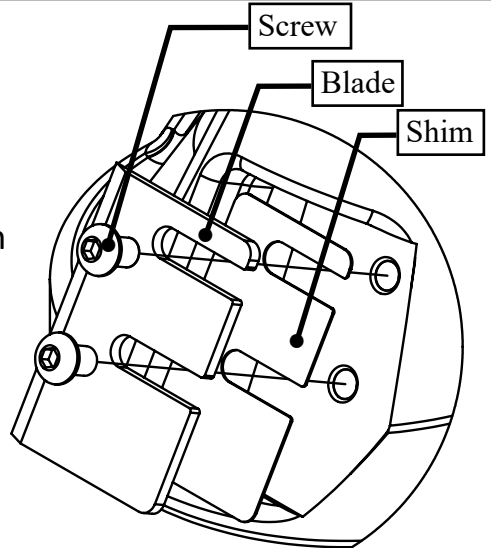

### **Pros of using shims**

- Smoother stake
- Reduced drill torque
- Less aggressive blade bite

### **Cons of using shims**

- Slightly longer time to cut



# CUTTING STAKES



**WARNING:** If the stock comes loose or unclamped while cutting the stake, **DO NOT** drop the drill or try to grab the stock! Stop cutting and remove the tool from the end of the log. Re-secure the log, and resume cutting.

1

- Obtain the stock you want to point
- Make sure the diameter fits the tool
- Cut it to length and make sure the ends are flat. If the ends are not even/flat, the point will be crooked.

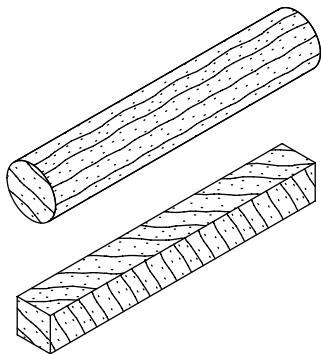

2

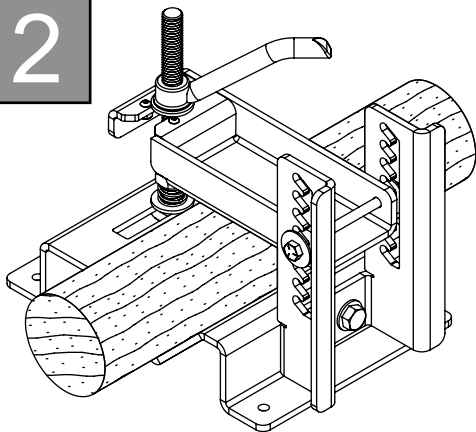

- Secure the stock in a vise, clamp, or fixture with a “V” shaped notch
- The **Lumberjack Tools Log Lock** is a safe, easy, economical way to clamp material, and is available on our website.

3

- If the diameter is larger than the tool can accept, taper the end with a hatchet or draw knife.

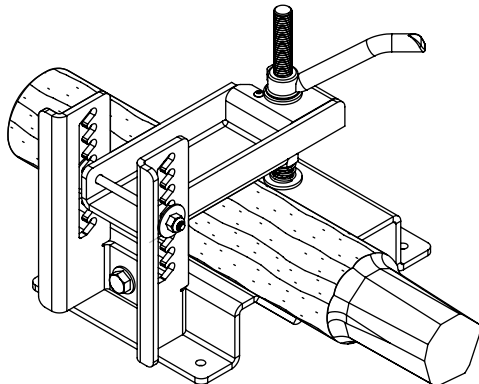

## CUTTING STAKES (CONT.)



**ALWAYS** unplug the drill before adjusting the blades or adjusting the chuck!

4

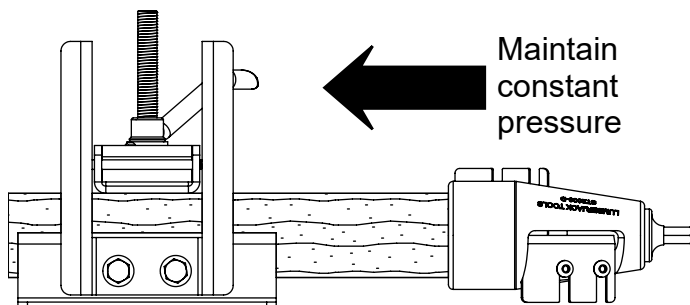

- Carefully install the staking tool into an unplugged 1/2" drill, and tighten it firmly by using the chuck key
- With the tool installed, square up to the log/stock so that the cutting face is flush with the end of the log/stock
- Apply body pressure by leaning against the back of the drill.

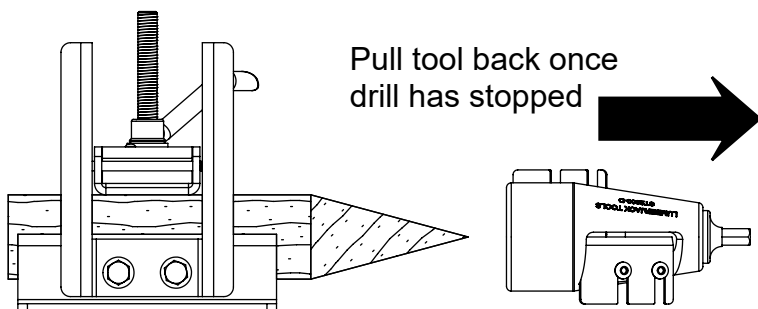

- Pull the trigger to cut a stake. Continue applying body pressure as the tool cuts.
- Wait until the drill comes to a complete stop before removing the cutter from the log/stock.

### TIP

The staking tool will continue to cut even after the log is pointed. Stop the drill immediately after the point is cut to avoid wasting material.

## CUTTING STAKES (CONT.)



- Make sure the tool is square against the end of the log before cutting
- If the tool is held at an angle the stake will be cut angled

4.5

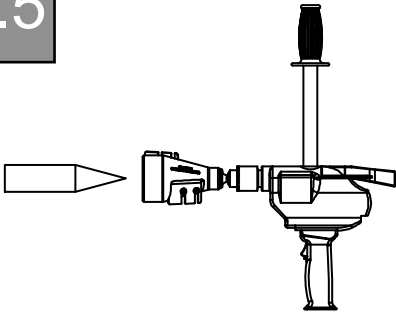

**CORRECT**

Drill in-line with stock

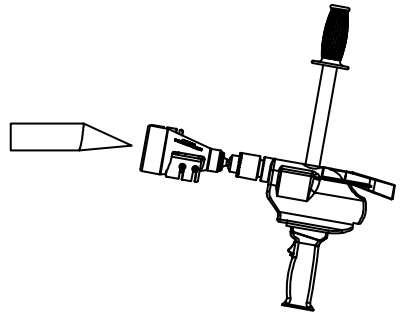

**WRONG**

Drill not in-line with stock (crooked)

Remember to always use a vise or clamp to hold your material.



**WARNING:** Never hold onto material being cut with bare hands under any circumstances!

## RECOMMENDED MOTOR SPECS

Horsepower • ½HP to 2HP	Voltage • 115	Shaft Diameter • 5/8 in
RPM • 500 to 1750	Hertz • 60	Shaft Design • Keyed

# MOTOR MOUNT ADAPTER

- If desired, the staking tool can be mounted to a motor for production stake cutting.

## TIP

- Make sure a key is included with the motor shaft
- If there is no key the adapter will not properly hold.

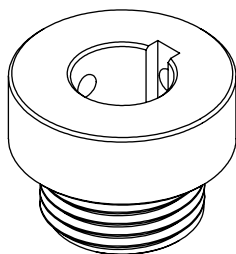
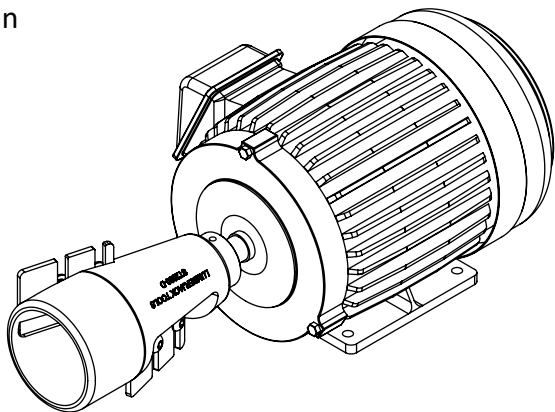

- We offer an adapter that allows the tool to fit over a motor shaft. The **Motor Shaft Adapter** is available for purchase on our website or by phone.

- Remove the shank that comes pre-installed to the tool by using a pipe wrench
- Screw the adapter into the tool where the shank was removed
- Slide the tool with the adapter over the motor shaft and secure in place by tightening the set screws (Make sure the key is in place)
- **NEVER** exceed more than 1750 RPM when operating the tool.

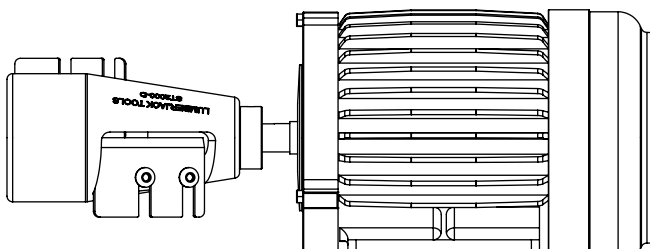
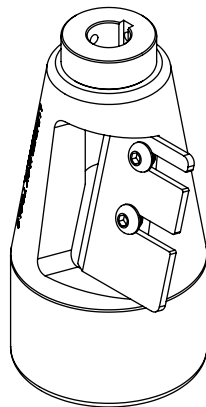

# MAINTENANCE

## ● Body

### Cleaning

- Keep the staking tool body clear of sap and other build-up
- Always remove the blades before cleaning
- Clean the tool with a solvent (such as mineral spirits).



**WARNING: ALWAYS HANDLE THE BLADES WITH EXTREME CARE! FAILURE TO DO SO MAY RESULT IN SERIOUS INJURY!**

## ● Blades

### Care

- Always wipe blades with a thin film of oil at the end of the day to help prevent oxidation.

### Cleaning

- Clean the blades with a solvent (such as mineral spirits) and **immediately** apply a thin film of oil to prevent oxidation.

### Sharpening

- Use a sharpening stone, file or the **Blade Boss** (BB2575) to re-sharpen the blades, then clean the blades and apply a thin film of oil.

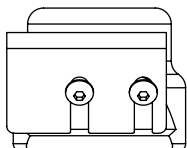

Visit our website or call for more information about our Blade Boss.

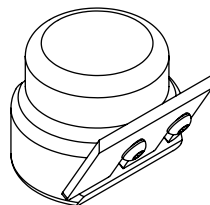

## ● Shank

### Replacement

- If your shank breaks, we offer replacement shanks (see first page for contact information)
- Turn the shank counter-clockwise to remove
- Turn the shank clockwise to install.

TASK	EACH USE
Clean blade pockets	X
Clean cutter bore	X
Clean blades	X
Inspect blades	X
Oil blades	X

# **TROUBLESHOOTING**

<b>PROBLEM</b>	<b>CAUSE</b>	<b>SOLUTION</b>
<ul style="list-style-type: none"> <li>• Tool skips off to one side or bounces around</li> </ul>	<ul style="list-style-type: none"> <li>• Stock is larger than tool will accept</li> </ul>	<ul style="list-style-type: none"> <li>• Taper down the end of the stock with a draw knife</li> </ul>
	<ul style="list-style-type: none"> <li>• Not enough pressure is being applied</li> </ul>	<ul style="list-style-type: none"> <li>• Lean into drill with body</li> </ul>
<ul style="list-style-type: none"> <li>• Not cutting stock</li> </ul>	<ul style="list-style-type: none"> <li>• Stock is larger than tool will accept</li> </ul>	<ul style="list-style-type: none"> <li>• Taper down the end of the log with a draw knife</li> </ul>
	<ul style="list-style-type: none"> <li>• Blades are slid too close</li> </ul>	<ul style="list-style-type: none"> <li>• Position blades so they are back no closer than 1/8"</li> </ul>
	<ul style="list-style-type: none"> <li>• Blades are dull</li> </ul>	<ul style="list-style-type: none"> <li>• Sharpen blades</li> <li>• Purchase new blades</li> </ul>
	<ul style="list-style-type: none"> <li>• Not applying enough pressure</li> </ul>	<ul style="list-style-type: none"> <li>• Lean into drill with body</li> </ul>
<ul style="list-style-type: none"> <li>• Takes too much of a "bite"</li> </ul>	<ul style="list-style-type: none"> <li>• Aggressive cutting from dual blades</li> </ul>	<ul style="list-style-type: none"> <li>• Use the TB2500 Blade Shims</li> </ul>
<ul style="list-style-type: none"> <li>• Crooked stake</li> </ul>	<ul style="list-style-type: none"> <li>• Holding drill/tool crooked while cutting</li> </ul>	<ul style="list-style-type: none"> <li>• Position drill/tool parallel with the stock before cutting</li> </ul>
<ul style="list-style-type: none"> <li>• Spiral grooves on stake</li> </ul>	<ul style="list-style-type: none"> <li>• Lateral wobbling of the drill</li> </ul>	<ul style="list-style-type: none"> <li>• Hold the drill as steady as you can while cutting</li> </ul>
	<ul style="list-style-type: none"> <li>• Removing the cutter while drill is still spinning</li> </ul>	<ul style="list-style-type: none"> <li>• DO NOT remove the cutter until the drill has come to a complete stop</li> </ul>

## **UNEXPECTED OCCURRENCES**

Engineers and Quality Control staff at Lumberjack Tools have provided you with one of the easiest to use and safest staking tools on the market. However, there is always the unexpected chance of failure.

- Please contact our customer support for a replacement if a failure ever occurs to the tool body, shank or blades.

**Thank you again for purchasing our tools!**



# BurnStencil®

*Burn • Emboss • Paint • Create*

Planning a garden? Keep it well labeled with BurnStencils®!

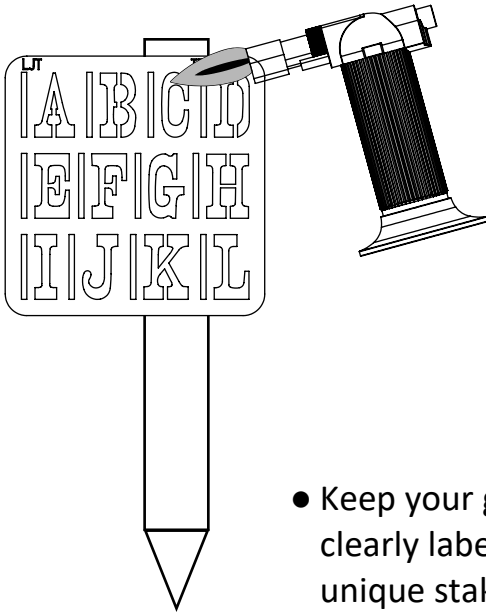

- Use a small butane torch to burn text onto stakes!

- Keep your garden clearly labeled with unique stakes that can be reused for multiple seasons!



Purchase your stencils today at  
[www.lumberjacktools.com](http://www.lumberjacktools.com)

3210 Hogarth Street, Eau Claire, WI 54703 | 715-514-0319

[www.lumberjacktools.com](http://www.lumberjacktools.com) | [info@lumberjacktools.com](mailto:info@lumberjacktools.com)

REV: 03-2023