

# LUMBERJACK TOOLS®

made in usa

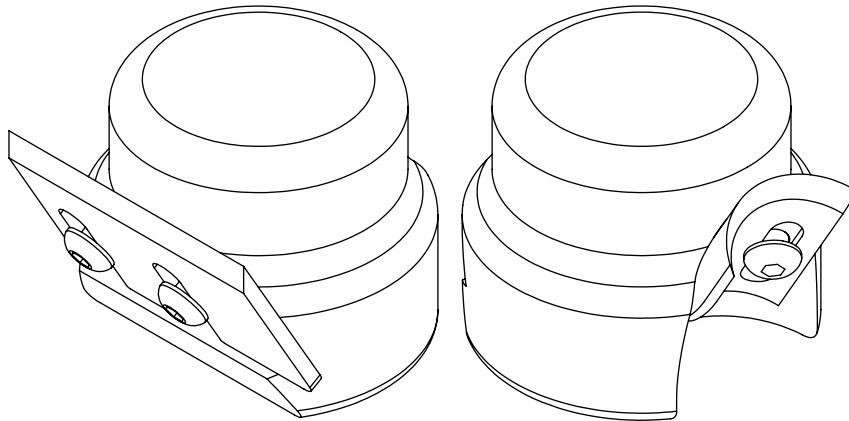

\*\* Blades not included \*\*

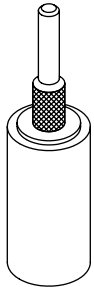

All Rights Reserved.  
© 2022 Lumberjack Group, LLC  
DBA Lumberjack Tools

## BB2575 Blade Boss Sharpening Jig

*Safe, Fast & Easy to Use™*

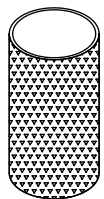
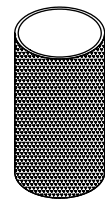

### About Your Product

Thank you for purchasing our Blade Boss!  
The Blade Boss securely holds curved (TB0750) and straight (TB2500 & TB3125) blades in position while sharpening. An ergonomic design ensures complete control of the sharpening angle and pressure. Razor-sharp blades will help your tools cut smoothly, quickly, and safely.

### Warranty

The Blade Boss is covered by our lifetime guarantee  
• Sanding drum and sleeves warranty is excluded

### What Voids Warranty

Alteration, misuse, or abuse of the jig

### Before You Get Started

Take the time to properly set the drill press speed to 4000 RPM or less

### Safety



HANDLE THE BLADES WITH EXTREME CARE. FAILURE TO DO SO MAY RESULT IN SERIOUS INJURY



WEAR GLOVES, SAFETY GLASSES, DUST MASK, AND OTHER PERSONAL PROTECTION ITEMS AS NEEDED



THE BLADE MUST BE SECURED IN THE JIG PRIOR TO RE-SHARPENING. FAILURE TO DO SO MAY RESULT IN INJURY



LUMBERJACK TOOLS ASSUMES NO RESPONSIBILITY FOR BODILY HARM CAUSED BY THE USE OR MISUSE OF THIS JIG



NEVER OPERATE THIS JIG UNDER THE INFLUENCE OF DRUGS, ALCOHOL OR ANY MEDICATIONS



KEEP ANY HAIR, JEWELRY OR LOOSE CLOTHING OUT OF WAY WHILE USING JIG



NEVER ATTEMPT TO ADJUST THE SANDING DRUM OR SLEEVE WHILE DRILL PRESS IS ON



WHEN EXCESSIVE FORCE IS REQUIRED TO SHARPEN, REPLACE SANDING SLEEVE



DRILL PRESS SPEED MUST NOT EXCEED 4000 RPM. FAILURE TO DO SO MAY RESULT IN INJURY

## Prepare The Drill Press

1. Begin by setting the speed of the drill press to 4000 RPM or less
2. Put an 80 grit sanding sleeve on the drum and turn the thumbscrew clockwise to secure
3. Install sanding drum into drill press chuck
4. Adjust the height of the table on the drill press so that the blade contacts the center of the sander (Fig 3a, Fig 3b)

## Maintenance

- Remove all blades and screws from your Blade Boss
- Clear blade pockets and screw holes of debris
- Clean Blade Boss with aluminum-safe solvent of your choice

## Standard Operation

### **TB2500 & TB3125 BLADES**

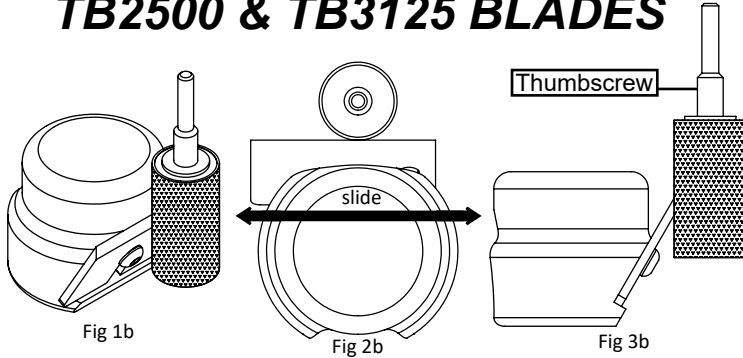

#### **TB2500 & TB3125 (straight)**

1. Secure blade to the straight pocket using the screws and wrench included with the blade
  - Make sure the blade is resting on bottom of slot
  - NOTE: the TB2500 uses the upper screw holes and the TB3125 uses the lower screw holes
2. Turn on the drill press
3. Carefully move the Blade Boss into the drum sander from right to left with a straight line motion (Fig 2b). You may want to practice this prior to sharpening

### **TB0750 BLADES**

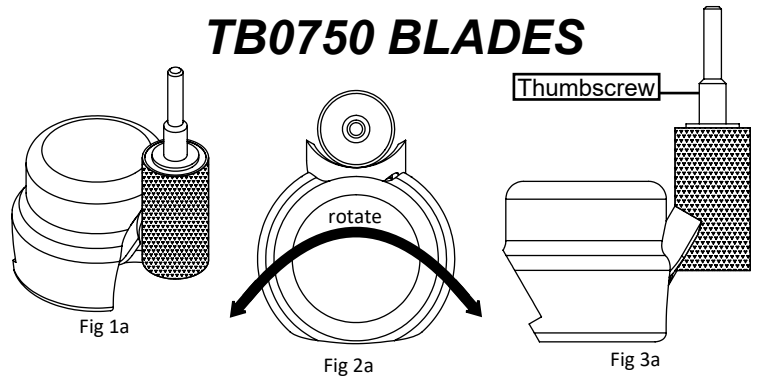

#### **TB0750 (radius)**

1. Secure blade to the radius pocket using the screw and wrench included with the blade kit
    - Make sure that the blade is raised high for clearance
  2. Turn on the drill press
  3. Carefully move the Blade Boss into the drum sander from right to left creating an arc motion (Fig 2a). You may want to practice this prior to sharpening.
- \*\*Disclaimer\*\*** : The profile of the blade will be altered from the factory grind after using this jig. However this does not affect cutting performance or durability.

4. DO NOT overheat the blade or let it turn blue. This will soften the steel and ruin your blade
5. Once the blade has been resurfaced with the 80 grit sleeve, switch to the 240 grit to hone your blade
  - If you own a slip stone, we strongly recommend dressing the front & back of the blade edge
6. When you feel you have re-sharpened your blade, carefully remove it from the jig
7. ALWAYS oil your blade after sharpening

\*\*\* We assume no responsibility for blade damage caused while using this jig \*\*\*

## Additional Tips

Blade sharpening is a skill that takes finesse to master however, with a little practice it does not take long to become proficient. The goal is to remove as little material as possible while still refreshing the surface to achieve a clean cutting edge. Always remember a sharp blade is a safe blade.

