



SHIFT GEN 3 / PILOT GEN 2
User Manual



TABLE OF CONTENTS

| | |
|--|----|
| WARRANTY..... | 3 |
| SAFETY PRECAUTIONS..... | 3 |
| SHIFT FEATURES..... | 5 |
| PILOT FEATURES..... | 7 |
| PIGTAIL GUIDE..... | 9 |
| GEN 9 PUNCHOUT TRIM LOOP..... | 10 |
| TRIM LOOP RELEASE CUFF ACTIVATION..... | 11 |
| TRIM LOOP RESET..... | 12 |
| USING THE LOCK IN TUBE..... | 13 |
| QUICK CHANGE TRIM LOOP..... | 13 |
| BELOW BAR SWIVEL | 15 |
| LEASH TO LINE ATTACHMENT..... | 16 |
| LEASH TO HARNESS ATTACHMENT..... | 17 |
| RELEASE CUFF MAINTENANCE..... | 19 |
| SINGLE FRONT LINE FLAGOUT DEPOWER..... | 20 |
| USING THE I3 SIDEWINDER (SHIFT)..... | 21 |
| TUNING THE LINES (SHIFT)..... | 23 |
| USING THE I3 G-STOP (SHIFT) | 25 |
| THE I3 FORCE TENSIONER SYSTEM (SHIFT)..... | 26 |
| BAR TRIM ADJUSTMENT (PILOT)..... | 27 |
| STORING AND CARING..... | 28 |
| ISO COMPLIANCE..... | 30 |

WARRANTY

All kite control bars are covered by a one year warranty offered to the original purchaser on workmanship and materials. Warranty is limited to the repair or replacement at Ocean Rodeo's sole discretion. This warranty does not cover damage caused by normal wear and tear, misuse or negligence and does not extend to any other equipment possibly damaged in the event of a product failure.

This warranty is invalid and void if unauthorized repairs or modifications have been made to the equipment. Bars used for professional or commercial use (rentals, instruction, etc) are covered under a 30 day warranty only. Repairs or alterations not covered by warranty will be billed to the customer.

SAFETY PRECAUTIONS

- Get instructions specific to your kite and its safety systems.
- Be first aid certified and carry first aid and rescue devices.
- Consult your doctor prior to taking kite lessons.
- Always wear a nationally approved personal flotation device when on the water.
- Dress appropriately for the weather and water temperatures.
- Check your equipment's condition before every session; look for signs of use and potential failure.
- Never kite alone.
- Do not kite in overpowered or gusty conditions.
- Do not kite in offshore wind conditions.

- Before launching your kite at an unfamiliar location, scout for safety hazards and consult other kites in the area for possible concerns (rocks, reefs, currents, changeable weather, local ‘best practices’, etc).
- Never launch with obstacles or people closer than two full line lengths downwind.
- Never kite near power lines!
- Never ask a non-kiter to launch or land your kite!
- Always wear a kite leash! Never wear a board leash!
- Always weigh your kites with rocks or sand when on the beach to prevent inadvertent launch.
- Always announce your launch so people around you can be prepared to move or assist in the event of a problem.
- Do not exceed your ability. Be honest with yourself.
- Never use alcohol or other mind altering drugs prior to kiteboarding.
- Never modify or otherwise alter any safety or release system.
- Never kite if your release system is not fully functional.

Caution: Kite powered sports can be very dangerous and physically demanding. The user of this product should understand that participating in kite powered sports may involve serious injury or death and agree to observe the following safety precautions:

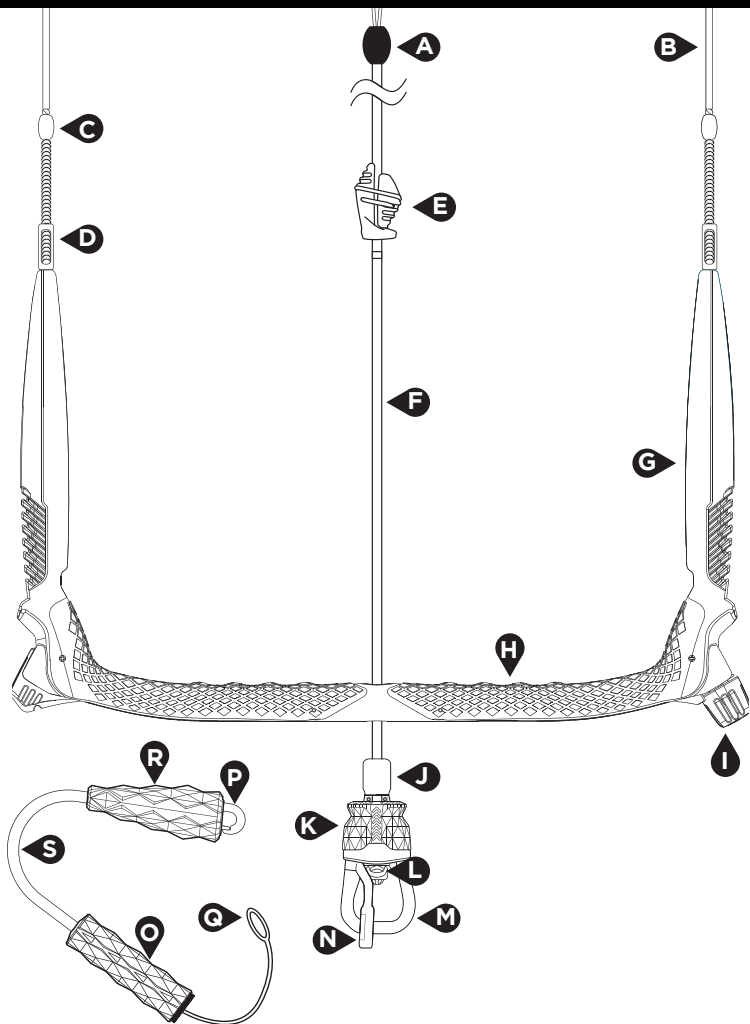

SHIFT FEATURES

| | | | |
|----------------|--|----------------|--|
| A | I3 LINE SPLITTER | O | PUSH AWAY KITE LEASH RELEASE CUFF |
| B | BACK FLYING LINES | P | STAINLESS CLIP WITH RETRACTABLE COVER |
| C | FORCE TENSIONER SPRING CAP | Q | LEASH TO HARNESS CONNECTOR |
| D | I3 FORCE TENSIONER SYSTEM | R | LEASH FLOAT |
| E | I3 G-STOP - BAR STOPPER | S | LEASH LINE |
| F | LOCKING TUBE | | |
| G | BAR FLOATS | | |
| H | GROOVE BAR | | |
| I | I3 SIDEWINDER: BACK LINE TRIM TUNER | | |
| J | BELOW BAR SWIVEL | | |
| K | PUSH AWAY RELEASE CUFF | | |
| L | LEASH ATTACHMENT RING | | |
| M | TRIM LOOP | | |
| N | LOCK IN TUBE | | |

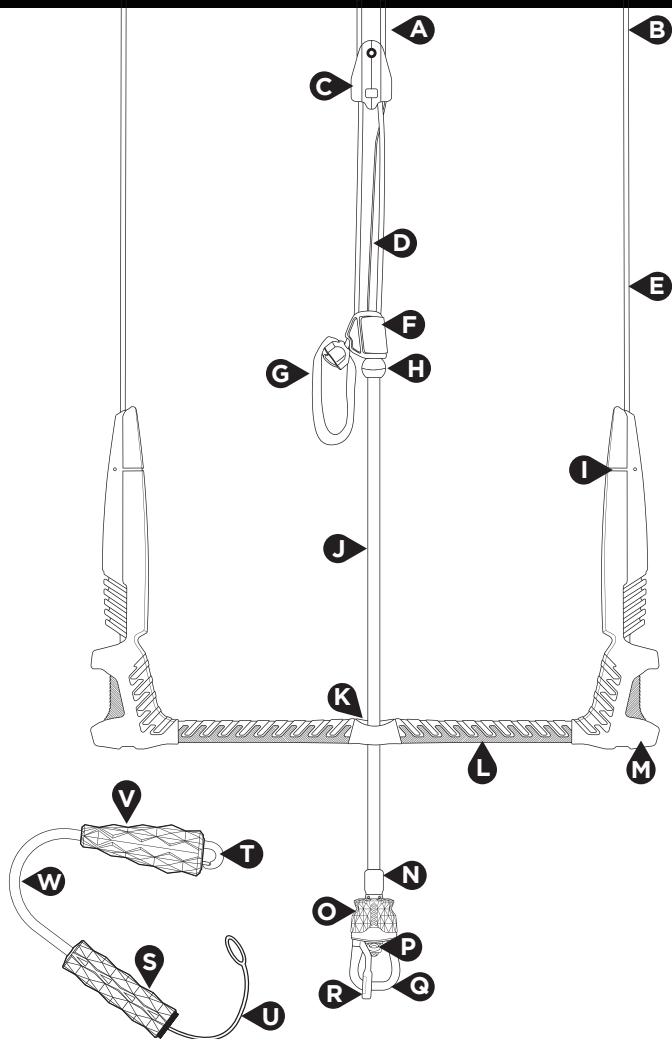

PILOT FEATURES

| | | | |
|----------------|---------------------------|----------------|--|
| A | FRONT FLYING LINES | P | LEASH ATTACHMENT RING |
| B | BACK FLYING LINES | Q | TRIM LOOP |
| C | PULLEY | R | LOCK IN TUBE |
| D | SINGLE FRONT LINE RE-RIDE | S | PUSH AWAY KITE LEASH RELEASE CUFF |
| E | BACK LINE LEADERS | T | STAINLESS CLIP WITH RETRACTABLE COVER |
| F | TRIM CLEAT | U | LEASH TO HARNESS CONNECTOR |
| G | VELCRO TRIM HANDLE | V | LEASH FLOAT |
| H | STOPPER BALL | W | LEASH LINE |
| I | BAR FLOAT | | |
| J | FRONT LINE TUBING SHEATH | | |
| K | CENTRE LINER | | |
| L | BAR GRIP | | |
| M | LINE STORAGE TAB | | |
| N | BELOW BAR SWIVEL | | |
| O | RELEASE CUFF | | |

PIGTAIL GUIDE

Warning:

Before riding with your new Ocean Rodeo Shift bar, please ensure you are using the appropriate pigtails and that your kite is properly rigged.

Included with this bar you have received:

2 x 20cm front line pigtails (A)

2 x 20cm back line pigtails (B)

2 x 30cm back line pigtails (C)

2 x 35cm back line pigtails (D)

All back line pigtails have been colour coded red and green to indicate left and right.

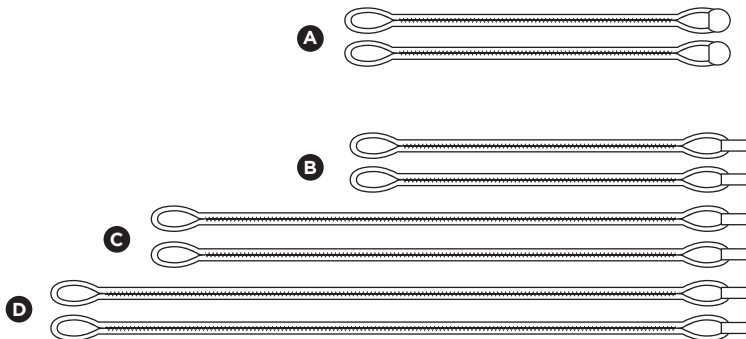

Note:

If you have noticeable front line stretch, you can offset it by replacing the backline pigtails with one of the longer alternative sets provided.

GEN 9 PUNCHOUT TRIM LOOP

Your Gen 3 Shift bar features the ISO compliant Gen 9 Punchout trim loop.

Designers Tip:

The push release cuff has a lip for improved grip on one side and is smooth on the opposite side.

It is important that you attach the trim loop with the lip of the cuff facing you. The smooth side faces away from the rider as it reduces the chance of accidental activation of the release cuff, should you bump it on the edge of a board during deep water starts.

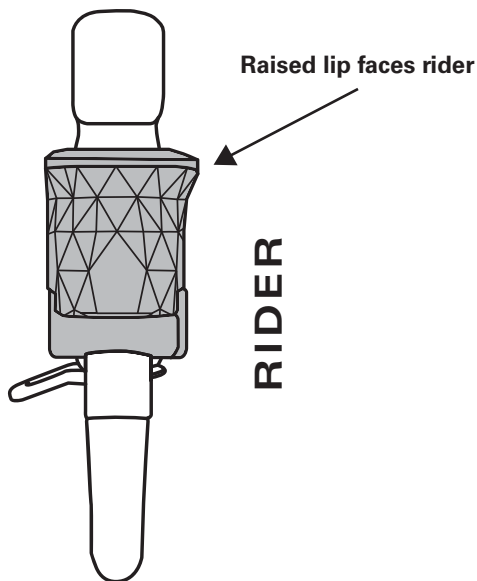

TRIM LOOP RELEASE CUFF ACTIVATION

Note: Always test your quick release before each session and always flush release after each session!

To separate yourself from the trim loop in an emergency situation, push the release cuff away from you.

As long as your kite leash is attached to the flagout ring, the control bar will ride up a single front line and depower the kite.

In most instances upon release the cuff will remain in the UP position for a quick reset.

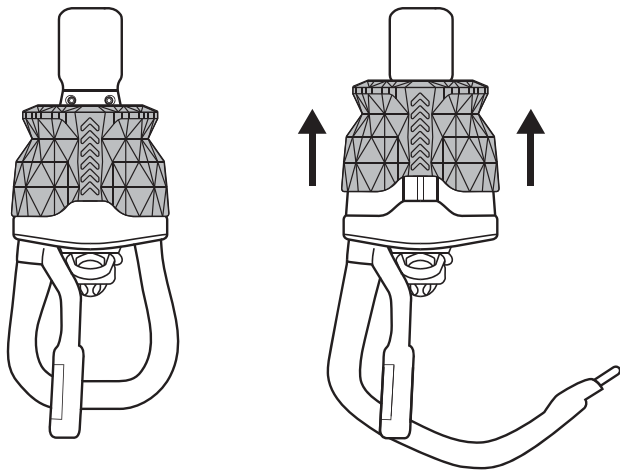

TRIM LOOP RESET

To reset your trim loop after it has been released:

- Begin by locking the cuff in the UP position if it is not already. To do this hold the trim loop system in an upright position and push up on the cuff.
- Hold the quick release by the swivel head, and insert the ring end of the trim loop back into the quick release.
- Push the loop up into the quick release while holding the swivel head, opposing this force. The loop will snap back into the quick release once enough pressure has been applied.

WARNING: Ensure fingers are kept away from the release cuff while resetting!

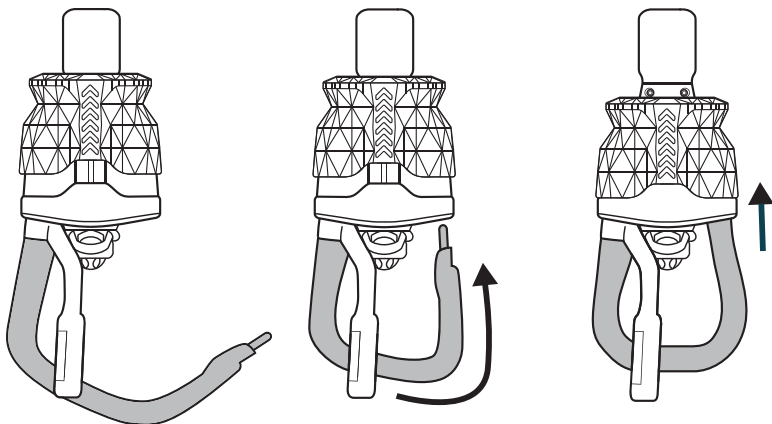

USING THE LOCK-IN TUBE

The lock-in tube helps keep your trim loop hooked in if you have slack or minimal tension on your lines while riding. To use the lock-in tube, simply flex the tubing into the head of the harness, under the trim loop.

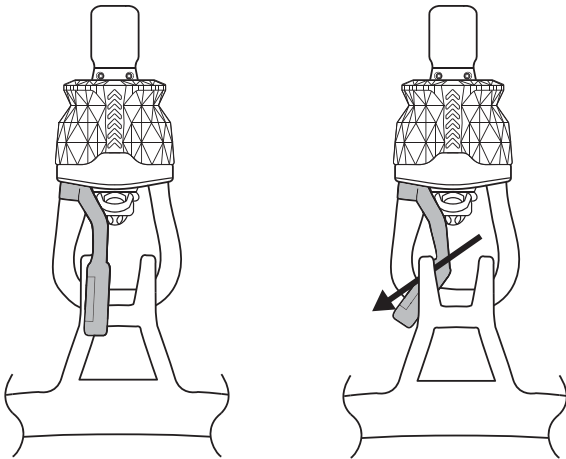

QUICK CHANGE TRIM LOOP

The trim loop can easily be replaced or switched out in favor of Ocean Rodeo's Slider or Freestyle loops.

To remove and replace the loop simply push up on the release cuff insuring the loop is released and exposing the connection screw. Using a fin key remove the screw and pull the loop out. Slide the new loop in and replace the screw. (As shown on page 14)

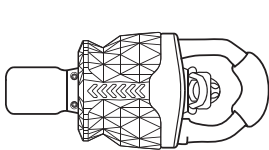
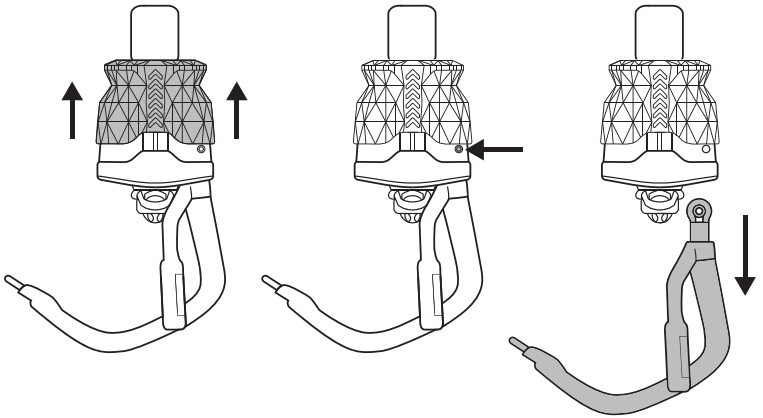

Slider Loop

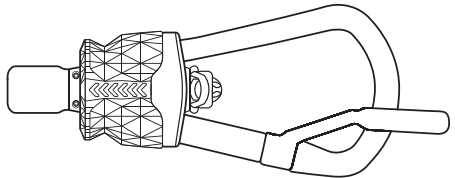

Freestyle Loop

Note: Slider loop must be used with correctly sized ring on the harness rope to ensure clean release. Refer to manual supplied with slider loop for most recent information.

BELOW BAR SWIVEL

Twisted front lines can affect the operation of your front line flagout depower system.

To correct twisted front lines: Grasp the swivel head and turn it in the opposite direction of the line twists.

WARNING: Multiple twists in your front lines can create dangerous amounts of friction and prevent proper depowering when the front line flagout system is activated. Untwist your lines regularly!

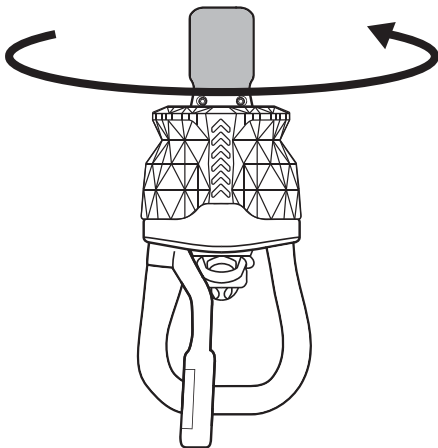

LEASH TO CENTRE LINE ATTACHMENT

To attach the leash to the trim loop slide the EVA float back to expose the clip and clip it onto the flagout rig as shown below.

Designer Tips:

Once clipped onto the flagout ring, slide the float back up to cover the clip opening. By doing this you eliminate a potential line snag point.

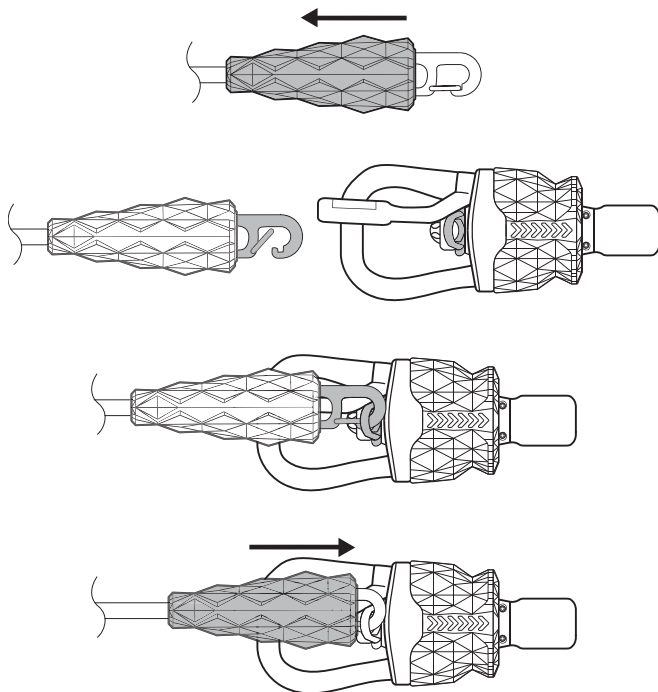

LEASH TO HARNESS ATTACHMENT

Note: Always attach your leash with the release cuff end closest to your harness!

Remove the connection tether from the leash and attach it to the harness ring, as shown below.

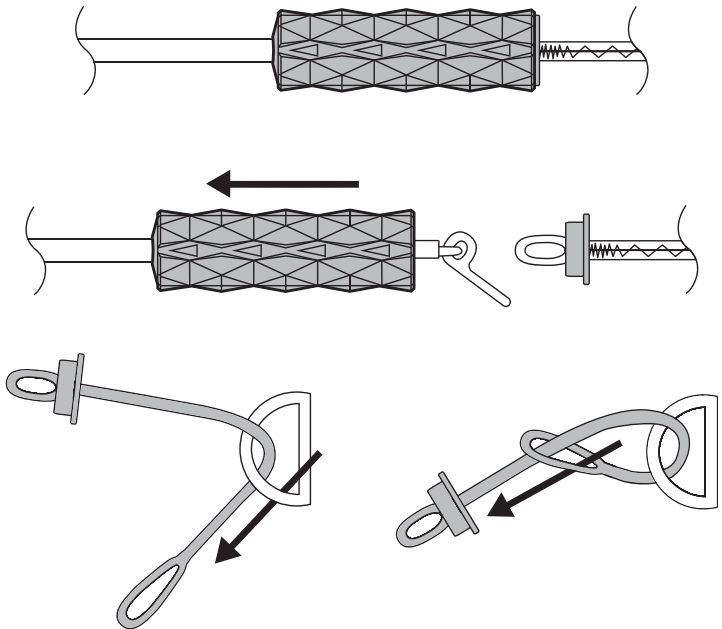

Once the connector tether has been attached to your harness, reset the leash's quick release following the steps shown below.

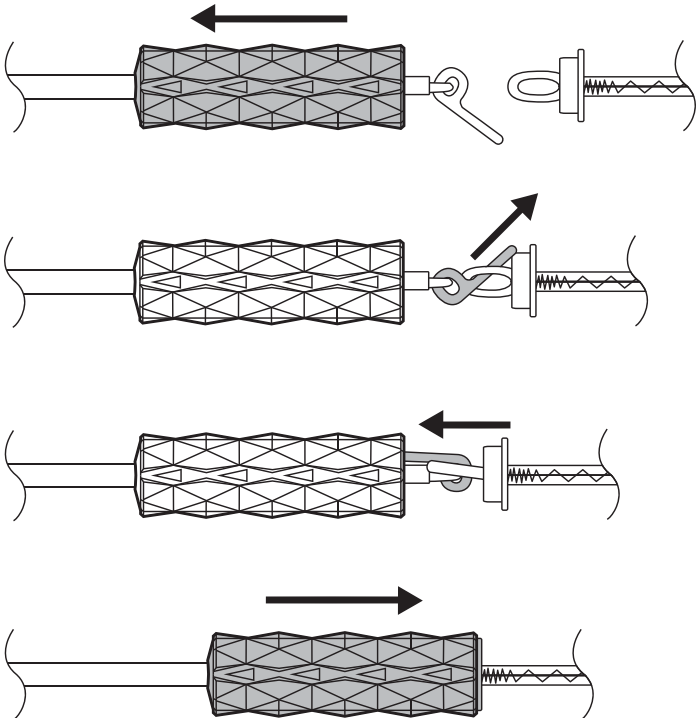

RELEASE CUFF MAINTENANCE

Note: Always flush sand and debris out your release systems after each session.

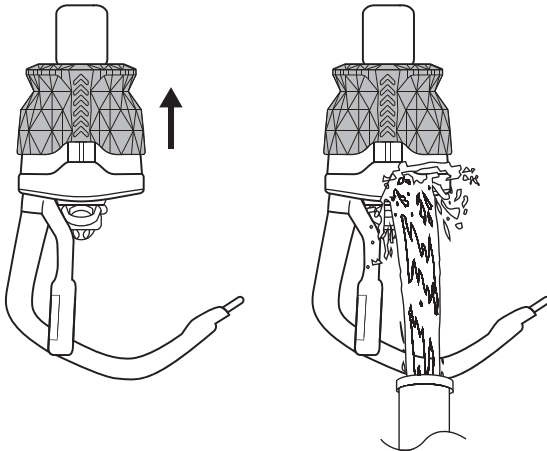
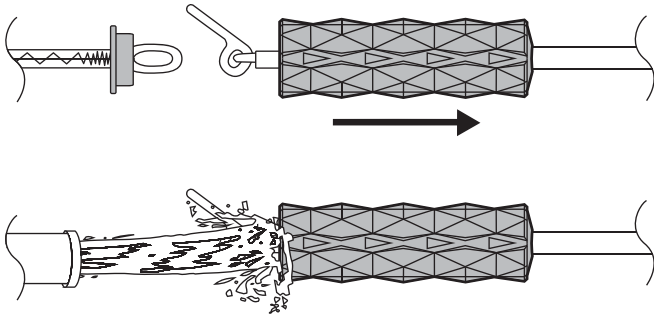

SINGLE FRONT LINE FLAGOUT DEPOWER

When activated, the bar's flagout system depowers your kite by releasing tension on 3 of the 4 flying lines. This allows the kite to depower and remain tethered to you by your leash.

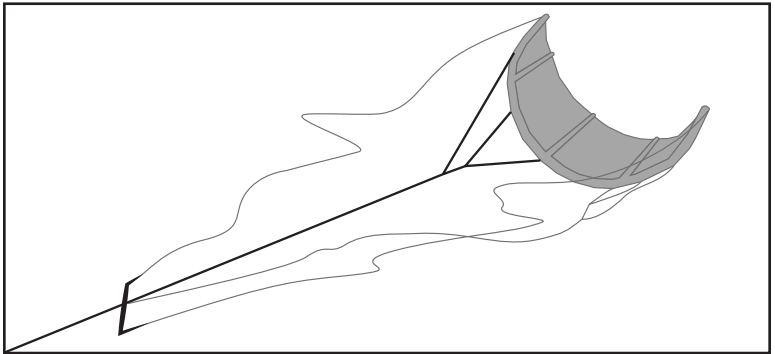

It is important that you inspect your front flagout line often for any damage or wear. This is easily done by grabbing the leash attachment ring and pulling the line out from the trim loop system. (This can not be done while lines are wrapped around the bar.)

For information on replacing a damaged front flagout line contact your ocean rodeo dealer or visit oceanrodeo.com/support

USING THE I3 SIDEWINDER (SHIFT)

NOTE: While riding, the I3 Sidewinder should be located on your right side.

To add power: Twist the tuning knob clockwise **(1)**. The winder will add ½ cm of trim for every quarter turn of the knob.

To depower: Bump or nudge the tuning knob outwards to allow the winder to unspool the wound up trim line in a controlled manner **(2)**. Your hand does not need to leave the bar grip during this process.

Adjusting trim while riding: If the tuning knob feels too difficult to turn, sheet the bar out to decrease backline tension. Slightly bearing off down-wind can also provide the same effect.

To rapidly depower: Nudge the winder and induce rotation in a counter-clockwise motion. This will allow the Sidewinder to skip multiple teeth on the gear and depower the kite quicker.

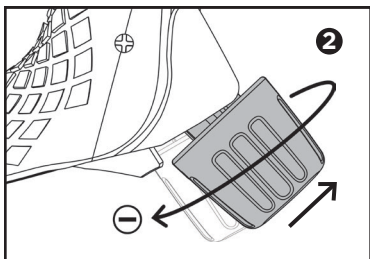
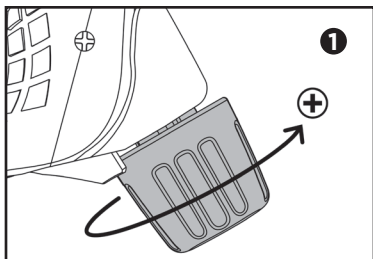

When the bar is at minimum power, a second white marker will become visible at the top of the float (1).

When the bar is wound to mid power, the first white marker will be centered in the window on the tension lock (2).

When the bar is wound to full power the spring cap will terminate at the top of the trim stopper (3). Do not continue to wind past this point.

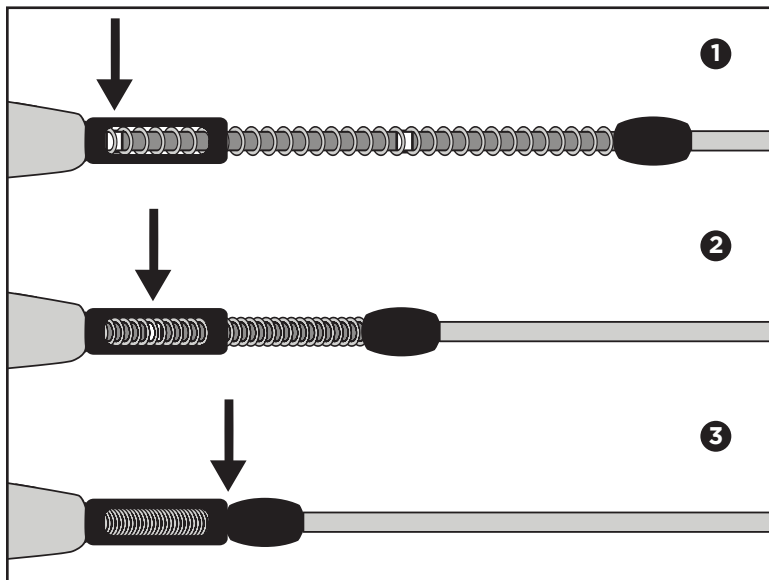

TUNING THE LINES (SHIFT)

Your kite's performance relies on properly tuned lines! Make a habit of checking your line lengths regularly. Attach all four lines to a solid object (fence, line wrapped around a tree, etc.) Pick up the kite bar and make sure the winder is set for maximum power before tuning your lines. Now, pull on the bar to check your rear outside (back) lines.

If properly tuned, your bar should sit perpendicular to the Polyurethane locking tube **(1)** and both tensioning springs should be equally compressed **(2)**

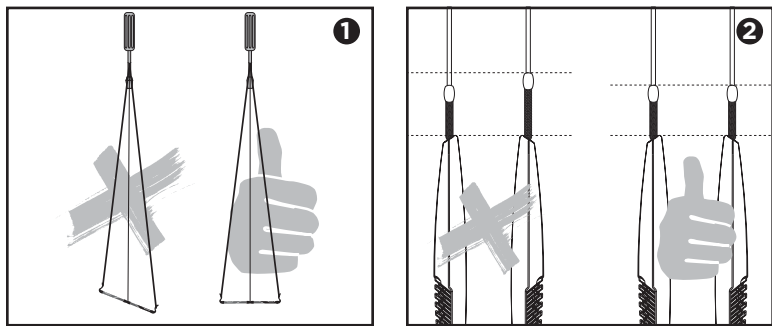

If the bar is not perpendicular to the locking tube, one of the back lines has stretched more than the other. There are two ways to fix this:

1. If the difference between line lengths is small (<2cm), the shorter line can be stretched to make up the difference in line lengths. Remove all lines except for the short line from the anchor point and pull on the bar until the line has stretched to the same length as the others.

2. If the difference between line lengths is large (>2cm), you should adjust line lengths using your pigtails. See the Pigtail Guide on the following pages.

If the springs are not equally compressed when fully powered, the trimline has stretched and must be adjusted at the winder. To fix this:

- Measure the difference between the two spring lengths when fully powered. Divide this number by 2. This is the length of line that must be shifted from one side of the winder to the other.
- Completely depower the bar by unwinding the Sidewinder to the minimum power setting.
- Using a small flathead screwdriver, loosen the knot attaching the line to the winder assembly.
- Once you have developed slack in the trimline-winder knot, slide the appropriate length of line through the winder assembly that was calculated in Step 1. **(3)**
- Adjust the Sidewinder to full power to verify that the force tensioner springs are now compressed the same amount. Repeat from Step 1 if necessary.

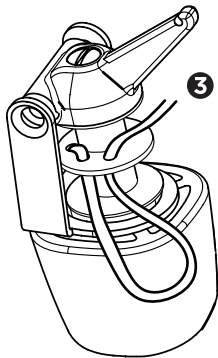

USING THE I3 G-STOP (SHIFT)

To adjust the stopper position on the locking tube, align the top edges of both stopper components .

To lock the stopper in place, tap it with your control bar. This will offset the two stopper components and engage the friction pad locking mechanism.

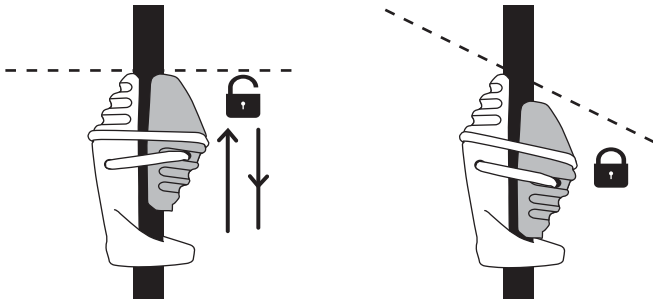

Warning: Do not move stopper below safe-line marked on locking tube.

Note: Locking the Bar Stopper below this line will prevent the kite from depowering and could lead to serious injury or death.

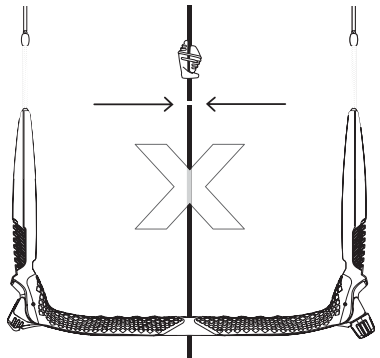

THE I3 FORCE TENSIONER SYSTEM (SHIFT)

The tensioning system allows the user to depower their kite when there is no tension on the back lines. To keep the tensioning system free from sand and debris, rinse it regularly. This can be achieved by simply dunking the bar in the water as you start your session. Storing the bar with the tensioning system fully depowered will increase the life of the springs and prepare you for your next launch.

To increase the life of your lines and bar floats, flush the floats out with fresh water regularly. Make sure the winder is set to minimum power, remove the spring cap from the top of the bar float and flush the float from the base with fresh water so that it flows out the top of the float. Be sure to replace the trim stopper into the top of the bar float.

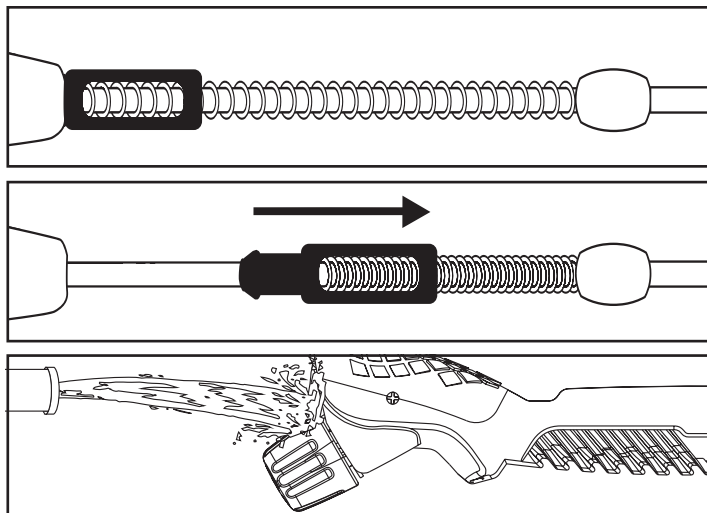

BAR TRIM ADJUSTMENT (PILOT)

- Bar is set at maximum power when trim line is in longest position.
- To depower the kite, pull down on Velcro trim handle.
- To add power to the kite, pull down and away from the cleat to disengage.

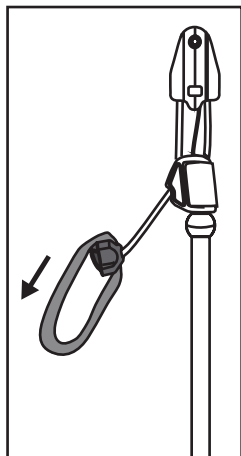
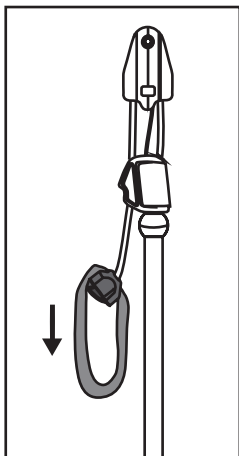
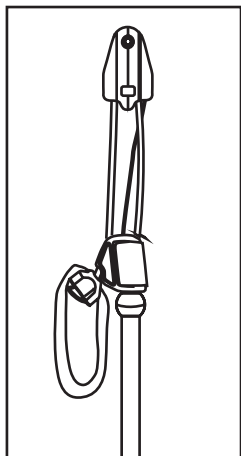

STORING AND CARING

For smooth operation; if your bar is covered with sand or debris, give it a quick rinse in the water before and after riding.

To avoid tangles, we suggest you wind your lines in a figure 8 pattern around your bar ends. This 'end over end' approach will prevent coils in your lines and allow you to smoothly run them out again for your next session.

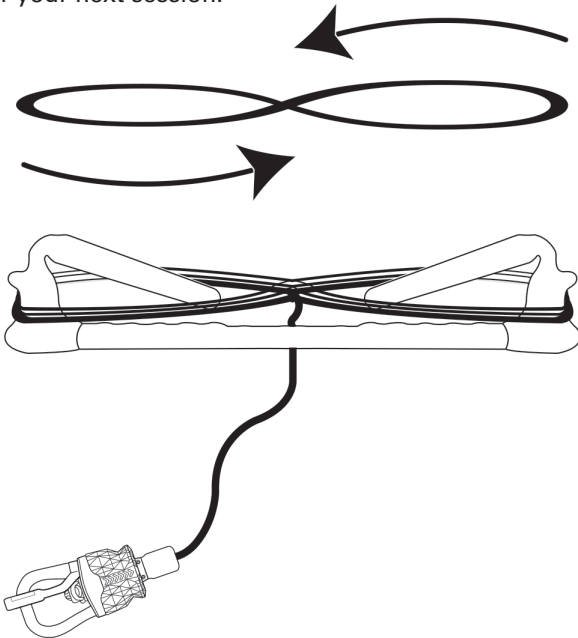

Use bar end line bungees to secure your kite lines for tangle free storage.

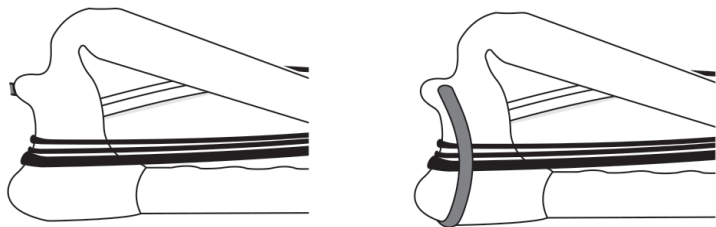

Thoroughly rinse with fresh water after each session and store out of direct sunlight.

WARNING!

Knots can easily form in your flying lines, especially close to the kite end of your lines. Always inspect for and remove knots when found. Knots weaken your flying lines! Lines with immovable knots should be replaced!

ISO COMPLIANCE

Ocean Rodeo has worked closely with The GKA on introducing a new ISO safety standard for quick-release systems on kite bars.

The new ISO standard regulates how bars are tested to ensure a level of safety you can rely on even in the harshest conditions.

The Gen 9 trim loop and freestyle leash featured with the Shift Gen 3 meet the ISO standards.





oceanrodeo.com

info@oceanrodeo.com

NA Toll Free 1-888-544-4969

INT +1 (778) 734-2696