



— PRODUCT DATA SHEET
HF4R WORK



HF4R Work

PRODUCT DESCRIPTION

The Ledlenser HF4R WORK rechargeable head torch is ideal for the professional trades and industrial users with a great eight hour run-time on mid power light intensity. Slim, lightweight and robust, this headlamp features three brightness options, a red light, a high colour rendering index (CRI) for close-range work, battery indicator, charge indicator, low battery warning, various helmet mounting options and a transport lock to prevent accidental battery drain. The head of the light tilts 45° to direct the light beam and thus optimise illumination. Charging of the integrated battery is easy via the Magnetic Contact Charge System. Dust and water ingress protected to IP68. Backed by a 7-year with registration warranty for complete peace of mind.

- Slim rechargeable head torch with three brightness levels as well as red front light
- Bright and perfectly balanced light pattern; focusable for flood (near) and spot (long-range) illumination
- Protective elements at the front for high impact resistance; high protection against dust and water ingress (IP68)
- Efficient battery, easily rechargeable via Magnetic Charge System. Also features battery status indicator
- Mounting option on helmet via rubberised headband or supplied helmet mount and adapter
- 7-year with registration warranty for complete peace of mind

TECHNICAL DATA

Weight incl. batteries [g]	79
Focus function	No
Head material	PC
Tube material	PC
Optic	Plastic lense (PMMA)
Headband material	Elastic fabric
Headband type	Side headband
Head movement type	Stepless movement
Head movement angle [°]	45
Headband specifications	Detachable, Elastic, Rubberised back, Washable

POWER SUPPLY

Power source type	Rechargeable battery
Battery quantity	1
Battery type	Li-ion
Battery replaceable	No
Total battery voltage [V]	3.7
Total battery capacity [mAh]	1000
Total battery energy ² [Wh]	3.7
Rechargeable	Yes
Charging time ⁵ [min]	180
Energy status indicator	Battery Indicator, Charge Indicator, Low Battery Warning

FURTHER SPECIFICATIONS

IP class	IP68
Drop test (drop height) [m]	2
Working temperature range [°C]	-20 to +40

LIGHT FUNCTIONS

Boost, Power, Mid Power, Low Power

LIGHT SOURCE

Amount LEDs	2
LED type	High Power LED
Colour	White
Colour temperature [K]	4600 to 5400
Colour rendering index (CRI)	80

LIGHT VALUES

	Boost	Power	Mid Power	Low Power
Light output ¹ [lm]	500	300	80	20
Beam distance ¹ [m]	130	100	60	15
Run time ¹ [h]		2.5	8	35

SWITCH

Front Switch

FEATURES

Red Light, Transportation lock , Memory Function, Backup Mode

TECHNOLOGIES

Temperature Control System, Magnetic Charge System, Fusion Beam

HF4R Work

PACKAGING AND LOGISTICS



PACKAGING INFORMATION

Type of packaging	Box
Supplied with	Connect adapter, Magnetic charging cable (USB-C), Mounting material
Item No.	502793
Customs tariff number	8513100000
Colour	yellow
STERLING RRP ex / incl vat (£)	£41.63/ £49.95
EURO RRP ex / incl vat (€)	€40.61 /€49.95

SINGLE PACKAGE

Dimensions W x H x D [cm]	7.2 x 21 x 4.2
Gross weight [g]	200
GTIN-13	4058205031769

EXPORT CARTON

Unit	48
Dimensions W x D x H [cm]	45.5 x 29 x 34
Gross weight [kg]	10.4
GTIN-13	4058205031752

HF4R Work

PRODUCT SERIES

The HF-series Work models are ideal companions for professional users. If you often work in the dark and need the best light for maintenance or repair work, our Work models will not disappoint. All Work headlamps are extremely robust, come with an additional red light as well as a high color rendering index for close-range work and can be attached to a helmet via a rubberized headband or an adapter and mounting system – all while allowing hands-free working.

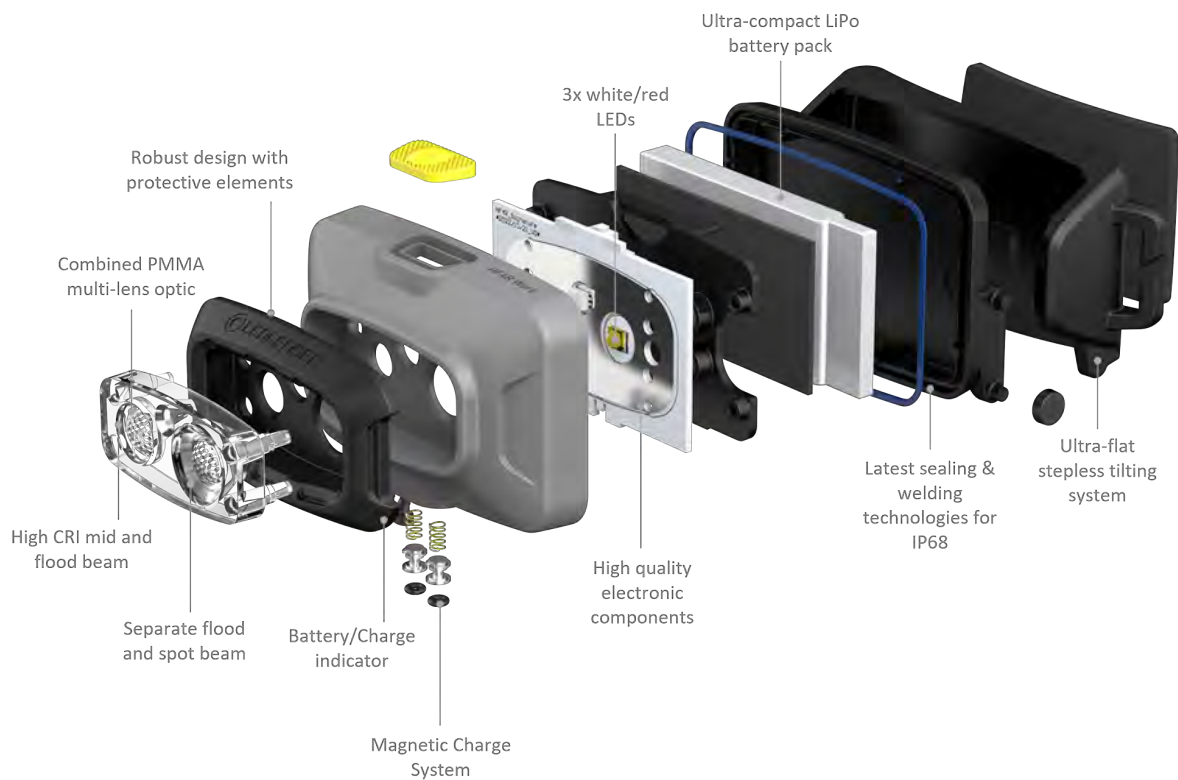

HF4R Work

FOOTNOTES

The information pertaining to scope of delivery, appearance, performance, dimensions and weight corresponds to the information available at the time of publication. In the interest of product development, we reserve the right to change scope of delivery, appearance, design and color without prior notice. Product images may vary from the actual products and may show optional accessories which can be purchased separately. Errors and omissions excepted.

1) Measurement values according to ANSI FL1 in the respective setting. If no setting is explicitly indicated, the values refer to luminous flux (lumens/lm) and lighting range (meters/m) on the highest setting, and to battery duration (hours/h) on the lowest setting. A boost function (if available) can be used several times, but only for short periods of time. If the light is equipped with (a) colored LED(s), the measurement values are given for the white light or the white LED. If the light has different energy modes, the measurement is made based on the "energy saving mode".

2) Calculated capacity value in watt-hours (Wh). This applies to the delivery state of the battery/ies inside the respective item, or for lights with rechargeable battery/ies, to the rechargeable battery/ies inside the product when fully charged.

5) Charging time varies by hardware used.