

SQUAREGLES®

PLAY BEYOND THE BUILD!



YETI YIKES! SKI MOUNTAIN

  @squaregles | squaregles.com

All images shown
are for illustration
purposes only.
Actual product
may vary. Art in
this guide is not
included on panels.

SQUAREGLES

YETI YIKES!
SKI MOUNTAIN

YETI YIKES! SKI MOUNTAIN SET

Welcome to the Squaregles universe!	1
Squaregles + MESH	2
Problem Solving and Storytelling	3
Who are the Oggs and Erggs?	4
Yeti Yikes! Piece List	5
Pieces Explained	6 - 7
Let's Build!	8 - 14

EXTRA BUILD IDEAS!

Beginner	15
Intermediate	16
Combining Build Ideas! *	17

* Includes sets that are sold separately. Check out squaregles.com for additional sets.

WELCOME TO THE SQUAREGLES® UNIVERSE!

The Squaregles® universe is full of Oggs® and Erggs™, and the things they create! Oggs and Erggs are adventurous characters that spend their days pulling pranks, building crazy contraptions and losing their heads (literally!). They've got powers to discover.

Squaregles magnetically connectable frames have crazy awesome panels that pop in and out. Panels are blank and themed, flat and 3D, paperboard and plastic. Why? Every child's play style is unique, so every Squaregles build can be too. Whether you're an action seeker, contraption maker, builder, inventor, artist or storyteller, Squaregles is for you. Hello hours of fun and engagement.

On top of all the fun, playing with Oggs, Erggs, and Squaregles helps build Mental, Emotional and Social Health skills (MESH). Your child is able to take on new and exciting challenges, solve problems and create stories. All of these skills are proven to improve MESH.

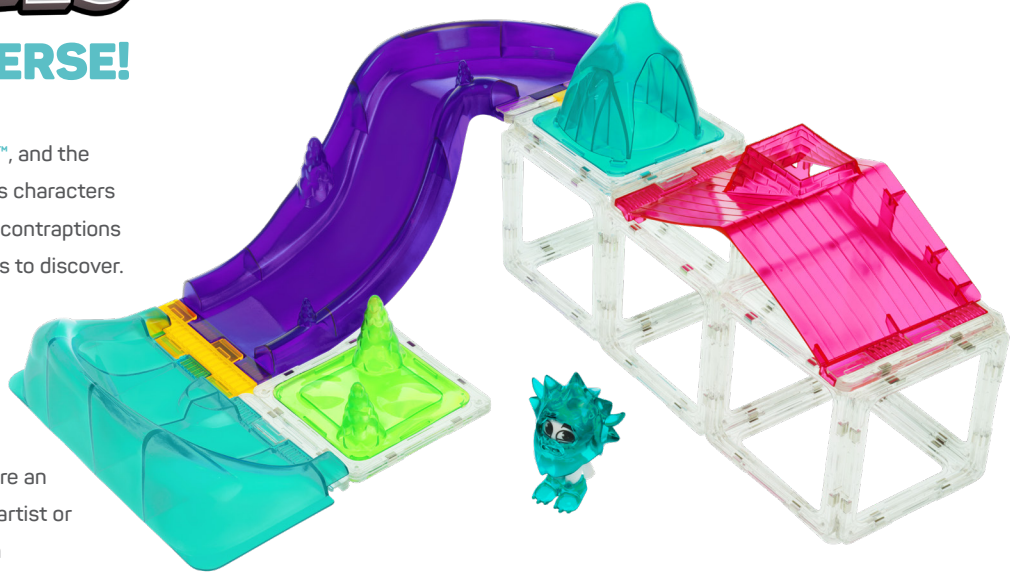

SQUAREGLES + MESH

TAKE THE PLAY EVEN FURTHER!

MESH (Mental, Emotional, Social Health) in children is important to building resiliency. There are four skills that have been identified to improve MESH through play:

1. Focus on **problem solving** and perseverance
2. Encourage **storytelling**
3. Present new or increasing challenges during the duration of play
4. Draw children and their adults to play together

Squaregles is designed specifically to develop these four MESH skills!



COMBINING PHYSICAL AND VERBAL PROBLEM SOLVING

WITH ERIKA CARDAMONE, MS, CCC-SLP

How does Squaregles do this?

- ▶ Children construct and modify their builds, as well as their stories through the characters.
- ▶ The builds can start off simple, but can become increasingly challenging as you see fit.
- ▶ Following step-by-step directions and revising construction is problem solving!
- ▶ Grownups can explain perseverance and verbally identify challenges, like "Wow, this is really tricky to balance. I wonder if we'll get it on the first try."
- ▶ Encourage storytelling! When children practice storytelling, they're doing so much more than just talking... they're verbalizing emotions, solving problems, negotiating roles, using critical thinking and language to engage with the world around them.

SIMPLE STRATEGIES TO ENGAGE IN STORYTELLING WITH YOUR CHILD:

Let your child lead the play – you are the Producer, your child is the Director of play.

The Ogggs and Erggs (characters) are essential for building the story. They interact through conversation, thinking, planning, and more!

Use "I wonder..." statements and open-ended questions, like "I wonder how they'll get back to shore," "How will they get rid of the shark?"

Be open to plot twists. Encourage modifications to the story and the build! For example, adding a floating dock to jump off and swim.



We partnered with Speech-Language Pathologist (and Toy Expert!), Erika Cardamone, to create ways to encourage storytelling with Squaregles. In the build section (starting on page 14), Erika has included some storytelling prompts for you to use while playing beyond the build!

WHO ARE THE OGGS® AND ERGGS™?

Oggs® are curious, sometimes sassy, always adventurous creatures. **Erggs**™ are just like the Oggs, but with a side of mischief, and don't always use their powers for good.

In the Squaregles universe, they uncover magical items called **Totems**! With powerups from Totems, Oggs and Erggs activate special, often surprising, and not always helpful, magical powers. How will they use them?!



TOTEMS EXPLAINED

Along the way, Oggs and Erggs uncover magical items called **Totems**. While it's a mystery where these Totems came from (or who left them behind), Oggs and Erggs have discovered that Totems magically unlock powerups when equipped.

Each powerup is unique to every Ogg and Ergg. For example, the Unicorn Helmet may allow Flare to teleport, but for others... well, the power may be more unpredictable. The only thing known for sure is that this is just the beginning...

Yeti Yikes! Ski Mountain Piece List

1
Yeti Mask



1
Fluke Head



1
2-Legged Body



1
Yeti Feet



16
Square Frames



1
Ski Moguls Panel

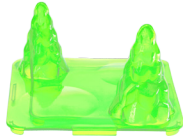

4
Paperboard Panels



1
Mountaintop

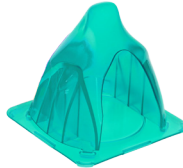

1
Ski Lodge Roof

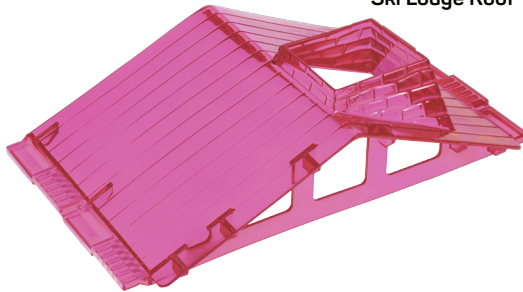

2
Bridge Clips



4
Edge Frames



2
Double Edge Clips



1
Alpine Slope



1
Luge

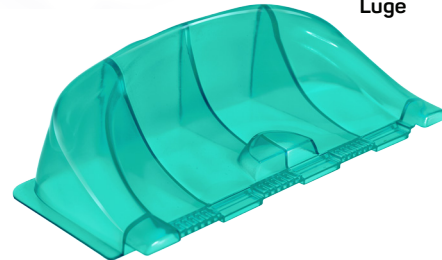

Something missing? Please reach out to us at build@squaregles.com. We're here to help!

Frames

Frames are magnetic squares in this set.

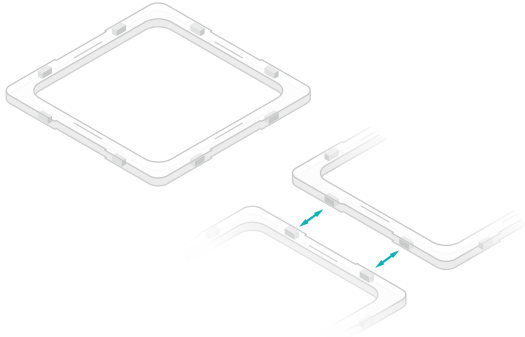

Panels

Panels come in a variety of shapes and snap into frames.

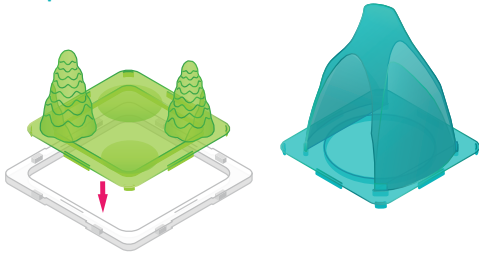

Edge Frames

Pop edge frames onto ramps and paperboard to connect them magnetically to other frames!

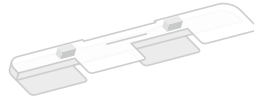

Double Edge Clip

Pop double edge clips onto ramps to build longer ramps.

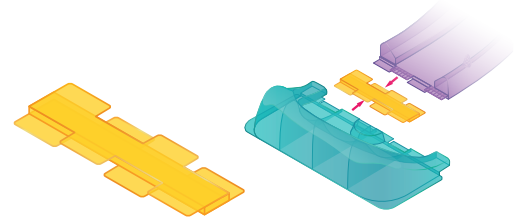

Edge Frames + Slopes, Roofs, and Lugers

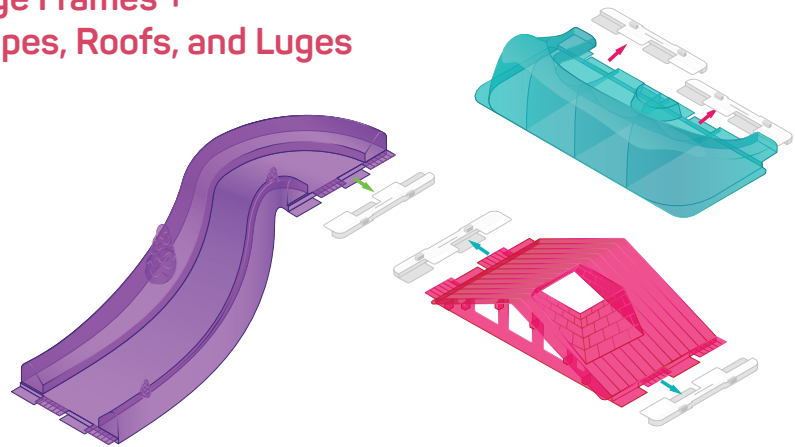

Paperboard

Paperboard are the blank paper pieces that you can draw on and snap into square and edge frames!

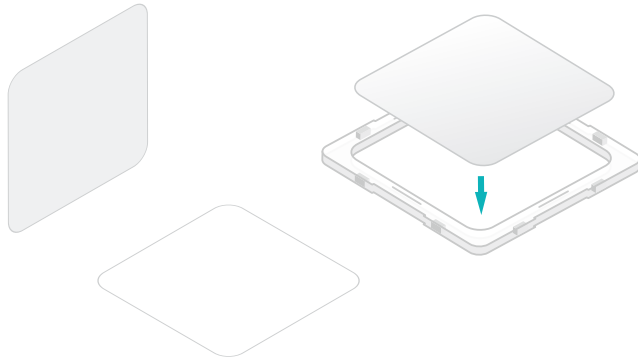

Paperboard + Edge Frame = Interactive Pieces!

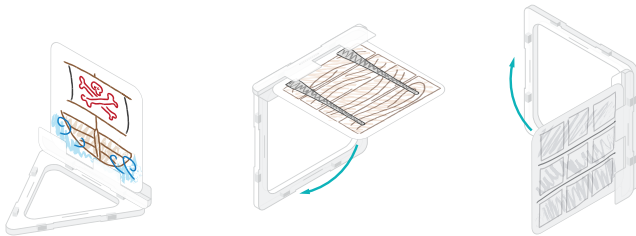

Erggs

Erggs are clever, mischievous characters included in the Squaregles Universe. They like to play pranks on the Oggs and they don't always use their powers for good.

Erggs heads are balls! Roll them down ramps or attach them to their bodies for endless ways to play. Attach Erggs' heads to their bodies with their hats.

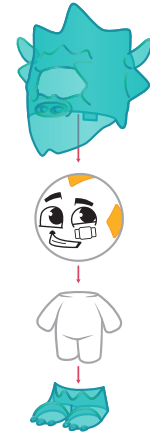

Bridge Clips

Bridge clips are our small, but mighty pieces. They reinforce magnetic connections, so you can build suspended bridges and bigger builds with fewer frames!

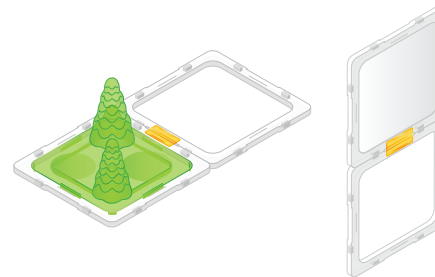

Use the bridge clips to build taller structures with fewer square frames!

LET'S BUILD!

Not sure where to start? Here are step-by-step instructions to recreate the build on the front of the box. **Heads up!** This may take some trial and error the first time.

Tag us on social media with [#squaregles](#). We can't wait to see the creations, contraptions and challenges you will dream up!

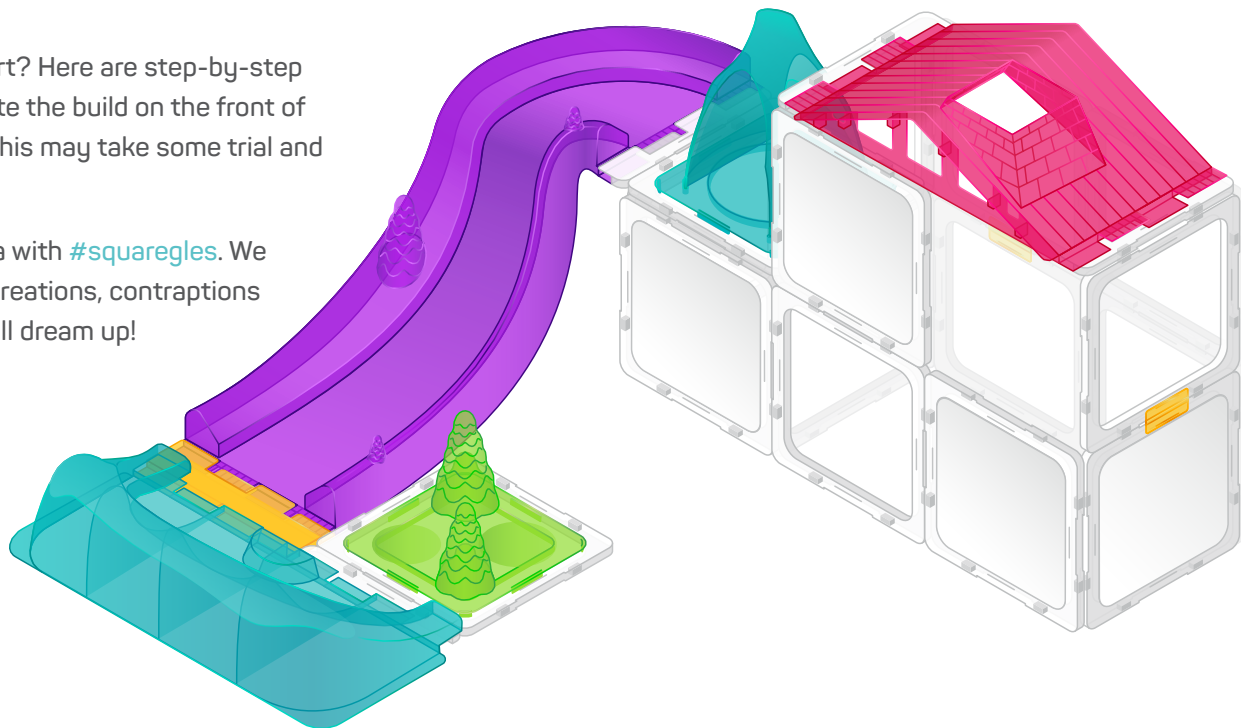

STEP

1

Snap panels into frames.

Build Tip: Less is more. You don't need 4-6 squares per level to build a tower, our magnets are strong so you can use less and maximize your build.

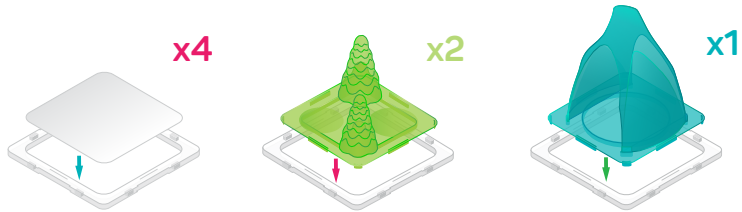

STEP

2

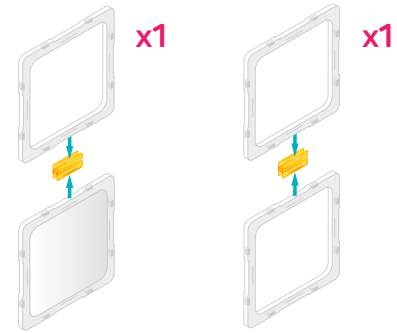
Attach frames with bridge clips.

... This frame has paperboard!

STEP

3

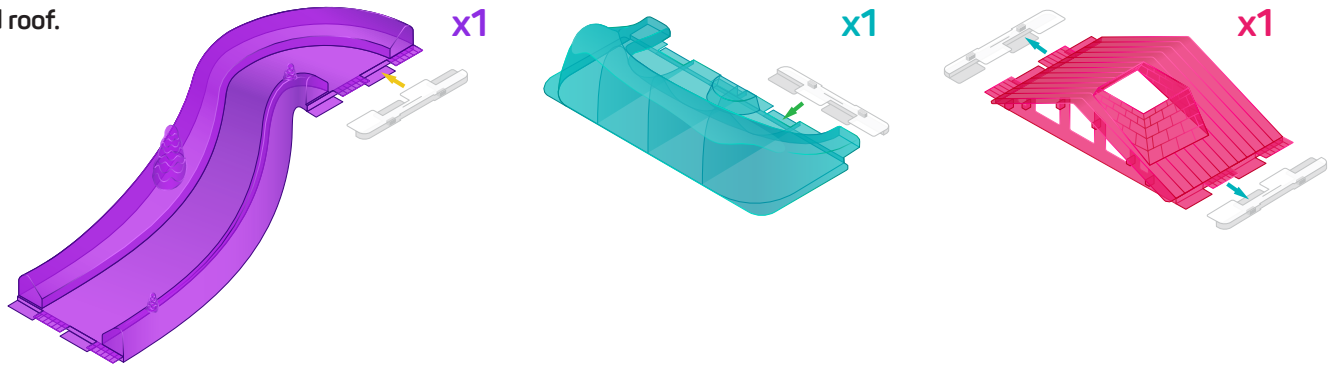
Attach edge frames to slopes and roof.

STEP 4 Let's build the ski lodge!

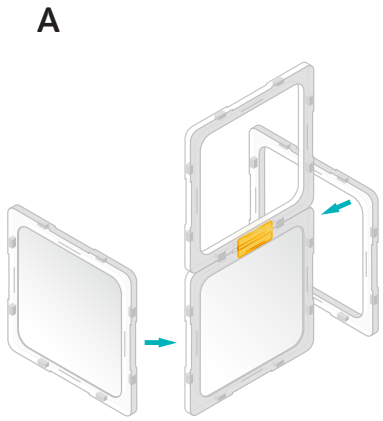

... These frames
have paperboard!

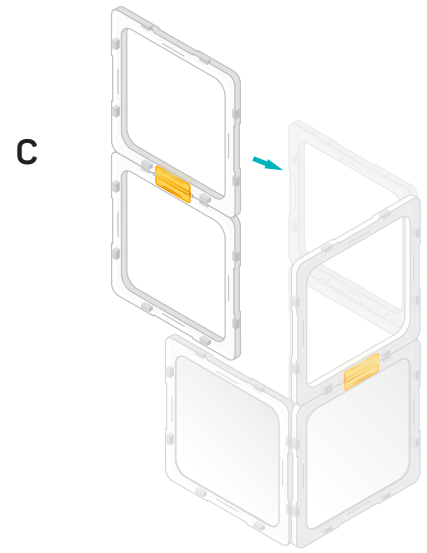
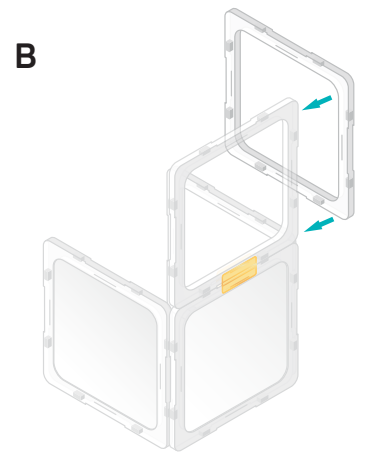

D

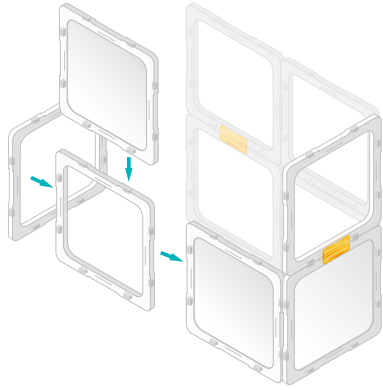

E

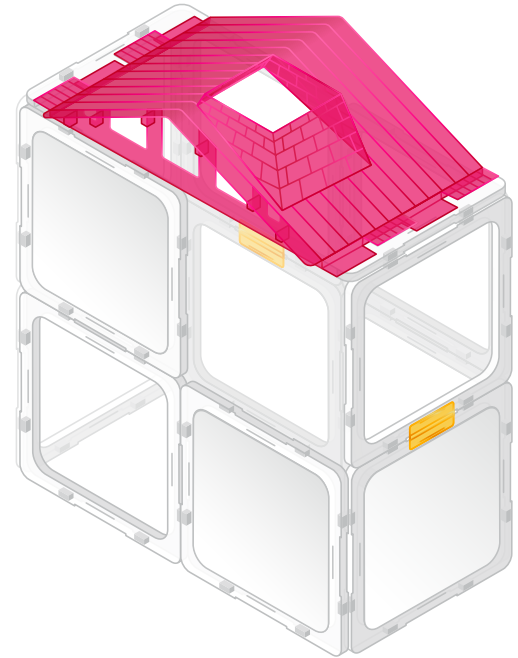
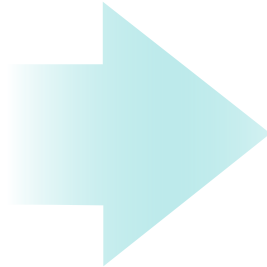
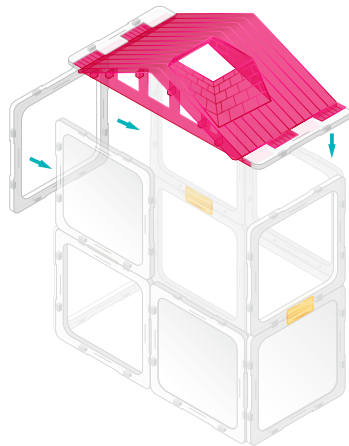

STEP 5

Let's build the mountainside!

A

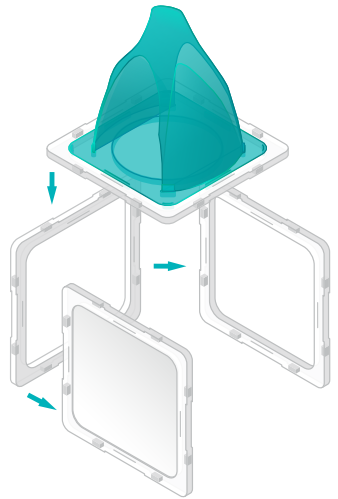

B

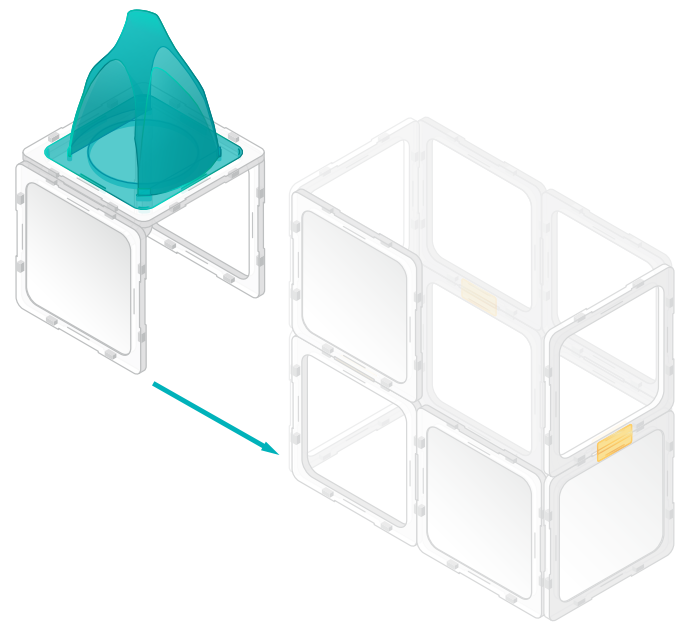

STEP 6

Let's finish the ski mountain!

A

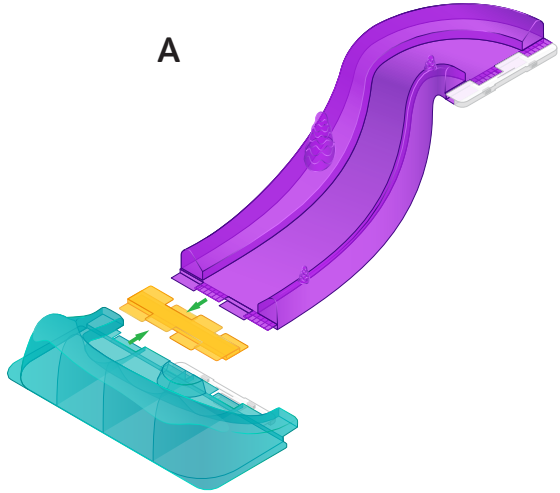

B

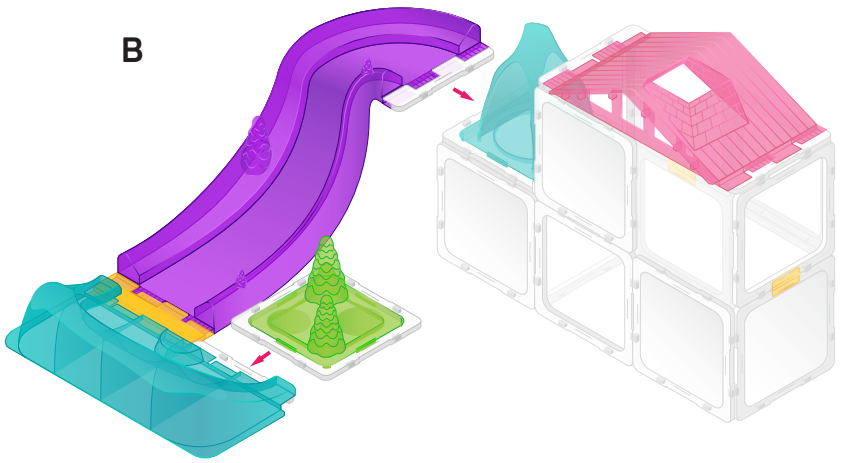

BUILD FINISHED!

STORY PROMPTS:

- ▶ Some friends discover Fluke in his icy mountain house and have proof that a yeti exists. They want a new friend to help track the yeti, but Fluke is very shy. How can they make him feel included?
- ▶ Fluke wants to show off his house. He invites friends in to decorate the walls – it could use more pizzazz. He also introduces them to his snowcapped relaxation room where he practices yoga. What else helps them relax?

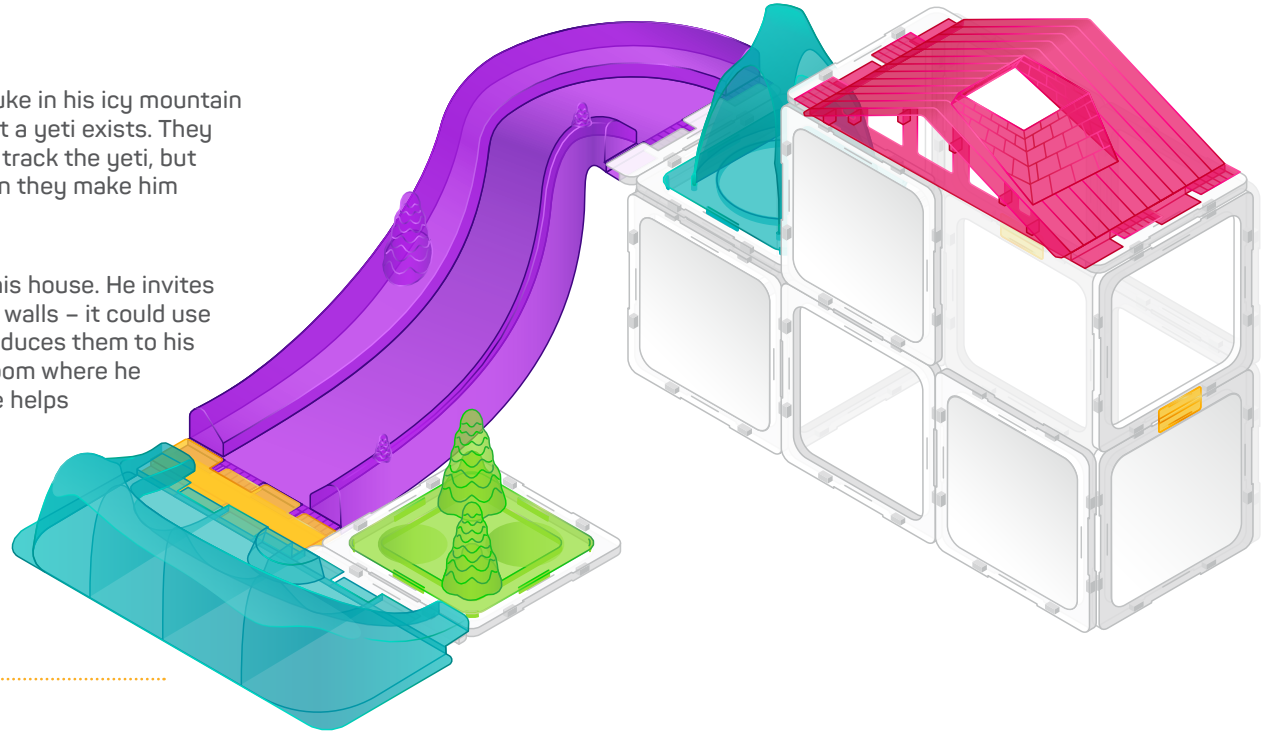

MESH PROMPT:

Have you ever felt shy with a new friend?
What strategies help you to feel comfortable
in new situations?

STORY PROMPTS:

- ▶ After a full day of throwing snowballs and sledding, Fluke started to shiver. Can you help build him a cozy house to warm up in? Maybe flip the roof to make solar panels! Or flip the roof to create a funnel to pour marshmallows for hot cocoa into!
- ▶ Spring is coming and the mountain snow begins to melt. Fluke's friends want to visit and find a slippery mountain that collects all the drips and flows down into a river below. What new activities can they enjoy in the spring?

MESH PROMPT:

Tell me about a time when you used a toy in a different way. How did you adapt or change your thinking to create something new?

Build Tip: Flip the roof upside down to create a ramp or a funnel!

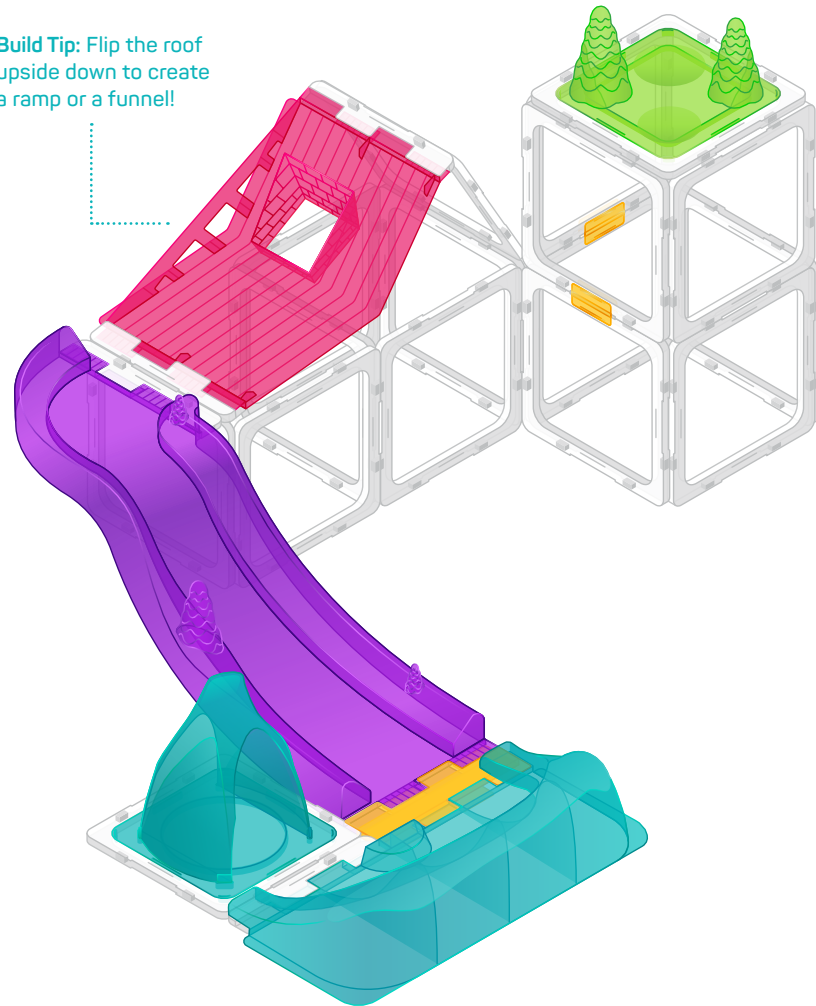

INTERMEDIATE

STORY PROMPTS:

- ▶ Fluke has always felt safe at the top of his mountain and has never climbed down the steep slopes. He really wants to see the beauty of the world below, but is afraid of falling. Can you rebuild the mountain to make Fluke feel safer coming down?
- ▶ The kids are afraid of the legends of Fluke the yeti and feel daring one day. They climb the mountain, but are quickly discovered by the green motion detectors in the trees. Fluke patiently waits in his house and has plans to serve hot chocolate. It's sure to be a great way to start a friendship.

MESH PROMPT:

Have you ever heard someone say something unkind? How should you support each other so that the world can be a kinder place?

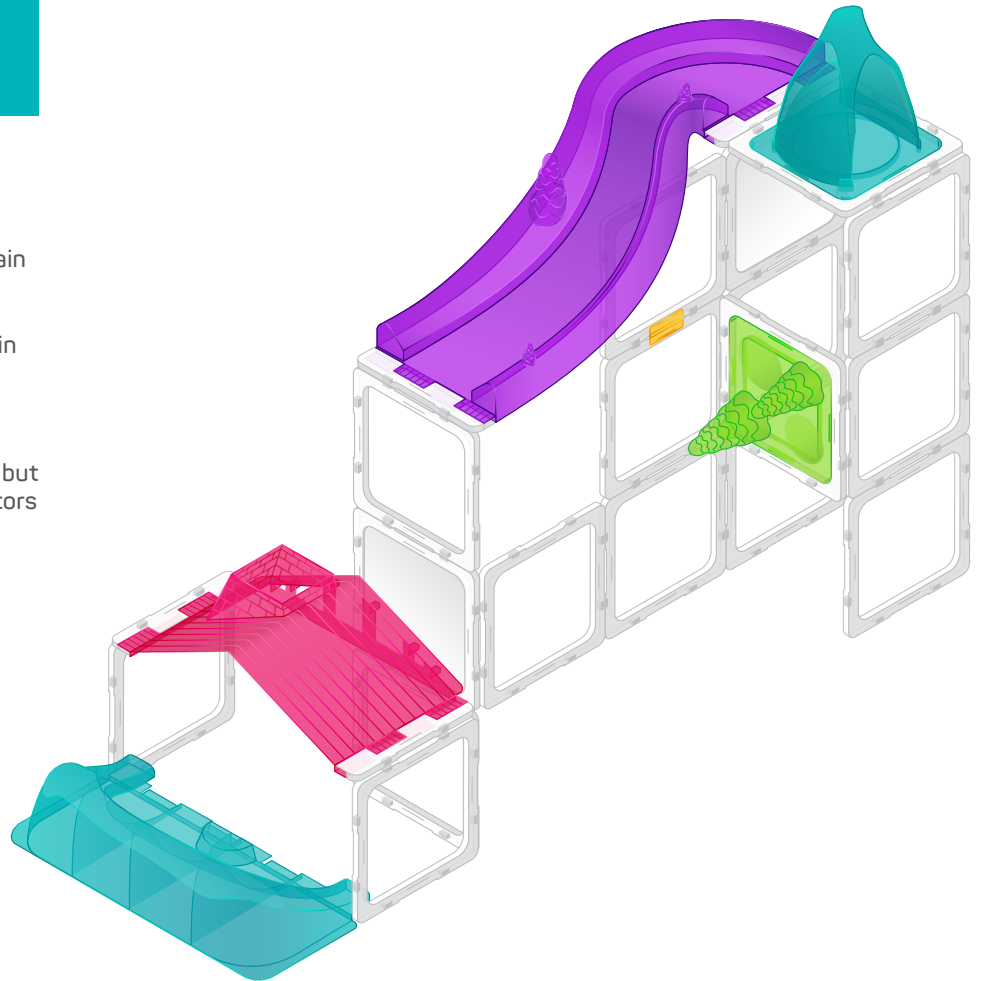

**COMBO
BUILD
IDEA 1**

Yeti Yikes! Ski Mountain



+ Innovator Set



(sold separately)

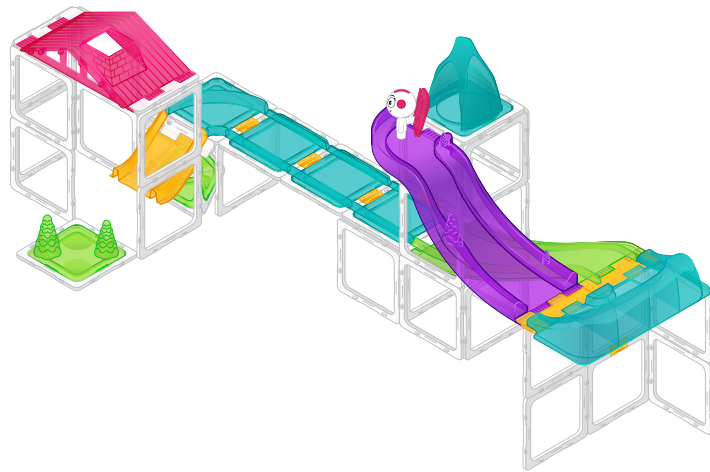

Yeti Yikes! Ski Mountain



+ Go's Spiral Drop



(sold separately)

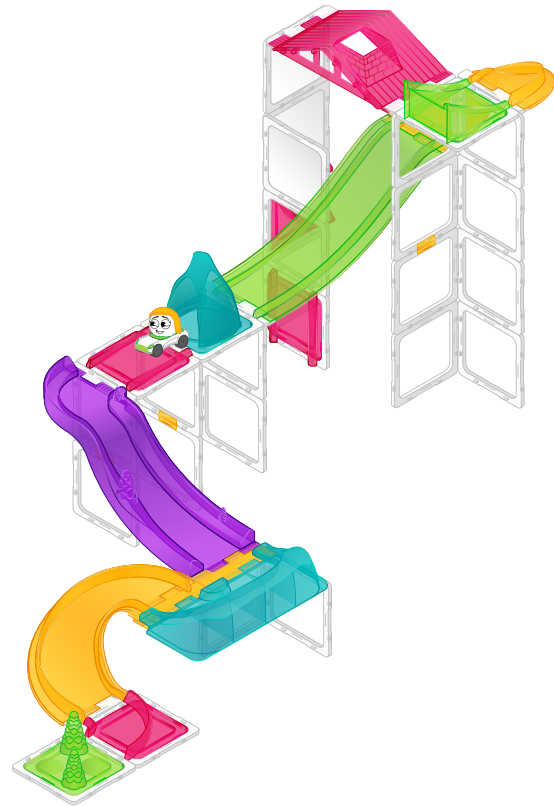

**COMBO
BUILD
IDEA 2**





SQUAREGLES®

 Email: build@squaregles.com

 Instagram: [Squaregles](https://www.instagram.com/Squaregles)

 TikTok: [Squaregles](https://www.tiktok.com/Squaregles)

ATTENTION!

-  Do not submerge the product in water and never use washing machines or dishwashers to clean the product.
-  Do not allow children to put parts in their mouth, as there may be a risk of choking. This product contains small parts and should not be used by children under 3 years old.
-  If the parts break, be sure to collect all pieces and discard them immediately.
-  Keep the product away from objects affected by magnets, such as credit cards, watches, TVs, computers, cellphones, and other electronics.
-  Please wipe with a dry towel if the product becomes dirty.

2023 Squaregles LLC. All Rights Reserved.
Squaregles, Squaregles logo, Oggs, Oggs logo, Erggs, Erggs logo, Get Lost in Play!, Play beyond the Build, Build Outside the Box, and associated trademarks and trade dress are owned by Squaregles LLC. Squaregles patent information is available at squaregles.com/patents