

Instruction Manual

C A D O L A
- 1 9 4 6 -



To ensure correct care, please take some time to review the enclosed instructions to review how to operate your watch.

Vol.1.40 EN

 CADOLA1946

Cadola

COSWORTH

LIMITED EDITION

COSTIN
CHRONOGRAPH

This watch is equipped with a quartz powered Swiss chronograph movement. Besides the normal time read out, this movement enables split timing micro measurements of time at the push of a button, which can be utilized in a variety of applications.

For more details on operating this timepiece please refer to the enclosed booklet or visit :

IM.CADOLA1946.COM

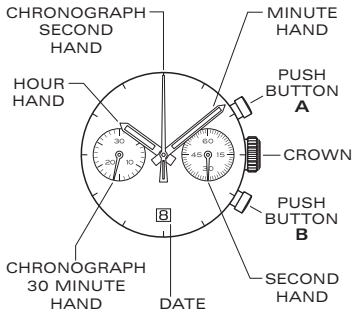

(1st click) (2nd click)

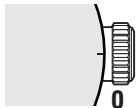

CLOSED:

Pushed back and
Water Resistant

OPENED:

Not secured for
Water Resistance

HOW TO SET THE TIME

1. Put the crown to position [2]-(2nd click).
2. Rotating the crown to set the correct time.
3. Push the crown back to position [0].

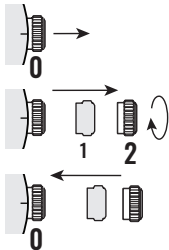

* Take a.m./p.m. into consideration when setting the hour and minute hands to the desired time.

HOW TO SET THE DATE

1. Put the crown to position [1]-(1st click).
2. Rotating the crown to set the correct date.
3. Push the crown back to position [0].

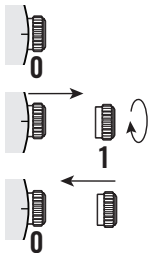

* Do not set the date between 9:00 P.M. and 0:30 A.M.

STOPWATCH FUNCTION

- The stopwatch can measure up to 30 minutes.

STANDARD MEASUREMENT

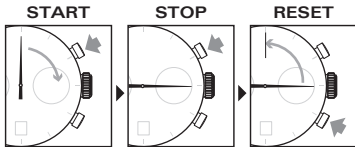

SPLIT TIME MEASUREMENT

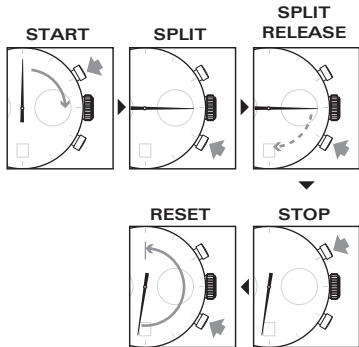

Measurement and release of split time can be repeated as many times as necessary by pressing the button **B**.

ADJUSTING THE STOPWATCH HAND POSITION

- * Before setting the time, check if all the chronograph hands (second, minute) - are at the "0" (12 o'clock) position.
- * If the stopwatch is in use, press the buttons in the following order to reset it, and then, check if the hands return to "0" position.

If the chronograph is counting : **A→B**

If the stopwatch is stopped : **B**

If the split time is displayed : **B→A→B**



AFTER BATTERY EXCHANGE OR MISHANDLING ONLY

To reset chronograph, minute and second chronograph.

1. Pull the crown in position [1]-(1st click).

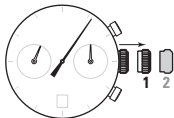

2. Push the button A two times with a time interval of 2s. The hand of counter 9h makes a turn.

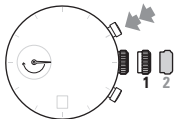

3. Push the button B continually for quick setting and push step by step to adjust the minute hand.

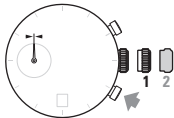

4. Push the button A. The second hand makes a turn.

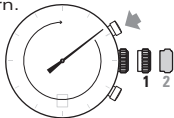

5. Push button B continually for quick setting and push step by step to adjust the second hand.

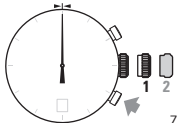

6. Push the crown in position [0] to exit.

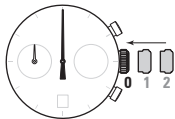

STOPWATCH
HANDS
ZERO POSITIONS

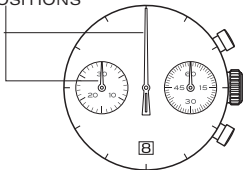

- * Turn slightly the crown. To facilitate the synchronization.

USING THE TACHYMETER

The most common use of a tachymeter is for measuring the approximate speed of a vehicle over a known distance.

(e.g.) Based on how many seconds it takes a vehicle to travel 1km or 1 mile (the available measuring range is up to 60 seconds), the average speed within the distance can be calculated.

1. Start the chronograph when the vehicles commence travel.
2. After the vehicle has travelled 1 km/1mile, stop the chronograph.

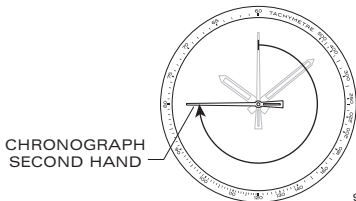

The approximate average speed within the distance can be determined by observing the present position of the second hand and reading the outer bezel.

As shown in the illustration, it takes the vehicle 45 seconds to travel 1km so the approximate average speed is 80kph (50 mph).

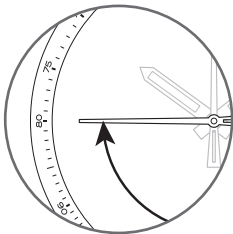

WATER RESISTANCE

The water resistance indicated on your timepiece serves only as a guide. Actual water resistance may vary depending on a number of important factors including temperature, water salinity, and actual use under water.

The water resistance of your timepiece may eventually be compromised over time with general wear and tear and the use of your watch under adverse conditions.

Always remember to employ the screw down crown (if available) to maintain the water resistance of your timepiece. Warranty may be voided if the screw down crown has not been properly employed.

Note that you should NEVER wear your watch in a jacuzzi, hot shower or steam room where steam may enter the case despite the watertight seals used to protect your watch.

The steam may cause condensation inside your watch, which may affect and damage the inner workings of your watch – which would also not be covered by the warranty.

HOW TO CHANGE THE BRACELET TO LEATHER STRAP

1.

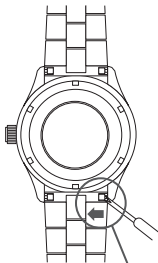

2.

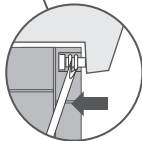
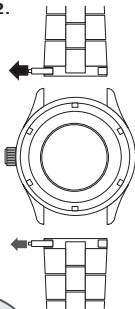

3.

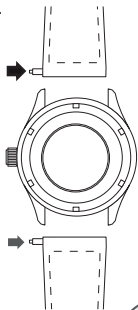

4.

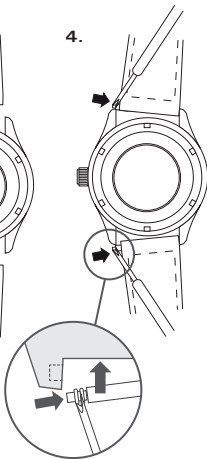

5.

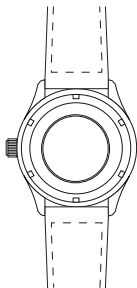

Strap Changing end



HOW TO RESIZE METAL BRACELET

On the inside of the bracelet, you will see some small arrows engraved on removeable links.

1.

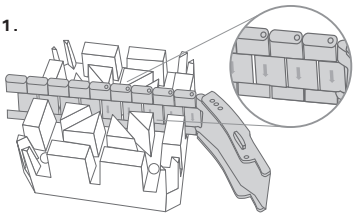

2.

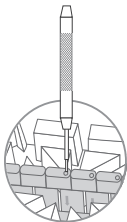

3.

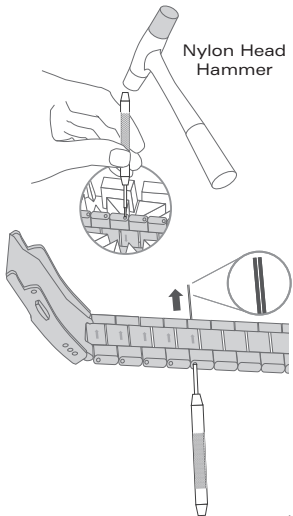

4.

5.

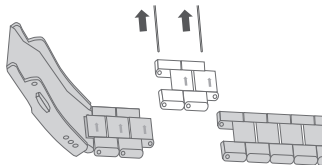

6.

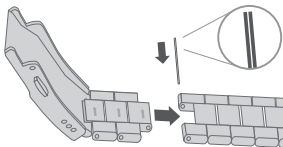

16

7.

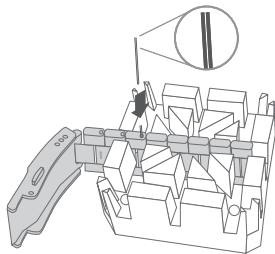

8.

Nylon Head
Hammer

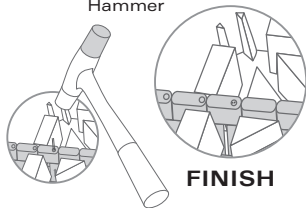

17

9.

Micro size
adjustment

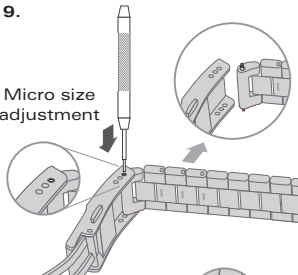

10.

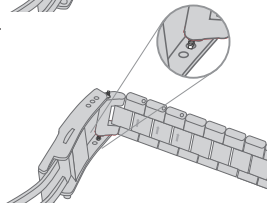

11.

12.

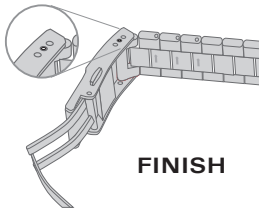
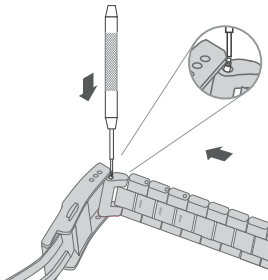

FINISH