

Instruction Manual

C A D O L A
- 1946 -



To ensure correct care, please take some time to review the enclosed instructions to review how to operate your watch.

Vol.1.39 EN

 CADOLA1946

Cadola

COSWORTH

LIMITED EDITION

COSTIN
MECA-QUARTZ

This watch is powered by a Japanese made "Meca-Quartz" movement. It combines a battery regulated engine with a mechanical module. The result is a watch that delivers the meticulous pinpoint precision of a quartz movement along with the smooth sweep seconds hand and visual charm of mechanical watches.

For more details on operating this timepiece please refer to the enclosed booklet or visit :

IM.CADOLA1946.COM

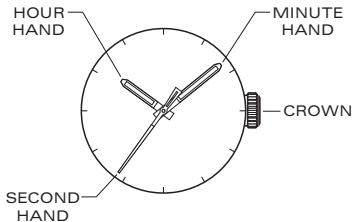

CROWN FOR TURNING
INNER BEZEL

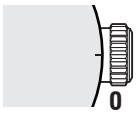

CLOSED:
Pushed back and
Water Resistant

(1st click)



OPENED:
Not secured for
Water Resistance

HOW TO SET THE TIME

1. Put the crown to position [1]-(1st click).
2. Rotating the crown to set the correct time.
3. Push the crown back to position [0].

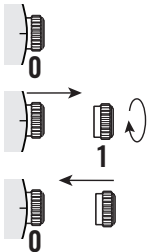

WATER RESISTANCE

The water resistance indicated on your timepiece serves only as a guide. Actual water resistance may vary depending on a number of important factors including temperature, water salinity, and actual use under water.

The water resistance of your timepiece may eventually be compromised over time with general wear and tear and the use of your watch under adverse conditions.

Always remember to employ the screw down crown (if available) to maintain the water resistance of your timepiece. Warranty may be voided if the screw down crown has not been properly employed.

Note that you should NEVER wear your watch in a jacuzzi, hot shower or steam room where steam may enter the case despite the watertight seals used to protect your watch.

The steam may cause condensation inside your watch, which may affect and damage the inner workings of your watch – which would also not be covered by the warranty.

HOW TO CHANGE THE STRAPS TO NATO STRAP

1.

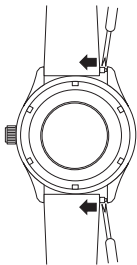

2.

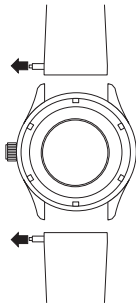

3.

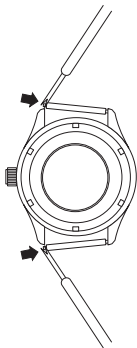

4.

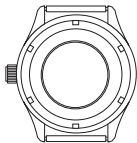

5.

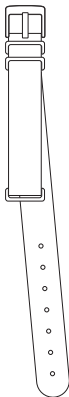

6.

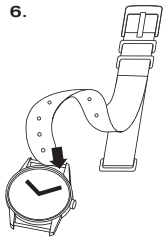

8.

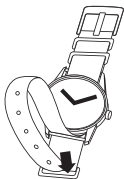

7.

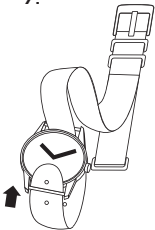

9.



4

HOW TO RESIZE METAL BRACELET

On the inside of the bracelet, you will see some small arrows engraved on removeable links.

1.

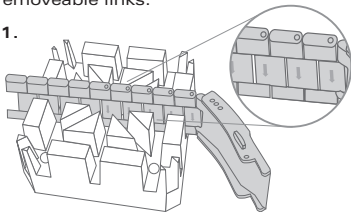

2.

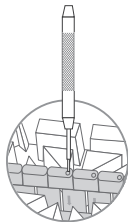

5

3.

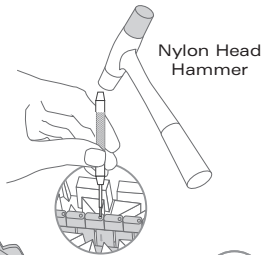

4.

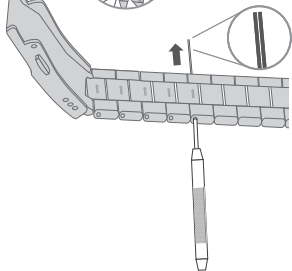

6

5.

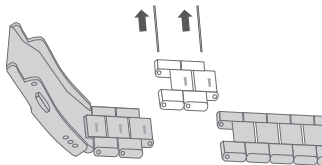

6.

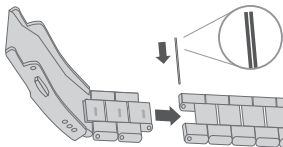

7

7.

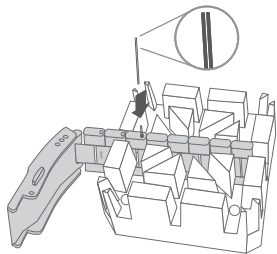

8.

Nylon Head Hammer

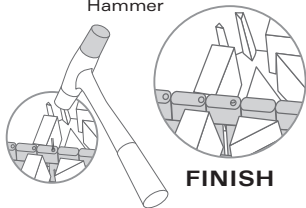

9.

Micro size adjustment

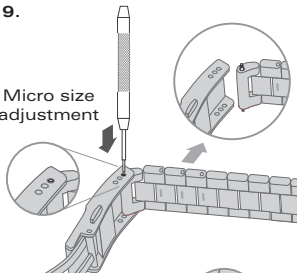

10.

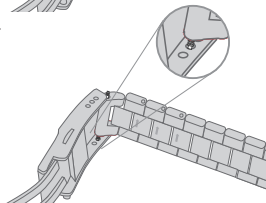

11.

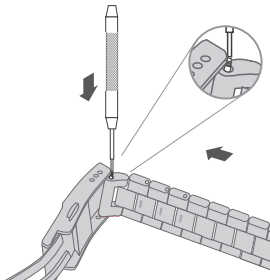

12.

