

Instruction Manual

C A D O L A
- 1 9 4 6 -



To ensure correct care, please take some time to review the enclosed instructions to review how to operate your watch.

Vol.1.27 EN

 CADOLA1946

Cadola

INTERCONTINENTAL
CHRONOGRAPH

CHRONOGRAPH
WATCH

This watch is equipped with a quartz powered chronograph movement.

Besides the normal time read out, this movement enables split timing micro measurements of time at the push of a button, which can be utilized in a variety of applications.

For more details on operating this timepiece please refer to the enclosed booklet or visit :

IM.CADOLA1946.COM

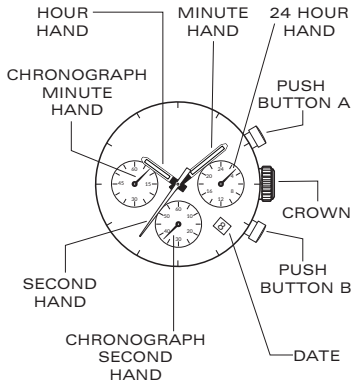

CROWN FOR TURNING
INNER BEZEL

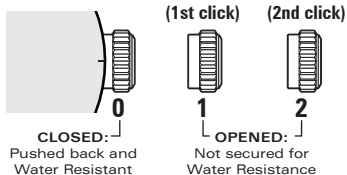

HOW TO SET THE DATE AND TIME

- * Before setting the time, check that the chronograph measurement is stopped.
1. Pull out the crown to the position **[1]**-(**1st click**).
 2. Turn the crown clockwise until the previous day's date appears.
 3. Pull out the crown to the position **[2]**-(**2nd click**) when the second hand is at the 12 o'clock position. It will stop on the spot. Set the hands to the desired time of the day (make sure AM/PM is set correctly) by turning the crown.
- * When the crown is at the position **[2]**-(**2nd click**), do not press any pusher. Otherwise the chronograph hands will move.

4. Push the crown back in the position **[0]** in accordance with a time signal.
- * Do not set the date between 9:00 P.M. and 1:00 A.M. , otherwise the day may not change properly. If it is necessary to set the date during the time period, first change the time to any time outside it, set the date and then reset the correct time.

STOPWATCH FUNCTION

- The measurement of time is indicated by the stopwatch hands that move independently of the center hands and 24-hour hand.
- The stopwatch can measure up to 60 minutes.

STANDARD MEASUREMENT

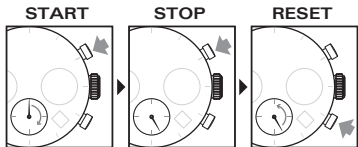

ACCUMULATED ELAPSED TIME MEASUREMENT

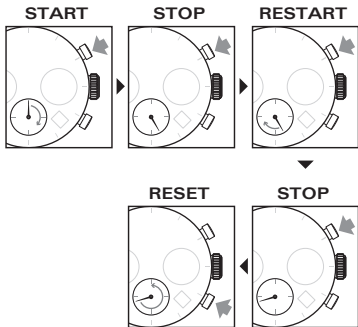

Restart and stop of the stopwatch can be repeated by pressing the button **A**.

SPLIT TIME MEASUREMENT

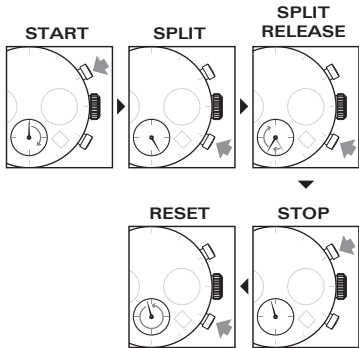

Measurement and release of split time can be repeated as many times as necessary by pressing the button **B**.

ADJUSTING THE STOPWATCH HAND POSITION

- * Before setting the time, check if all the chronograph hands (second, minute) - are at the "0" (12 o'clock) position.
- * If the stopwatch is in use, press the buttons in the following order to reset it, and then, check if the hands return to "0" position.

If the chronograph is counting : **A→B**

If the stopwatch is stopped : **B**

If the split time is displayed : **B→A→B**

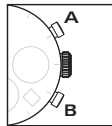

If either of the stopwatch hands are not in the "0" position, reset them following the procedure below.

1. Pull out the crown to the position **[2]**-(**2nd click**).
2. Press button **A** or **B** to reset all stopwatch hands to "0" position.
 - * The stopwatch minute hand moves correspondingly with the stopwatch second hand.
 - * The hands move quickly if the respective buttons are kept pressed.
3. Push the crown back to **[0]** position.

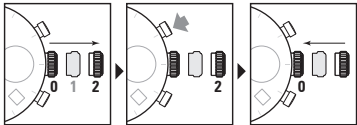

STOPWATCH
HANDS
ZERO POSITIONS

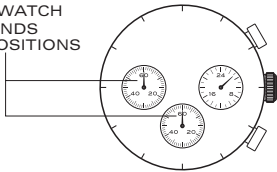

HOW TO READ A SECOND TIME ZONE

Using the bezel of this watch, you can read the time of a second timezone giving you at a glance view of the time in two different places with ease.

For example you live in London and the current time is 2.00 PM.

Knowing that the time in Bangkok is +6 Hours ahead.

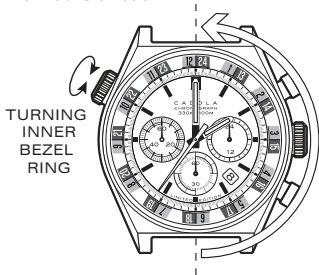

You can simply move the bezel so that the number 6 is aligned to the 12 o'clock position on the dial.



By doing so this gives you the time at a glance in London and in Bangkok with the bezel referencing the time in Bangkok and the hour hand on the main dial positioned at the time London.



WATER RESISTANCE

The water resistance indicated on your timepiece serves only as a guide. Actual water resistance may vary depending on a number of important factors including temperature, water salinity, and actual use under water.

The water resistance of your timepiece may eventually be compromised over time with general wear and tear and the use of your watch under adverse conditions.

Always remember to employ the screw down crown (if available) to maintain the water resistance of your timepiece. Warranty may be voided if the screw down crown has not been properly employed.

Note that you should NEVER wear your watch in a jacuzzi, hot shower or steam room where steam may enter the case despite the watertight seals used to protect your watch.

The steam may cause condensation inside your watch, which may affect and damage the inner workings of your watch – which would also not be covered by the warranty.

HOW TO RESIZE METAL BRACELET

On the inside of the bracelet, you will see some small arrows engraved on removeable links.

1.

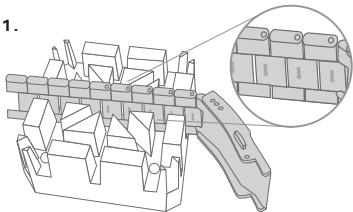

2.

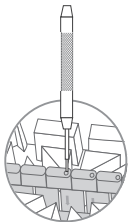

3.

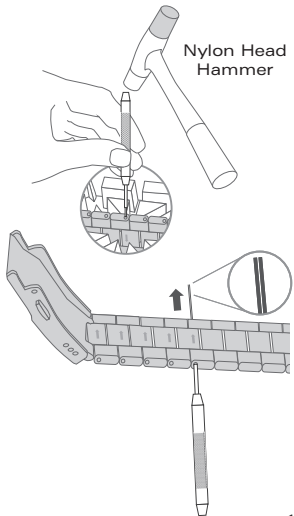

5.

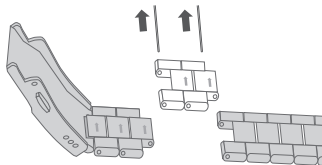

6.

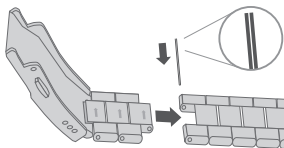

7.

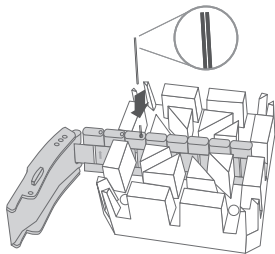

8.

Nylon Head
Hammer

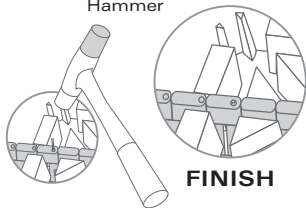

9.

Micro size
adjustment

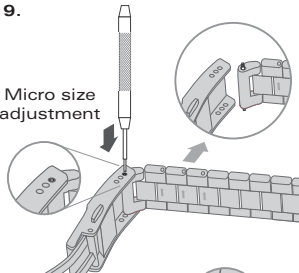

10.

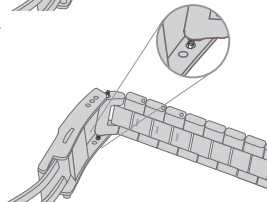

11.

12.

