

Instruction Manual

CADOLA - 1946 -

To ensure correct care, please take some time to review the enclosed instruction to review how to operate your watch.

Vol.1.04 EN  CADOLA1946

Cadola

LAGUNA

For more details on operating this timepiece please refer to the enclosed booklet or visit :

IM.CADOLA1946.COM

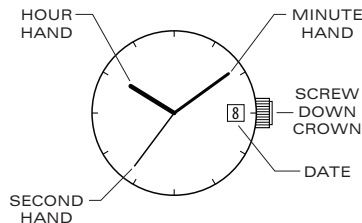

PLEASE READ THE FOLLOWING BEFORE UNSCREWING THE CROWN:

SCREW-DOWN CROWN

Screw-down crowns are used to ensure water resistance. **ALWAYS** be certain that your crown is securely screwed down (Position [0] is secured. Positions [1], [2] and [3] are not secured for water resistance). Do **NOT** unscrew your crown while you are in any environment where moisture is present.

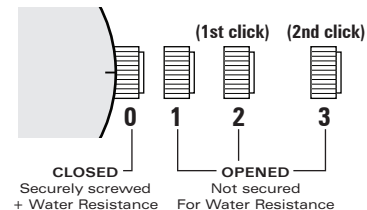

USING THE SCREW-DOWN CROWN

DO NOT PULL THE CROWN UNLESS IT IS UNSCREWED FIRST:

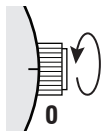

TO UNSCREW:

Turn the crown anti-clockwise until it turns freely without tension. GENTLY pull the crown out to the other desired positions for watch setting (see specific operating instructions on the following pages).

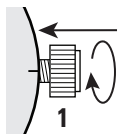

TO SCREW:

Push the crown ALL THE WAY IN (towards the watch) THEN begin to turn clockwise until it is securely screwed down.

NOTE: Failure to SECURELY screw down the crown after setting the watch may affect its water resistance.

2

HOW TO SET THE TIME

1. Unscrew the crown and pull it out to position [3]-(2nd click).
2. Turn the crown anti-clockwise to set the correct time.
3. Push the crown in then screw it securely.

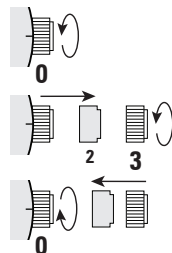

* Take a.m./p.m. into consideration when setting the hour and minute hands to the desired time.

* Always be certain that your crown is SECURELY SCREWED; this will prevent moisture from entering in.

3

HOW TO SET THE DATE

1. Unscrew the crown and pull it out to position [2]-(1st click).
2. Turn the crown counter-clockwise to set the correct date.
3. Push the crown in then screw it securely.

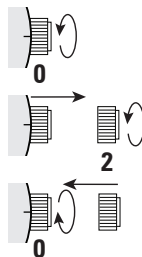

* Do not set the date between 9:00 P.M. and 4:00 A.M.

4

1

WATER RESISTANCE

Note that the water resistance chart serves only as a guide (please refer to the water resistance chart on the next page). Actual water resistance may vary depending on a number of factors including water temperature, water salinity, and use under water.

The water resistance of your timepiece may eventually be compromised over time with general wear and tear and use of your timepiece under adverse conditions.

Always remember to employ the screw down crown if available to maintain the water resistance of your timepiece. Warranty may be voided if the screw down crown has not been properly employed.

Note that you should **never** wear your watch in a jacuzzi, hot shower or steam room where steam may enter the case despite the water tight seals used to protect your watch. This may cause condensation inside your watch which may effect and damage the inner workings of your watch.

WATER RESISTANCE CHART	30M/ 3ATM	50M/ 5ATM	100M/ 10ATM	150M/ 15ATM	200M/ 20ATM
SPLASH/ SHOWERING	☑	☑	☑	☑	☑
SWIMMING/ BATHING	☒	☑	☑	☑	☑
BRIEF SWIMMING/ WATER SPORTS	☒	☒	☑	☑	☑
PROLONGED SWIMMING/ FREE DIVING	☒	☒	☒	☑	☑
SCUBA DIVING	☒	☒	☒	☒	☒
PROFESSIONAL DEEP SEA DIVING	☒	☒	☒	☒	☒