

Instruction Manual

C A D O L A
- 1 9 4 6 -



To ensure correct care, please take some time to review the enclosed instructions to review how to operate your watch.

Vol.1.21 EN

 CADOLA1946

Cadola

NEW CALEDONIA

CHRONOGRAPH WATCH

This watch is equipped with a quartz powered Swiss chronograph movement. Besides the normal time read out, this movement enables split timing micro measurements of time at the push of a button, which can be utilized in a variety of applications.

For more details on operating this timepiece please refer to the enclosed booklet or visit :

IM.CADOLA1946.COM

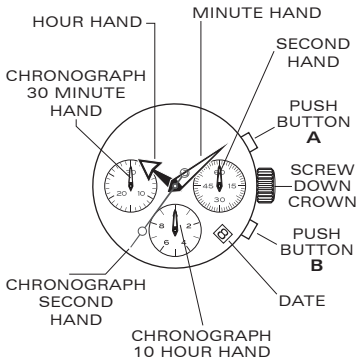

PLEASE READ THE FOLLOWING BEFORE UNSCREWING THE CROWN:

SCREW-DOWN CROWN

Screw-down crowns are used to ensure water resistance. **ALWAYS** be certain that your crown is securely screwed down (Position [0] is secured. Positions [1], [2] and [3] are not secured for water resistance). Do **NOT** unscrew your crown while you are in any environment where moisture is present.

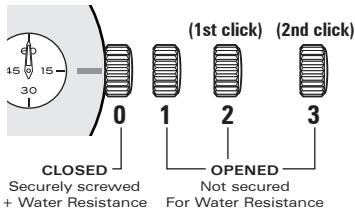

USING THE SCREW-DOWN CROWN

DO **NOT** PULL THE CROWN UNLESS IT IS **UNSCREWED** FIRST:

TO UNSCREW:

Turn the crown anti-clockwise until it turns freely without tension. GENTLY pull the crown out to the other desired positions for watch setting (see specific operating instructions on the following pages).

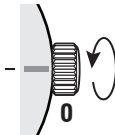

TO SCREW:

Push the crown ALL THE WAY IN (towards the watch) THEN begin to turn clockwise until it is securely screwed down.

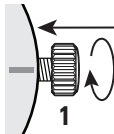

NOTE: Failure to **SECURELY** screw down the crown after setting the watch may affect its water resistance.

HOW TO SET THE DATE AND TIME

- * Before setting the time, check that the chronograph measurement is stopped.
- 1. Pull out the crown to the position **[2]**-(1st click).
- 2. Turn the crown clockwise until the preview day's date appears.
- 3. Pull out the crown to the position **[3]**-(2nd click) when the second hand is at the 12 o'clock position. It will stop on the spot. Set the hands to the desired time of the day (make sure AM/PM is set correctly) by turning the crown.
- * When the crown is at the position **[3]**-(2nd click), do not press any pusher. Otherwise the chronograph hands will move.

4. Push the crown back in the position **[0]** in accordance with a time signal.
- * Do not set the date between 9:00 P.M. and 00:30 A.M. , otherwise the day may not change properly. If it is necessary to set the date during the time period, first change the time to any time outside it, set the date and then reset the correct time.
 - * Always be certain that your crown is **SECURELY SCREWED**; this will prevent moisture from entering in the watch.

STOPWATCH FUNCTION

- The stopwatch can measure up to 10 Hours.

STANDARD MEASUREMENT

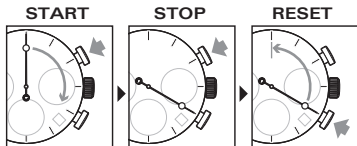

SPLIT TIME MEASUREMENT

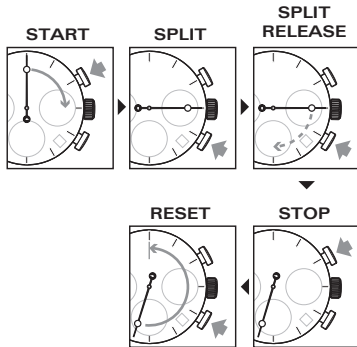

Measurement and release of split time can be repeated as many times as necessary by pressing the button **B**.

ADJUSTING THE STOPWATCH HAND POSITION

- * Before setting the time, check if all the chronograph hands (second, minute) - are at the "0" (12 o'clock) position.
- * If the stopwatch is in use, press the buttons in the following order to reset it, and then, check if the hands return to "0" position.

If the chronograph is counting : **A→B**

If the stopwatch is stopped : **B**

If the split time is displayed : **B→A→B**

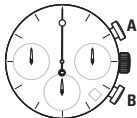

AFTER BATTERY EXCHANGE OR MISHANDLING ONLY

To reset chronograph, minute and second chronograph.

1. Pull the crown in position [2]-(1st click).

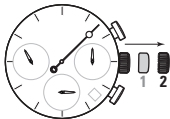

2. Push the button A. The hand of counter 6h makes a turn.

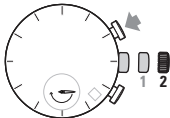

3. Push button B continually for quick setting and push step by step to adjust the hour hand.

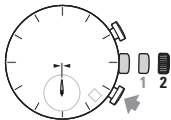

4. Push button A. The hand of counter 9h makes a turn.

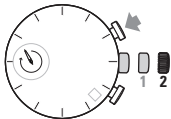

5. Push button B continually for quick setting and push step by step to adjust the minute hand.

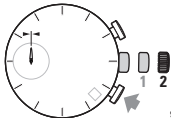

9

6. Push the button A. The second hand makes a turn.

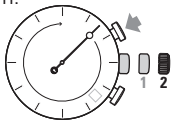

7. Push button B continually for quick setting and push step by step to adjust the second hand.

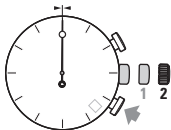

8. Push the crown in position [0] to exit.

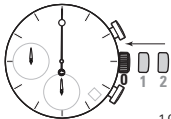

10

STOPWATCH
HANDS
ZERO POSITIONS

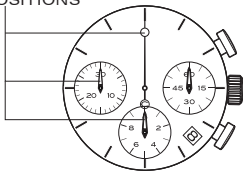

- * Turn slightly the crown. To facilitate the synchronization.

WATER RESISTANCE

The water resistance indicated on your timepiece serves only as a guide. Actual water resistance may vary depending on a number of important factors including temperature, water salinity, and actual use under water.

The water resistance of your timepiece may eventually be compromised over time with general wear and tear and the use of your watch under adverse conditions.

Always remember to employ the screw down crown (if available) to maintain the water resistance of your timepiece. Warranty may be voided if the screw down crown has not been properly employed.

Note that you should NEVER wear your watch in a jacuzzi, hot shower or steam room where steam may enter the case despite the watertight seals used to protect your watch.

The steam may cause condensation inside your watch, which may affect and damage the inner workings of your watch – which would also not be covered by the warranty.