

SPECIFICATIONS

Gogopower

DP250CL5S-AU

SOUND-PROOF TYPE

DIESEL GENERATOR SET

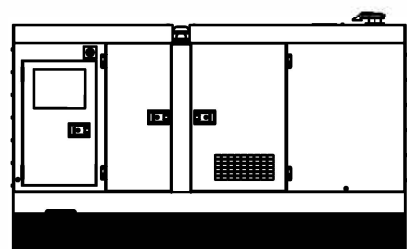

1 Standards & Conditions

Design Standards

The designs and the productions are in conformity with:

- Conformance European (CE)
- China Compulsory Certification (CCC)
- ISO8528-5:2005
- GB/T2820.5-2009
- AS 3000-1997
- AS 3010.1-1988

Environmental Operating Conditions

- Installation place: Outdoors or indoors (well ventilated).
- Ambient temperature: -25°C to 50°C. The coolant heater is needed when the temperature is below 5°C
- Humidity: Less than 90%.
- Altitude: Below one thousand (1000) meters above sea level.

Factory Inspection

- Inspection items.
- Protection devices working test.
- Starting ability in normal temperature.
- 50% rated power load moment capability.
- Voltage deviation and speed variation: 0%, 25%, 50%, 75%, 100%, 110% Load.

Painting Process

- Painting process specifications and colors are based on the manufacturer's standard.
- The customer could also choose the color which the manufacturer offers.

2 General Features

- Cummins engine 6LTAA8.9-G2
- Close coupled to a Stamford alternator UC DI274K
- Microprocessor control module PLC-AMF
- SCHNEIDER main circuit breaker: 400A
- Rotate speed governor: Electrical governor S6700E
- Excitation system: Self excited, SHUNT
- A.V.R model: AS440
- Key switch
- Emergency stop switch

- ATS(automatic transfer switch)receptacle
- Remote run connector
- 2x12V/120AH sealed for life maintenance free battery
- Lockable battery isolator switch
- Powder coated canopy
- 50°C radiator
- Steel base frame with supporting leg
- Vibration isolators between the engine/alternator and base frame
- Dry type air filter
- Base fuel tank for 7 hours running
- Drain points for fuel tank
- Operation Manual / Specifications

3 Equipment Specification

General technical data

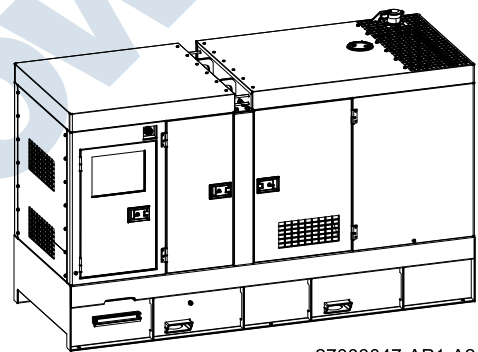

27003047-AP1-A2

Model.....	DP250CL5S-AU
Tank capacity.....	360L
Dry weight.....	2712kg
Sound pressure level @ 7m.....	69dB(A)
Sound power acc. 2000/14/EC.....	96.9dB(A)
Dimensions L×W×H.....	3500×1250×2035mm
Standby Power.....	275kVA/220kW
Prime Power.....	250kVA/200kW

Voltage	380V	400V	415V	440V	
Ampere	379.8	360.9	347.8	328.1	
Genset Fuel Consumption					
Frequency/Load	25%	50%	75%	100%	110%
50Hz (L/h)	15.0	27.0	39.0	53.0	58.0

Diesel Engine

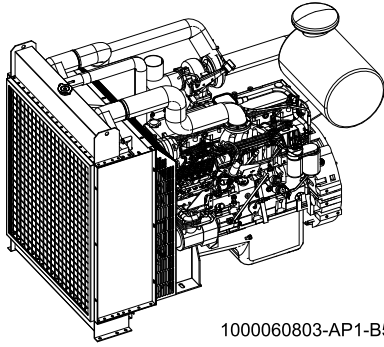

1000060803-AP1-B5

Engine Manufacturer/Brand.....	Cummins
Engine Model.....	6LTAA8.9-G2
Dimensions L×W×H.....	1497.4x936.4x1228.7mm
Dry Weight (approx.)	650kg
Number of Cylinders.....	6
Bore.....	114mm
Stroke.....	145mm
Displacement.....	8.9L
Compression Ratio.....	16.6
Type of injection.....	Direct injection
Intake System.....	Turbocharged, air-to-air charge cooled
Intake Resistance.....	≤6.2kPa
Cooling System.....	Water cooled
Fan.....	Pusher
Battery Voltage.....	12/24V
Type of Fuel.....	Diesel
Type of Oil.....	ACEA E2, API CF, CF-4, CG-4
Oil Capacity.....	27.6L
Type of Coolant.....	Glycol mixture
Coolant Capacity.....	50.3L
Back Pressure.....	≤10.1kPa
Standby Power.....	240kW
Prime Power.....	220kW
Fuel Consumption(100%load).....	197g/kW.h

Alternator

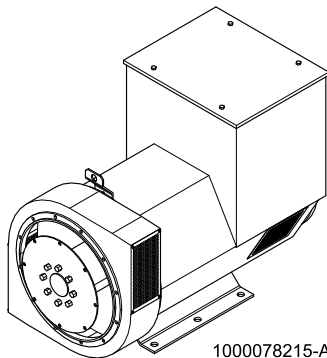

1000078215-AP1-C2

Alternator Manufacturer/Brand.....	Stamford
Alternator Model.....	UCDI274K
Exciter.....	Brushless
Cooling Fan.....	Cast alloy aluminum
Windings.....	100% copper
Insulation Class.....	H
Winding Pitch.....	2/3
Terminals.....	12
Drip Proof.....	IP23
Altitude.....	≤1000m
Overspeed.....	2250rpm
Air Flow.....	0.58m³/s(50Hz),0.69m³/s(60Hz)
Voltage Regulation.....	±1.0%
Total Harmonic TGH / THCat no load < 1.5 % - on load < 5%	
Telephone Interference.....	THF<2%;TIF<50

PLC-AMF Control System

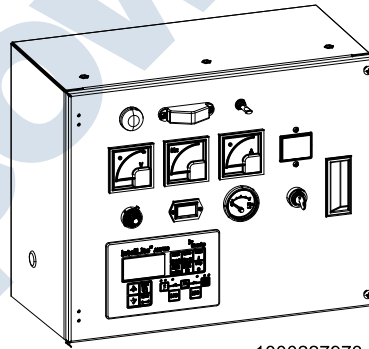

1000227973-AP1-C2

PLC-AMF is an advanced control module based on micro-processor, containing all necessary functions for protection of the genset and the breaker control. It can monitor the mains supply, and automatically start the engine when the mains is abnormal. Accurately measure various operational parameters and display all values and alarms information on the LCD. In addition, the control module can automatically shut down the engine and indicate the engine failure.

- Microprocessor control, with high stability and credibility
- Monitoring and measuring operational parameters of the mains supply and genset
- Indicating operation status, fault conditions, all parameters and alarms
- Multiple protections; multiple parameters display, like pressure, temp. etc.
- Manual, automatic and remote work mode selectable
- Real time clock for time and date display, overall runtime display, 200 log entries
- Overall power output display
- Integral speed/frequency detecting, telling status of start, rated operation, overspeed etc.
- Communication with PC via RS485 OR RS232 interface, using MODBUS protocol

4 Overall Dimensions

27003047-DR1-A2

Dry weight	2712kg
Fuel tank capacity	360L
Dimensions L x W x H	3500×1250×2035mm

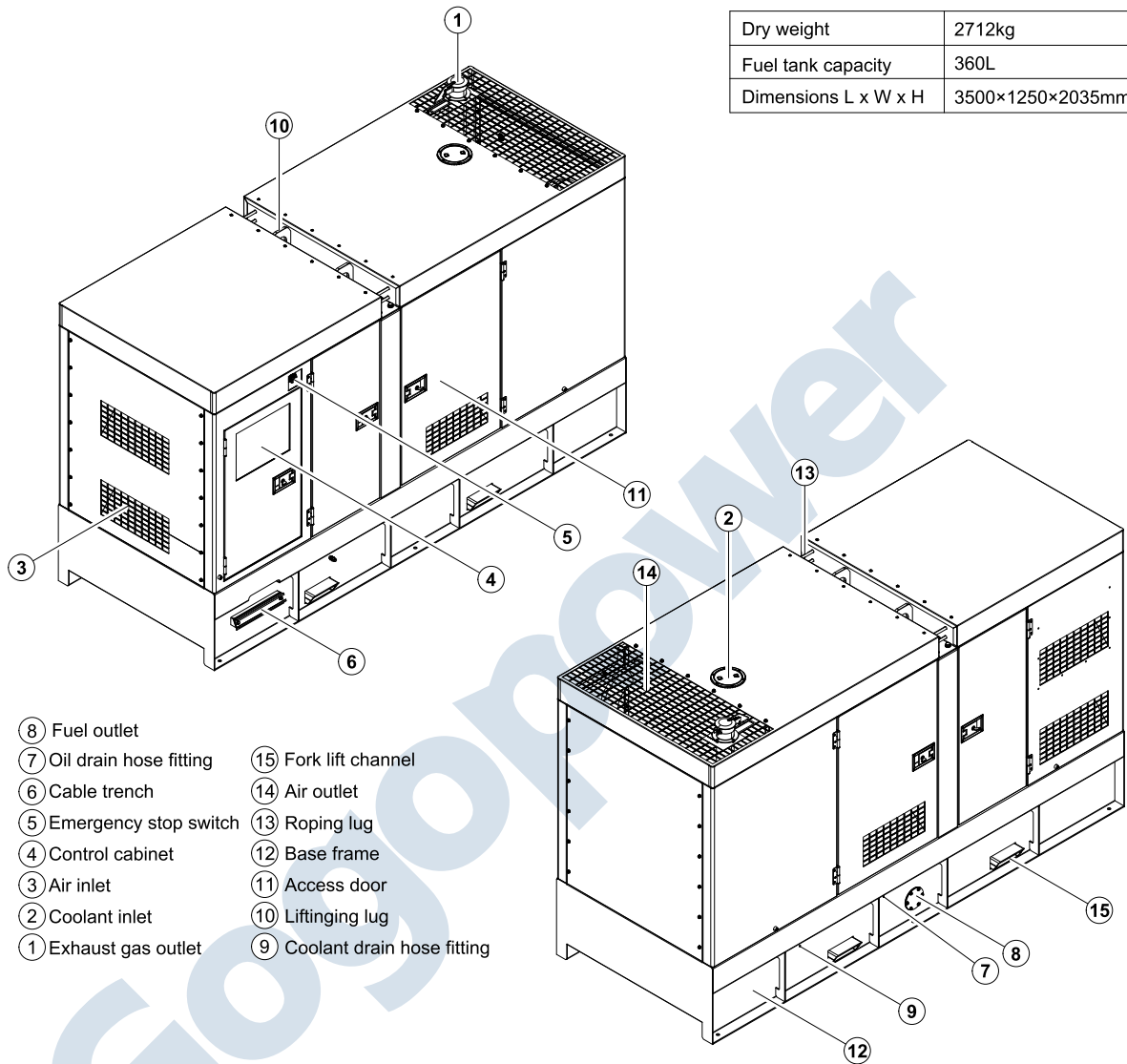

- ⑧ Fuel outlet
- ⑦ Oil drain hose fitting
- ⑥ Cable trench
- ⑤ Emergency stop switch
- ④ Control cabinet
- ③ Air inlet
- ② Coolant inlet
- ① Exhaust gas outlet
- ⑮ Fork lift channel
- ⑭ Air outlet
- ⑬ Roping lug
- ⑫ Base frame
- ⑪ Access door
- ⑩ Lifting lug
- ⑨ Coolant drain hose fitting

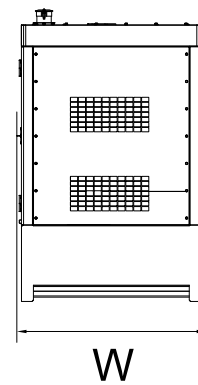
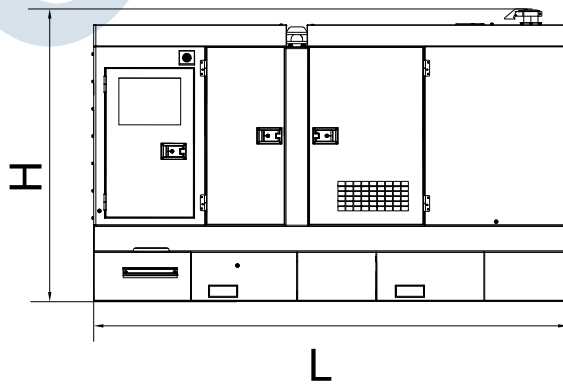

5 Control System

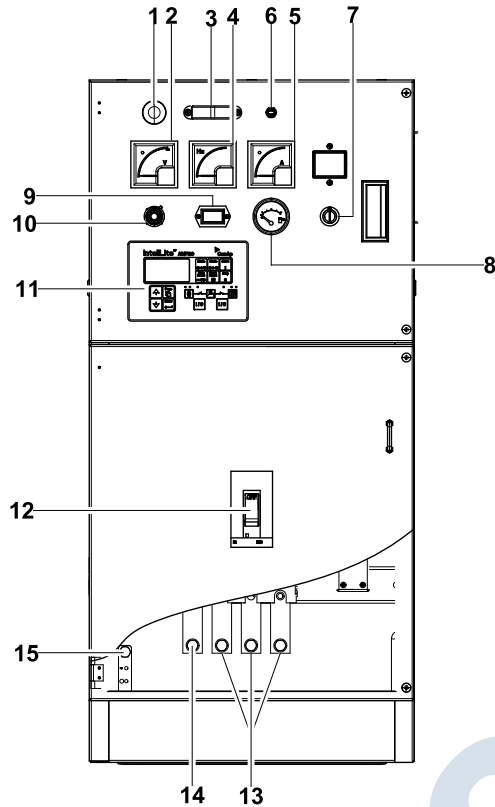

Control & field wiring cabinet

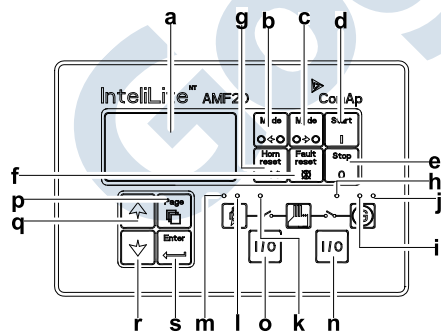

Control module

Ref.	Description
1	Running indicator
2	Voltage meter
3	Control cabinet lamp
4	Frequency meter
5	Current meter
6	Control cabinet lamp switch
7	Key switch
8	Fuel level meter
9	Time counter
10	Voltage adjust knob
11	Control module
12	Main circuit breaker
13	Live wire terminal
14	Neutral wire terminal
15	Ground wire terminal

a	LCD display
b	← Mode
c	Mode →
d	Start (MAN mode)
e	Stop (MAN mode)
f	Fault reset
g	Horn reset
h	GCB on (green LED)
i	GEN voltage present (green LED)
j	Gen-set failure (red LED)
k	MCB on (green LED)
l	Mains failure (red LED)
m	Mains voltage present (green LED)
n	GCB on/off (MAN mode)
o	MCB on/off (MAN mode)
p	Page
q	Up
r	Down
s	Enter

6 Optional Accessories

1. ATS Cabinet

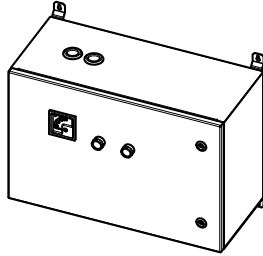

- Adopt advanced ATS with high quality
- High reliability, high stability, ease of operation

2. Automatic Oil Drain Pump

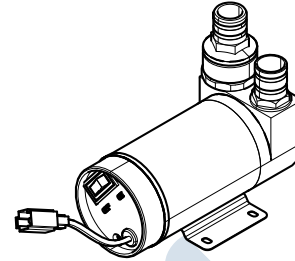

- Drain the oil from engine automatically
- Easy to operate with inching switch

20004002-OA1

3. Battery Charger

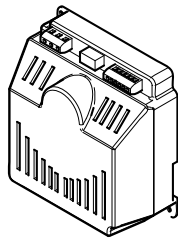

- Switch power supply structure, wide input alternating voltage range, small size, light weight, high efficiency rate
- Short-circuit protection

4. Double Layer Air Filter

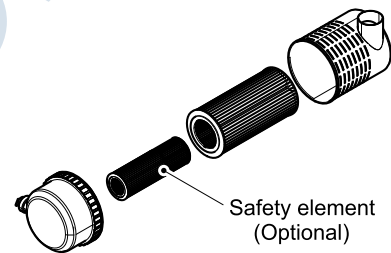

- Air filter with safety element
- High filtration precision and filtering ability

5. Spark Arrestor

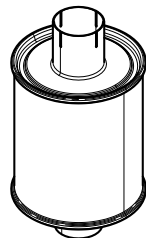

- Any explosive exhaust particles can be captured in dangerous environment.

6. Water Jacket Preheat Unit

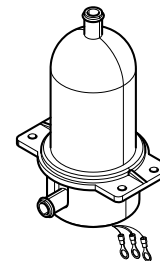

- Water jacket preheat unit should be used to start the engine quickly if the temperature is lower than 5°C
- The preheat unit is equipped with a thermostat

27003047-A2-E

02.2015

www.gogopower.com.au

*Specification may change without prior notice. For more info.,
contact our company or your local distributors please.*