

fold

fold

HELMET INSTRUCTIONS

This helmet you have just purchased provides protection, whether on or off the road. To ensure proper use of this helmet, familiarize yourself with its features, fit and care by carefully reading through this manual before wearing your new helmet.

WARNING

- A.** No helmet can protect the wearer against all possible impacts.
- B.** The helmet is designed to be retained by a strap under the lower jaw.
- C.** To be effective, a helmet must fit and be worn correctly. To check for correct fit, place helmet on head and make any adjustments indicated. Securely fasten retention system. Grasp the helmet and try to rotate it to the front and rear. A correctly fitted helmet should be comfortable and should not move forward to obscure vision or rearward to expose the forehead.
- D.** No attachments should be made to the helmet except those recommended by the helmet manufacturer.
- E.** The helmet is designed to absorb shock by partial destruction of the shell and liner. This damage may not be visible. Therefore, if subjected to a severe blow, the helmet should be destroyed and replaced even if it appears undamaged.
- F.** The helmet may be damaged and rendered ineffective by petroleum and petroleum products, cleaning agents, paints, adhesives and the like, without the damage being visible to the user.
- G.** A helmet has a limited lifespan in use and should be replaced when it shows obvious signs of wear.

H. Warning! This helmet should not be used by children while climbing or doing other activities where there is a risk of hanging or strangulation if the child gets trapped whilst wearing the helmet.

Designed for the use in scooter riding, pedal cycling and skateboarding. NOT intended for use in motor sports or by motor cyclists.

Hazard

Strangulation can occur when children are not riding their bicycles but are wearing helmets and are involved in play indoors or outdoors. (e.g. playing on playground equipment) The helmet may become stuck or entangled on another object which can cause strangulation.

- Teach your children to remove the helmet once they have finished riding and before they start playing or doing anything else.
- Show them where to place the helmet when they're not wearing it. (e.g. On the handle-bar if out playing or in a special place at home)
- Choose a helmet that fits your child properly. It should be comfortable, snug and level on your child's head.
- Make sure the chin strap is securely buckled.

THE PROPER FIT

1. The helmet fits correctly when the pads hold it firmly but comfortably in place.

All fitting adjustments must be made with the helmet in the proper position. Failure to do so will result in a poor fit. This will allow the helmet to move out of position or come off in an accident. For Proper position, please refer to **DIAGRAM A**.

DIAGRAM A



CORRECT

INCORRECT

- 2.** Always wear a helmet low in the front to protect the forehead as in the "correct" example.
- 3.** The front and rear straps should join at a point slightly below and in front of the ears. See **DIAGRAM B**. To adjust the position of the straps hold one end of the buckle in one hand and slide the slide adjuster up or down as necessary with the other hand correctly positioned. To adjust the front and rear strap individually, hold the strap to be adjusted and slide the slide adjuster in the appropriate direction.

DIAGRAM B DIAGRAM C DIAGRAM D

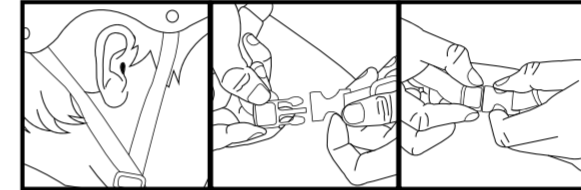

4. Always wear the helmet with the chin strap buckle fastened and the strap pulled tight. Make sure the strap is well back against the throat, not on the point of the chin. Straps worn in the point of the chin increase the chance of the helmet coming off in an accident. See **DIAGRAM C & D** on how to fasten and release the buckle. Make sure the loose end of the strap passes through the rubber "o" ring. If it does not, the strap may slide loose and the helmet can come off accidentally. See **DIAGRAM F**.

DIAGRAM F

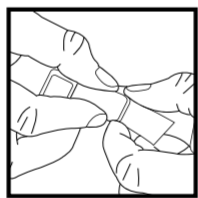

5. Before using the helmet, make sure it fits correctly, the straps are correctly adjusted and the chin strap is tight enough. Put the helmet on in the correct position. Fasten the chin strap and pull it tight.

CHECK THE FIT

Grab the helmet with both hands and twist it to the left and to the right. If the helmet fits right, the skin on the forehead will move as the helmet moves. If it does not, the helmet is too loose. Return to **STEP 1**.

CHECK THE STRAPS

Grab the helmet with both hands and try to move it by rolling the helmet forward and backward as far as you can.

Make a serious effort. If you can roll it off the head completely in either direction, roll it forward so far that it blocks vision or backwards far enough to expose the forehead if it doesn't fit right. Repeat **STEPS 3 & 4** until helmet movement is minimal.

WARNING

If you cannot adjust your helmet to fit as required by **STEP 5**, DO NOT USE THIS HELMET. Replace it with a different size. **6.** Once you are satisfied that the helmet fits correctly and that all the straps are properly adjusted and tightened, take a short ride. Pay attention to overall comfort and helmet stability while riding. Make any minor adjustments to the fit pads and straps to improve the comfort stability.

CLEANING YOUR HELMET

Use only mild soap and warm water to clean the helmet, straps and pads. Do not use chemicals. Do not use solvents, paints and hydrocarbons.

STORING YOUR HELMET

After each use, allow the helmet to air dry and then store in a cool, dry place. Excessive heat can damage the helmet. High temperatures, (above 43°) may distort the outer shell. In direct sunlight, the back ledge of a car, behind rear window and other places that can get hot enough, will get heat damage. Damaged helmets will appear to have uneven or bubbly surfaces. DO NOT USE HEAT DAMAGED HELMETS.

290620



MULTI SPORT HELMET OWNER'S MANUAL

ITEM NO:
211-202 / 211-203 / 211-217 / 211-218
211-220 / 211-221 / 211-223 / 211-224
211-229 / 211-230 / 211-261 / 211-378

INSTRUCTIONS FOR USE AND CARE

READ AND UNDERSTAND THIS ENTIRE MANUAL BEFORE ALLOWING YOUR CHILD TO USE THIS PRODUCT!

WWW.MADDCGEAR.COM

Please retain address information for future use:



MADD GEAR AUSTRALIA
5/4 KIRKHAM ROAD, DANDENONG SOUTH
VIC 3755 AUSTRALIA
EMAIL: SALES@MADDCGEAR.COM

MG DISTRIBUTORS LIMITED (NZ)
147 CAPTAIN SPRINGS ROAD,
ONEHUNGA, AUCKLAND 1061
EMAIL: SALES@MADDCGEAR.COM

MADD GEAR UK & IRELAND
DISTRIBUTED BY J & R SPORTS LIMITED
VESTY BUSINESS PARK, AINTREE,
MERSEYSIDE, L30 1NY, UK
EMAIL: SALESUK@MADDCGEAR.COM
CUSTOMER SERVICE
EMAIL: UKSUPPORT@MADDCGEAR.COM

EC Type examination conducted by:
SGS United Kingdom Ltd, Weston-super-Mare, BS22 6WA, UK.
Notified Body No: 0120

DO NOT PRINT DIE LINES

FRONT COVER

DIMENSION: 260MM W X 184MM H

NOTE: ARTWORK IS TO BE PRINTED FRONT AND BACK

DATE: 29/06/2020 **ARTIST:** DM/CA **VERSION:** 2.290620 - REMOVED REFERENCE TO PADS
ITEM No: 206-688 **BRAND:** MADD GEAR
BUSINESS DOT COM **FILENAME:** MG HELMET INSTRUCTIONS ENGLISH 290620.AI

COLOUR BREAKDOWN:



SUBSTRATE/PACKAGING: INSTRUCTION MANUAL

ARTWORK CHECK: APPROVED:

<input type="checkbox"/> SPELLCHECK/TYPE	<input type="checkbox"/>	GRAPHIC ARTIST
<input type="checkbox"/> LAYERS/ELEMENTS	<input type="checkbox"/>	CREATIVE
<input type="checkbox"/> DIMENSIONS/DIAGRAM	<input type="checkbox"/>	QA
<input type="checkbox"/> CMYK/SPOT COLOURS	<input type="checkbox"/>	



PROOF NO: #2

PRINTOUT SCALE: 90%

No trapping has been applied to this file. Check artwork carefully and apply necessary trapping before proceeding to film. This artwork is to be used in conjunction with the colour printout provided. All queries to be directed to MaddDesign at Madd Gear Australia, prior to the output of separations.

fold

fold

HELMET INSTRUCTIONS

This helmet you have just purchased provides protection, whether on or off the road. To ensure proper use of this helmet, familiarize yourself with its features, fit and care by carefully reading through this manual before wearing your new helmet.

WARNING

- A.** No helmet can protect the wearer against all possible impacts.
- B.** The helmet is designed to be retained by a strap under the lower jaw.
- C.** To be effective, a helmet must fit and be worn correctly. To check for correct fit, place helmet on head and make any adjustments indicated. Securely fasten retention system. Grasp the helmet and try to rotate it to the front and rear. A correctly fitted helmet should be comfortable and should not move forward to obscure vision or rearward to expose the forehead.
- D.** No attachments should be made to the helmet except those recommended by the helmet manufacturer.
- E.** The helmet is designed to absorb shock by partial destruction of the shell and liner. This damage may not be visible. Therefore, if subjected to a severe blow, the helmet should be destroyed and replaced even if it appears undamaged.
- F.** The helmet may be damaged and rendered ineffective by petroleum and petroleum products, cleaning agents, paints, adhesives and the like, without the damage being visible to the user.
- G.** A helmet has a limited lifespan in use and should be replaced when it shows obvious signs of wear.

H. Warning! This helmet should not be used by children while climbing or doing other activities where there is a risk of hanging or strangulation if the child gets trapped whilst wearing the helmet.

Designed for the use in scooter riding, pedal cycling and skateboarding. NOT intended for use in motor sports or by motor cyclists.

Hazard

Strangulation can occur when children are not riding their bicycles but are wearing helmets and are involved in play indoors or outdoors. (e.g. playing on playground equipment) The helmet may become stuck or entangled on another object which can cause strangulation.

- Teach your children to remove the helmet once they have finished riding and before they start playing or doing anything else.
- Show them where to place the helmet when they're not wearing it. (e.g. On the handle-bar if out playing or in a special place at home)
- Choose a helmet that fits your child properly. It should be comfortable, snug and level on your child's head.
- Make sure the chin strap is securely buckled.

THE PROPER FIT

1. The helmet fits correctly when the pads hold it firmly but comfortably in place.

All fitting adjustments must be made with the helmet in the proper position. Failure to do so will result in a poor fit. This will allow the helmet to move out of position or come off in an accident. For Proper position, please refer to **DIAGRAM A**.

DIAGRAM A



CORRECT

INCORRECT

- 2.** Always wear a helmet low in the front to protect the forehead as in the "correct" example.
- 3.** The front and rear straps should join at a point slightly below and in front of the ears. See **DIAGRAM B**. To adjust the position of the straps hold one end of the buckle in one hand and slide the slide adjuster up or down as necessary with the other hand correctly positioned. To adjust the front and rear strap individually, hold the strap to be adjusted and slide the slide adjuster in the appropriate direction.

DIAGRAM B DIAGRAM C DIAGRAM D

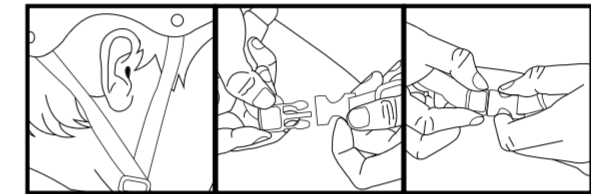

4. Always wear the helmet with the chin strap buckle fastened and the strap pulled tight. Make sure the strap is well back against the throat, not on the point of the chin. Straps worn in the point of the chin increase the chance of the helmet coming off in an accident. See **DIAGRAM C & D** on how to fasten and release the buckle. Make sure the loose end of the strap passes through the rubber "o" ring. If it does not, the strap may slide loose and the helmet can come off accidentally. See **DIAGRAM F**.

DIAGRAM F

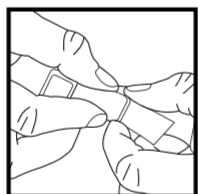

5. Before using the helmet, make sure it fits correctly, the straps are correctly adjusted and the chin strap is tight enough. Put the helmet on in the correct position. Fasten the chin strap and pull it tight.

CHECK THE FIT

Grab the helmet with both hands and twist it to the left and to the right. If the helmet fits right, the skin on the forehead will move as the helmet moves. If it does not, the helmet is too loose. Return to **STEP 1**.

CHECK THE STRAPS

Grab the helmet with both hands and try to move it by rolling the helmet forward and backward as far as you can.

Make a serious effort. If you can roll it off the head completely in either direction, roll it forward so far that it blocks vision or backwards far enough to expose the forehead if it doesn't fit right. Repeat **STEPS 3 & 4** until helmet movement is minimal.

WARNING

If you cannot adjust your helmet to fit as required by **STEP 5**, DO NOT USE THIS HELMET. Replace it with a different size. **6.** Once you are satisfied that the helmet fits correctly and that all the straps are properly adjusted and tightened, take a short ride. Pay attention to overall comfort and helmet stability while riding. Make any minor adjustments to the fit pads and straps to improve the comfort stability.

CLEANING YOUR HELMET

Use only mild soap and warm water to clean the helmet, straps and pads. Do not use chemicals. Do not use solvents, paints and hydrocarbons.

STORING YOUR HELMET

After each use, allow the helmet to air dry and then store in a cool, dry place. Excessive heat can damage the helmet. High temperatures, (above 43°) may distort the outer shell. In direct sunlight, the back ledge of a car, behind rear window and other places that can get hot enough, will get heat damage. Damaged helmets will appear to have uneven or bubbly surfaces. DO NOT USE HEAT DAMAGED HELMETS.

290620



MULTI SPORT HELMET OWNER'S MANUAL

ITEM NO:

- 211-202 / 211-203 / 211-217 / 211-218
- 211-220 / 211-221 / 211-223 / 211-224
- 211-229 / 211-230 / 211-261 / 211-378

INSTRUCTIONS FOR USE AND CARE

READ AND UNDERSTAND THIS ENTIRE MANUAL BEFORE ALLOWING YOUR CHILD TO USE THIS PRODUCT!

WWW.MADDCON.COM

Please retain address information for future use:



MADD GEAR AUSTRALIA
5/4 KIRKHAM ROAD, DANDENONG SOUTH
VIC 3755 AUSTRALIA
EMAIL: SALES@MADDCON.COM

MADD GEAR LLC USA
5780 WEST OAKLAND STREET,
CHANDLER, AZ 85226 USA
EMAIL: SALES@MADDCON.COM

MADD EUROPE GMBH
DISTRIBUTED BY SKATEAU SPORTS
PRODUCTION GMBH
VON-SEVERN-STRASSE 2,
53773 HENNEF, GERMANY
EMAIL: SALES@MADDCON.COM

MADD GEAR UK & IRELAND
DISTRIBUTED BY J & R SPORTS LIMITED
VESTY BUSINESS PARK, AINTREE,
MERSEYSIDE, L30 1NY, UK
EMAIL: SALESUK@MADDCON.COM
CUSTOMER SERVICE
EMAIL: UKSUPPORT@MADDCON.COM

EC Type examination conducted by:
SGS United Kingdom Ltd, Weston-super-Mare, BS22 6WA, UK.
Notified Body No: 0120

DO NOT PRINT DIE LINES

FRONT COVER

DIMENSION: 260MM W X 184MM H

NOTE: ARTWORK IS TO BE PRINTED FRONT AND BACK

DATE: 29/06/2020	ARTIST: DM/CA	VERSION: 2.290620 - REMOVED REFERENCE TO PADS	COLOUR BREAKDOWN:	ARTWORK CHECK:	APPROVED:	<p>PROOF NO: #2</p> <p>PRINTOUT SCALE: 90%</p>
ITEM No: 206-688	BRAND: MADD GEAR			<input type="checkbox"/> SPELLCHECK/TYPE	<input type="checkbox"/> GRAPHIC ARTIST	
BUSINESS DOT COM	FILENAME: MG HELMET INSTRUCTIONS ENGLISH 290620.AI			<input type="checkbox"/> LAYERS/ELEMENTS	<input type="checkbox"/> CREATIVE	
<small>No trapping has been applied to this file. Check artwork carefully and apply necessary trapping before proceeding to film. This artwork is to be used in conjunction with the colour printout provided. All queries to be directed to MaddDesign at Madd Gear Australia, prior to the output of separations.</small>			SUBSTRATE/PACKAGING: INSTRUCTION MANUAL	<input type="checkbox"/> DIMENSIONS/DIAGRAM	<input type="checkbox"/> QA	
				<input type="checkbox"/> CMYK/SPOT COLOURS	<input type="checkbox"/>	