

THE SWING[®]

The World's Best Cane for Stability.



SWING FOOT REPLACEMENT

PART IDENTIFICATION

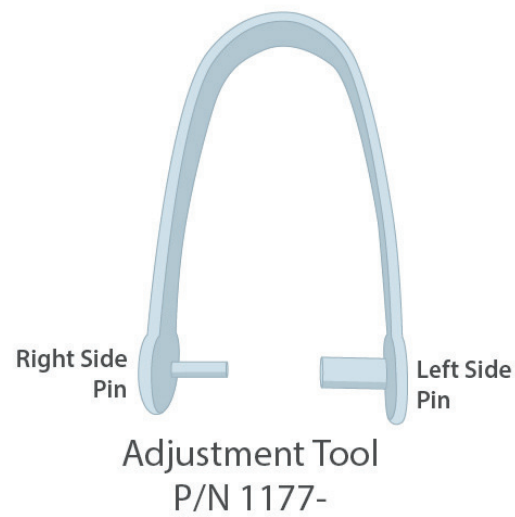

INSTRUCTIONS FOR REMOVING THE FOOT:

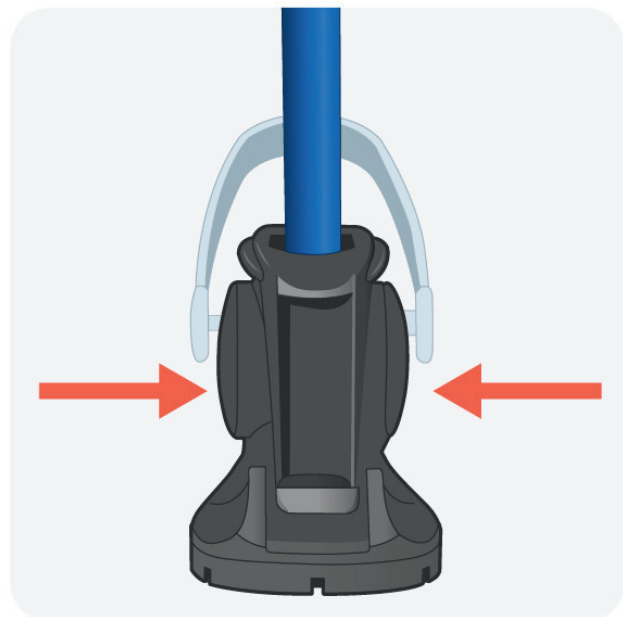

STEP 1

Place the Adjustment Tool into the appropriate holes on the left and right side of the Foot and push in until it is secure.



STEP 2

a) Squeeze both sides of Adjustment Tool while b) pulling the foot away from the base of the cane.

INSTRUCTIONS FOR INSERTING A NEW FOOT:



STEP 1

Remove Hub from the original foot (located on left side of foot with large diameter hole). To remove: Reach into top of foot and push hub out. To insert: Line up the hub so that the cut out faces the top of the foot and gently slide into place.

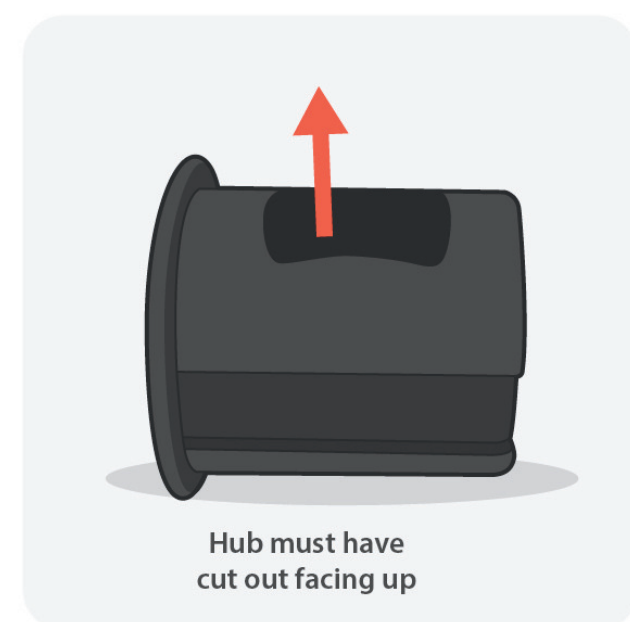

Hub must have cut out facing up



STEP 2

Place the base of the cane into the notch of the foot.

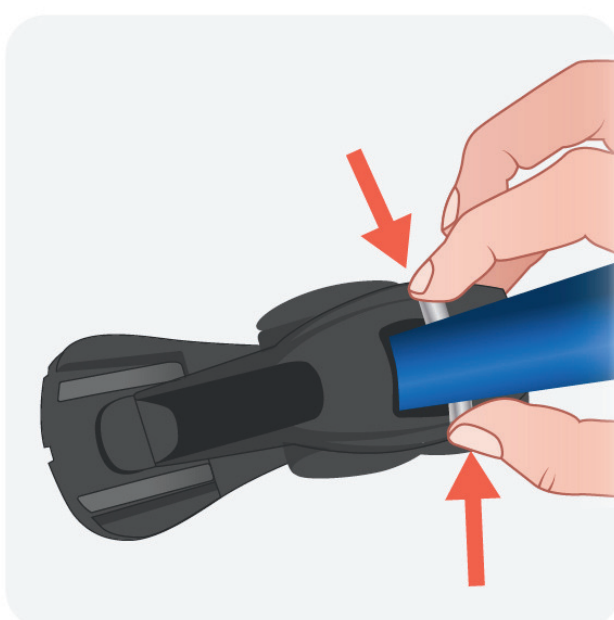

STEP 3

Squeeze the locking clips on both sides and push the cane into the foot until you hear the locking clips "click" into a secure position.

QUESTIONS?

Email us at:
Questions@dynamome.com

Or visit us at:
dynamome.com