



BARRIERS BY **RAYDOOR**[®]

Aesthetic Solutions For Social Distancing

Our new barrier solutions build on Raydoor's 20 years of experience dividing spaces in highly aesthetic ways that maintain light. What began as a flexible solution for privacy in open-plan living areas can now be utilized to protect those working at stations and customers approaching counters in retail, commercial and hospitality settings.

A return to public spaces and places of work will require protection for employees, guests, and customers, but protection shouldn't come at the cost of good design. Barriers by Raydoor come in a variety of styles and configurations from floor standing to work-surface mounted and they are quick to install, easy to clean. Add beauty and function while safeguarding the occupants of your space.



PRODUCT OVERVIEW

Raydoor Barrier comes in a variety of styles and configurations from floor standing to work-surface mounted and are quick to install and easy to clean. Raydoor's new Barrier takes a necessity for current times and makes an aesthetically pleasing solution that is highly effective in protecting employees and customers

Perimeter Series

A fully framed panel for floor-standing or work surface applications. Strong yet light and easy to customize so it can suit any space.

Base Frame Series

This barely-there aesthetic provides the protection you need while being minimally intrusive. Its lightweight design does not compromise coverage.

Side Frame Series

Simple, elegant and sturdy, this versatile partition can be had with or without a pass through for various transactions. Put multiple panels together to create stations or a continuous run.

ABOUT OUR FRAME SIZES

125 Frame

Our thin 125 frame has a 1-1/4" face to minimize obstruction and to provide a lightweight structure. Ideal for work surface mounted Raydoor Barriers.

300 Frame

Our 300 frame has a 3" frame for a strong and durable barrier in heavy-use or floor standing applications



TYPICAL USAGE

Raydoor Barriers can be specified to work in a broad variety of applications, from office to retail settings, and hospitality to residential lobbies. Our guide below outlines common interaction scenarios in a variety of settings to help you understand some of the considerations in selecting the right Barrier for your project.

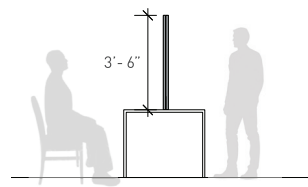

Seated to Standing

Help Desks

Reception Areas

Allows coverage for a person walking up to someone's workspace

Can be specified w/ pass-through

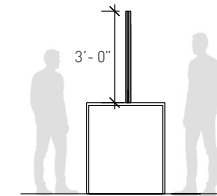

Standing to Standing

Doorman or Concierge station

Cashier

Check-out

Can be specified w/ pass-through

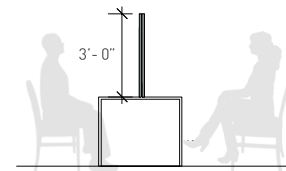

Seated to Seated

Conference tables

Shared workspaces

Consultation areas

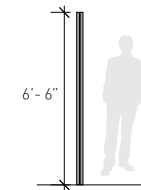

Floor Standing

Foot traffic divider

Entrance / exit control

Waiting rooms

PERIMETER FRAME



Our Perimeter Frame Barriers are perfect for larger panels whether they are standing on a floor or sitting on a counter or work-surface. The frames are offered in several premium finishes including stained or clear-coated veneer and high-quality laminates. Choose our 125 frame for a lighter, less obstructive look and our 300 frame for extra strength

Ideal for seating areas that also have people walking through
Guiding people through lobbies or other semi-public spaces
Longer dividers for large conference tables

Series 125*

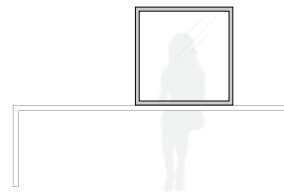

36 x 36

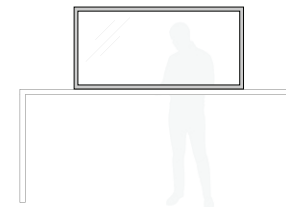

30 x 60



84 x 36

Series 300*



60 x 60



60 x 96



84 x 60

* Common sizes shown, all barriers are made to order

SIDE FRAME



Raydoor Side Frame Barriers offer a middle ground between strength and rigidity and a lighter visual presence. They can be used for floor standing or work surface and counter applications. Side Frame Barriers can pair with partially concealed mounts to maintain that light visual presence - especially important for settings like reception desks.

Ideal for scenarios where you must communicate across a barrier

Adds the warmth of our frame finishes for a less clinical, premium appearance

Possibly the most versatile of our barrier offerings.

Series 125*

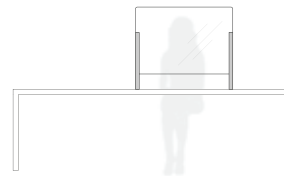

30 x 36

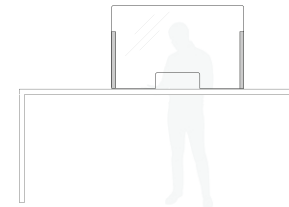

30 x 48"

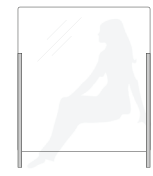

60 x 48

Series 300*

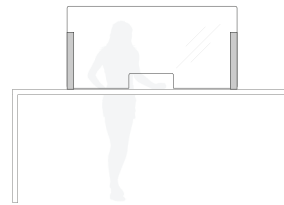

30 x 60



60 x 72

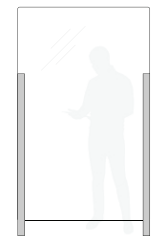

84 x 48

* Common sizes shown, all barriers are made to order

BASE FRAME



Our most minimal barrier, the Base Frame is an ideal solution for restaurants, bars or any shared surface. Simple to install and less expensive, the Base Frame Barrier by Raydoor can quickly and easily address your needs for separation and protection.

Great as a screen/guard at computer workstations

With Clear acrylic it allows for face-to-face consultations at desks or tables

Arrange them in various configurations for multiple stations or longer runs

Series 125*

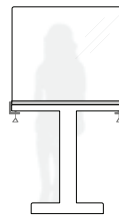

36 x 36

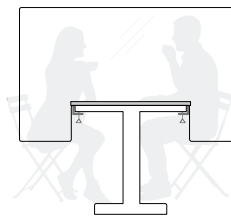

48 x 72

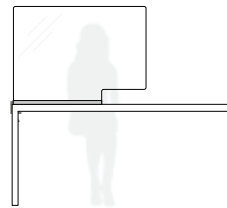

36 x 48

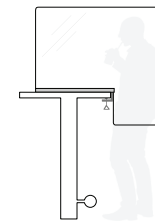

42 x 48

Frame Detail



* Common sizes shown, all barriers are made to order

PRODUCT OPTIONS

Raydoor's new Barrier takes a necessity for current times and makes an aesthetically pleasing solution that is highly effective in protecting employees and customers. Below are a few of the options available to tailor a Barrier to your space or project.

Inserts

Translucent



Opal

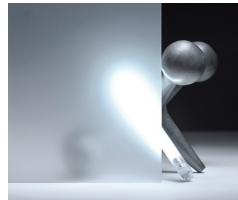

Cloud



Transparent

Frames

Laminate



Sierra White



Timber



Brushed Steel

Veneer



Coffee Wood



Rift Oak



Walnut

Mounting Options



Delta Stand

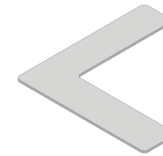

"L" Base

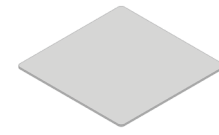

Square Base

Pass Through Options

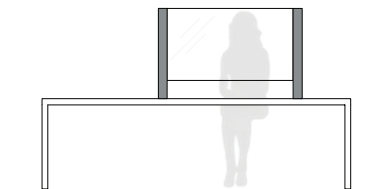

6" Lift

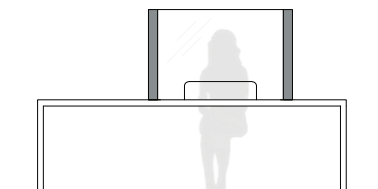

6" x 18"

Looking for more? Check out raydoor.com for full list of product options

WHERE TO START

Finding the right solution for your project with the Raydoor Barrier is simple.

First you'll need to consider how it will be used - to separate two seated people? A seated and a standing person? People walking past one another?

Once you've examined the setting you'll need to determine what size you need i.e the entire width of a desk and from desk height to above user's heads. Then you'll select what frame style suits best - something lighter for small, less obstructive scenarios like reception desks or larger and stronger frames for something like a freestanding Barriers in a high-traffic area.

Selecting your finishes and other option will be the final touch in making something that specifically address the needs of your space. Last but not least, contact us and we will be happy to give you a quote and even guide you through some considerations to find the best solution for your project.

For more on all of our products visit: raydoor.com
Follow us on social media for our latest updates.



STEP 1 - How will it be used?

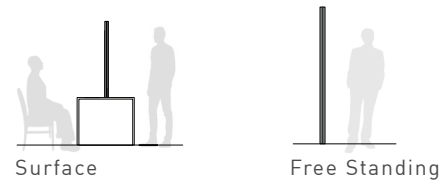

STEP 2 - Determine barrier size

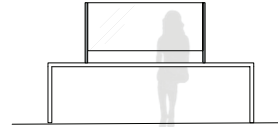

STEP 3 - Choose your style

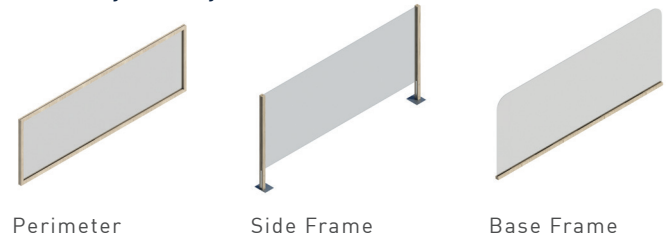

STEP 4 - Pick Options



STEP 5 - Contact Us!

Give us a call or request a quote online to receive a no-obligation price quote:

(212) 421-0641 info@raydoor.com