



User Manual

Briiv 2/Briiv 2 Pro

Product ID: BR04-000-01-A
 BR04-000-01-C
 BR04-000-01-G
 BR04-000-01-(X)



Contents:

| | |
|---|-----------|
| Setting Up for the First Time | 4 |
| Alternate Power Sources | 5 |
| Basic Operation | 5 |
| Controlling The Speed | 6 |
| 1 Hour Filter Cycle | 7 |
| Turning on the Air Sensor Indicator – For Briiv 2 Pro Only | 7 |
| Adjusting Automatic Activation Mode | 8 |
| Changing the Moss & Coconut | 9 |
| Changing the Nano Matrix Filter | 10 |
| Filter variants | 11 |
| Washing Yorkshire Moss | 12 |
| Connecting to Wi-Fi | 13 |
| Can I use Briiv 2 without Wi-Fi? | 13 |
| Get The App | 14 |
| Placement | 14 |
| Run Time | 14 |
| When To Use | 14 |
| Time to Cycle the Air in a Room Comparison Table | 15 |
| Build an Air Quality System | 16 |
| Add Fragrance | 18 |

| | |
|---------------------------------------|-----------|
| Adding a Fragrance | 18 |
| Changing the Fragrance Bud | 18 |
| Cleaning the Fragrance Chamber | 19 |
| Briiv Support | 19 |
| Maintenance Advice | 19 |
| General Safe Usage | 20 |
| FAQs | 20 |
| Important Safety Instructions | 21 |
| Troubleshooting Tips | 22 |
| Warranty | 23 |

Setting Up for the First Time

1. Unbox your Briiv 2 Air Purifier.
2. Remove the bag of moss from the top of Briiv 2.
3. Remove and read the information disc from under the glass ensuring the filter is not obstructed, then replace the glass.
4. Open the bag of moss.
5. Remove the moss and gently place evenly within the glass portion of Briiv 2.
6. Connect Briiv 2 to a USB power supply.

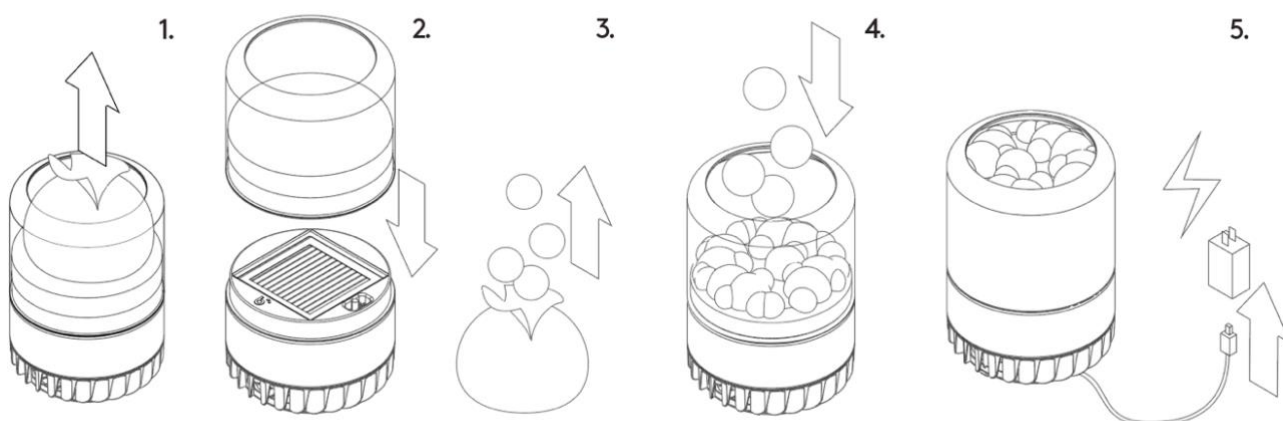

Alternate Power Sources

Briiv 2 can be connected to a mains power supply, but its low power consumption means it does not need a mains outlet to operate.

Briiv 2 can be powered by:

- Laptops
- PC's
- Portable battery packs or chargers

Briiv 2 does not contain an internal battery and must be connected to a power source to function.

Basic Operation

Briiv 2 operates with a touch-sensitive interface.

1. The front of the unit is directly opposite the cable connection.

United Kingdom contact for regulatory topics only:

FIVE Create Ltd, Unit 5, Armley Nano Park, Leeds, West Yorkshire, LS12 2BJ, UK

2. Touch the fabric panel on the front of Briiv 2 to wake it up. The lights will be white.

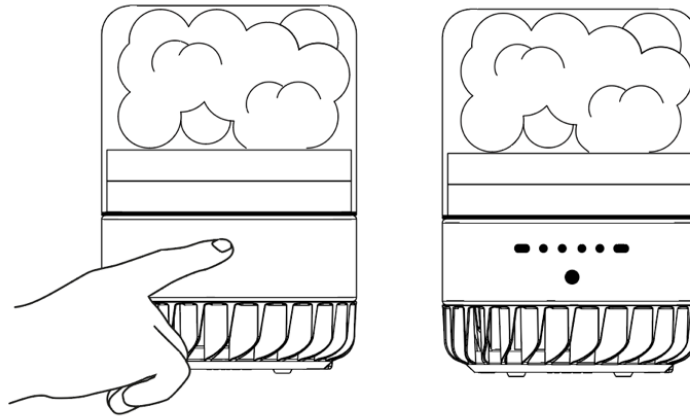

Controlling The Speed

Briiv 2 has four speed settings to control the clean air delivery rate you wish to achieve.

Using the interface select the speed you wish Briiv 2 to run at, indicated by the central four white dots.

The oval dots on the right and left control the speed up and down. Pressing the right-hand dot will increase the fan speed, and the left-hand dot will decrease the fan speed until it is off.

The number of illuminated central dots show the unit's current speed.

The speed can also be controlled via the Briiv 2.0 App.

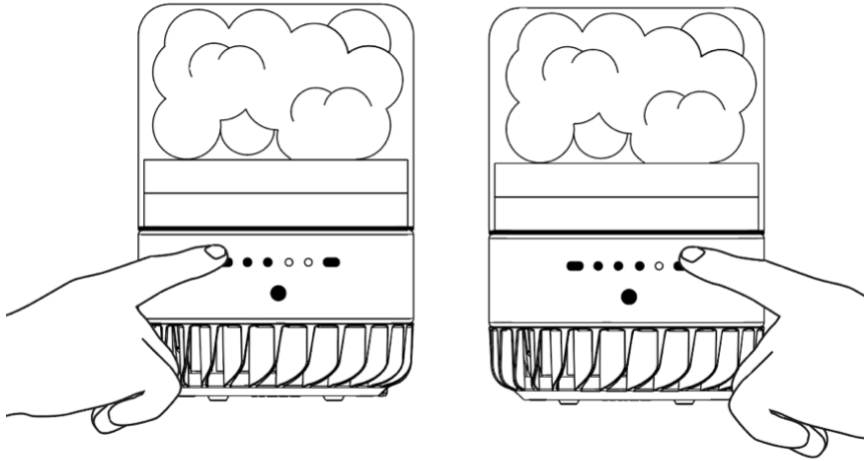

1 Hour Filter Cycle

Briiv 2's 1 Hour Filter Cycle allows you to set the unit running on maximum speed for one hour before it automatically returns to its prior setting.

To activate the 1 Hour Filter Cycle, touch the large dot below the speed indicator dots.

Once activated, Briiv 2 will run at full speed for one hour and then return to its previous setting.

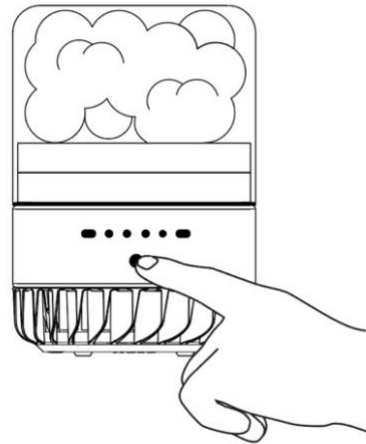

Turning on the Air Sensor Indicator – For Briiv 2 Pro Only

The air sensor indicator will show how clean the air around your unit is based on the particulate matter in the air.

Touch the front area of Briiv 2 Pro to wake it up.

On the lit display, use two fingers and hold down both oval lights at the same time.

After a few seconds, the display will change to a colour display.

Under the line of dots there will be a bigger dot in red or green.

Touch this dot to change between the two settings:

- Green = Air Quality Indicator always on
- Red = Air Quality Indicator always off

Once selected leave the display by letting your Briiv 2 Pro go to sleep, and your selection will be saved. You do not need to press any buttons to save the selection.

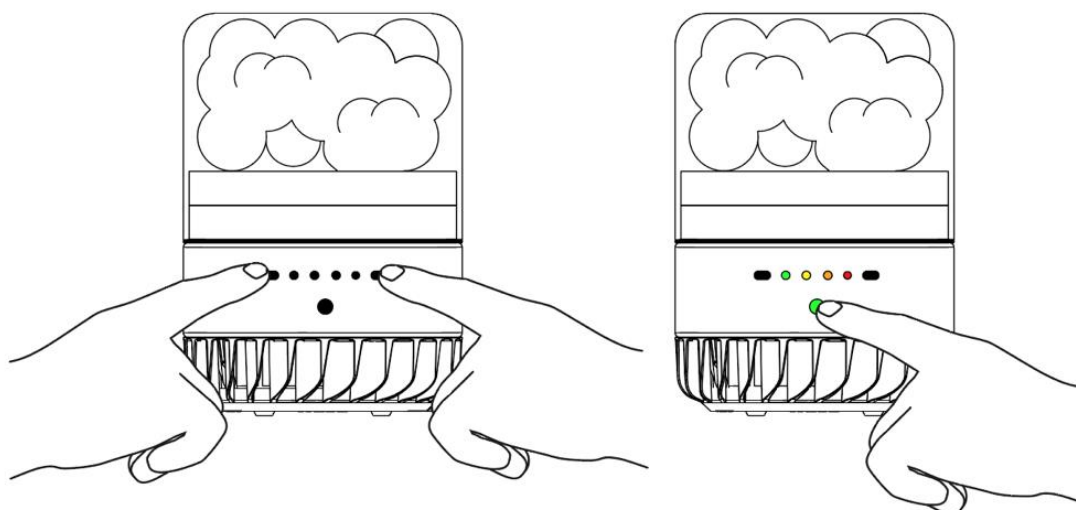

Adjusting Automatic Activation Mode

Briiv 2 Pro will automatically activate when poor air quality is detected. You can change the sensitivity of when the unit activates in the app and on the unit.

To change the air quality sensitivity on the unit touch the front area of Briiv 2 Pro to wake it up.

On the lit display, use two fingers and hold down both the oval lights at the same time.

After a few seconds, the display will change to a colour display.

The central four dots are used to set the sensitivity using the oval lights at each end, with the right oval moving the selection up and the left oval moving the selection down.

The colour of the dot represents the standard air quality index:

- Green = 0-50 ppm
- Yellow = 51-100 ppm
- Orange = 101-150 ppm
- Red = 151+ ppm

The selection will flash as it is moved.

Once selected leave the display by letting your Briiv 2 Pro go to sleep, and your selection will be saved. You do not need to press any buttons to save the selection.

If you select orange, the Briiv 2 Pro will activate when the air quality 101-150 ppm. When the air quality improves, the Air Quality Indicator light will change colour. When the light is green, your air is clean.

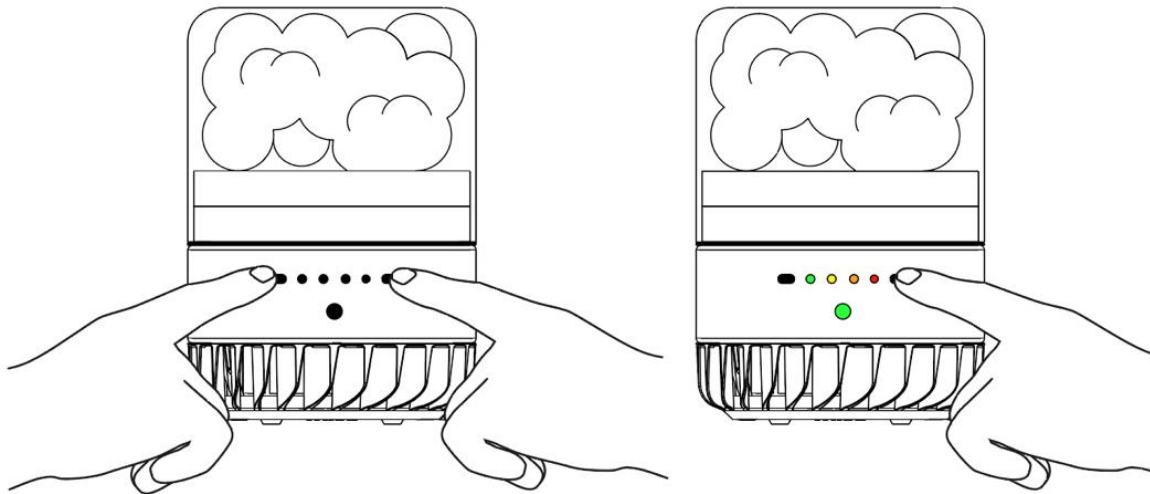

Changing the Moss & Coconut

1. Carefully lift the glass of Briiv 2 upward and set safely to one side.
2. Push the moss & coconut filters from the top down and out of the glass.
3. Place the new coconut filter on a flat surface. Place the glass on top of the new coconut filter so it fits inside.
4. Once the coconut is in place, you can insert your new moss filter inside of the glass. Evenly place the moss in the glass, being careful not to damage the moss.
5. Replace the glass piece on top of the Briiv 2 base unit gently, making sure to align with the base so the glass piece is secure.

6. The old moss and coconut filters can be composted.

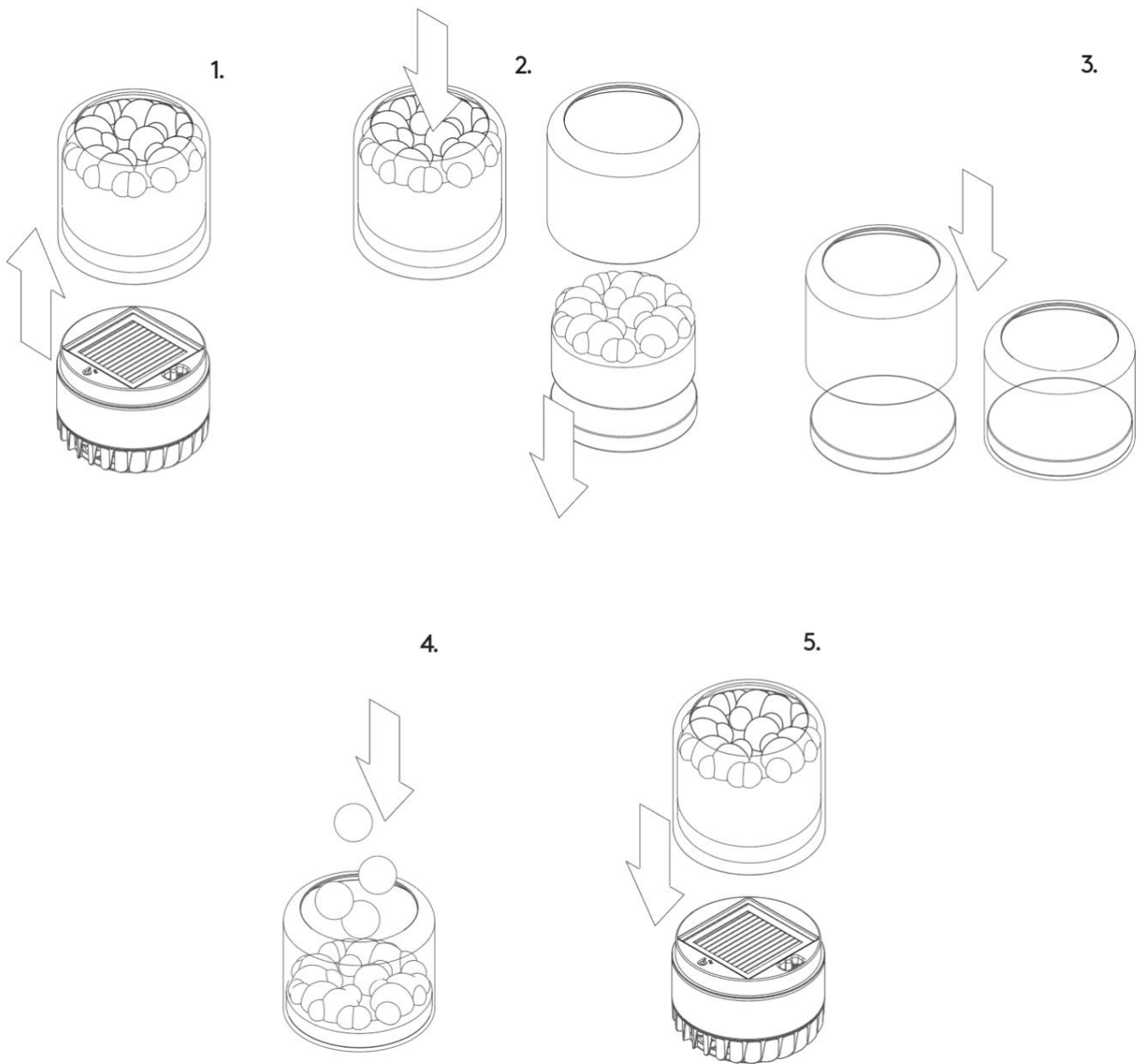

Changing the Nano Matrix Filter

1. Carefully lift the glass of Briiv 2 upward and set safely to one side.
2. Inside the bioplastic base of Briiv 2 is the matrix filter housing. Open the lid of the cardboard filter housing to access the filter.
3. Remove the used matrix filter.

4. Insert your new matrix filter dark side facing up into the cardboard filter housing and then close the lid.
5. Replace the glass piece on top of the Briiv 2 base unit gently, making sure to align with the base so the glass piece is secure.
6. Dispose of the old nano matrix in your general waste.

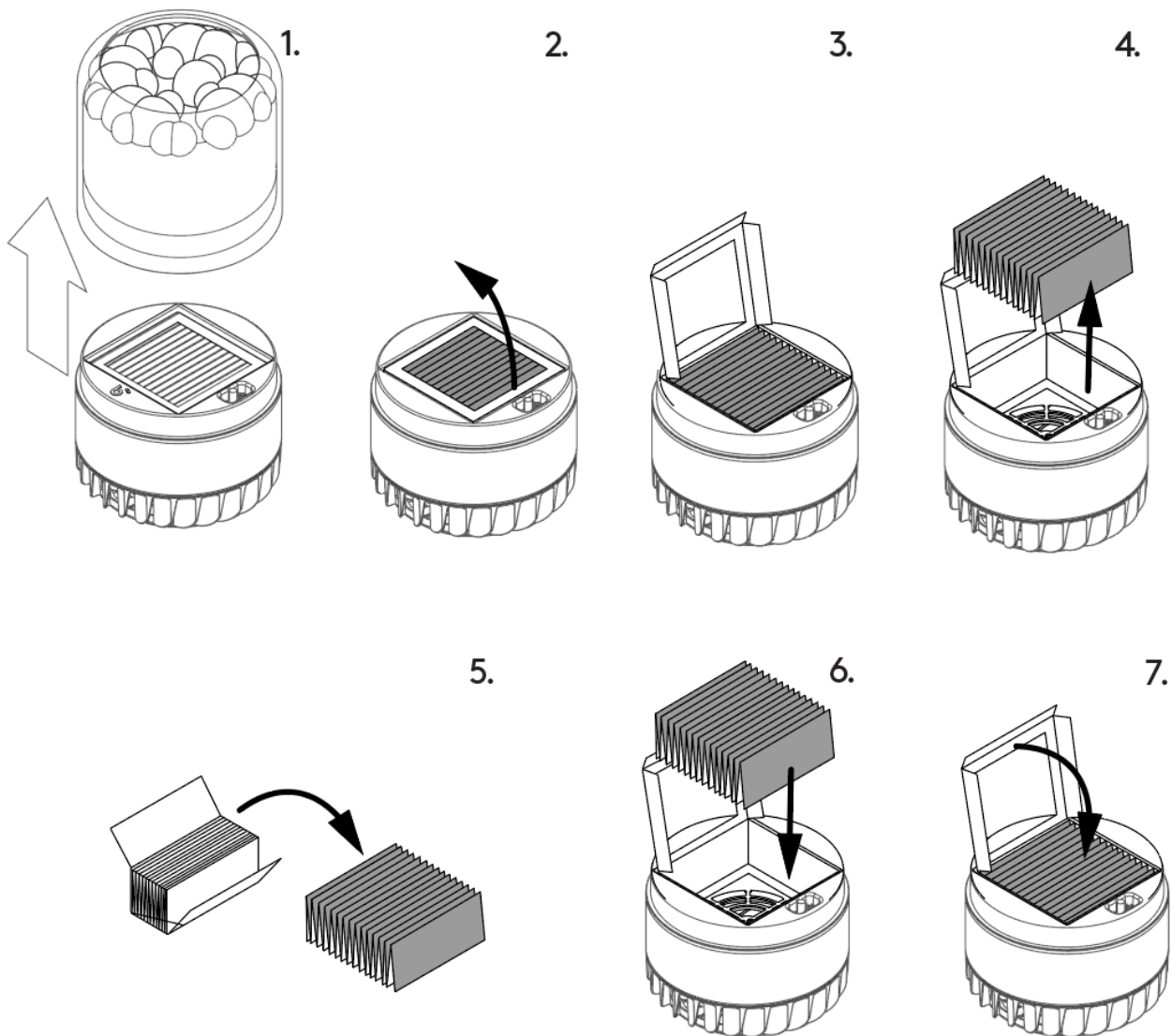

Filter Variants

Briiv 2 has three main filter variants:

- Yorkshire moss – A sphagnum moss that grows in most gardens around the world, this filter is washable and reusable. It captures dust particles as small as PM10.
- Reindeer moss – A lichen (*cladonia stellaris*) that is carefully grown and picked from boreal regions, this filter can be used once and then composted. It captures dust particles as small as PM10.
- Activated carbon – 250 grams of activated carbon with an iodine rating of 1000, this filter is ideal for removing odours and any chemical compound classed as a VOC's (volatile organic compound).

Briiv 2 and Briiv 2 Pro are compatible with any of these three filters.



Washing Yorkshire Moss

The Yorkshire moss filter can be washed and re-used. This **cannot** be done for the other filters.

Using water and a few drops of concentrated disinfectant, you can use the hessian bag that the moss is supplied with to wash it in. Alternatively, you can use a sieve or colander.

When washing the moss, this should be done in a sink by hand.

Fill a container with 1 litre of warm or cool water and a few drops of concentrated disinfectant.

Leave the moss to soak for 5 minutes in the water, then rinse with fresh cold water.

Squeeze the Yorkshire moss until no more water can be removed. Put the moss back into Briiv 2 and spread it out so it is not clumped together from the washing process.

Run Briiv 2 for at least 6 hours at speed 3 or above while the moss dries out.

You can also pick your own sphagnum moss and follow the above steps so you can grow your own filter. At the end of its life, it can be composted at home. We are the only filter in the world that lets you do this!

Connecting to Wi-Fi

To connect Briiv 2 to your Wi-Fi ensure the Briiv 2 is close to the Wi-Fi Router.

Touch and hold the large, illuminated dot on the front of Briiv 2 for 8 SECONDS until the display turns blue and the lights show a connection animation.

Follow the instructions on the app to connect the unit to Wi-Fi.

If you are having any problems with connection, up to date trouble shooting advice can be found on our support pages here:

<https://Briiv.zendesk.com/hc/en-gb>

When moving Briiv 2 after it has been connected, if the app is no longer successfully communicating with the unit it may have been moved outside of the Wi-Fi range. If you have known areas of your home with poor Wi-Fi signal, it is not recommended to place Briiv 2 in these areas.

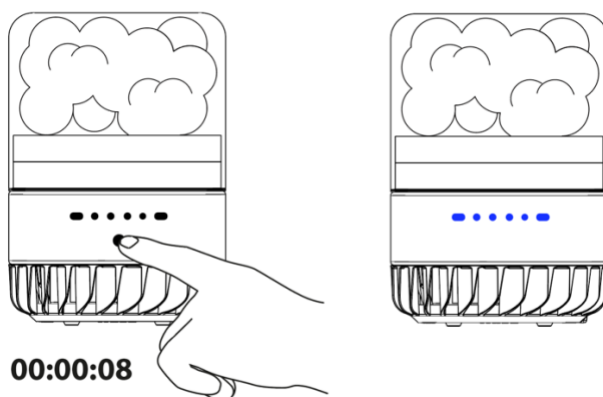

Can I use Briiv 2 without Wi-Fi?

Yes, but you won't be able to control Briiv 2 via the app or amend the automatic activation air quality intervals.

Briiv 2 features touch buttons, so you don't have to have it connected to the internet in order for it to work. You can still control the speed and set the air quality monitor using the touch interface.

Get The App

Follow the QR code for further instructions or visit:

<https://www.Briiv.co.uk/pages/Briiv-app-download-2-0>



Placement

A central location within a space will give Briiv 2 the best opportunity to cycle all the air as efficiently as possible.

If a central location is not viable, an elevated position elsewhere within a space is ideal to keep Briiv 2 operating safely and effectively.

Avoid placing Briiv 2 in confined places (such as on a shelf with low clearance, close to another surface directly above it, or in a corner).

Run Time

In just 21 minutes, Briiv 2 cleans a 4x4m² space on speed level 4.

When To Use

Briiv 2's usage can be maximised by using it strategically.

Use the 1 Hour Filter Cycle one hour before you intend to go to bed to refresh the air in your bedroom.

Use the 1 Hour Filter Cycle one hour before returning home to walk into cleaner air.

Activate Briiv 2 when cleaning a room to capture and remove dust and VOCs that are disturbed or distributed through the cleaning processes.

Use Briiv 2 in your kitchen after cooking to speed up the clearing of the air and removal of odours.

Time to Cycle the Air in a Room Comparison Table

| Room Length (m) | Room Width (m) | Room Height (m) | Room Volume (m ³) | Time (Mins) |
|-----------------|----------------|-----------------|-------------------------------|-------------|
| 4 | 4 | 2.5 | 40 | 21 |
| 3.5 | 3.5 | 2.5 | 30 | 16 |
| 3 | 3 | 2.5 | 22.5 | 11 |
| 2.5 | 2.5 | 2.5 | 15.6 | 8 |
| 2 | 2 | 2.5 | 10 | 5 |

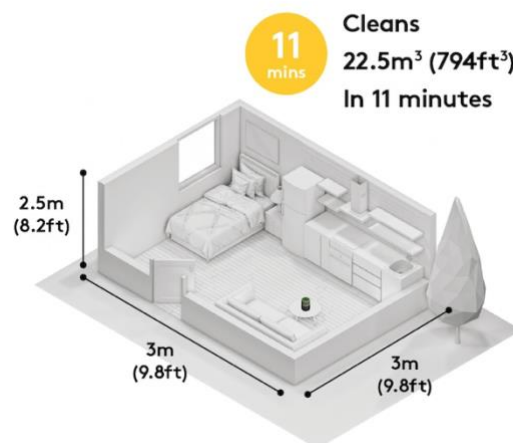

(On speed level 4)

Build an Air Quality System

Briiv 2 Pro links together with other Briiv units to create a smart air monitoring system, so you can build a complete air quality system in your home or office.

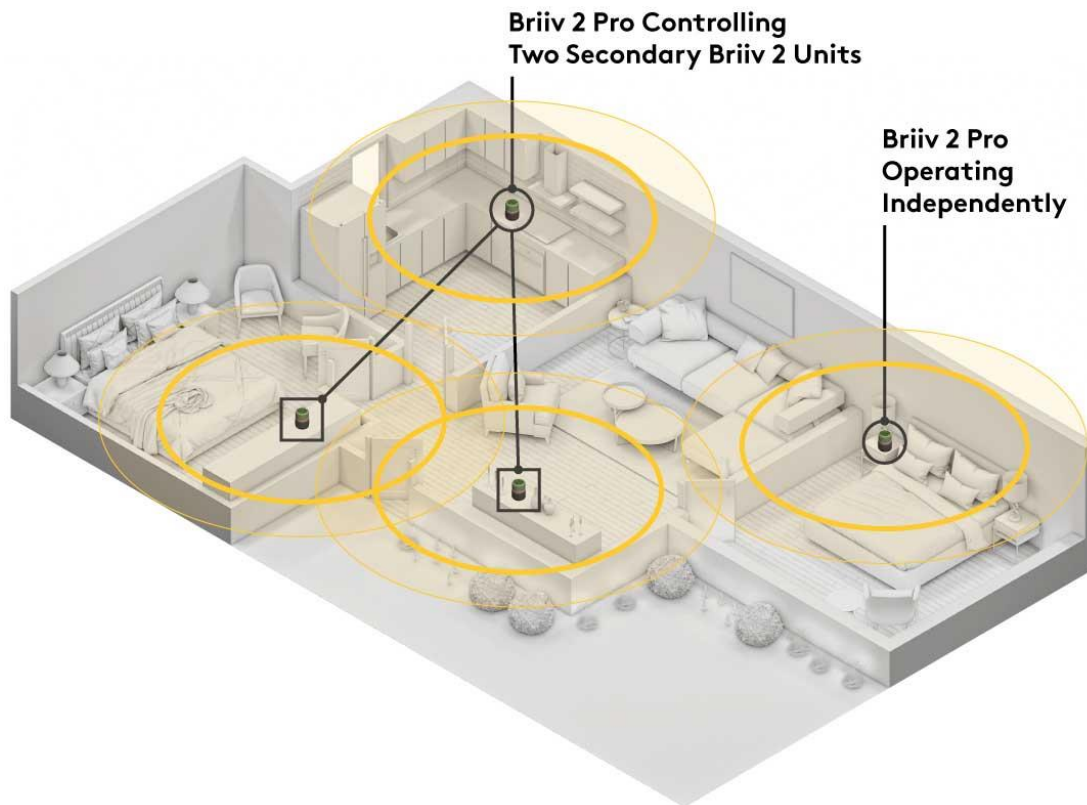

Place units around the home in different zones as seen below.

Connect all the devices to the Briiv 2.0 app.

Choose the Briiv 2 Pro unit you want to set as the master controller in the app.

Navigate to the settings page on that device in the app.

In 'create a zone', select the devices that you want to be controlled by the Briiv 2 Pro.

Hit save.

Your changes should be reflected on the homepage where the connected devices will display as linked.

Now when the chosen master unit detects poor air quality it will trigger the other linked Briivs to switch on and clean the air.

Add Fragrance

Essential oils can be added to Briiv 2 so that after all of the harmful particulates have been removed, you can add natural fragrance oil to freshen up and give your space a new lease on life.

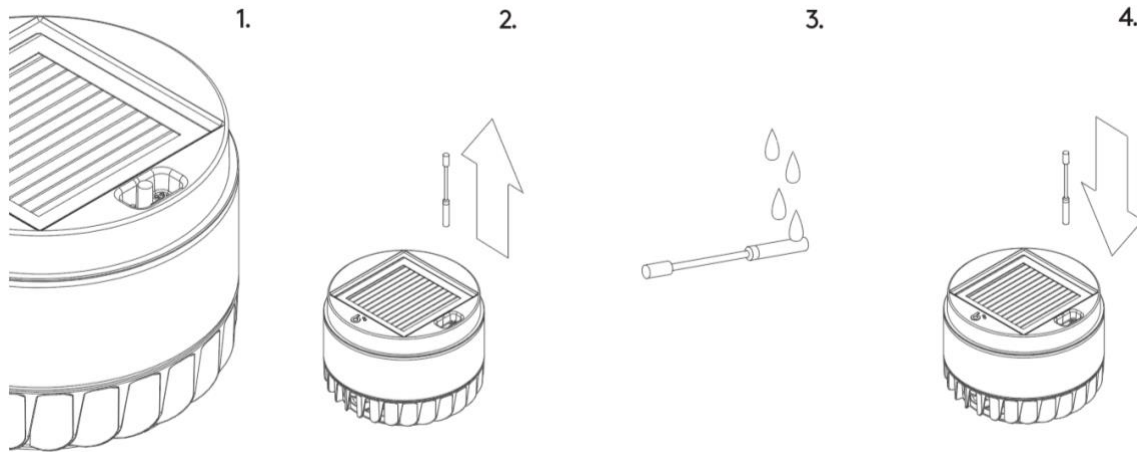

Adding a Fragrance

Remove the glass, moss, and coconut from the Briiv 2 to reveal the small well next to the filter. Do not remove the nano matrix filter for this.

Take the fragrance stick with the attached fragrance bud and the essential oil of your choice. Add up to 10 drops of essential oil directly to the fragrance bud on the stick. Do not use more than 10 drops of fragrance.

(Note: Do not pour essential oil directly into the well as this may overflow and cause damage to your Briiv 2 or the surface Briiv 2 is standing on).

Put the fragrance stick, bud down, into the well.

Replace the glass and filters.

Turn on Briiv 2 to allow the fragrance to disperse.

We recommend that one fragrance is used per bud, but each bud can continue to be used and refilled as desired.

Changing the Fragrance Bud

Each bud can be removed from the stick. Hold onto the handle of the metal stick and unscrew the fragrance bud.

A new bud can then be screwed on for use with a different fragrance. Watch [here](#).

Cleaning the Fragrance Chamber

Use the included cleaning sticks to clean the fragrance chamber periodically or if fragrance is spilled into the well.

Turn off Briiv 2 and unplug. Put the cleaning stick into the well as far as it can go, then let it absorb any residual fragrance. Repeat as many times as necessary to absorb any spillage.

Briiv Support

Use our extensive customer support library and team to answer common customer queries and questions about set up:

<https://Briiv.zendesk.com/hc/en-gb>



Maintenance Advice

Before cleaning Briiv 2, remove it from its power source.

Cleaning the glass:

- Regular dusting with a lint free cloth will remove particulate that has gathered on the glass.
- To clean the glass, remove the glass top from Briiv 2 and remove all filters from within the glass.
- Using a domestic glass cleaner, wipe any marks from the surface of the glass inside and out.
- For additional cleaning, hot water and household dish soap will clean the glass. Dry the glass using a lint free cloth to avoid water marks.
- The glass can be placed into a dishwasher provided the detergent and dishwasher salts are appropriate for glass cleaning.

Cleaning the base:

- Regular dusting with a lint free cloth will remove particulate that has gathered on the base of Briiv 2.
- A slightly damp cloth or lint roller can remove heavier dirt from the Briiv 2 base.
- Avoid getting any moisture or liquid inside the Briiv 2 unit.
- Water should never be introduced to Briiv 2. Water may cause an electrical short and damage the unit, rendering it inoperable and posing a safety risk.

General Safe Usage

Do not eat or place in the mouth any element of the filter media (this includes the moss, coconut and matrix filter).

We recommend against using Briiv 2 in places of high moisture such as bathrooms. Humid environments will increase the usage of the filters and poses a risk to the electronic components within.

If the glass surround becomes broken, dispose of it in its entirety immediately in a safe and responsible manner. Replacement glass surrounds can be ordered from Briiv.co.uk

We recommend keeping Briiv 2 out of reach of children and away from pets in order to mitigate the chances of damage occurring to any element of the Briiv 2 unit or the unit as a whole.

Do not insert any part of your or anyone or anything's body into Briiv 2 at any time.

Do not squash, tear or compress the moss as this will cause irreparable damage to it and inhibit its ability to filter the air.

Do not water the moss or add water to any part of the product.

FAQs

Where can I order filters? You can order filters from Briiv.co.uk

How loud is it? Briiv 2 is rated at around 45dB at maximum speed, the equivalent of a quiet office.

Does Briiv 2 use an ionizer or generate ozone? Briiv 2 doesn't use an ionizer and doesn't generate ozone.

What is your warranty policy like?

We offer a two year guarantee against defects and faults with Briiv 2. We also offer a 30 day money back guarantee if you change your mind (minus shipping and handling), provided Briiv 2 is in the same condition as when it was taken out of the box and in its original packaging.

Important Safety Instructions

When using electrical appliances, basic precautions should always be followed to reduce the risk of fire, electric shock and injury to persons, including the following:

1. Read all instructions before using the appliance.
2. To avoid fire or shock hazard, always use an appropriate 5v plug or USB outlet.
3. Keep the cord out of heavy traffic areas. To avoid fire hazard NEVER put the cord under rugs, near heat registers, radiator, stoves, or heaters.
4. To protect against electrical hazards DO NOT immerse in water or other liquids. Do not use near water.
5. Close supervision is necessary when any electronic appliance is used by or near children.
6. Always unplug Briiv 2 before moving it, removing the glass, changing filters, cleaning, or whenever the air purifier is not in use. Be sure to pull by the plug and not the cord.
7. NEVER drop or insert any object into any openings.
8. DO NOT operate any appliance with a damaged cord or plug, if motor fan fails to rotate, after the appliance malfunctions, or if it has been dropped or damaged in any manner.
9. Use appliance only for intended use as described in this manual. Any other use not recommended by the manufacturer may cause fire, electric shock, or injury to persons.
10. DO NOT use outdoors.
11. NEVER block the air openings, outlets, or place on a soft surface such as a bed or sofa, as this could cause the unit to tip over, blocking the air intake opening or causing damage to the glass of Briiv 2 Pro.

United Kingdom contact for regulatory topics only:

FIVE Create Ltd, Unit 5, Armley Nano Park, Leeds, West Yorkshire, LS12 2BJ, UK

12. Keep unit away from heated surfaces and open flames.

13. DO NOT attempt to repair or adjust any electrical or mechanical functions on this unit. Doing so will void your warranty. The inside of the unit contains no user serviceable parts. All servicing should be performed by qualified personnel only.

14. WARNING: To reduce the risk of fire or electric shock, DO NOT use this air purifier with any solid-state speed control device.

15. DO NOT place anything on top of unit.

People with a history of respiratory problems or lung disease should consult a physician before using this product.

Caution: Keep electrical appliances out of reach from children. Do not let them use the appliances without supervision.

Troubleshooting Tips

If the air purifier shuts off unexpectedly, safety features may have been activated to prevent damage or injury. If this happens:

1. Be sure the air purifier is plugged into a working electrical outlet;
2. Reset the unit by unplugging from its power source and waiting 30 seconds before powering the unit again.

NOTE: IF YOU CONTINUE TO EXPERIENCE A PROBLEM, PLEASE RETURN THE AIR PURIFIER TO THE PLACE OF ORIGINAL PURCHASE OR SEE YOUR WARRANTY. DO NOT ATTEMPT TO DISASSEMBLE THE UNIT BY YOURSELF. DOING SO MAY VOID YOUR WARRANTY AND CAUSE DAMAGE TO THE PRODUCT OR PERSONAL INJURY.

Warranty

Briiv units have a 2 year warranty from the date of purchase against defects and faults with the product when purchased from an official retailer.

We also offer a 30 day money back guarantee if you change your mind (minus shipping and handling), provided Briiv is in the same condition as when it was taken out of the box and in its original packaging.

Terms and Conditions:

Replacement Unit or Parts may be new or remanufactured service exchanges that are equivalent to new in performance and reliability.

The warranty does not cover any of the following actions:

- Periodic check ups, maintenance and repair or replacement of parts due to normal wear and tear.
- Cost relating to transport, removal or installation of the product.
- Misuse, including failure to use the product for its normal purposes or incorrect installation, or accidental damage.
- Damage caused by Lightning, Water, Fire, Acts of God, War, Public Disturbances, incorrect mains voltage, improper or insufficient ventilation or any other cause beyond the reasonable control of Five Create Ltd.
- Any interference with the product outside of normal use, such as removing screws or tampering with the inner workings of the product, will render the warranty void.
- Damages resulting from any unauthorised attempts to repair or from any use not in accordance with the instruction manual.
- This Warranty applies ONLY to repair or replacement of any supplied or manufactured parts of this product that, upon inspection by the agent, authorised personnel, is shown to have failed in normal use due to defects in material or workmanship.
- Operating this unit under conditions other than those recommended or at voltages other than the voltage indicated on the unit, or attempting to service or modify the unit, will render this WARRANTY VOID.

The manufacturer warranty is only valid when accompanied by the original invoice, sales receipt or confirmation from the Briiv team of the warranty period and must be supplied by the original buyer.

If you have any questions or comments regarding this unit, please contact us on ask@briiv.co.uk

This 2 year limited warranty applies to repair or replacement of product found to be defective in material or workmanship. This warranty does not apply to damage resulting from commercial, abusive, unreasonable use or supplemental damage. Defects that are the result of normal wear and tear will not be considered manufacturing defects under this warranty.

We are not liable for incidental or consequential damages of any nature. Any implied warranty of merchantability or fitness for a particular purpose on this product is limited to the duration of this warranty.

This warranty gives you specific legal rights, and you also may have other rights which vary from jurisdiction to jurisdiction. This warranty applies only to original purchaser of this product from the original date of purchase.

At its option, we will repair or replace this product if it is found to be defective in material or workmanship. Defective product should be returned to the place of purchase in accordance with the store policy. Thereafter, while within the warranty period defective product may be returned to us.

IMPORTANT RETURN INSTRUCTIONS: Your warranty depends on your following these instructions if you are returning the unit.

1. Carefully pack the item in its original carton or other suitable box to avoid damage in shipping.
2. Before packing your unit for return, be sure to do the following:
 - a. Submit a return form via our online website submission.
 - b. Contact customer service to confirm the return and receive a return slip to include in the return parcel for identification. If the return cannot be identified the warranty is void.
 - c. Ship the package insured and tracked.