



Fire Your Imagination

Ellingham Front

For use with Riva2 500/ 530/ 670 Gas



Instructions for Use and Installation
For use in GB, IE (Great Britain and Republic of Ireland)

Installation Instructions

Covering frame model numbers:

Riva2 530	Riva2 670	Riva2 500
934-433	934-486	934-470

1. General



IMPORTANT: TAKE CARE WHEN HANDLING. THIS DECORATIVE FRONT IS MADE OF CAST IRON AND IS EXTREMELY HEAVY. LIFT WITH CAUTION. INSTALLATION WILL REQUIRE 2 PEOPLE.

- 1.1 These instructions are supplementary to, and must be read in conjunction with, the instructions supplied with the appliance. Read both thoroughly before installation.
- 1.2 Fitting of this decorative front requires work to be carried out during the installation procedure. Ensure any necessary actions are taken prior to fitting the appliance.

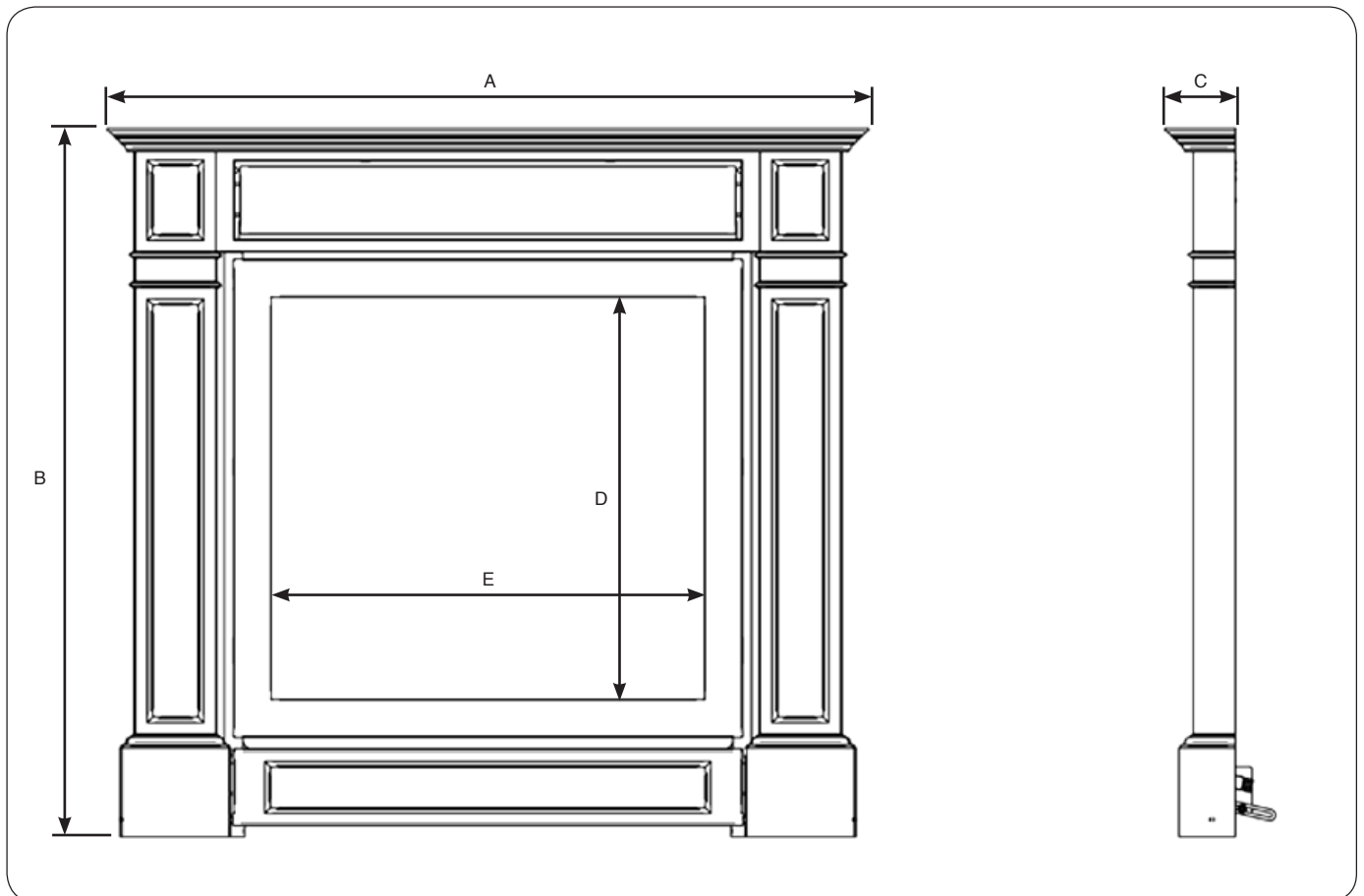

Model	A	B	C	D	E
Riva2 530	815	759	75	431	464
Riva2 670	940	627	75	299	590
Riva2 500	885	678	75	383	546

All dimensions in mm

Installation Instructions

2. Pre-Installation Riva2 530 & 670 only

2.1 The front consists of 3 components:

- Decorative cast iron front.
- Wall mounting bracket.
- Access door catch mechanism.

The wall mounting bracket and access door catch mechanism will need to be separated from the cast front prior to installation.

2.2 Lay the front face down on a soft flat surface to avoid damage.

2.3 Remove the 2 screws securing the access door catch mechanism to the cast front, see Diagram 1, Detail A. Retain the screws as they will be required during installation.

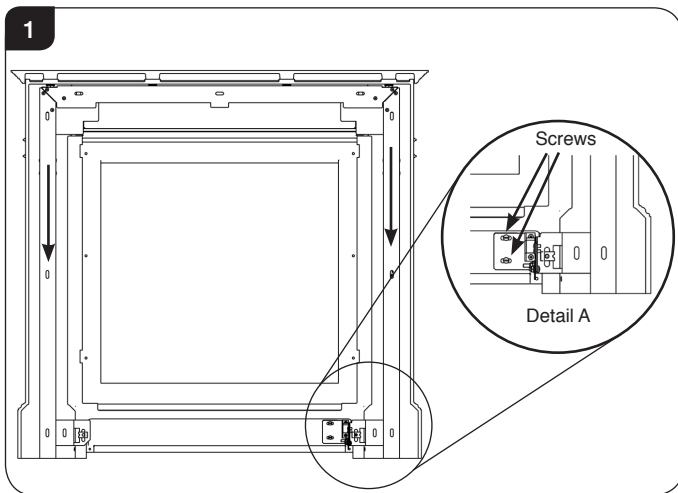

2.4 Release the countersunk screws on the cast front from the slots on the wall mounting bracket by sliding the bracket towards the base of the cast front, see Diagram 1.

Note: It not necessary to remove the access door catch from the wall mounting bracket.

3. Fitting the Front



IMPORTANT: BEFORE THE INSTALLATION OF THE DECORATIVE FRONT ENSURE THAT THE WALL ABOVE AND TO THE SIDES OF THE APPLIANCE IS SUITABLY CONSTRUCTED FOR THE FIXINGS TO SUPPORT THE WEIGHT OF THE FRONT. IF THE WALL IS CONSTRUCTED FROM PLASTERBOARD OR SIMILAR, IT IS ESSENTIAL THAT BATTERNS ARE LOCATED TO THE SIDES OF THE APPLIANCE IN THE FIXING AREA TO PROVIDE STRENGTH TO THE FIXINGS. SEE DIAGRAM 1 & 2.

3.1 The Riva2 500 and the Riva2 530/670 require different methods of installation, please refer to the specific section for the individual appliance requirements.

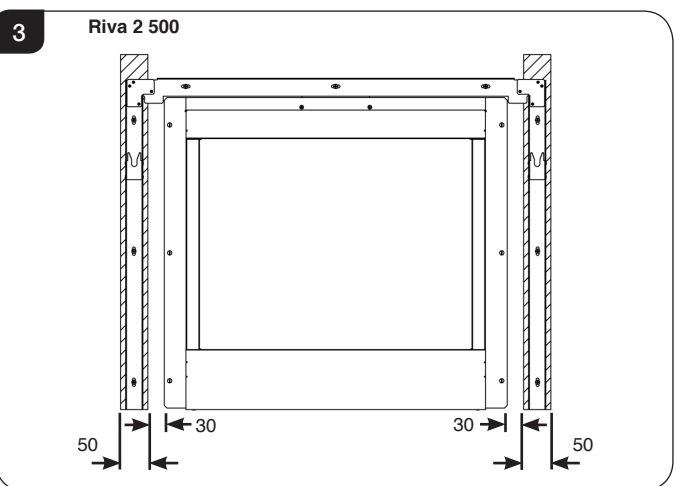
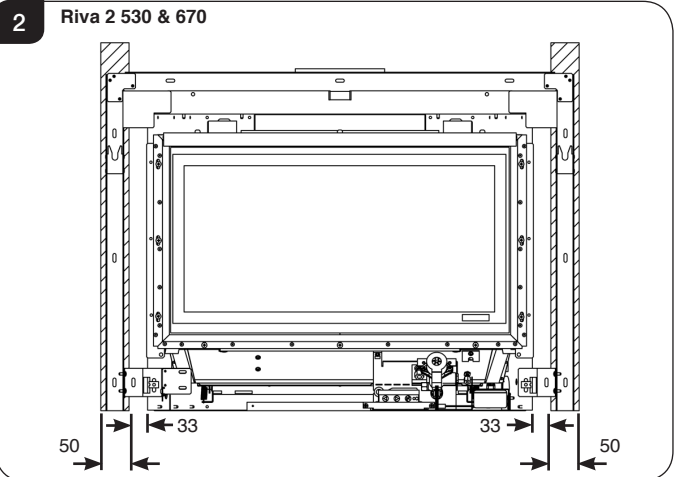

PLEASE NOTE THAT THE CAST IRON FRONT IS VERY HEAVY, 2 PEOPLE ARE REQUIRED TO LIFT THE FRONT INTO POSITION. TAKE CARE TO ENSURE THE FRONT DOES NOT MARK THE WALL FINISHING.

3.2 Install the appliance in accordance with the User & Installation instructions supplied with the appliance.

Riva2 530 & 670

3.3 Locate the 3 tabs on the top flange of the appliance, see Diagram 4.

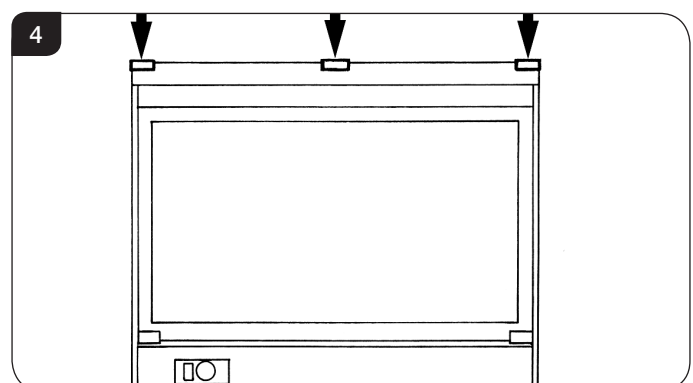

Installation Instructions

3.4 The wall mounting bracket has 3 flanges that align with the tabs on the appliance.
Place the wall mounting bracket so that the flanges locate in the tabs and the top of the bracket rests against the top edge of the appliance.

3.5 Proceed to 3.8

Riva2 500

3.6 Locate the wall mounting bracket by centralising the top of the bracket with the appliance flange, see Diagram 5.
Note: The bracket has tabs on either end, which locate around either side of the flange, see Diagram 5, detail A.

The bottom of the bracket legs should rest on the hearth.
Ensure that the legs are square to the appliance.

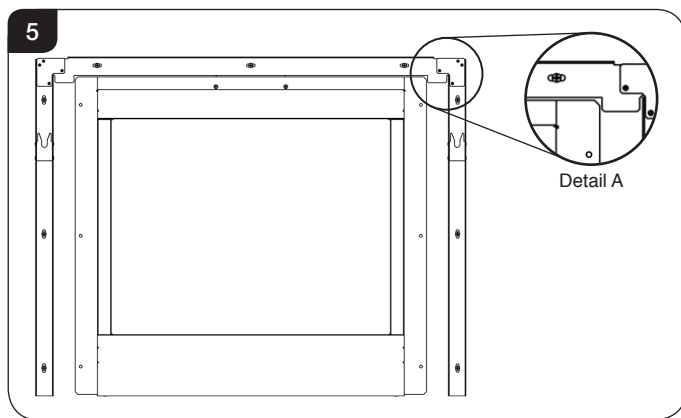

3.7 Proceed to 3.8.

All Models

3.8 Ensure the bracket is resting centrally and mark the location of the fixing holes, see Diagram 6.

- If the wall is of solid construction mark the position of the 9 holes marked A.
- If the wall is constructed from studwork and plasterboard (or similar) mark the position of the 8 holes marked B.

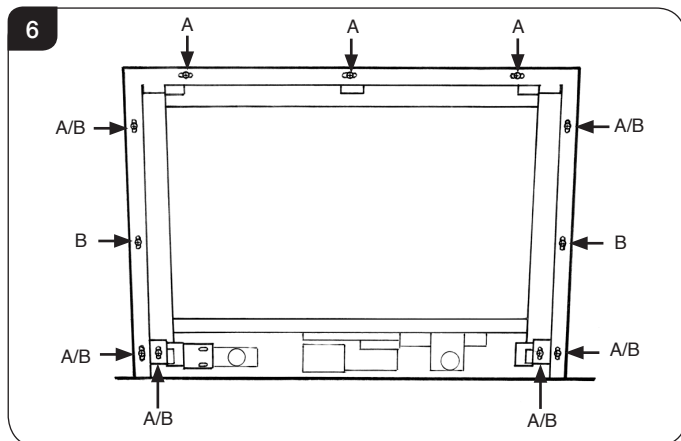

3.9 Remove the mounting bracket and drill the fixing holes.
Ensure no debris falls into the appliance.

3.10 Push the rawplugs into the holes and secure the bracket to the wall with the screws supplied.



THE FIXINGS SUPPLIED SHOULD BE SUFFICIENT WHEN MOUNTING ONTO A BRICK OR BLOCK WALL. USE SUITABLE FIXINGS WHEN MOUNTING ON A WALL CONSTRUCTED OF AN ALTERNATIVE MATERIAL.

3.11 Remove the cast iron decorative front from the packaging and place face down on a soft surface to avoid damage.

3.12 Fit the securing screws from the fixing kit into the threaded holes on either side of the back face of the casting and screw into the holes until approximately 10mm of screw is left protruding, see Diagram 7.

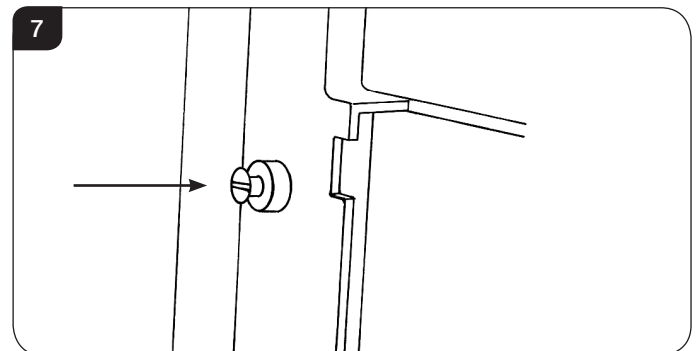

3.13 Lift the cast front into its upright position.



IMPORTANT: THE ACCESS DOOR IS MADE OF CAST IRON AND IS VERY HEAVY. TAKE CARE THAT IT DOES NOT OPEN WHILST LIFTING THE CAST IRON FRONT.

Raise off the floor and place over the mounting frame, ensuring the front is central to the appliance.

Gently lower so that the 2 countersunk screws locate into the slots on the sides of the mounting bracket, the front should now sit on the hearth, see Diagram 8.

THIS OPERATION WILL REQUIRE 2 PEOPLE.

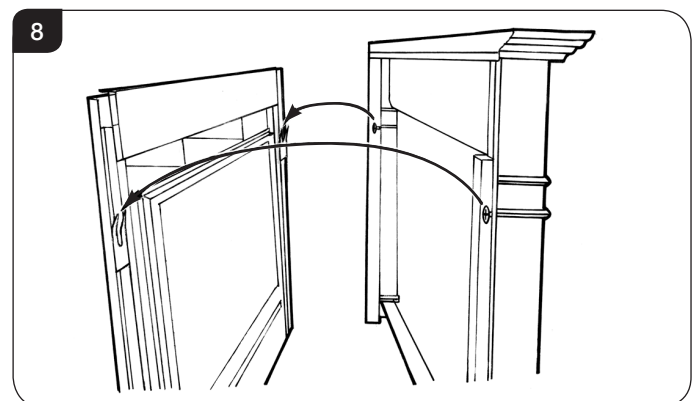

IMPORTANT: THIS DECORATIVE FRONT IS TO BE INSTALLED AGAINST A FLAT WALL AND MUST REST ON A SUITABLY CONSTRUCTED HEARTH; IT IS TOO HEAVY FOR WALL MOUNTING WITHOUT HEARTH SUPPORT.

PLEASE NOTE THAT THE CAST IRON FRONT IS VERY HEAVY, 2 PEOPLE ARE REQUIRED TO LIFT THE FRONT INTO POSITION. TAKE CARE TO ENSURE THE FRONT DOES NOT MARK THE WALL FINISHING.

Installation Instructions

Riva2 530 & 670 Only

- 3.12 Carefully open the access door on the front and lower until it rests against the hearth.
Secure the front to the mounting frame using the 2 long black screws and washers and locate these in the Left and Right hand slots. Tighten until the front is secure, see Diagram 9.

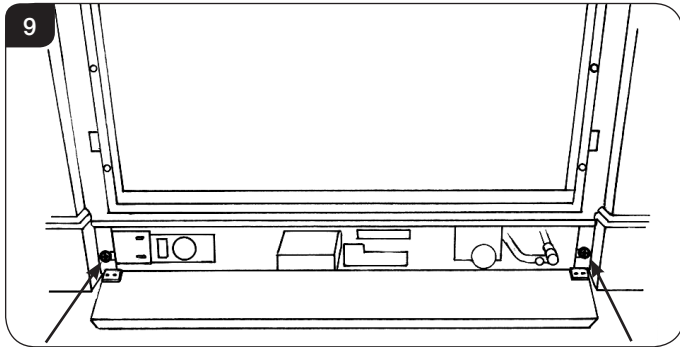

- 3.13 Identify the access door catch mechanism and pull the holding plate out of the catch.

Locate the plate so that the 2 holes align with the threaded holes on the back side of the access door and secure in position using the 2 screws removed during Pre-Installation Section 2, see Diagram 10.

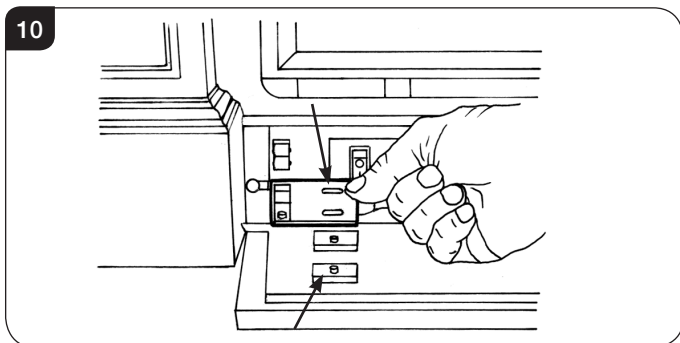

- 3.14 Carefully shut the access door and remove the window frame cover from the packaging.

- 3.15 Place the window frame in position by locating the 4 hooks (2 on each side) into the 4 slots on the inner opening of the cast iron front.

Push the cover down until the hooks are engaged fully behind the cast iron, see Diagram 11.

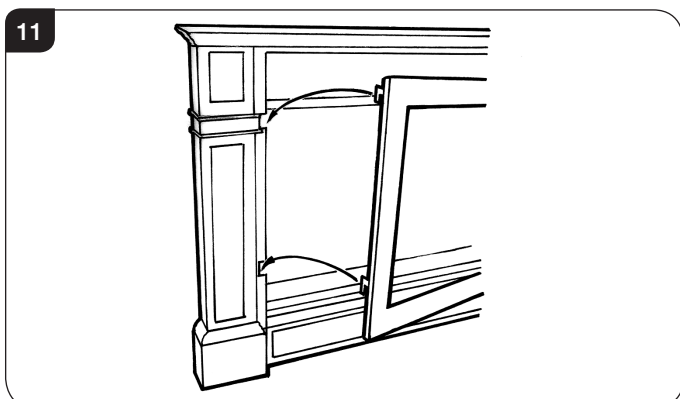

PLEASE NOTE THAT THE CAST IRON FRONT IS VERY HEAVY, 2 PEOPLE ARE REQUIRED TO LIFT THE FRONT INTO POSITION. TAKE CARE TO ENSURE THE FRONT DOES NOT MARK THE WALL FINISHING.

4. Commissioning

- 4.1 Where commissioning tests are detailed in the appliance installation instructions, these should now be carried out with the decorative front in place.
- 4.2 Ensure that these instructions are handed to the user and kept along with the appliance.

5. Operating the Appliance



IMPORTANT: THE ACCESS DOOR IS MADE OF CAST IRON AND IS VERY HEAVY. THE RETENTION CATCH WILL SUPPORT THE WEIGHT BUT TAKE CARE AS IT IS POSSIBLE TO TRAP FINGERS.

- 5.1 To open the access door, gently pull forward to release the catch then lower until the retention lever takes the weight.
- 5.2 To close the access door, return to the upright position ensuring the catch engages.

RESISTANCE FROM THE CATCH IS NORMAL DURING THE OPENING AND CLOSING OF THE DOOR. THIS IS NECESSARY TO SUPPORT THE WEIGHT OF THE DOOR.

6. Cleaning the Front

- 6.1 Only clean the frame when the appliance is cold.
- 6.2 It is advisable to run a soft brush over the cast iron front to remove any dust that may have accumulated. A damp cloth may be used but care should be taken to ensure no residue or lint from the cloth is left behind.

7. Fixing Kit Components

Description	Quantity
Wood screws	9
Rawlplugs	9
Long screws	2
1/2" Washers	2
Instruction manual	1

Gazco Limited, Osprey Road, Sowton Industrial Estate, Exeter, Devon, England EX2 7JG
Technical Customer Services: (01392) 261950 Fax: (01392) 261951
E-mail: technicalservices@gazco.com

A member of the Stovax Group
E & O E