

# INSPIRE & CREATE VOL.3



The page features a central gold-colored frame with intricate scrollwork. The background is a light purple color with a repeating white floral and scroll pattern. Several fabric flowers in shades of purple, pink, and beige are attached to the frame. The word 'INDEX' is centered in the middle of the page in a simple, black, sans-serif font.

## I N D E X

Pin Cushion .....	01
Bed Throw .....	02-03
Wreath with Felt Flowers .....	04-05
Kanzashi Flower Makers <i>How to use</i> .....	06-07
Kanzashi Flower Makers <i>List of products</i> .....	08-09
Roses! Roses!! Roses!!! .....	10-11
Sweetheart Rose Makers <i>List of products</i> .....	12
Yo-Yo Tapestry .....	12
"QUICK" Yo-Yo Makers <i>How to use</i> .....	13
"QUICK" Yo-Yo Makers <i>List of products</i> .....	14-15





*KANZASHI*



# 01 Pin Cushion

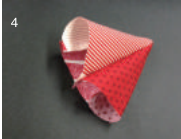
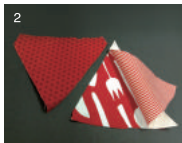
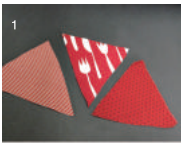
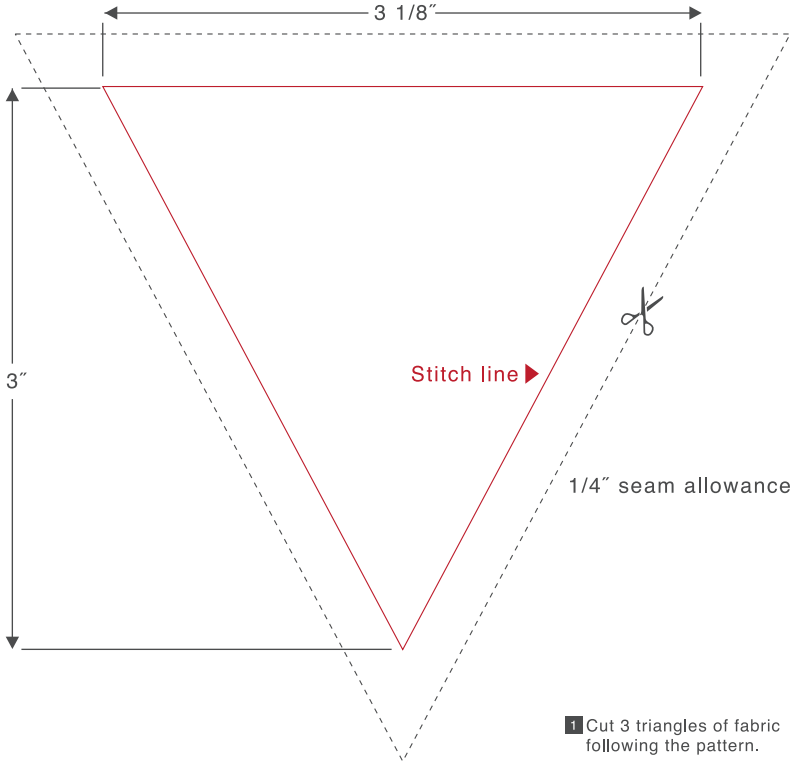

- 1 Cut 3 triangles of fabric following the pattern.
- 2 Sew 2 triangles with right sides together on one long side.
- 3 Sew the third triangle on to the other long side.
- 4 Turn unit to the right side and stuff.
- 5 Sew a running stitch around the top edge, draw up stitches and tie off.
- 6 Make your favorite Kanzashi Flower and sew it on the top.









02

## Bed Throw

Use Kanzashi Flower Maker Art No. 8483 Pointed Petal/Large and make 6 petals per flower.

DARK color fabric(orange).....80 flowers

LIGHT color fabric(green).....67 flowers

Patterned fabric(brown).....69 flowers

Attach floral trim at the middles of each flower with glue.

Sew together all of flowers as the drawing below.

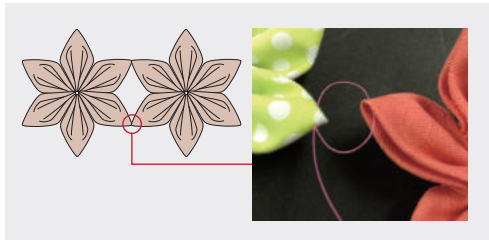
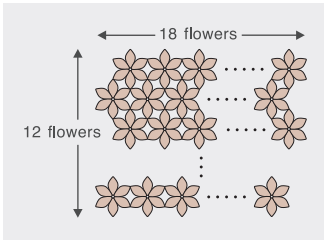





# 03

## Wreath with Felt Flowers

You can make flowers from felt using your favorite size and shape with the Kanzashi Flower Maker.

The wreath is designed using felt flowers, small pine cones, and nuts. Attach all pieces using glue.



No need to fold felt.  
Simply cut a rectangle to the shape of the template.



**1** Sandwich fabric between plate and cut.

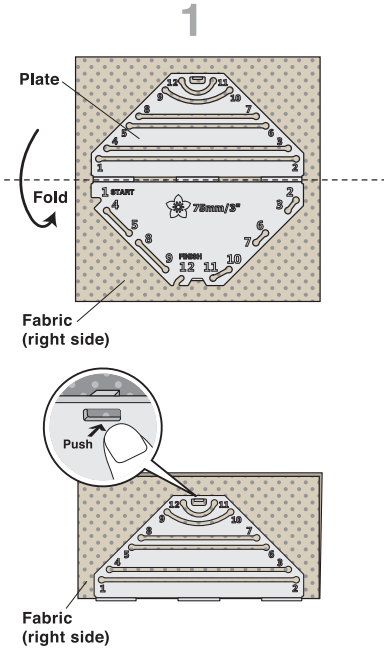

**2** Sew thread through elongated slit, following the numbers on the plate.

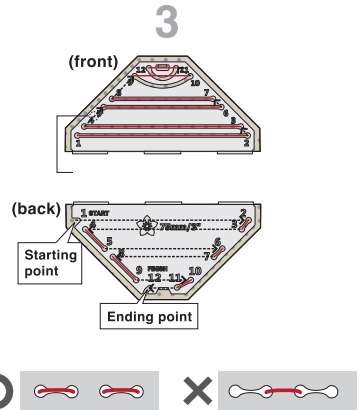
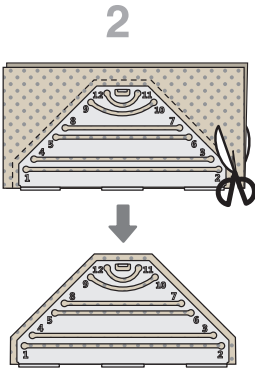
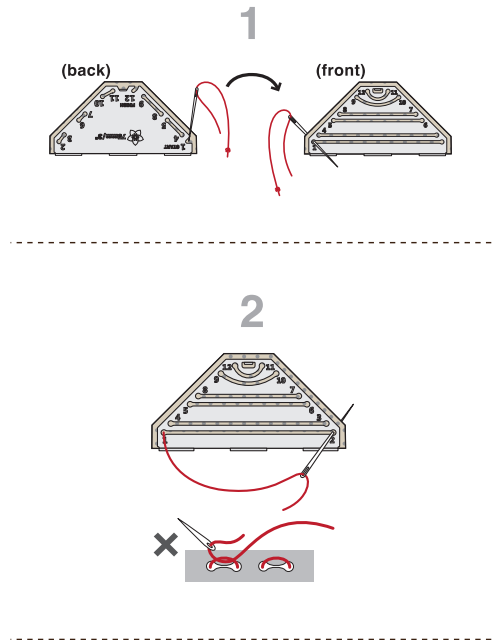

**3 Remove plate, shape petal by drawing up the stitches.**

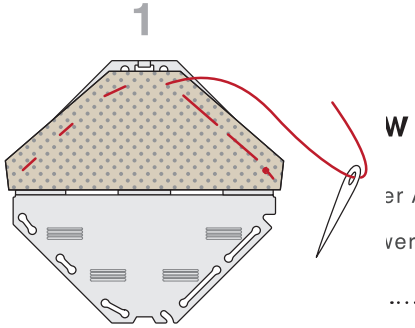



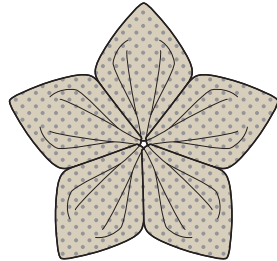
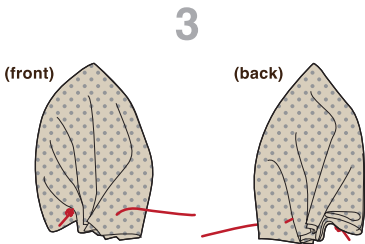
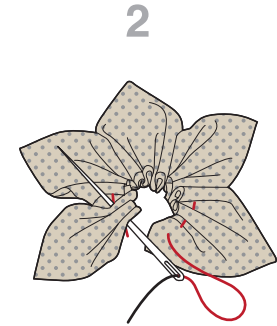
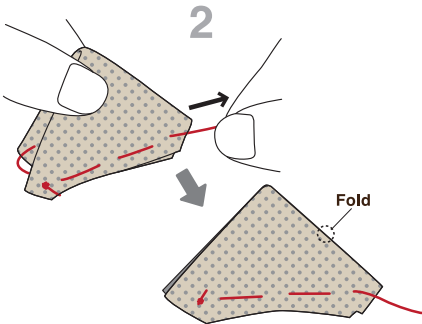
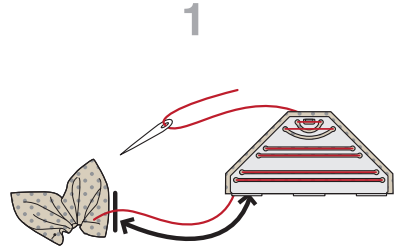











**4 Make remaining petals and create flower.**































# Kanzashi Flower Makers

<p>no.</p> <p><b>Kanzashi Flower Makers</b></p>	<p>8490</p> <p><b>Round Petal Extra Small</b></p> 	<p>8480</p> <p><b>Round Petal Small</b></p> 	<p>8481</p> <p><b>Round Petal Large</b></p> 
<p><b>finished size</b></p>	<p><b>35 mm</b></p>	<p><b>50 mm</b></p>	<p><b>75 mm</b></p>
<p><b>bar code</b></p>			
<p>8484</p> <p><b>Gathered Petal Small</b></p> 	<p>8485</p> <p><b>Gathered Petal Large</b></p> 	<p>8493</p> <p><b>Orchid Petal Extra Small</b></p> 	<p>8486</p> <p><b>Orchid Petal Small</b></p> 
<p><b>50 mm</b></p>	<p><b>75 mm</b></p>	<p><b>35 mm</b></p>	<p><b>50 mm</b></p>
			

<p>8491</p> <p><b>Pointed Petal Extra Small</b></p>  	<p>8482</p> <p><b>Pointed Petal Small</b></p>  	<p>8483</p> <p><b>Pointed Petal Large</b></p>  	<p>8492</p> <p><b>Gathered Petal Extra Small</b></p>  
<p>35 mm</p>	<p>50 mm</p>	<p>75 mm</p>	<p>35 mm</p>
 <p>0 51221 78491 0</p>	 <p>0 51221 55482 7</p>	 <p>0 51221 55483 4</p>	 <p>0 51221 78492 7</p>

<p>8487</p> <p><b>Orchid Petal Large</b></p>  	<p>8494</p> <p><b>Daisy Petal Extra Small</b></p>  	<p>8488</p> <p><b>Daisy Petal Small</b></p>  	<p>8489</p> <p><b>Daisy Petal Large</b></p>  
<p>75 mm</p>	<p>35 mm</p>	<p>50 mm</p>	<p>75 mm</p>
 <p>0 51221 78487 3</p>	 <p>0 51221 78494 1</p>	 <p>0 51221 78488 0</p>	 <p>0 51221 78489 7</p>







# 04



## Roses! Roses!! Roses!!!



You can easily make beautiful Roses with your favorite fabric.



- 1** Place the fabric in between the two patterns and pin the fabric to the pattern.



- 3** Remove the pins and pull the outer pattern from the fabric. Straighten the fabric, and then pull out the inner pattern.



- 2** Fold the end from ←START! and start sewing the folded section. Fold the pattern twice in alternating sections. Stitch up to the next corner. Repeat this fold & stitch process until you create a circle and stop sewing at STOP! →



- 4** Pull the thread to make loose gathers.



- 5** Use the hairpin as the center to wind the fabric.

## Sweetheart Rose Makers



Sweetheart Rose  
Makers



finished size



bar code







# 06 Yo-Yo Tapestry



Make Yo-Yos in your favorite size and shape.

Sew them together to make a curtain or runner.

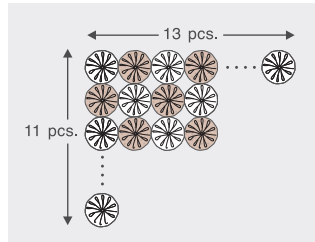
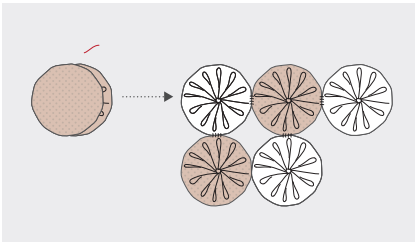

# "QUICK" Yo-Yo Makers

1

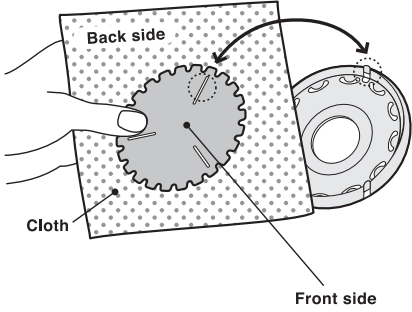

2

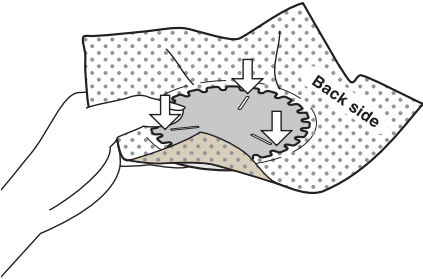

3

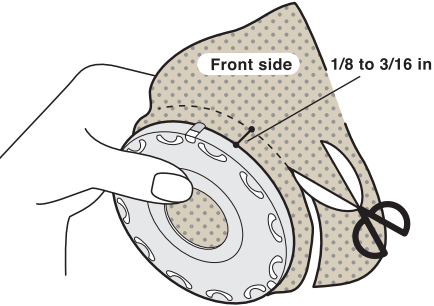

4

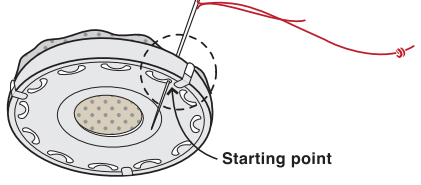
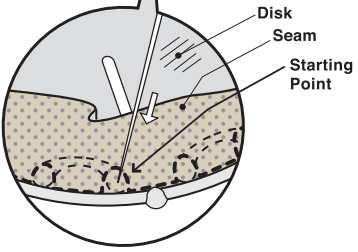
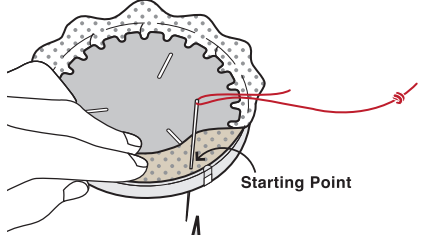

5

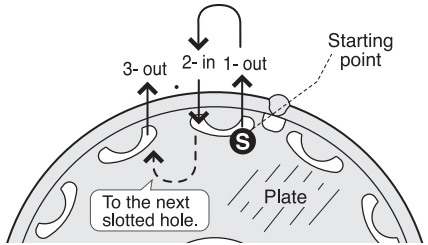

6

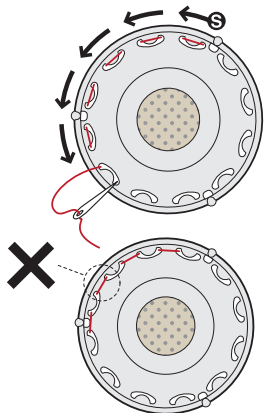

7

Ending point

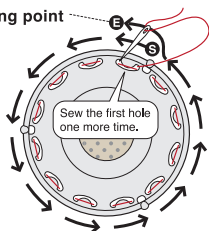

8

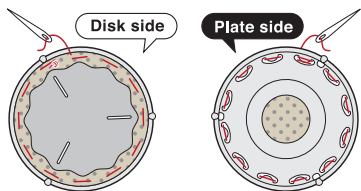

9

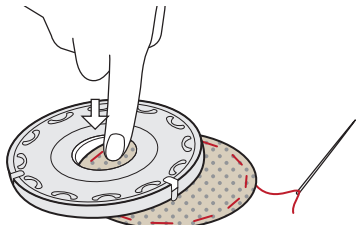

10

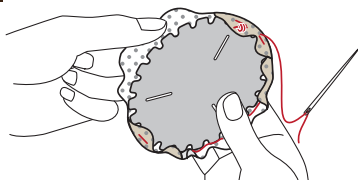

11

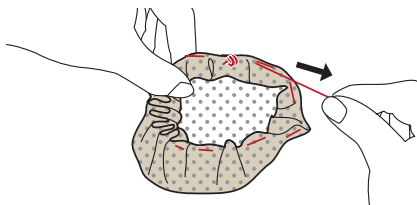

12

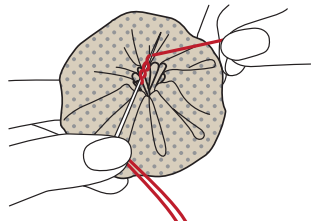

13

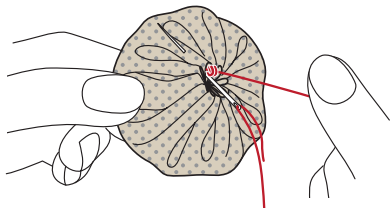

14

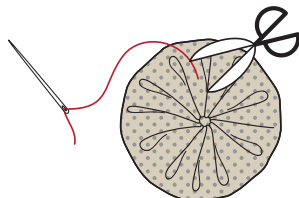



**“QUICK” Yo-Yo Makers**

no.	8708	8703	8701
<p><b>“QUICK” Yo-Yo Makers</b></p>	<p><b>Jumbo</b></p>	<p><b>Extra Large</b></p>	<p><b>Large</b></p>
			
	<p><b>Approx. 90 mm</b></p>	<p><b>Approx. 60 mm</b></p>	<p><b>Approx. 45 mm</b></p>
<p><b>bar code</b></p>			

8707	8706	8711	8710
<p><b>Flower-Shape/Large</b></p>	<p><b>Flower-Shape/Small</b></p>	<p><b>Butterfly-Shape/Large</b></p>	<p><b>Butterfly-Shape/Small</b></p>
			
<p><b>Approx. 45 mm</b></p>	<p><b>Approx. 35 mm</b></p>	<p><b>Approx. 45 x 55 mm</b></p>	<p><b>Approx. 30 x 40 mm</b></p>
			

<p><b>8700</b></p> <p><b>Small</b></p>  	<p><b>8702</b></p> <p><b>Extra Small</b></p>  	<p><b>8705</b></p> <p><b>Heart-Shape/Large</b></p>  	<p><b>8704</b></p> <p><b>Heart-Shape/Small</b></p>  
<p>Approx. 30 mm</p>	<p>Approx. 20 mm</p>	<p>Approx. 40 x 45 mm</p>	<p>Approx. 25 x 30 mm</p>
			
<p><b>8713</b></p> <p><b>Shamrock-Shape/Large</b></p>  	<p><b>8712</b></p> <p><b>Shamrock-Shape/Small</b></p>  	<p><b>8709</b></p> <p><b>Oval Shape/Large</b></p>  	<p><b>8714</b></p> <p><b>Oval Shape/Small</b></p>  
<p>Approx. 45 mm</p>	<p>Approx. 30 mm</p>	<p>Approx. 45 x 75 mm</p>	<p>Approx. 30 x 50 mm</p>
			



**CLOVER NEEDLECRAFT, INC.**  
**CLOVER MFG. CO., LTD. JAPAN**  
[www.clover.com](http://www.clover.com)



CT0129  
Vol.3