

Botanical Towel Ring

Clover



Art No. 8483
& Art No. 8487

MAKE•IT

How to make a Kanzashi

Step 1:

Place fabric in between template and snap shut. Cut fabric around template.

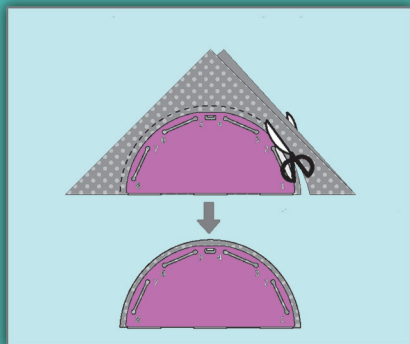

Step 2:

Use guides to hand stitch around the template.

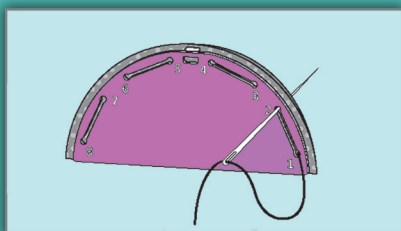

Step 3:

Remove fabric from template. Gather petals by pulling thread. Repeat step for all petals on a continuous thread.

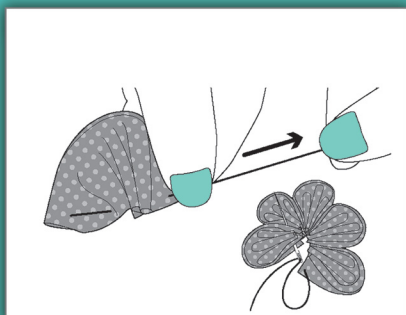

Step 4:

Pull thread through first petal, pull tight to create pleats then knot.

Assembling your ring

Step 1: Complete a total of three Kanzashi Flowers.
- 2 Round Petal & 1 Pointed Petal

Step 2: Use fabric glue or glue gun to glue a piece of felt to the back of your flower and a button or gem to the top of your flower.



Step 3: Glue felt leaves and flowers to your ring in a pattern of your choosing. You can either glue items directly on the ring or glue the flower and leaf to each other with the ring in between.



Step 4: Add a loop to your ring and hang!

Materials List

***Cut 5 pieces of fabric to measure 4" x 4". This will make one flower. (you will need to make three flowers for this project)**

***Needle and thread. (leave tail 18 inches long in order to stitch all five petals in one continuous thread)**

***Art No. 8483 & 8487 Large Kanzashi Flower Makers, Pointed & Orchid**

*** One 7inch craft ring.**

*** Hanging Cord.**



[@cloverusa](https://www.instagram.com/cloverusa)

[blog.clover-usa.com](https://www.blog.clover-usa.com)

CT0181
Rev. Jan 2020

P.O. Box 9850 Ontario, CA 91761
Toll: 800.233.1703 Fax: 909.218.2161

www.clover-usa.com